

REPLACEMENT PARTS LIST

INTEGRITY WARMERS, MODEL 8708

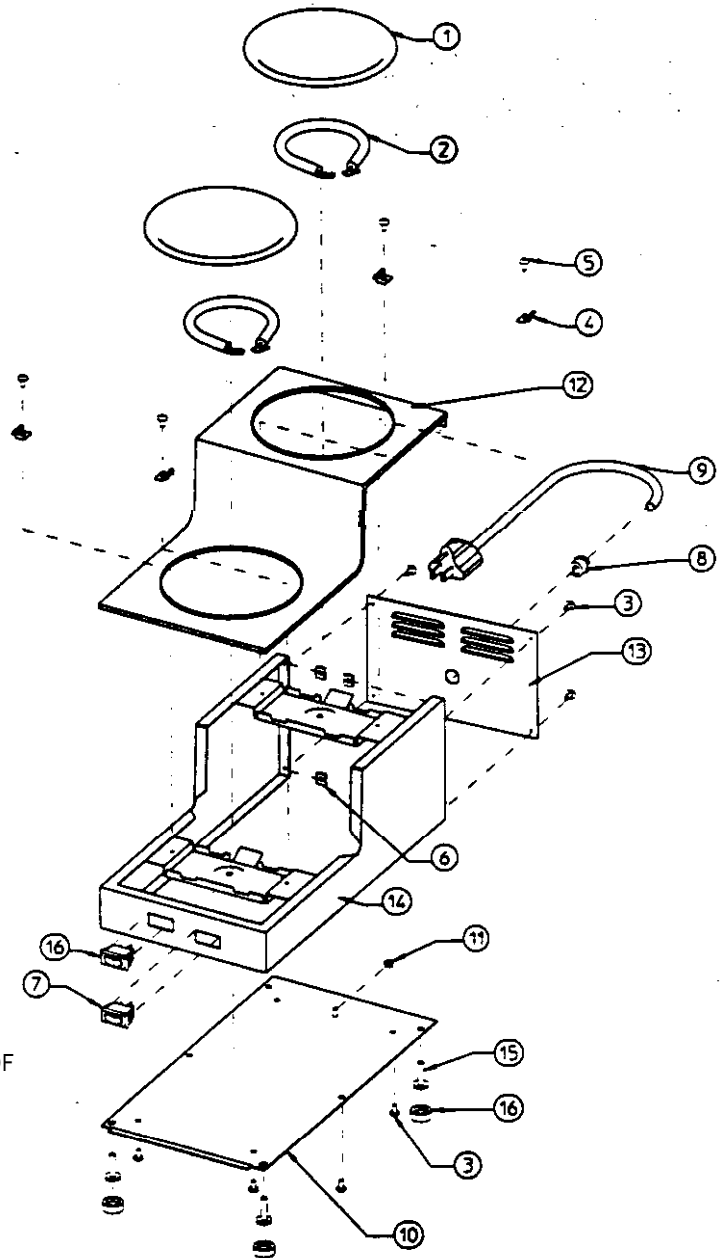
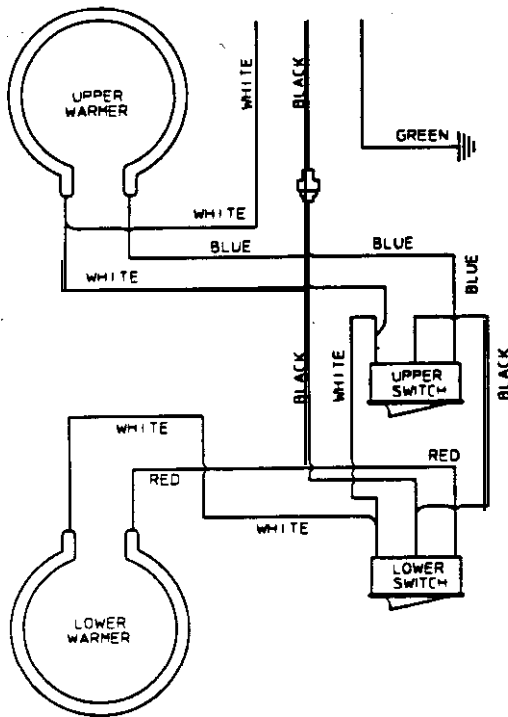

NOTE:
WHEN ORDERING REPLACEMENT PARTS ALWAYS SPECIFY
MODEL NUMBER (SHOWN ON SPEC. PLATE LOCATED IN BACK OF
THE UNIT). PART NUMBER, DESCRIPTION AND QUANTITY OF
EACH PART BEING ORDERED. MINIMUM ORDER IS \$5.00.

16	8033-56	LEVELER CAP	4
15	8033-55	LEG. LEVELER	4
14	81206	BODY SUB ASSY 8708 WARMER	1
13	8553-4	COVER BACK WARMER	1
12	8553-3	COVER WARMER TOP	1
11	16-84	NUT KEP 6-32	2
10	8553-11	PLATE BOT S/A DBL STEP-UP	1
9	8841-8	CORD & CAP	1
	35-210	STRAIN RELIEF LO TIGHT	1
	3710-23	SWITCH ON-OFF LITED 120V	2
6	8543-23	NUT TNR Z1 #8	10
5	7506-30	SCREW 8-32 x 3/8 TAPG	4
4	8543-80	CLIP MTG	4
3	8861-23	SCREW PHL SS 8 x 3/8	10
2	8572-18	ELEM WARMER 120V 100W	2
1	8700-16	PLATE COVER WARMER	2
ITEM	PART NO.	DESCRIPTION	QTY