

64 Modular Series

64KB and 64KPRB Corner
Multiple Tank Rack Conveyor
Modular System

Champion[®]

The Dishwashing Machine Specialists



Shown with optional end panels

High Volume, Flexible Warewashing System

Champion's prewash, wash, rinse and final rinse drive modular units provide peak efficiency and maximum design flexibility for your high volume application.

Exclusive Heavy-Duty Construction

The entire machine, including frame, base, legs, lower panels and doors are heavy-gauge stainless steel for durability and reliable service.

Simple, Fully Automatic Operation

Flip one switch to fill and heat the tanks and activate the optional booster heater and blower-dryer. Then, one pushbutton starts the conveyor and automatic operation.

Choice of Tank Heat

Standard electric elements or optional steam coils, or steam injectors to maintain proper tank heat.

Space Saving Top Mounted Controls

Top mounted controls are convenient, safe and save space. A reliable 120-volt control circuit allows easy access for connecting chemical dispensing equipment.

Easy to Clean

Upper and lower spray arms are interchangeable and have easily-removable end caps for fast, thorough cleaning. Standard external scrap basket on the prewash unit reduces soil build-up. The machine continually cleans itself during operation, saving labor and "down" time.

64 Modular Series

64KB and 64KPRB Corner
Multiple Tank Rack Conveyor
Modular System

Typical Modula

90° Application

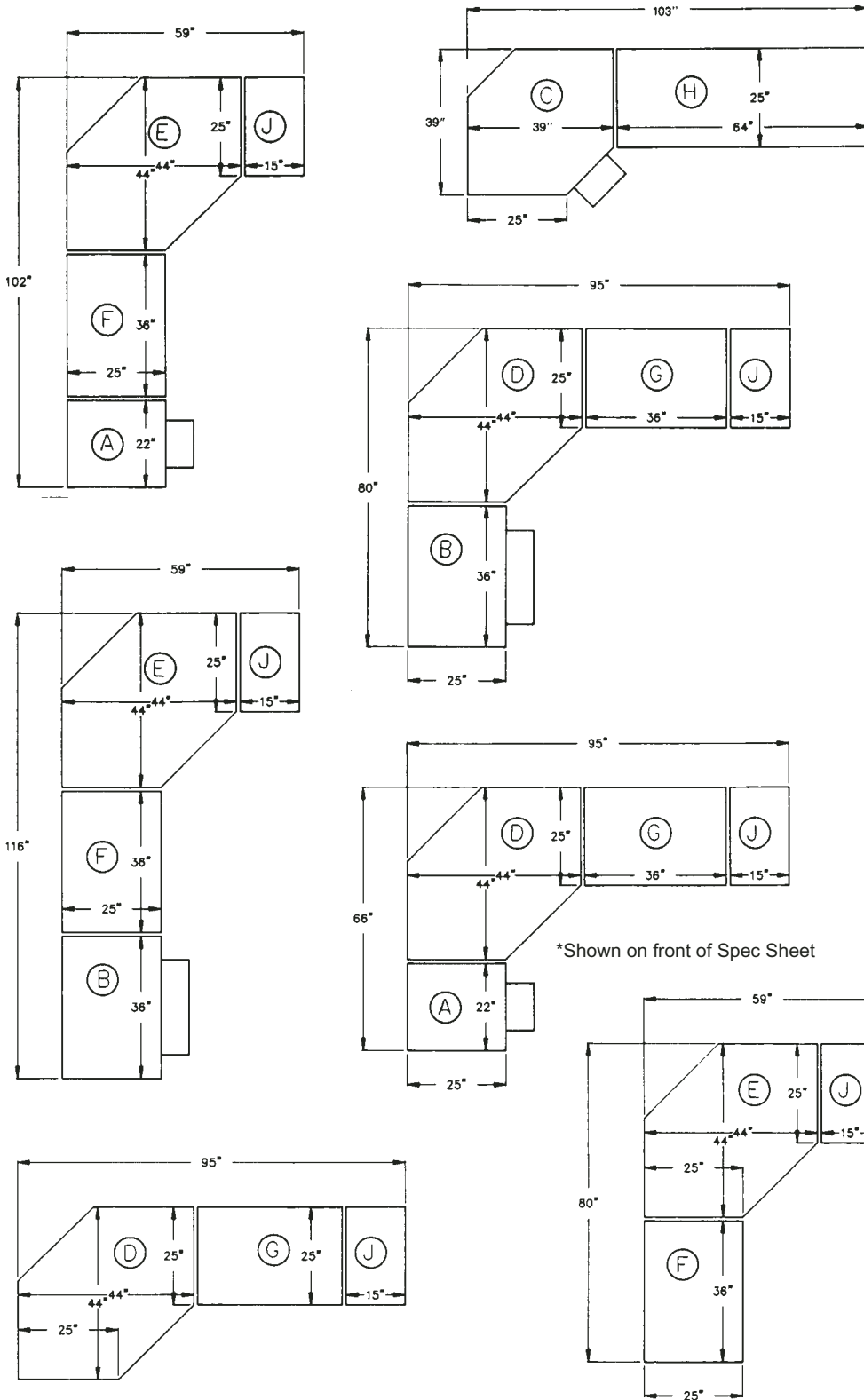

Modular Units	
Prewash 22"	A
Prewash 36"	B
Corner Prewash 39"	C
Corner Wash	D
Corner Rinse	E
Straight Wash	F
Straight Rinse	G
Wash/Rinse	H
Final Rinse Drive	J

For electrical, drain, and booster connections, consult the Factory.

For Options and Accessories, refer to 64KB and 64KPRB Specification Sheets.

Note: Machine to be installed 6" (min.) from wall.

Available in either right-to-left, or left-to-right operation

*Shown on front of Spec Sheet

Warning: Plumbing and electrical connections should be made by qualified workmen who will observe all the applicable plumbing, sanitary, safety codes and the National Electrical Code.

Note: Water Hammer Arrestor (meeting ASSE-1010 standard or equivalent) to be supplied (by others) in common water supply line at service connection



Configuration

180° Application

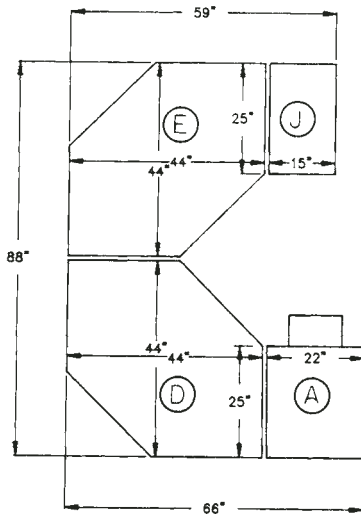
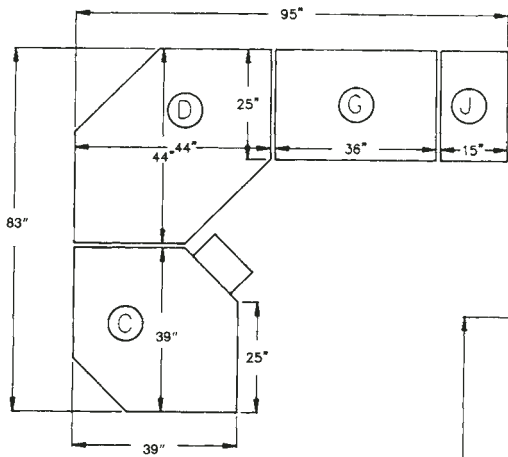
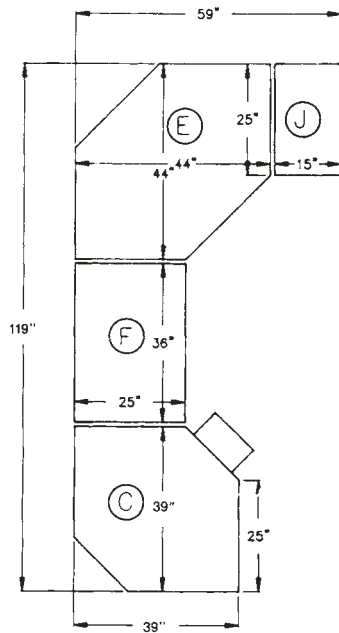
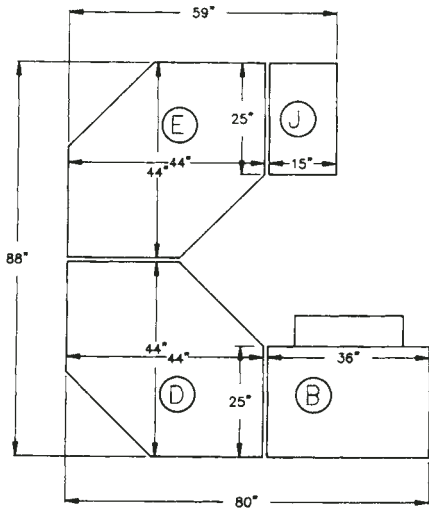

*Shown on front of Spec Sheet

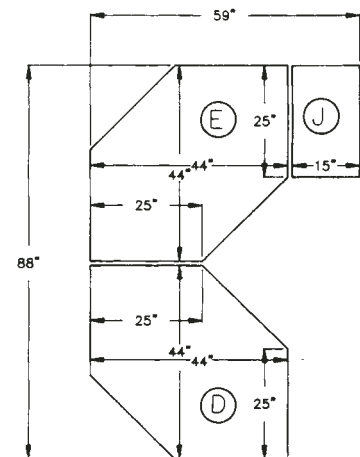

Due to an ongoing value analysis program at Champion, specifications contained in this catalog are subject to change without notice.

Quick Facts

Capacities

Racks per hr. (NSF rated)	201
Wash tank (gal.)	20
Conveyor speed (ft./min.)	7

Motor horsepower

Drive	1/4
Prewash 22", 36" and 37"	1
Wash	2
Rinse	2

Water consumption

Gal. per hr. (max. use)	300
Gal. per rack	1.49

Temperature °F

Wash	150
Rinse	160
Final Rinse	180

Heating

Tank heat, electric (Kw)	25
Tank heat, steam (lbs./hr. required at 15 psi flow pressure)	125
Electric booster (built-in) (Kw required for 40° rise)	36
Electric booster (Kw required for 70° rise)	57
Steam booster (lbs./hr. required for 40° rise)	185
Steam booster (lbs./hr. required for 70° rise)	320

Venting

Load end (minimum cfm)	200
Unload end (minimum cfm)	400

Standard 20" x 20" rack complement

Peg	2
Flat	1

Standard Features

- Automatic tank fill
- Common utility connections
- Control circuit, 115-volt
- Convenient top-mounted controls
- Conveyor drive 1/4-Hp motor
- Door activated drain closure
- Door safety switch
- Enclosure panel (front)
- Energy sentinel (idle pump shut-off)
- External scrap basket on prewash units
- Interchangeable spray arms
- Leakproof doors, internally fitted
- Prewash 1-Hp pump motor
- Low-water tank heat protection
- Rinse saver device
- Stainless steel heavy gauge construction, including base and feet
- Electric tank heat (optional: steam coil or steam injectors)
- Wash and rinse pumps with 2-Hp motors

64 Modular Series

64KB and 64KPRB Corner
Multiple Tank Rack Conveyor
Modular System

Champion[®]

The Dishwashing Machine Specialists



**Sample configuration consisting of:
22" prewash, corner wash straight rinse,
final rinse drive, and optional end panels.**



**Standard external scrap
basket reduces soil build-up.**



**Racks are moved automatically by means of a 90° curved
pawl bar and conveyor.**