



PROJECT	
ITEM #	
QUANTITY	DATE
APPROVAL	

CM/CP**Mobile chilled mug and plate dispensers****Short Form Specifications**

Cabinet top surface shall be 16-gauge stainless steel with all corners welded and polished and reinforced with heavy-gauge channels. Insulated folding lid shall be stainless steel with high impact plastic liner and have chrome plated, die cast handles. Opening shall have a throat liner constructed of high impact plastic.

The exterior sides and the watertight inner liner shall be 22-gauge stainless steel. The unit shall be insulated with foamed-in-place high density polyurethane. Unit to be equipped with 4.00" (10.2cm) diameter, polyefin swivel casters and non-marking gray corner bumpers.

Refrigeration system controlled by an electronic control with built in defrost timer. System will also include a blower coil and a condensate evaporator. Unit designed to maintain a temperature setting from -5°F to 40°F (-21°C to 4°C).

THE FOLLOWING APPLIES TO MODELS CP-2 AND CP-4 ONLY:

On CP-2 and CP-4, stainless steel perforated dispenser tubes (2 on CP-2 and 4 on CP-4) for plates shall be furnished with properly calibrated, non-fatiguing stainless steel springs. Each dispenser tube shall have a maximum capacity of approximately 50 plates.

NOTE: The maximum dish diameter that can be dispensed by these models is 9.62" (24.4cm).

THE FOLLOWING APPLIES TO MODEL CM-2 ONLY:

On CM-2, self-leveling mechanism to be field adjustable by adding or removing stainless steel extension springs on perimeter of vertical side channels. A 20.00" x 20.00" (50.8cm x 50.8cm) carrier tray shall be provided. The dispenser shall have a capacity of three to four 20" x 20" racks (50.8cm x 50.8cm). Racks are not supplied by Delfield; most hold 20-25 mugs.

Optional Accessories and Modifications

- Heavy duty casters (consult factory)
- Fiberglass panels
- Laminate panels
- Lid-locking device (specify model number)

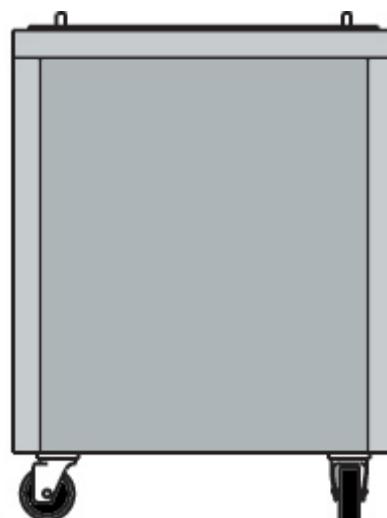
**MODEL CP-4**

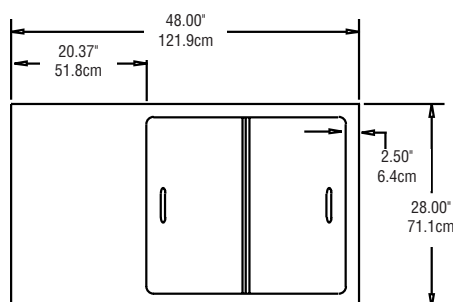

**PLAN VIEW
CM-2 MODELS**

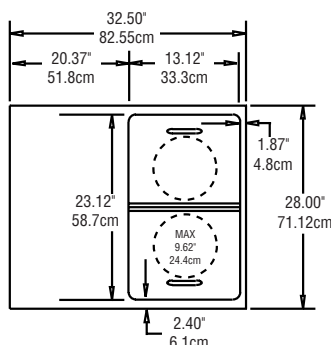

**PLAN VIEW
CP-2 MODELS**

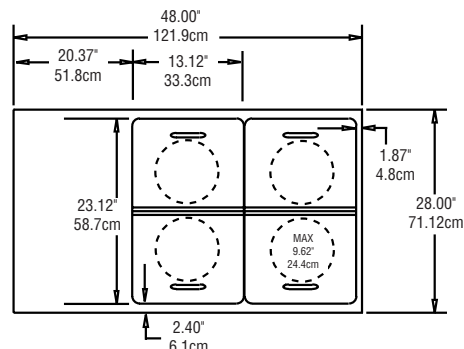

**PLAN VIEW
CP-4 MODELS**

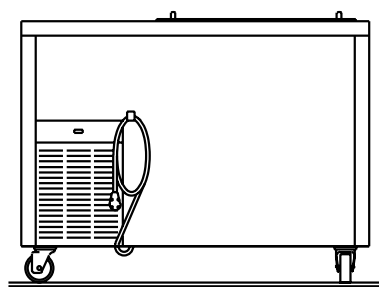

**ELEVATION VIEW
CM-2 MODELS**

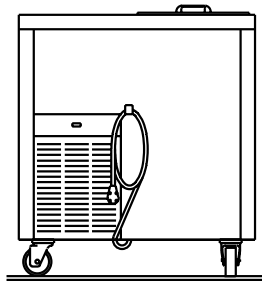

**ELEVATION VIEW
CP-2 MODELS**

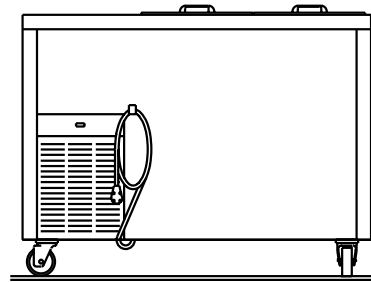

**ELEVATION VIEW
CP-4 MODELS**

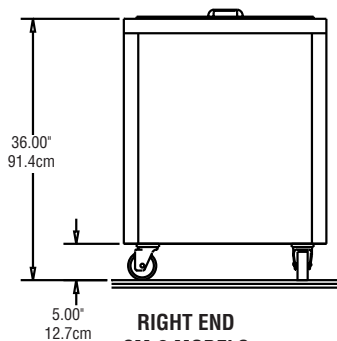

**RIGHT END
CM-2 MODELS**

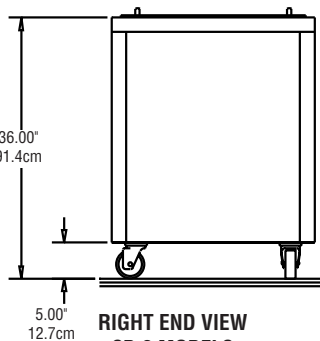

**RIGHT END VIEW
CP-2 MODELS**

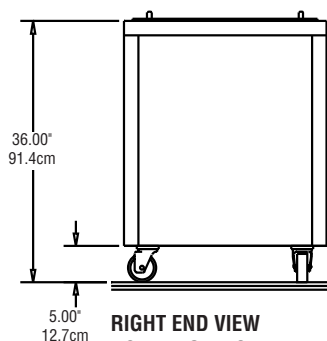

**RIGHT END VIEW
CP-4 MODELS**

Technical Data—Standard Unit

MODEL NUMBER	APPROX. CAPACITY	ELECTRICAL CONNECTION	HP	AMPS	NEMA PLUG	SHIP WEIGHT
CM-2	60 mugs	120V/60 Hz/ single phase	1/3	10.0	5-15P	485lbs - 200kg
CP-2	100 plates or bases	120V/60 Hz/ single phase	1/3	10.0	5-15P	410lbs - 186kg
CP-4	200 plates or bases	120V/60 Hz/ single phase	1/3	10.0	5-15P	485lbs - 220kg

NOTES:

- These models include a 9' (2.7cm) cord with NEMA 5-15 plug.
- The following information is required with an order to ensure proper operation of CP-2 and CP-4 models:
 - 1) Height of one plate.
 - 2) Overall diameter of the plate,
 - 3) Height of a stack of eleven plates, and
 - 4) Weight of a stack of 10 plates.