



PROJECT	
ITEM #	
QUANTITY	DATE
APPROVAL	

F17R

Remote Refrigerated Base Equipment Stands

Short Form Specifications

Top is constructed of 18-gauge stainless steel, with integral front marine edge nosing and rear backsplash. Spline bars are made of 12-gauge stainless steel and run front to back on both the left and right stainless steel sides for support and spline purposes. Interior sub-top is made of 22-gauge 2BF stainless steel is made integral with the top by injecting 2.00" of high density polyurethane foam between the exterior and interior tops. As a standard, 14-gauge cutting board brackets are attached to each side and house a 1.25" thick x 9.5" deep maple cutting board.

Refrigerated base interior back and bottom is constructed of 22-gauge 2BF stainless steel. Exterior sides are constructed of 18-gauge stainless steel. Bottom and back are made of 22-gauge galvanized steel. Both left and right interior sides are formed of ABS plastic. The base is injected with 2.00" of high density polyurethane foam between the exterior and interior. Refrigerated base fronts are made of .095" thick ABS thermoformed plastic and backed up by ridged polyurethane water blown injection molded frames. The frames are an excellent thermo-break and superior structural material for fastening doors and drawers. Exterior machine compartment side is constructed with 18-gauge galvanized steel.

Single units are supplied with a wall-mounted bracket and threaded rod to allow installation of the unit against a solid surface. Units shipped, as part of a line-up do not come standard with a wall mounted bracket assembly.

Full Extension Plus drawer system is a complete drawer system, which can operate independent of the unit it's installed in. Drawer system is sized to hold 12 x 20 x 4 " deep hotel pans and smaller fractional pans. Drawer system is all stainless steel construction for maximum durability. Outer drawer track is made of 11-gauge stainless and held in place with 12-gauge up right and cross supports. Drawer track rollers are made of Delrin™ 100 NC-10 and do not require grease for operation. Intermediate tracks are removable without tools and house Delfield's "anti-friction binary roller system". Drawer boxes are designed with "easy pan grip flanges". Tracks are designed with a stay shut feature that holds the drawer gasket tight to the base front on uneven floors. Exterior drawer fronts are made of 22- gauge stainless steel; and an interior made of ABS plastic with formed in channels to house the snap-in dart style santoprene gasket. A 12-gauge galvanized brace is foamed in place to be an integral part of the drawer front assembly. Each drawer front is injected with 1.87" of high density polyurethane foam between the exterior and interior. Handles are recessed black plastic and held in with a positive lock system.

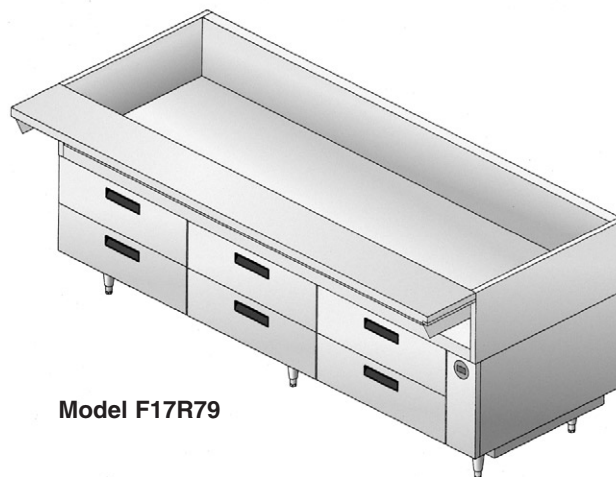

Model F17R79

Unit is supported with two 14-gauge leg rails that run the entire length of the unit. Leg rails are welded to the bottom side of the unit and are tied together with two 12-gauge braces running front to back. Caster/leg boxes are welded inside the leg rail and 6.12" adjustable stainless steel legs are mounted as standard with (4) 5/16" bolts. Remote models have a digital thermometer installed in the machine compartments (standard on right) removable access panel and it's equipped with a thermostat and solenoid valve. Remote models must be hard wired at the installation site.

Refrigeration system components are HFC-404A. Interior cabinet is cooled with mullion style blower coils (coated) mounted between each door/drawer section for very even air and temperature control. Electrical connections are 115V-60H-1PH.

Optional Accessories and Modifications

- 505B Stainless steel back
 - 906A Stainless steel end
 - 505F Laminate facing (drawers only)
 - 905A Laminate back
 - 906E Laminate end
 - 1027A Casters
 - 108 Locks
 - 213 *220V/50 cycle electrical
- *Inclusion of this option will alter electrical specifications.



Delfield's
MARK7
modular equipment

Remote Refrigerated Base Equipment Stands

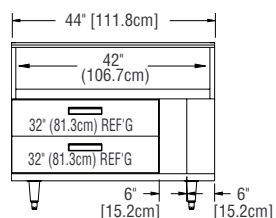

**ELEVATION VIEW
F17R44**

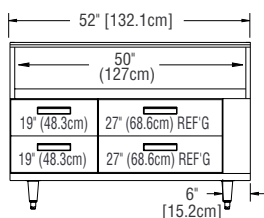

**ELEVATION VIEW
F17R52**

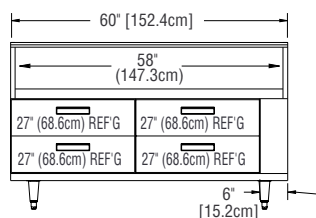

**ELEVATION VIEW
F17R60**

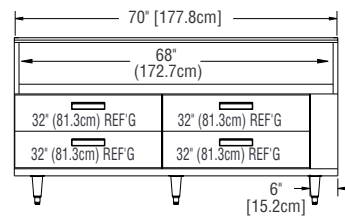

**ELEVATION VIEW
F17R70**

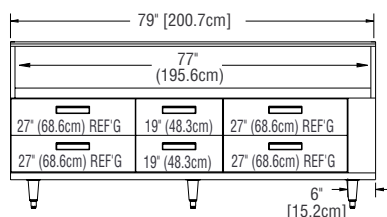

**ELEVATION VIEW
F17R79**

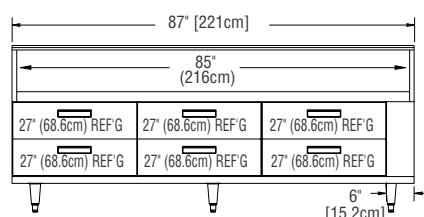

**ELEVATION VIEW
F17R87**

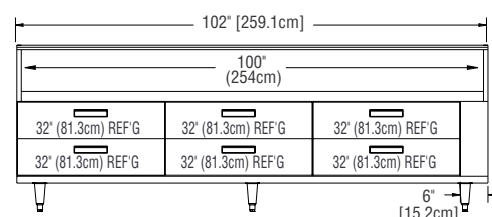

**ELEVATION VIEW
F17R102**

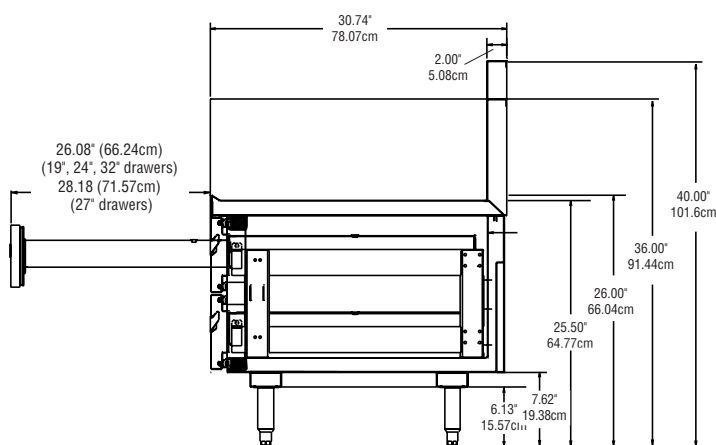

END VIEW ALL MODELS

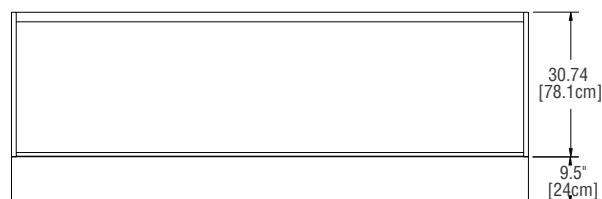

PLAN VIEW ALL MODELS

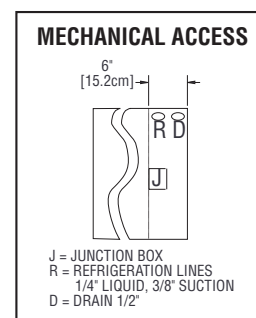

Mechanical Data—Standard Unit

MODEL NUMBER	NUMBER OF DRAWERS	PAN* CAPACITY	RECOM. H.P.	VOLTS, HERTZ PHASE	AMPS	BTU DESIGN LOAD	SYSTEM CAP LOAD	EVAP. CAP. BTU/°TD	SHIP WEIGHT
F17R44	(2) 32"	4	1/5	115/60/1	3.0	452	1673	120/14	300 lbs/ 136 kg
F17R52	(2) 19 & (2) 27"	6	1/5	115/60/1	3.0	556	1673	120/14	350 lbs/ 159 kg
F17R60	(4) 27"	8	1/5	115/60/1	3.0	632	1673	120/14	396 lbs/ 180 kg
F17R70	(4) 32"	8	1/5	115/60/1	3.0	726	1673	120/14	450 lbs/ 204 kg
F17R79	(2) 19 & (4) 27"	10	1/4	115/60/1	6.0	868	2232	240/15	525 lbs/ 238 kg
F17R87	(6) 27"	12	1/4	115/60/1	6.0	1001	2232	240/15	560 lbs/ 254 kg
F17R102	(6) 32"	12	1/4	115/60/1	6.0	1143	2232	240/15	610 lbs/ 276 kg

*12" x 20" x 4" deep pans not included.

The Delfield Company, 980 S. Isabella Rd., Mt. Pleasant, MI 48858, U.S.A. • (800) 733-8821 • Fax (800) 669-0619 • www.delfield.com

Delfield reserves the right to make changes in design or specifications without prior notice. ©2003 The Delfield Company. All rights reserved. Printed in U.S.A.

DS17R 04/03