



PROJECT	
ITEM #	
QUANTITY	DATE
APPROVAL	

F18RR

31.5" (80cm) Deep Remote Reduced Height Rail

Short Form Specifications

Exterior top is one-piece, 16-gauge stainless steel, with integral 2.12" (5.4cm) high square nosing on front. Top has a mechanically cooled refrigerated raised rail at rear with openings to accommodate 1/6 size pans. Pans and adapter bars are provided by others. Pans are recessed 3" (7.6cm) or 2" (5.1cm) and set on adjustable stainless steel pan supports. Rail interior is 22-gauge stainless steel. Raised rail openings have 20-gauge stainless steel removable lids. Unit is equipped with separate expansion valve and on/off switch for refrigerated rail. Temperature in top opening to maintain 33°F (1°C) to 41°F (5°C), with pans recessed 3" (7.6cm), at 86°F ambient room temperature, meeting NSF7 requirements.

Exterior Back and Bottom are 24-gauge galvanized steel. Exterior ends are finished with 18-gauge galvanized steel.

Base Interior is 22-gauge stainless steel back and bottom. Base interior ends and door frames are thermoformed ABS plastic. Base is insulated with 1.5" (3.8cm) high density foamed in place polyurethane.

Door(s) have a 22-gauge stainless steel exterior front, with thermoformed ABS plastic interior liner, black recessed handle and snap in magnetic gasket which is easily replaceable. Each interior door section has (1) removable epoxy coated wire shelf.

Base has a blower coil assembly with expansion valve located behind door mullion. Base is equipped with independently controlled thermostat and solenoid valve. On/off switch for unit is located behind the hinged panel.

Unit is mounted on 6.13" (15.6cm) high adjustable stainless steel legs.

Electrical connections are 115 volt, 60 Hertz, single phase. Unit must be hard wired.

Refrigeration System Components — HFC-404A



Model F18RR79

Optional Accessories & Modifications

- 906A** Stainless steel end
- 505H** Stainless steel back
- 505F** Laminate facing (full front)
- 906E** Laminate end
- 905A** Laminate back
- 1030A** Cutting board (Sanalite or composite)
- 109** Condensate evaporator (1 per coil) for base
- 107F** Tray rack
- 102** Drawers
 - A-(2) 19" in lieu of one door
 - B-(2) 27" in lieu of one door
 - C-(2) 32" in lieu of one door
- 108** Locks
- 120F** Cold pan drain
- 213** *220V/50 cycle

*Inclusion of this option will alter the electrical specifications of the unit



Delfield's
MARK7
modular equipment

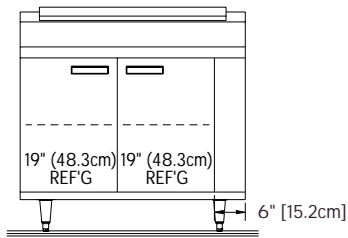

ELEVATION VIEW
F18RR44

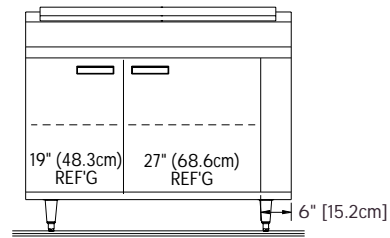

ELEVATION VIEW
F18RR52

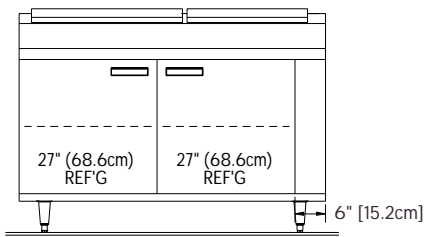

ELEVATION VIEW
F18RR60

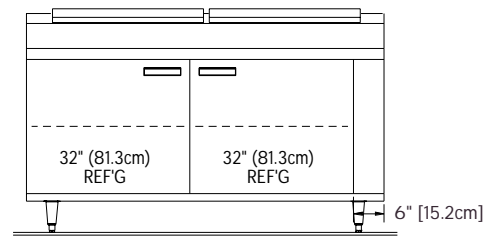

ELEVATION VIEW
F18RR70

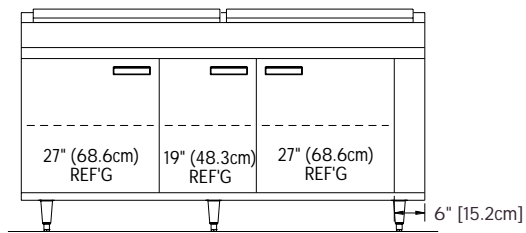

ELEVATION VIEW
F18RR79

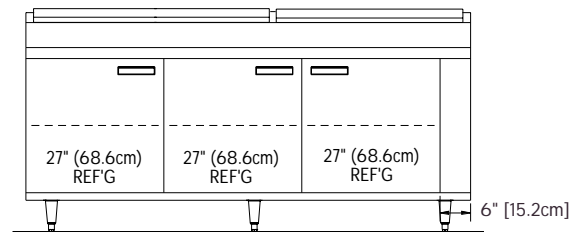

ELEVATION VIEW
F18RR87

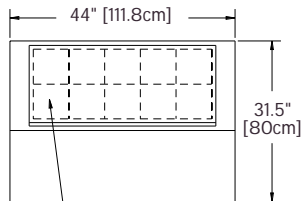

44" LG. MECH. COOLED NSF-7
STYLE RAISED RAIL WITH (1) 13.62"
X 34.87" TOP OPENING TO ACCOMMODATE
(10) 1/6 SIZE PANS 6" DP. PROVIDED WITH
HINGED REMOVABLE COVER AND
ADJUSTABLE PAN CLIPS. (PANS AND
ADAPTER BARS BY OTHERS)

**PLAN VIEW
F18RR44**

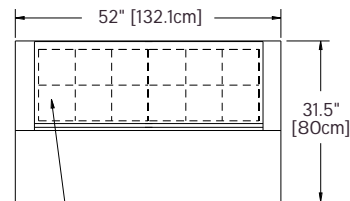

52" LG. MECH. COOLED NSF-7
STYLE RAISED RAIL WITH (1) 13.62"
X 41.87" TOP OPENING TO ACCOMMODATE
(12) 1/6 SIZE PANS 6" DP. PROVIDED WITH
HINGED REMOVABLE COVER AND
ADJUSTABLE PAN CLIPS. (PANS AND
ADAPTER BARS BY OTHERS)

**PLAN VIEW
F18RR52**

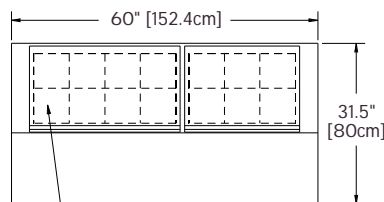

60" LG. MECH. COOLED NSF-7
STYLE RAISED RAIL WITH (1) 13.62"
X 20.87" TOP OPENING TO ACCOMMODATE
(6) 1/6 SIZE PANS 6" DP. AND (1) 13.62"
X 27.87" TOP OPENING TO ACCOMMODATE
(8) 1/6 SIZE PANS 6" DP. PROVIDED WITH
HINGED REMOVABLE COVER AND
ADJUSTABLE PAN CLIPS. (PANS AND
ADAPTER BARS BY OTHERS)

**PLAN VIEW
F18RR60**

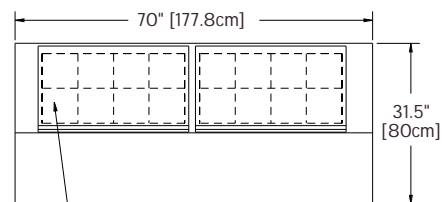

70" LG. MECH. COOLED NSF-7
STYLE RAISED RAIL WITH (2) 13.62"
X 27.87" TOP OPENINGS TO ACCOMMODATE
(8) 1/6 SIZE PANS 6" DP. PROVIDED WITH
HINGED REMOVABLE COVER AND
ADJUSTABLE PAN CLIPS. (PANS AND
ADAPTER BARS BY OTHERS)

**PLAN VIEW
F18RR70**

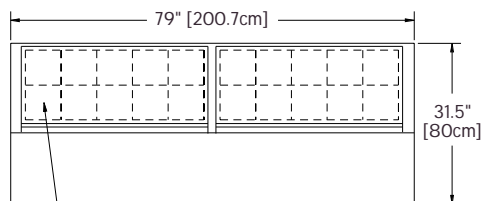

79" LG. MECH. COOLED NSF-7
STYLE RAISED RAIL WITH (2) 13.62"
X 34.87" TOP OPENING TO ACCOMMODATE
(10) 1/6 SIZE PANS 6" DP. PROVIDED WITH
HINGED REMOVABLE COVER AND
ADJUSTABLE PAN CLIPS. (PANS AND
ADAPTER BARS BY OTHERS)

**PLAN VIEW
F18RR79**

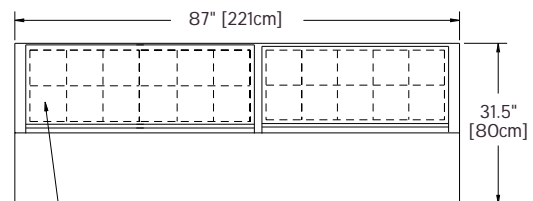

87" LG. MECH. COOLED NSF-7
STYLE RAISED RAIL WITH (1) 13.62"
X 41.87" TOP OPENING TO ACCOMMODATE
(12) 1/6 SIZE PANS 6" DP. AND (1) 13.62"
X 34.87" TOP OPENING TO ACCOMMODATE
(10) 1/6 SIZE PANS 6" DP. PROVIDED WITH
HINGED REMOVABLE COVER AND
ADJUSTABLE PAN CLIPS. (PANS AND
ADAPTER BARS BY OTHERS)

**PLAN VIEW
F18RR87**

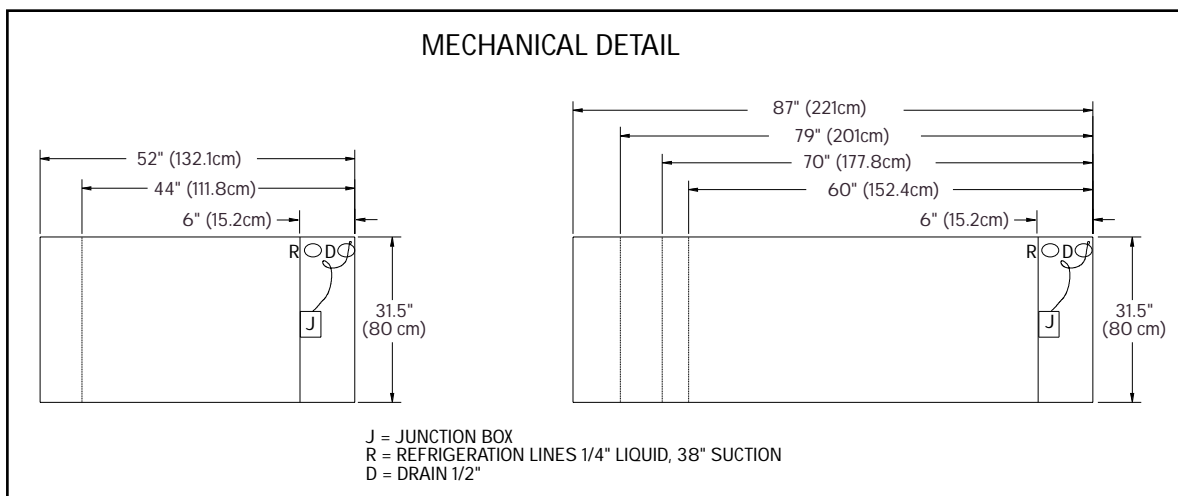
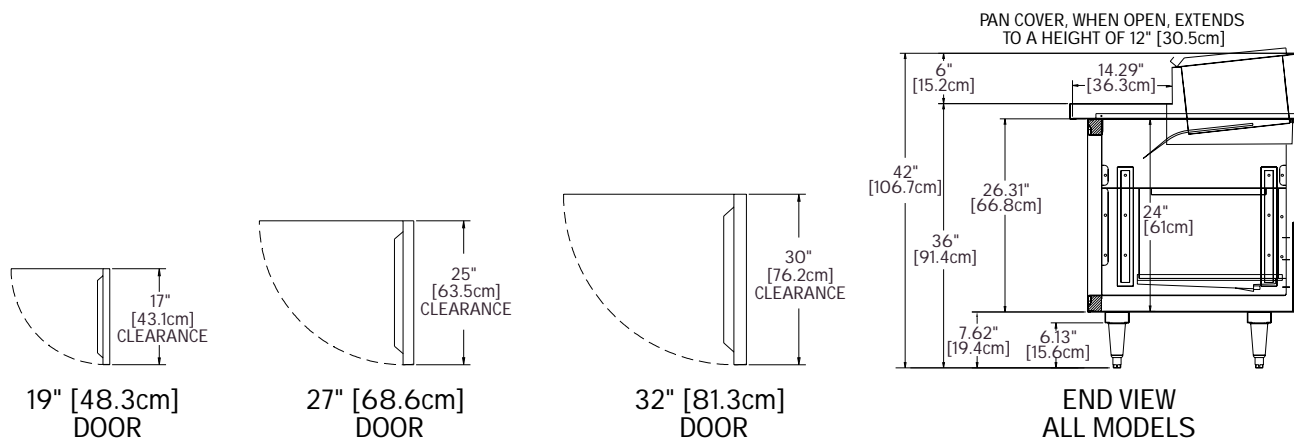

NOTE; UNOBSTRUCTED AIRFLOW MUST BE MAINTAINED TO INSURE UNIT PERFORMANCE AND MAINTAIN WARRANTY.

Mechanical Data-Standard Unit

MODEL NUMBER	NUMBER OF DOORS	NUMBER OF PANS	STORAGE CU. FT.	SHELF AREA SQ. FT.	H.P.*	AMPS	SHIP WEIGHT LBS/KG	BTU DESIGN LOAD BASE/RAIL	EVAP. CAP. BTU /°TD
F18RR44	(2) 19"	10	9.49	5.12	1/4	3.0	485/220	547/441	120/19
F18RR52	19" & 27"	12	11.81	6.51	1/3	3.0	540/245	625/529	120/23
F18RR60	(2) 27"	14	14.14	7.90	1/3	5.0	620/281	703/617	120/26
F18RR70	(2) 32"	16	17.05	9.64	1/2	5.0	700/317	800/794	120/32
F18RR79	(2) 27" & 19"	20	18.68	10.29	1/2	5.0	735 /333	962/882	240/36
F18RR87	(3) 27"	22	21.30	11.85	3/4	5.0	765/347	1032/970	240/39

*Recommended horsepower