



PROJECT	
ITEM #	
QUANTITY	DATE
APPROVAL	

KCF

Mobile Ice Cream Counters

Short Form Specifications

Exterior Body is seamless, one-piece molded fiberglass, having perfectly smooth exterior surface with all corners fully rounded. The fiberglass reinforced polyester (F.R.P.) is molded with permanent color. Stress points are internally reinforced.

Exterior Top is constructed of 14-gauge stainless steel welded, ground and polished into one integral unit. Top is fabricated with square corners. Top has die-stamped openings, with hinged removable lids, one on KCF-36, two on KCF-50, three on KCF-60 and four on KCF-74. Lids are constructed of stainless steel and has a rubber gasket seal.

Freezer Compartment has a water-tight inner liner constructed of 22-gauge stainless steel, with radius corners and 1.5" (3.8cm) of polyurethane insulation. Freezer compartment is equipped with drain plumbed to a drain valve located in the bottom of the counter. Freezer compartment is equipped with automatic self-leveling, field-adjustable elevators. Divider trays are supplied.

Refrigeration; Copper refrigeration coils are attached to outside of inner liner. Unit is refrigerated by self-contained, 115 volt, 60 hertz, single phase hermetically sealed condensing unit with thermostatic control. Unit is wired with a 3-wire, grounded, maximum 10' (3m) 120 volt cord and plug.

Casters; units are mounted on 5" (12.7cm) diameter swivel casters with non-marking polyolefin tires and plate brakes. Overall height of caster assembly is 6" (15.2cm)



Model KCF-50

Optional Accessories and Modifications

- A) 12" (30.5cm) wide stainless steel fold-down tray slide
- C) 10" (25.4cm) wide three-bar fold-down tray slide
- E) 10" (25.4cm) wide stainless steel fold-down work shelf
- F) Line-up interlock device
- R) 10" x 17" x 4" (25.4cm x 43.2cm x 10.2cm) deep chrome wire baskets
- S) Stainless steel lid locking device with keyed lock
- ST) Stainless steel trim strips
- U) 14" x 30" (35.6cm x 76.2cm) stainless steel end drop shelf
- UU) Molded fiberglass trim strips
- V) 6" (15.2cm) high adjustable stainless steel legs in lieu of casters



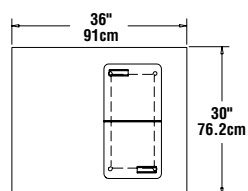

DRAINS CENTERED
UNDER EACH
COMPARTMENT

**PLAN VIEW
KCF-36**

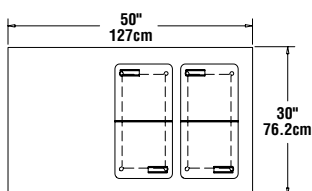

DRAINS CENTERED
UNDER EACH
COMPARTMENT

**PLAN VIEW
KCF-50**

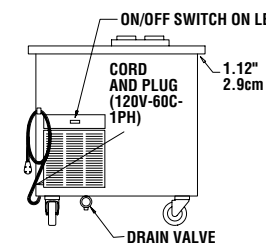

**ELEVATION VIEW
KCF-36**

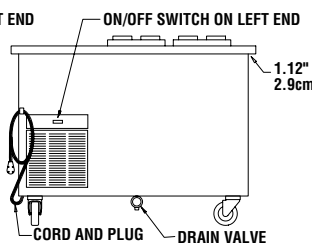

**ELEVATION VIEW
KCF-50**

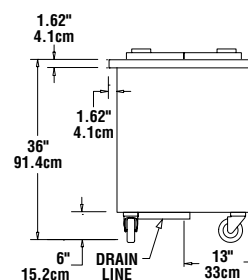

**END VIEW
ALL MODELS**

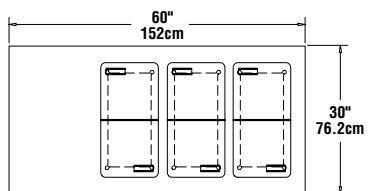

DRAINS CENTERED
UNDER EACH
COMPARTMENT

**PLAN VIEW
KCF-60**

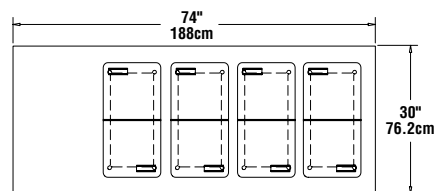

DRAINS CENTERED
UNDER EACH
COMPARTMENT

**PLAN VIEW
KCF-74**

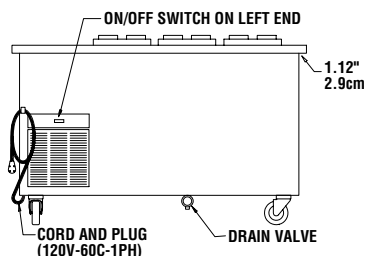

**ELEVATION VIEW
KCF-60**

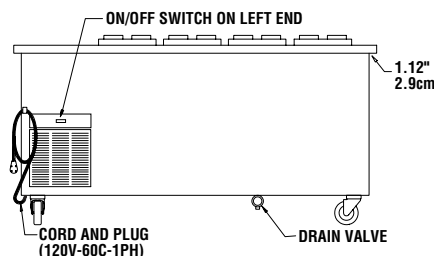

**ELEVATION VIEW
KCF-74**

Mechanical Data—Standard Unit

MODEL NUMBER	ICE CREAM CAPACITY*	TOP OPENINGS	H.P.	VOLTS/ HERTZ/ PHASE	AMPS	NEMA PLUG	SHIP WEIGHT
KCF-36	210	1	1/4	120/60/1	6.0	5-15P	475 lbs/216 kg
KCF-50	420	2	1/4	120/60/1	6.0	5-15P	525 lbs/238 kg
KCF-60	630	3	1/3	120/60/1	8.0	5-15P	575 lbs/260 kg
KCF-74	840	4	1/3	120/60/1	8.0	5-15P	625 lbs/283 kg