



PROJECT	
ITEM #	
QUANTITY	DATE
APPROVAL	

# N8000

## Drop-In Ice Cooled Cold Pans

### Short Form Specifications

Top is one piece 20-gauge stainless steel. Interior liner is 22-gauge stainless steel and is creased to 1.00" (2.54 cm) diameter drain. Unit has a sectional, removable perforated stainless steel false bottom and is provided with adapter bars to allow placement of 12" x 20" (30.5 cm x 50.8 cm) pans. Unit is supplied with 1" (2.54 cm) plastic drain to be installed by customer. Exterior housing is 22-gauge galvanized steel. Unit is insulated with high density closed cell polyurethane.

### Optional Accessories & Modifications

- Custom sizes and styles
- Single or double service flip-up sneezeguards



Model N8056

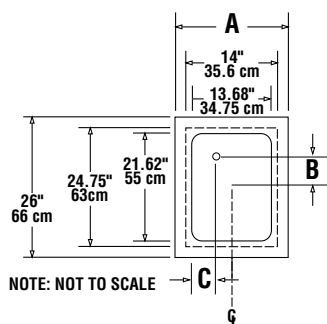

PLAN VIEW  
MODEL N8018

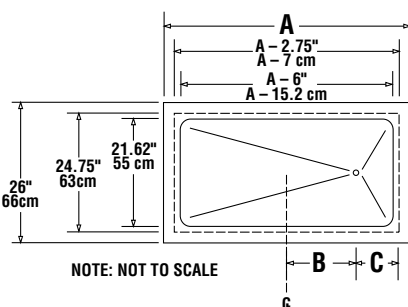

TYPICAL PLAN VIEW  
N8000 MODELS (EXCEPT N8018)



TYPICAL ELEVATION VIEW  
ALL N8000 MODELS

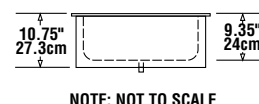

TYPICAL RIGHT END VIEW  
ALL N8000 MODELS

### Mechanical Data: Standard Unit



MODEL NUMBER	A	B	C	COUNTER CUTOUT DIMENSIONS (D x L)	# OF 12" X 20" PANS HELD	SHIPPING WEIGHT
N8018	18" 45.7cm	6.84" 17.3cm	4.06" 10.3cm	17" x 25" 43.2cm x 63.5cm	1	37 lbs 17 kg
N8030	30.75" 78.1cm	8.68" 22cm	6.06" 15.3cm	29.75" x 25" 75.6cm x 63.5cm	2	100 lbs 45 kg
N8043	43.5" 110.5cm	9.82" 24.9cm	11.31" 28.7cm	42.50" x 25" 107.9cm x 63.5cm	3	118 lbs 53 kg
N8056	56.25" 142.9cm	9.82" 24.9cm	17.69" 44.9cm	55.25" x 25" 140.3cm x 63.5cm	4	145 lbs 65 kg
N8069	69" 175.3cm	9.82" 24.9cm	24.06" 61.1cm	68" x 25" 172.7cm x 63.5cm	5	164 lbs 74 kg
N8081	81.75" 208cm	9.82" 24.9cm	30.43" 77.3cm	80.75" x 25" 205.1cm x 63.5cm	6	190 lbs 86 kg



PROJECT	
ITEM #	
QUANTITY	DATE
APPROVAL	

# N8000N

## Narrow Drop-In Ice Cooled Cold Pans

### Short Form Specifications

Top is one piece 20-gauge stainless steel. Interior liner is 22-gauge stainless steel and is creased to 1.00" (2.54 cm) diameter drain. Unit shall have a sectional, removable perforated stainless steel false bottom. Unit shall be provided with adapter bars to allow placement of 12" x 20" (30.5 cm x 50.8 cm) pans. Unit is supplied with 1" (2.54 cm) plastic drain to be installed by customer. Exterior housing shall be 22-gauge galvanized steel. Unit shall be insulated with high density closed cell polyurethane.

### Optional Accessories & Modifications

- Custom sizes and styles
- Single or double service flip-up sneezeguards



**Model N8046N**  
(pans by others)

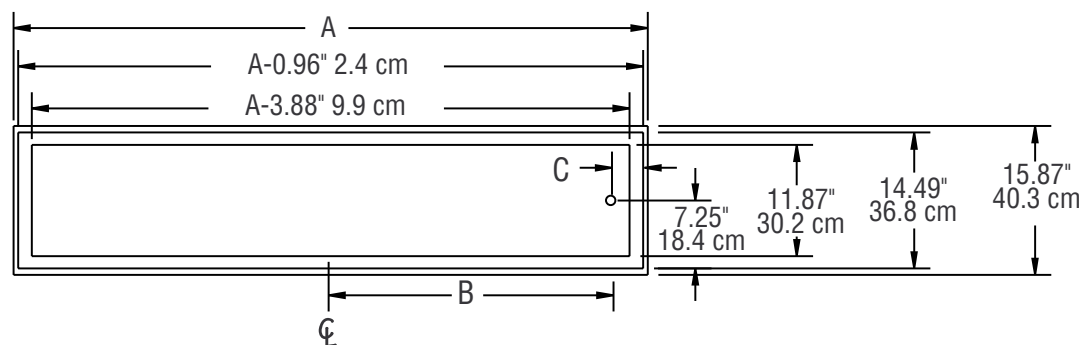

TYPICAL PLAN VIEW

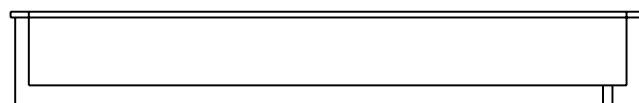

TYPICAL ELEVATION VIEW

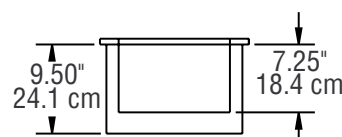

TYPICAL END VIEW

### Mechanical Data: Standard Unit

MODEL NUMBER	A	B	C	COUNTER CUTOUT DIMENSIONS (D x L)	# OF 12" X 20" PANS HELD	SHIPPING WEIGHT
N8046N	46.75" 118.75 cm	14.41" 36.60 cm	8.25" 20.95 cm	17" x 45.75" 43.18 cm x 116.20 cm	2	100 lbs 46 kg
N8068N	67.5" 171.5cm	14.41" 36.60 cm	18.64" 47.35 cm	17" x 66.50" 43.18 cm x 168.91 cm	3	120 lbs 55 kg

