



E-Chef™ Series

Installation and Operation Manual

Please read this manual completely before attempting to install or operate this equipment! **Notify carrier of damage!** Inspect all components immediately. See page 2.



Effective December 2007

Enodis®

CONTENTS

| | |
|---|-------|
| SERIAL NUMBER LOCATION..... | 2 |
| RECEIVING & INSPECTING | 2 |
| SPECIFICATIONS | 3 |
| INSTALLATION | 4 |
| OPERATION | 5 |
| MAINTENANCE..... | 6 |
| WIRING DIAGRAMS | 7 |
| DELFIELD FOOD WARMER (DFW) ASSEMBLIES with infinite control..... | 8 |
| REPLACEMENT PARTS LISTS | 9 |
| STANDARD WARRANTY | 10-12 |

SERIAL NUMBER LOCATION

The serial number on all E-Chef™ Series models is printed on the tag located on the plate shelf.

Always have the serial number of your unit available when calling for parts or service. A complete list of authorized Delfield parts depots is shown on the back cover of this manual.

©2007 The Delfield Company. All rights reserved. Reproduction without written permission is prohibited. "Delfield" is a registered trademark of The Delfield Company.

RECEIVING AND INSPECTING THE EQUIPMENT

Even though most equipment is shipped crated, care should be taken during unloading so the equipment is not damaged while being moved into the building.

1. Visually inspect the exterior of the package and skid or container. Any damage should be noted and reported to the delivering carrier immediately.
2. If damaged, open and inspect the contents with the carrier.
3. In the event that the exterior is not damaged, yet upon opening, there is concealed damage to the equipment notify the carrier. Notification should be made verbally as well as in written form.
4. Request an inspection by the shipping company of the damaged equipment. This should be done within 10 days from receipt of the equipment.

5. Check the lower portion of the unit to be sure legs or casters are not bent.
6. Also open the compressor compartment housing and visually inspect the refrigeration package. Be sure lines are secure and base is still intact.
7. Freight carriers can supply the necessary damage forms upon request.
8. Retain all crating material until an inspection has been made or waived.

Uncrating the Equipment

First cut and remove the banding from around the crate. Remove the front of the crate material, use of some tools will be required. If the unit is on legs remove the top of the crate and lift the unit off the skid. If the unit is on casters it can be "rolled" off the skid.

SPECIFICATIONS

| MODEL NUMBER | OVERALL | | | VOLTS | AMPS | HZ | PHASE |
|--|---------|-------|-----|-------|------|-----|-------|
| | L | D | H | | | | |
| OPENSHELF MODULES | | | | | | | |
| ECOS24 | 24" | 31.5" | 36" | N/A | N/A | N/A | N/A |
| ECOS36 | 36" | 31.5" | 36" | N/A | N/A | N/A | N/A |
| ECOS48 | 48" | 31.5" | 36" | N/A | N/A | N/A | N/A |
| ESOS24 | 24" | 20" | 34" | N/A | N/A | N/A | N/A |
| ESOS27 | 27" | 20" | 34" | N/A | N/A | N/A | N/A |
| ESOS32 | 32" | 20" | 34" | N/A | N/A | N/A | N/A |
| ESOS36 | 36" | 20" | 34" | N/A | N/A | N/A | N/A |
| ESOS48 | 48" | 20" | 34" | N/A | N/A | N/A | N/A |
| ESOS60 | 60" | 20" | 34" | N/A | N/A | N/A | N/A |
| ESOS64 | 64" | 20" | 34" | N/A | N/A | N/A | N/A |
| ESOS72 | 72" | 20" | 34" | N/A | N/A | N/A | N/A |
| ESOS74 | 74" | 20" | 34" | N/A | N/A | N/A | N/A |
| SINK MODULE | | | | | | | |
| ECSR24 | 24" | 31.5" | 36" | N/A | N/A | N/A | N/A |
| DOUBLE-TIER CANTILEVERED OVERSHELF ON OPENSHELF MODULE | | | | | | | |
| EODC24 | 24" | 28" | 70" | N/A | N/A | N/A | N/A |
| EODC27 | 27" | 28" | 70" | N/A | N/A | N/A | N/A |
| EODC32 | 32" | 28" | 70" | N/A | N/A | N/A | N/A |
| EODC36 | 36" | 28" | 70" | N/A | N/A | N/A | N/A |
| EODC48 | 48" | 28" | 70" | N/A | N/A | N/A | N/A |
| EODC60 | 60" | 28" | 70" | N/A | N/A | N/A | N/A |
| EODC64 | 64" | 28" | 70" | N/A | N/A | N/A | N/A |
| EODC72 | 72" | 28" | 70" | N/A | N/A | N/A | N/A |
| EODC74 | 74" | 28" | 70" | N/A | N/A | N/A | N/A |
| SOUPWELL MODULE | | | | | | | |
| ESSW36 | 36" | 20" | 34" | 120 | 8.3 | 60 | 1 |
| DOUBLE-TIER CANTILEVERED OVERSHELF ON SOUPWELL MODULE | | | | | | | |
| EODC36S | 36" | 28" | 70" | 120 | 8.3 | 60 | 1 |
| ICE PAN MODULE | | | | | | | |
| ESIC36 | 36" | 20" | 34" | N/A | N/A | N/A | N/A |
| DOUBLE-TIER CANTILEVERED OVERSHELF ON ICE PAN MODULE | | | | | | | |
| EODC36I | 36" | 28" | 70" | N/A | N/A | N/A | N/A |
| MICROWAVE OVERSHELF | | | | | | | |
| EOSM24 | 24" | 24" | 20" | N/A | N/A | N/A | N/A |

| MODEL NUMBER | OVERALL | | | # OF WELLS | VOLTS | AMPS | HZ | PHASE | NEMA PLUG |
|-----------------|---------|-------|-----|------------|---------|-----------|----|-------|-----------|
| | L | D | H | | | | | | |
| HOT FOOD TABLES | | | | | | | | | |
| EHEI36L | 36" | 31.5" | 36" | 2 | 120 | 17.0 | 60 | 1 | 5-30P |
| EHEI48L | 48" | 31.5" | 36" | 3 | 208/230 | 15.0/16.0 | 60 | 1 | 6-20P |
| EHEI60L | 60" | 31.5" | 36" | 4 | 208/230 | 20.0/22.0 | 60 | 1 | 6-30P |
| EHEI74L | 74" | 31.5" | 36" | 5 | 208/230 | 24.0/27.0 | 60 | 1 | 6-50P |
| EHEI36C | 36" | 31.5" | 36" | 2 | 120 | 17.0 | 60 | 1 | 5-30P |
| EHEI48C | 48" | 31.5" | 36" | 3 | 208/230 | 15.0/16.0 | 60 | 1 | 6-20P |
| EHEI60C | 60" | 31.5" | 36" | 4 | 208/230 | 20.0/22.0 | 60 | 1 | 6-30P |
| EHEI74C | 74" | 31.5" | 36" | 5 | 208/230 | 24.0/27.0 | 60 | 1 | 6-50P |



INSTALLATION



Maximum weight for openshelves and over shelves is 250 pounds. Overloading shelves can damage equipment or cause bodily injury.

INSTALLATION: ESSW36 & EODC36S SERIES (ELECTRIC)



Installation should only be done by personnel certified and licensed to install and maintain electrical appliances.

Location

Intended for indoor use only. Do not install the hot food table near any combustible objects or surfaces affected by heat or moisture.



Flanged feet must be fastened to the floor.

Leveling

This unit must be level, both front and back and left to right, in order to maintain an equal water depth throughout the wells.

Plumbing

A waste connection is provided 26.5" (67.3cm) above the floor, 1/2" from the gate valve. You must supply the required 1/2" connection at gate valve.

Electrical connection



Connections must be made in accordance with all applicable local codes and/or the National Electrical Code. Refer to the wiring diagrams on page 10.

INSTALLATION: ESIC36 & EODC36I SERIES

Plumbing

The unit's drain must have an outlet to an appropriate drainage area or container. The 1" IPC piece drain is shipped loose and must be connected during installation.

INSTALLATION: EHEI SERIES (ELECTRIC)



Installation should only be done by personnel certified and licensed to install and maintain electrical appliances.

Location

Intended for indoor use only. Do not install the hot food table near any combustible objects or surfaces affected by heat or moisture.

Leveling

This unit must be level, both front and back and left to right, in order to maintain an equal water depth throughout the wells.

Plumbing

A waste connection is provided 26.5" (67.3cm) above the floor, 5.25" (13.3cm) from the right end. You must supply the required 1/2" connection at gate valve.

Electrical connection



Connections must be made in accordance with all applicable local codes and/or the National Electrical Code. Refer to the wiring diagrams on page 10.

OPERATION: ESSW36, EODC36S & EHEI SERIES (ELECTRIC)

Before the unit is used the first time for serving, turn the temperature knob to HIGH and heat the well for 30 minutes. Any residue or dust that adhered to the heater element(s) will burn off during this initial preheat period.

When using thick sauces always operate the hot food well filled with water. This will provide a more uniform temperature for the sauce.



WEAR

Steam can cause serious burns. Always wear some type of protective covering on your hands and arms when removing lids or pans from the unit. Lift the lid or pan in a way that will direct escaping steam away from your face and body.



CAUTION

Never place food directly into the well. Always use pans.

Although these models may be operated either with or without water in the wells, wet operation is recommended.

Always place covers on pans when not serving to prevent food from drying out and to reduce your operating cost.

For most efficient operation when empty, keep covered insets in each well during preheating and when the well is not in use.

Do not put food down drain.

Wet operation



STEPS

- 1) Fill food well with two inches of water. For quicker pre-heating, use hot water to fill the well.
- 2) Turn the control to "HIGH" and pre-heat the warmer for 30 minutes.
- 3) After pre-heating, set the control to your desired serving temperature.

Dry operation



STEPS

- 1) Pre-heat the well on "HIGH" for approximately 15 minutes.
- 2) After pre-heating, set the control to your desired serving temperature.

Only 6" (15.2cm) deep insets should be used with a dry food well. When operated dry, the bottom of the food well will discolor. A mild abrasive cleaner is recommended to clean this discoloration.

Temperature

Water in wells 160°F to 180°F

Product in pans 140°F to 160°F

MAINTENANCE

The exterior can be cleaned using mild soap and warm water. If this is not sufficient try ammonia and water or a non-abrasive liquid cleaner. When cleaning the exterior, always rub with the grain of the stainless steel to avoid marring the finish. Do not use an abrasive cleaner because it will scratch the stainless steel. A stainless steel cleaner or polish may be used to eliminate water spotting and fingerprints and bring out the finish of the exterior. The interior of the food wells should be cleaned daily with a non-abrasive cleaner and non-abrasive pad. If necessary, a mild abrasive may be used on the interior of the pans only. Hard water stains and lime scaling may require a special cleaning product. Never use steel wool.

Cleaning solutions need to be alkaline based or non-chloride cleaners. Any cleaner containing chlorides will damage the protective film of the stainless steel. Chlorides are also commonly found in hard water, salts, and household and industrial cleaners. If cleaners containing chlorides are used be sure to rinse repeatedly and dry thoroughly upon completion. Routine cleaning of stainless steel can be done with soap and water. Extreme stains or grease should be cleaned with a non-abrasive cleaner and plastic scrub pad. It is always good to rub with the grain of the steel. There are also stainless steel cleaners available which can restore and preserve the finish of the steels protective layer. Early signs of

stainless steel breakdown can consist of small pits and cracks. If this has begun, clean thoroughly and start to apply stainless steel cleaners in attempt to restore the passivity of the steel.



Do not use a hose or pressure washer on these units. The water will damage the electrical components.

WIRING DIAGRAMS: ESSW36 & EODC36S

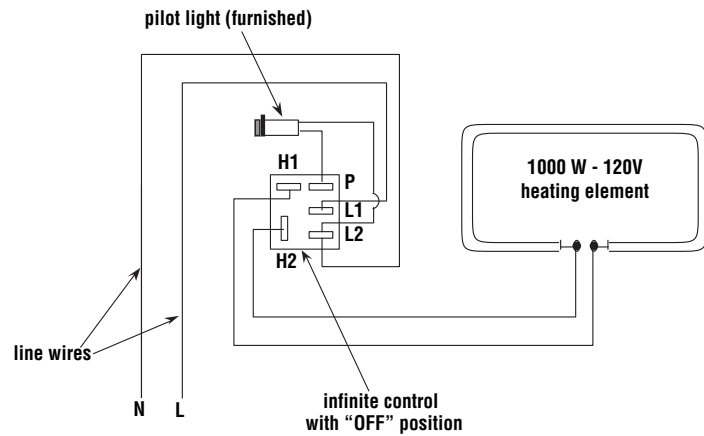
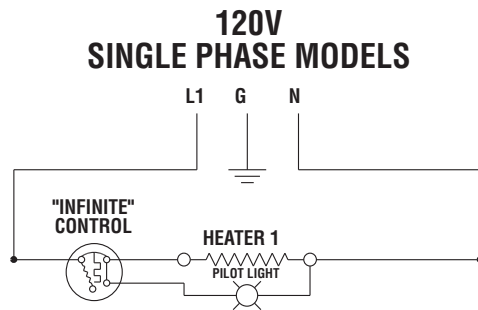

WIRING DIAGRAMS: EHEI

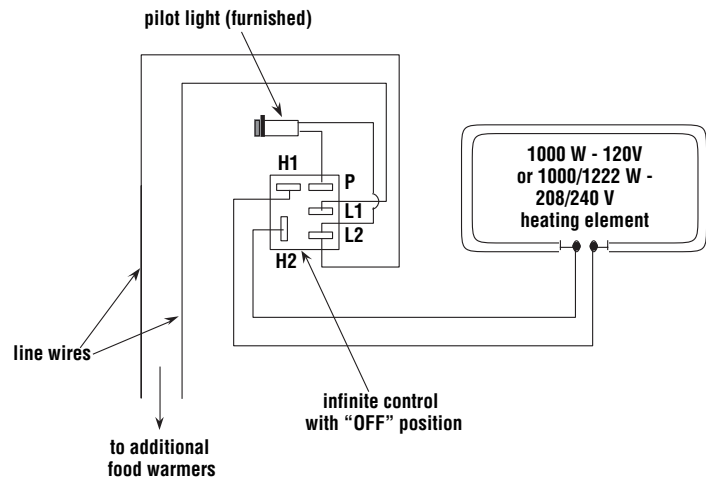
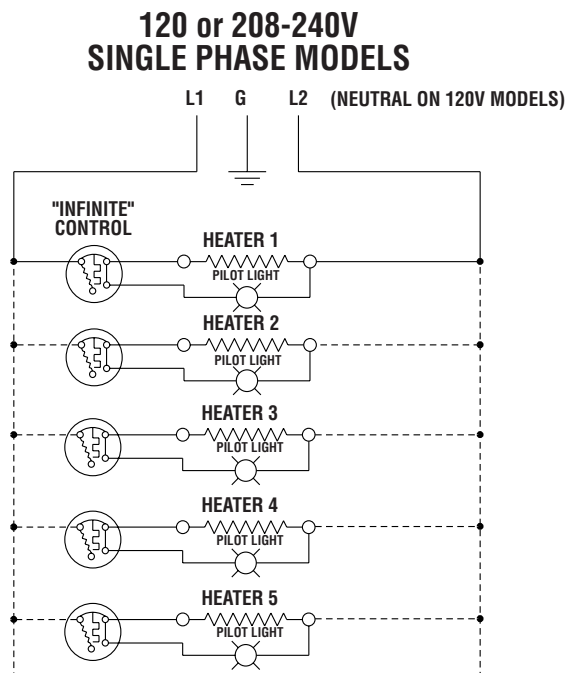

DELFIELD FOOD WELL (DFW) ASSEMBLY: WITH INFINITE CONTROL

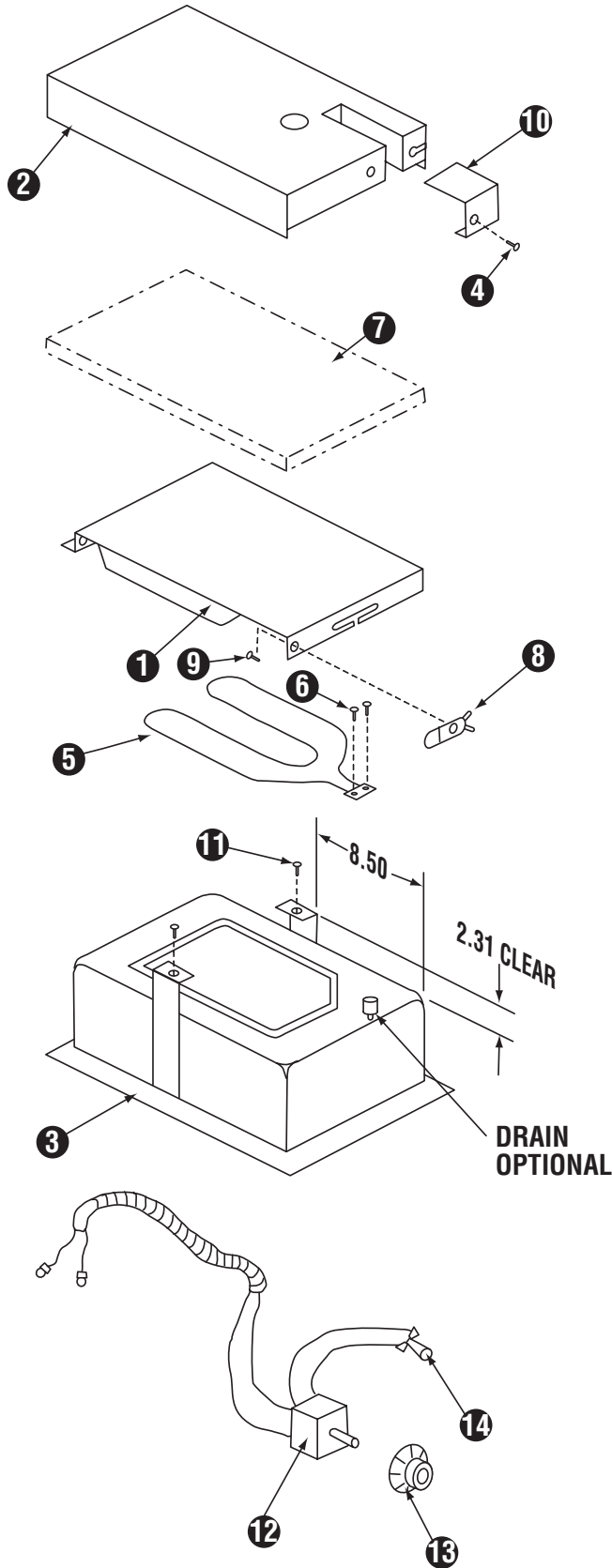

INFINITE
CONTROL

| KEY | PART NAME | DELFIELD PART # |
|-----|---|-----------------|
| | Complete assembly, 120V, infinite w/drain | 000-516-0000 |
| | Complete assembly, 120V, infinite w/o drain | 000-517-0000 |
| | Complete assembly, 208V, infinite w/drain | 000-518-0000 |
| | Complete assembly, 208V, infinite w/o drain | 000-519-0000 |
| 1 | Deflector plate | 026-061-0001 |
| 2 | Bottom cover | 026-103-0001 |
| 3 | Food well, with drain | 323-4361 |
| | Food well, without drain | 323-4362 |
| 4 | Screw | 932-1353 |
| 5 | Element, 120V | 219-4006 |
| | Element, 208V | 219-4007 |
| 6 | Screws (2) | 932-1379 |
| 7 | Insulation | 343-4663 |
| 8 | Thermostat non-adjustable | 219-4335 |
| 9 | Screw | 932-1007 |
| 10 | Drain cover | 027-210-0001 |
| 11 | Screws (2) | 932-1007 |
| 12 | Infinite control, 120V | 219-4107 |
| | Infinite control, 240V | 219-4110 |
| 13 | Infinite control knob | 323-4557 |
| 14 | Pilot light, red, 120V | 219-4190 |
| | Pilot light, amber, 240V | 219-4095 |

MISCELLANEOUS PARTS LISTS

ESSW36 & EODC36S Series (electric)

| PART NAME | DELFIELD PART # |
|----------------------------|-------------------|
| Bullet feet (4) | 3234224 |
| Casters | 3234160 & 3234161 |
| Leg | 3234645 |
| Gate valve, 1/2" | 3547486 |
| Flanged feet | 3234339 |
| 1" plastic drain | 3234242 |

EHEI Series (electric)

| PART NAME | DELFIELD PART # |
|--|-----------------|
| Cutting board pin cap. | 1701000 |
| Cutting board pin screw. | 9321076 |
| Brass cutting board hinge pin | 3234360 |
| Polyethylene board, model EHEI36 | 096-004-0031 |
| Polyethylene board, model EHEI48 | 096-004-0032 |
| Polyethylene board, model EHEI60 | 096-004-0033 |
| Polyethylene board, model EHEI74 | 096-004-0034 |

ACCESSORY MODELS

| MODEL # | NAME |
|---------|--|
| EORW14 | Top shelf vertical raceway, 14" |
| EORW18 | Bottom shelf vertical raceway, 18" |
| EORW24 | Top shelf to ceiling vertical raceway, 24" |
| EORW36 | Top shelf to ceiling vertical raceway, 36" |
| EORW48 | Top shelf to ceiling vertical raceway, 48" |
| ESRW24 | Server side horizontal raceway, 24" |
| ESRW27 | Server side horizontal raceway, 27" |
| ESRW32 | Server side horizontal raceway, 32" |
| ESRW36 | Server side horizontal raceway, 36" |
| ESRW48 | Server side horizontal raceway, 48" |
| ESRW60 | Server side horizontal raceway, 60" |
| ESRW64 | Server side horizontal raceway, 64" |
| ESRW72 | Server side horizontal raceway, 72" |
| ESRW74 | Server side horizontal raceway, 74" |
| ECFP | Stainless steel end filler panel |
| ECPB114 | Stainless steel flashing, PTB, rail |
| ECPB99 | Stainless steel flashing, PTB, rail |
| ECPB91 | Stainless steel flashing, PTB, rail |
| ECPB72 | Stainless steel flashing, PTB, rail |
| ECPB60 | Stainless steel flashing, PTB, rail |
| ECPB48 | Stainless steel flashing, PTB, rail |



STANDARD LABOR GUIDELINES TO REPAIR OR REPLACE PARTS ON DELFIELD EQUIPMENT

Advice and recommendations given by Delfield Service Technicians do not constitute or guarantee any special coverage.

- A maximum of 1-hour is allowed to **diagnose a defective component**.
- A maximum of 1-hour is allowed for **retrieval of parts** not in stock.
- A maximum **travel distance** of 100 miles round trip and 2-hours will be reimbursed.
- Overtime, installation/start-up, normal control adjustments, general maintenance, glass breakage, freight damage, and/or correcting and end-user installation error will not be reimbursed under warranty unless pre-approved with a **Service Work Authorization** from Delfield. You must submit the number with the service claim.

LABOR OF 1-HOUR IS ALLOWED TO REPLACE:

- Contactor/Relay
- Infinite Switch
- Hi-limit/Thermal Protector Switch
- Water Level Sensor/Probe

LABOR OF 2 HOURS TO REPLACE:

- Heating Element
- Solenoid Valve

STANDARD ONE YEAR WARRANTY (ONE YEAR PARTS AND LABOR.)

The Delfield Company ("Delfield") warrants to the Original Purchaser of the Delfield product (herein called the "Unit") that such Unit, and all parts thereof, will be free from defects in material and workmanship under normal use and service for a period of one (1) year from the date of shipment of the Unit to the Original Purchaser **or, if the Original Purchaser returns the warranty card completely filled out including the date of installation within thirty (30) days of receipt of the Unit, one (1) year from the date of installation.** During this one year warranty period, Delfield will repair or replace any defective part or portion thereof returned to Delfield by the Original Purchaser which Delfield determines was defective due to faulty material or workmanship. The Original purchaser will pay all labor, crating, freight and related costs incurred in the removal of the Unit of defective component and shipment to Delfield, except that during a period of either ninety (90) days from the date of shipment of the Unit to the Original Purchaser or, if the Original Purchaser returns the warranty card completely filled out including the date of installation within thirty (30) days of receipt of the Unit, ninety (90) days from the date of installation Delfield will pay all related labor costs. Delfield will pay the return costs if the Unit or part thereof was defective.

The term "Original Purchaser" as used herein means that person, firm, association, or corporation for whom the Unit was originally installed.

This warranty does not apply to any Unit or part thereof that has been subjected to misuse, neglect, alteration, or accident, such as accidental damage to the exterior finish, operated contrary to the recommendations specified by Delfield; or repaired or altered by anyone other than Delfield in any way so as to, in Delfield's sole judgement, affect its quality or efficiency. This warranty does not apply to any Unit that has been moved from the location where it was originally installed. This warranty also does not cover the refrigerator drier or the light bulbs used in the Unit. **The warranty is subject to the user's normal maintenance and care responsibility as set forth in the Service and Installation Manual, such as cleaning the condenser coil, and is in lieu of all other obligations of Delfield. Delfield neither assumes, nor authorizes any other person to assume for Delfield, any other liability in connection with Delfield's products.**

Removal or defacement of the original Serial Number or Model Number from any Unit shall be deemed to release Delfield from all obligations hereunder or any other obligations, express or implied.

Parts furnished by suppliers to Delfield are guaranteed by Delfield only to the extent of the original manufacturer's express warranty to Delfield. Failure of the Original Purchaser to receive such manufacturer's express warranty to Delfield. Failure of the Original Purchaser to receive such manufacturer's warranty shall in no way create any warranty, expressed or implied, or any other obligation or liability on Delfield's part in respect thereof.

IF THE CUSTOMER IS USING A PART THAT RESULTS IN A VOIDED WARRANTY AND A DELFIELD AUTHORIZED REPRESENTATIVE TRAVELS TO THE INSTALLATION ADDRESS TO PERFORM WARRANTY SERVICE, THE SERVICE REPRESENTATIVE WILL ADVISE CUSTOMER THE WARRANTY IS VOID. SUCH SERVICE CALLS WILL BE BILLED TO CUSTOMER AT THE AUTHORIZED SERVICE CENTER'S THEN APPLICABLE TIME AND MATERIALS RATES. CONSIDER: CUSTOMER MAY INITIATE A SERVICE AGREEMENT WITHOUT PARTS COVERAGE.

If shipment of a replacement part is requested prior to the arrival in the Delfield factory of the part claimed to be defective, the Original Purchaser must accept delivery of the replacement part of a C.O.D.

basis, with credit being issued after the part has been received inspected at Delfield's plant and determined by Delfield to be a warranty.

Under no condition does this warranty give the Original Purchaser right to replace the defective Unit with a complete Unit of the same manufacturer or of another make. Unless authorized by Delfield in writing, this warranty does not permit the replacement of any part, including the motor-compressor, to be made with the part of another make or manufacturer.

No claims can be made under this warranty for spoilage of any food for any reason, including system failure.

The installation contractor shall be responsible for building access entrance and field conditions to insure sufficient clearance to a hood(s), vent(s), or Unit(s) if necessary, to be brought into the building. Delfield will not be responsible for structural changes or damage incurred during installation of the Unit or any exhaust system.

Delfield shall not be liable in any manner for any default or delinquency in performance hereunder caused by or resulting from any condition beyond Delfield's control, including, but not limited to, war, governmental restrictions or restraints, strike, lockouts, injunction, fire, flood, acts of nature, short or reduced supply of raw materials, or discontinuance of the parts by the original part manufacturer.

Except as provided in any Additional Four Year Protection Plan, if applicable, and the Service Labor Contract, if applicable, the foregoing is exclusive and in lieu of all other warranties, written or oral, express or implied. This warranty supersedes and excludes any prior oral or written representations or warranties. Delfield expressly disclaims any implied warranty of merchantability, fitness for a particular purpose or compliance with any law, treaty, rule or regulation relating to the discharge of substances into the environment. The sole and exclusive remedy of any person relating to the Unit, and the full liability of Delfield in any breach of this warranty, will be as provided in this warranty.

Other than this Delfield Standard One Year Limited Warranty, an applicable Delfield Additional Four Year Protection Plan or applicable Delfield Service Labor Contract, the Original Purchaser agrees and acknowledges that no other warranties are offered or provided in connection with or for the unit or any other part thereof.

In no event will Delfield be liable for special, incidental or consequential damages, or for damages in the nature of penalties.

IF DURING THE WARRANTY PERIOD, CUSTOMER USES A PART THAT IS NOT THIS DELFIELD EQUIPMENT OTHER THAN AN UNMODIFIED OR RECYCLED PART PURCHASED DIRECTLY FROM DELFIELD, OR ANY OF ITS AUTHORIZED SERVICE CENTERS AND/OR THE PART BEING USED IS MODIFIED FROM ITS ORIGINAL CONFIGURATION, THIS WARRANTY WILL BE VOID. FURTHER, DELFIELD AND AFFILIATES WILL NOT BE LIABLE FOR ANY CLAIMS, DAMAGES, OR EXPENSES INCURRED BY THE CUSTOMER WHICH ARISE DIRECTLY OR INDIRECTLY, IN WHOLE OR IN PART, DUE TO THE INSTALLATION OF ANY MODIFIED PART AND/OR PART RECEIVED FROM AN UNAUTHORIZED SERVICE CENTER. If the warranty becomes void, the Customer may purchase from Delfield, if available, a Service Agreement or service at the then current time and materials rates.

For more information on Delfield warranty's log on and check the service section of our web site at www.delfield.com.



ADDITIONAL FOUR YEAR PROTECTION PLAN (for Motor-Compressor only)

| Delfield Model# | Serial # | Installation Date |
|----------------------|----------------------|----------------------|
| <input type="text"/> | <input type="text"/> | <input type="text"/> |

In addition to the Standard One Year Warranty on the Motor-Compressor contained in the above listed Delfield product (the "Unit"), The Delfield Company ("Delfield") also agrees to repair, or exchange with similar or interchangeable parts in design and capacity at Delfield's option, the defective Motor-Compressor contained in the Unit (the "Motor-Compressor"), or any part thereof, for the Original Purchaser only, at any time during the four (4) years following the initial one (1) year period commencing on the date of installation for the Original Purchaser. **Failure of the Original Purchaser to register the registration card containing the Original Purchasers name, address, date of installation, model number and serial number of the Unit containing the Motor-Compressor within 30 days from the date of installation shall void this warranty.** This additional warranty is only available if the Motor-Compressor is inoperative due to defects in material or factory workmanship, as determined by Delfield in its sole judgement and discretion. The Original Purchaser shall be responsible for returning the defective Motor-Compressor to Delfield prepaid, F.O.B. at the address shown on the back cover of this manual.

The term "Original Purchaser" as used herein means that person, firm, association, or corporation for whom the Unit was originally installed.

The term "Motor-Compressor" as used herein does not include unit base, air or water cooled condenser, receiver, electrical accessories such as relay, capacitors, refrigerant controls, or condenser fan/motor assembly. This warranty does not cover labor charges incidental to the replacement of parts. This warranty further does not include any equipment to which said condensing unit is connected, such as cooling coils, temperature controls or refrigerant metering devices. This warranty shall be void if the Motor-Compressor, in Delfield's sole judgement, has been subjected to misuse, neglect, alteration or accident, operated contrary to the recommendations specified by the Unit manufacturer, repaired or altered by anyone other than Delfield in any way so as, in Delfield's sole judgment, to affect its quality or efficiency or if the serial number has been altered, defaced or removed. This Warranty does not apply to a Motor-Compressor in any Unit that has been moved from the location where it was originally installed. The addition of methyl chloride to the condensing unit or refrigeration system shall void this warranty.

General Conditions

Delfield shall not be liable in any manner for any default or delay in performance hereunder caused by or resulting from any contingency beyond Delfield's control, including, but not limited to, war, governmental restrictions or restraints, strike, lockouts, injunctions, fire, flood, acts of nature, short or reduced supply of raw materials, or discontinuance of any part or the Motor-Compressor by the unit manufacturer.

Replacement of a defective Motor-Compressor is limited to one (1) Motor-Compressor by us during the four (4) year period. Delfield shall replace the Motor-Compressor at no charge.

This warranty does not give the Original Purchaser of the Motor-Compressor the right to purchase a complete replacement Motor-Compressor of the same make or of another make. It further does not permit the replacement to be made with a Motor-Compressor of another kind unless authorized by Delfield. In the event Delfield authorizes the Original Purchaser to purchase a replacement Motor-Compressor locally, only the wholesale cost of the Motor-Compressor is refundable.

Expressly excluded from this warranty are damages resulting from spoilage of goods.

Except as provided in any applicable Standard One Year Limited Warranty or applicable Service Labor Contract, the foregoing is exclusive and in lieu of all other warranties, whether written or oral, express or implied. This Warranty supersedes and excludes any prior oral or written representations or warranties. Delfield expressly disclaims any implied warranties of merchantability, fitness for a particular purpose or compliance with any law, treaty, rule or regulation relating to the Motor-Compressor, and the full liability of Delfield for any breach of this warranty, will be as provided in this warranty.

Other than any applicable Delfield Standard One year Limited Warranty, this Delfield Additional Four Year Protection Plan and any applicable Delfield Service Labor Contract, the Original Purchaser agrees and acknowledges that no other warranties are offered or provided in connection with or for the Motor-Compressor or any part thereof.

In no event will Delfield be liable for special, incidental or consequential damages, or for damages in the nature of penalties.

NOTES:



NOTES:

NOTES:





Mt. Pleasant, MI



Covington, TN

Thank you for choosing Delfield!

Help is a phone call away. Help our team of professional, courteous customer service reps by having your model number and serial number available at the time of your call (800) 733-8829.

Model: _____ S/N: _____

Installation Date: _____



**For a list of Delfield's authorized parts depots,
visit our website at www.delfield.com.**

