

SPCS, SPCS-E

Cashier Counter, 30" Depth

Project _____
Item _____
Quantity _____
CSI Section 11400
Approved _____
Date _____

SPCS, SPCS-E: Cashier Counter, 30" Depth

Models

- SPCS-30 Cashier counter module, 34" height, 30" length
- SPCS-30E Cashier counter module, 30" height, 30" length
- SPCS-36 Cashier counter module, 34" height, 36" length
- SPCS-36E Cashier counter module, 30" height, 36" length



SPCS-30

Standard Features

- 14-gauge stainless steel top standard
- SPCS: 34" counter height, 30" depth
- SPCS-E: 30" counter height, 30" depth
- 18-gauge stainless steel exterior standard
- Full NSF and UL certification
- A wide selection of laminate colors available at no additional charge
- Laminate selection has 18-gauge galvanized base, 16-gauge coved corner supports to protect laminate
- Standard on 5" diameter polyurethane swivel casters
- Stainless steel fully retractable interlock provided as standard
- A 2" ferruled hole is located at the rear of the top to allow cord access for cash register
- Stainless steel locking cash drawer standard
- Stainless steel under shelf can serve as foot rest or storage
- Add eye catching decal packages or bright canopies to create a distinctive look
- One year parts and 90 day labor standard warranty

Options & Accessories

- Tray slides
 - V-style
 - Tubular bar
 - Line up interlock device
 - (3) 1/3 x 6" deep pans
 - Decal package
 - Canopy
 - Silverware cutouts with stainless steel bin
 - Bullet feet
 - 115V/15A convenience outlet with 10A breaker*
- * Inclusion of these options will alter the electrical specifications of the unit

Specifications

Exterior: Exterior body is constructed of 18-gauge stainless steel side panels or 18-gauge galvanized reinforced laminate panels. 14-gauge galvanized bottom. All exterior side panels are reinforced with overlapping corners and are welded in place. All insert cutouts are reinforced with 14-gauge galvanized channel supports.

Exterior top: is constructed of 14-gauge stainless steel, welded, ground and polished into one integral unit. Top is fabricated with square exterior corners with fully hemmed nosing on all sides. Stainless steel fully retractable interlocks are installed on opposing corners and locks units into a complete serving system.

Interior Lining: At the cashier's end is an 18-gauge stainless steel liner, with a stainless steel bottom shelf. Unit has an 16.5" x 16.5" x 5" (42cm x 42cm x 12.7cm) stainless steel cash drawer with lock and key.

Casters: Unit is mounted on 5" (12.7cm) diameter swivel polyurethane casters with non-marking tires and plate brakes. Casters are bolted directly to the 14-gauge bottom of the base. Overall height of caster assembly is 6.00" (15.2cm).

Styling: Units are standard with 18-gauge stainless steel exterior sides. Laminate is an option available at no additional charge. Decal packages and canopies are also available.

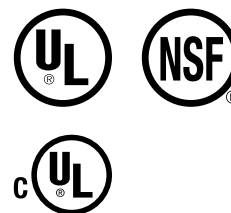

SPCS, SPCS-E

Cashier Counter, 30" Depth

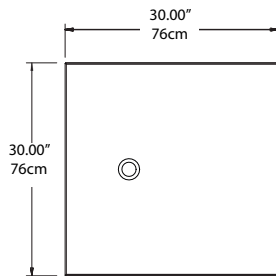

Plan View SPCS-30, SPCS-30E

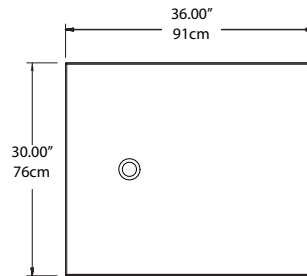

Plan View SPCS-36, SPCS-36E

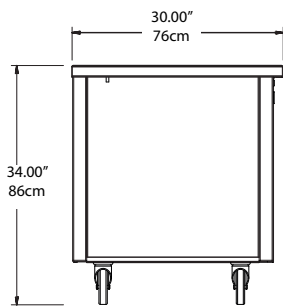

Elevation View SPCS-30

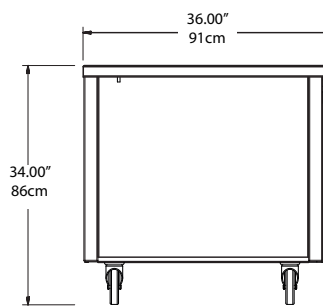

Elevation View SPCS-36

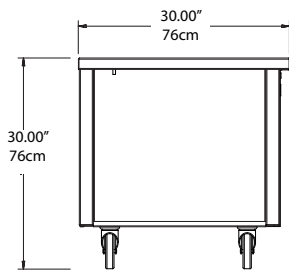

Elevation View SPCS-30E

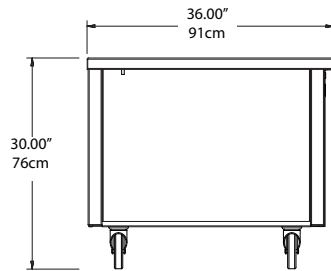

Elevation View SPCS-36E

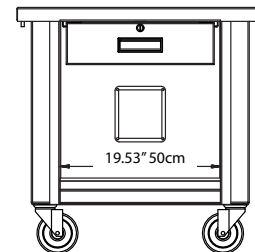

Right End View
All Models

Specifications				
Model	L	D	H	Ship Weight
SPCS-30	30.00"/76cm	30.00"/76cm	34.00"/86cm	180lbs/82kg
SPCS-30E	30.00"/76cm	30.00"/76cm	30.00"/76cm	180lbs/82kg
SPCS-36	36.00"/91cm	30.00"/76cm	34.00"/86cm	210lbs/95kg
SPCS-36E	36.00"/91cm	30.00"/76cm	30.00"/76cm	210lbs/95kg

Delfield reserves the right to make changes to the design or specifications without prior notice.