

KCFT-NU

Mobile Self-Contained Frost Top Serving Counter

Project _____
Item _____
Quantity _____
CSI Section 11400
Approved _____
Date _____

Models

- KCFT-36-NU - 36" Mobile frost top serving counter without understorage
- KCFT-50-NU - 50" Mobile frost top serving counter without understorage
- KCFT-60-NU - 60" Mobile frost top serving counter without understorage
- KCFT-74-NU - 74" Mobile frost top serving counter without understorage
- KCFT-96-NU - 96" Mobile frost top serving counter without understorage



KCFT-74-NU

Standard Features

- One piece, molded fiberglass base, fully rounded corners, permanent color
- All corners and center sides reinforced with galvanized bracing, laminated into the fiberglass
- 14-gauge tops
- Standard on 5" diameter polyurethane swivel casters for easy cleaning
- Caster mounting plates laminated into base
- Easy to use stainless steel interlock system is standard on base and tray slides
- A maximum 10' long cord and plug
- Frost top is 18-gauge stainless steel, one piece construction; perimeter drain with valve located at bottom of unit standard
- 18"x 26" sheet pan can rest on frost top
- On/off switch located on exterior of unit
- All body cutouts reinforced with 14-gauge channel supports
- Environmentally friendly R404A refrigerant
- One year parts and 90 day labor standard warranty

Options & Accessories

- Tray slides and work shelves
 - 10" (25.4cm) wide composite fold-down cutting boards
 - Line-up interlock device
 - Food shields
 - Glass-front counter protector
 - 12" (30.5cm) wide 18-gauge stainless steel overshell
 - Fluorescent or incandescent light fixtures*
 - Open understorage with shelf
 - 120V/60Hz/1ø, 10 amp convenience outlet with breaker*
 - Dry storage compartment
 - Stainless steel trim strips
 - 14" x 30" (35.6cm x 76.2cm) stainless steel end drop shelf
 - Molded fiberglass trim strips
 - 6" (15.2cm) high adjustable stainless steel legs in lieu of casters
- * Inclusion of these options will alter the electrical specifications of unit

Specifications

Exterior body is seamless, one-piece molded fiberglass, having perfectly smooth exterior surface with all corners fully rounded. The fiberglass reinforced polyester (F.R.P.) is molded with permanent color. Stress points are internally reinforced.

Exterior top is constructed of 14-gauge stainless steel, welded, ground and polished into one integral unit. Top is fabricated with square exterior corners.

Frost top is 18-gauge stainless steel, one-piece construction and perimeter trough. Underside of frost top is sealed with refrigeration lines and insulated with high-density, closed cell environmentally friendly, Kyoto Protocol Compliant, Non ODP (Ozone Depletion Potential), Non GWP (Global Warming Potential) polyurethane. Frost top assembly is enclosed in a galvanized steel jacket. The frost top is separated from the exterior top by a thermal break.

Refrigeration system uses HCFC-404a refrigerant and has a self-contained 115 volt, 60 Hertz, single phase hermetically sealed condensing unit. Unit is wired with a 3-wire, grounded, maximum 10' (3m) cord and plug. Unit has an on/off switch mounted on the exterior.

Casters: Unit is mounted on 5" (12.7cm) diameter swivel casters with non-marking polyolefin tires and plate brakes. Overall height of caster assembly is 6.00" (15.2cm).



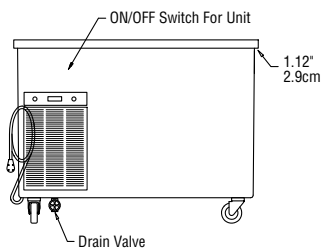
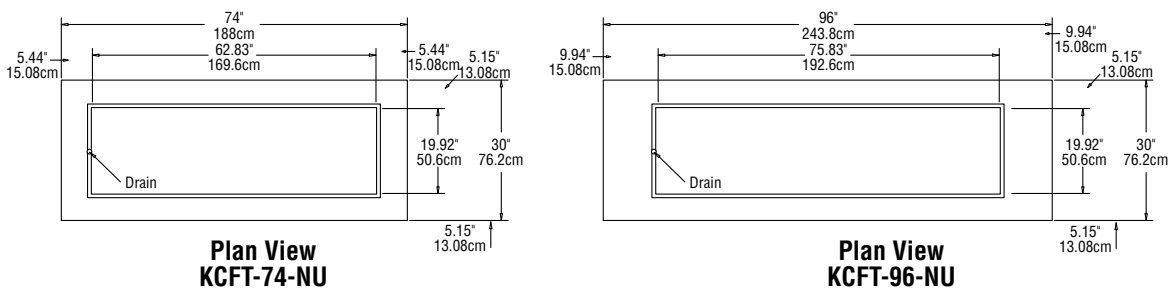
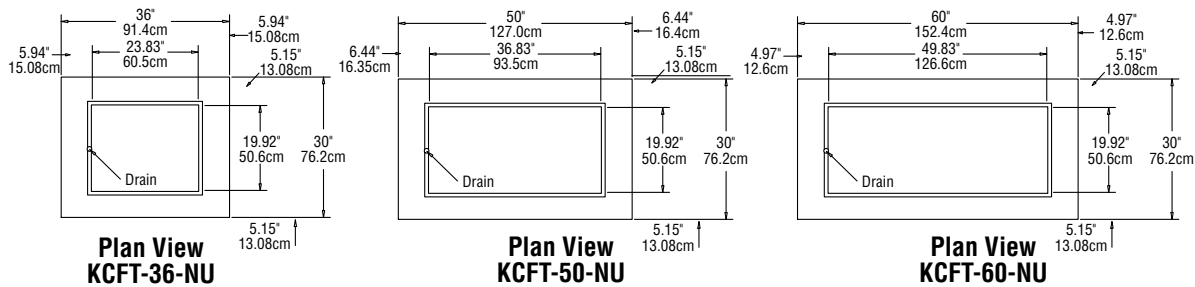

**Elevation View
All KCFT-NU Models**

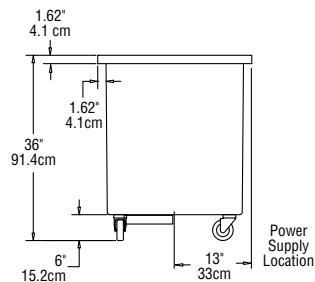

**End View
All KCFT Models**

Specifications					
Model	V/Hz/Ph	Amps	H.P.	Nema Plug	Ship Weight
KCFT-36-NU	115/60/1	8.0	1/4	5-15P	380 lbs/172 kg
KCFT-50-NU	115/60/1	8.0	1/4	5-15P	455 lbs/206 kg
KCFT-60-NU	115/60/1	8.0	1/4	5-15P	540 lbs/245 kg
KCFT-74-NU	115/60/1	8.0	1/4	5-15P	610 lbs/277 kg
KCFT-96-NU	115/60/1	8.0	1/4	5-15P	680 lbs/308 kg

Delfield reserves the right to make changes to the design or specifications without prior notice.