

SECTION 5. PARTS INFORMATION

5-1. INTRODUCTION

This section identifies and lists the replaceable parts of the Henny Penny Multipurpose Holding Cabinets.

5-2. GENUINE PARTS

Use only genuine Henny Penny parts in your cabinet. Using a part of lesser quality or substitute design may result

5-3. HOW TO FIND PARTS

To find parts you want to order from the Parts List proceed as follows:

1. Refer to the exploded drawing in this section to identify
2. Use the item number from the exploded drawing to locate the corresponding part in the Parts List in this section. In this list will be the Henny Penny part number and a description of the part.

5-4. HOW TO ORDER

Once the part you want to order has been found in the Parts List, write down the following information:

1. From the Parts List:

(Sample)

Item Number	<u>16</u>
Part Number	<u>27534</u>
Description	<u>Slide Vent</u>

2. From the data plate:

(Sample)

Product Number	<u>05126</u>
Serial Number	<u>0001</u>
Voltage	<u>120V</u>

5-5. PRICES

Your independent Henny Penny distributor has a price parts list and will be glad to inform you of the cost of your parts order.

5-6. DELIVERY

Commonly replaced items are stocked by your independent Henny Penny distributor and will be sent out when your order is received. Other parts will be ordered by the distributor from Henny Penny Corporation. Normally, these will be sent to your distributor within three working days.

5-7. WARRANTY

All replacement parts (except lamps and fuses) are covered under warranty for 90 days against manufacturing defects and workmanship. If damage occurs during shipping, notify the carrier at once so that a claim may be properly filed. Refer to warranty on the front of this section for other rights and limitations.

5-8. RECOMMENDED SPARE PARTS FOR DISTRIBUTORS

Recommended replacement parts, stocked by your distributor, are indicated with √ in the parts lists. Please use care when ordering recommended parts, because all voltages and variations are marked. Distributors should order parts based upon common voltages and equipment sold in their territory.

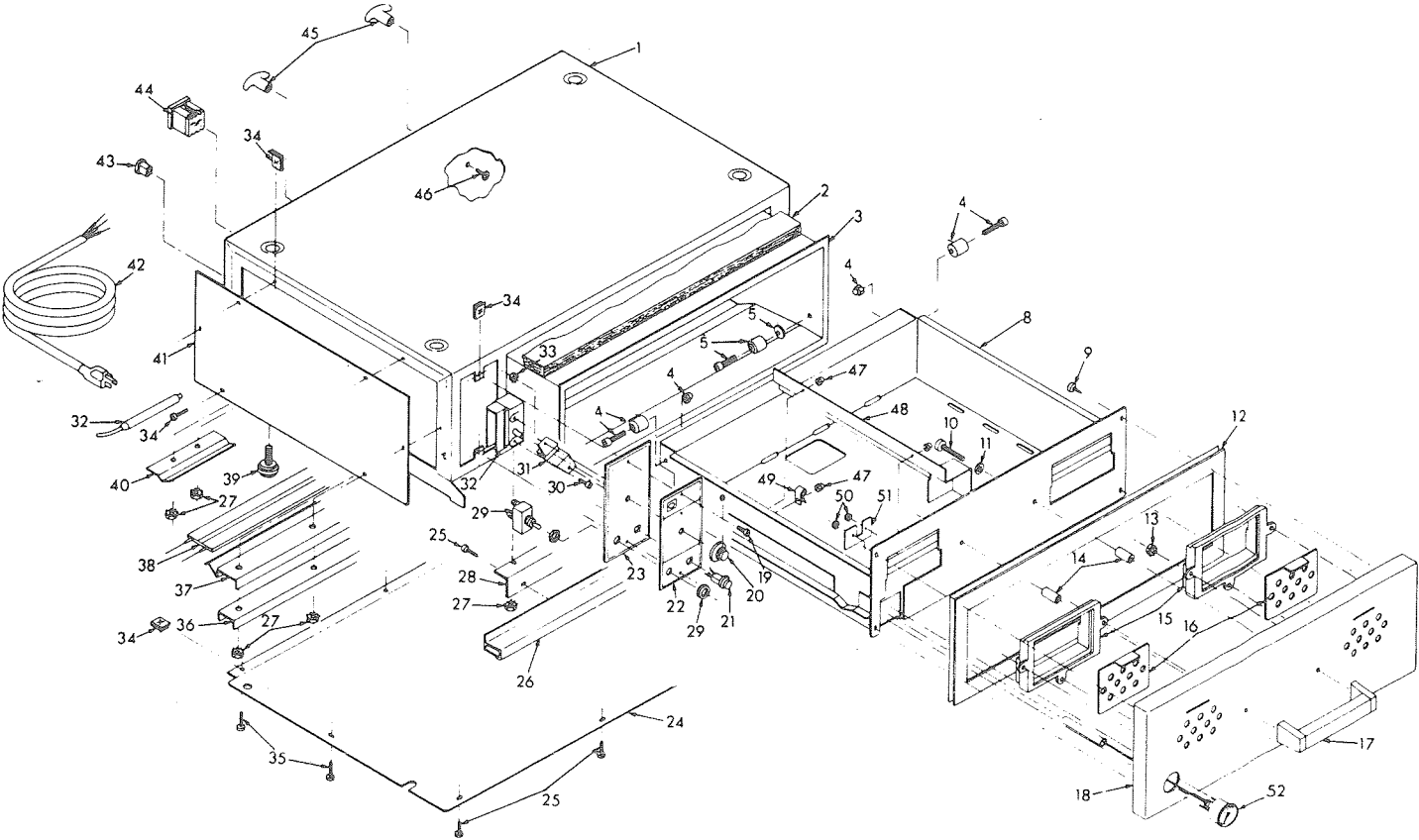

Model 05524 (No Vents)

Part No.	Description	Qty.
44319	Shell Stud Weld Assy.	1
44315	Drawer Frame Assy.	1
44311	Drawer Front	1
44324	Drawer Assy.	1
44305	Decal	1
44031	Heater	1
49112	Power Cord	2
PL01-001	Chrome Plug - 1/2"	1
EF02-049	Strain Relief	1
44323	Thermometer Bulb Cover	1
44341	Pan Insert	1
05031	Pan	1
41539	Bracket - Thermometer	1

117500 Cumm 7 day Wasserstrom

No.	Part No.	Description	Qty.
1	27623	Shell Stud Weld Assembly	1
2	27535	Insulation - HHC	1
3	27622	Liner Stud Weld Assembly	1
√ 4	14113	Bearing Kit	1
8	28844	Drawer Frame Assembly	1
9	SC02-016	Screw #8-AB x 1/2 PH PHD S	4
10	SC01-114	Screw #10-24 x 1 1/4 PH PHD S	2
11	LW02-005	Lockwasher #10 Internal	2
√ 12	27516	Gasket	1
13	NS02-006	Nut Hex Keps #10-24	6
14	27538	Spacer - Drawer Handle	2
15	27501	Block - Molded Vent	2
16	27534	Slide - Vent	2
17	31395	Handle - Drawer	1
18	28837	Drawer Front Assembly	1
19	SC02-030	Screw 8-B x 3/8 PH THD C	2
20	27540	Knob - HHC	1
√ 21	16624	Light - Indicator 250 V	1
22	27613	Decal	1
22	44659	Decal - DQ only	1
23	27609	Face Plate Assembly	1
24	27617	Panel - Bottom Access	1
25	SC01-002	Screw #10-32 x 1/2 THD C	6
26	27608	Edge - Drip	1
27	NS02-002	Nut Keps 1/4-20 C	*
28	27629	Brace - Bottom	1
√ 29	22195	Switch - Toggle	1
30	SC01-023	Screw #6-32 x 1/4 PH RHD C	2
31	25903	Bracket - Thermostat	1
√ 32	14111	Thermostat	1
33	NS02-005	Nut Hex Keps #6-32 C	2
34	NS03-031	#8 Tinnerman Fastener	*
35	SC02-014	Screw #8 - AB x 3/8 PH THD S	5
36	27527	Brace - Heater	2
37	27526	Clamp - Heater	2
√ 38	27552	Heater - HHC 120 V, 480 W	2
39	26411	Foot Leveler	4
40	22512	Clip Thermostat Bulb Mtg.	1
41	27615	Plate - Side Access	2
42	15063	Cord, Electric	1
43	EF02-017	Strain Relief 11/32	1
44	MS01-197	Receptacle NEMA 5-15 R	1
45	27645	Knob - Cord Wrap	2
46	SC01-059	Screw 1/4-20 x 1/2 PH THD C	2
47	NS03-016	Nut - #6-32 Acorn Nut SS	3
48	28823	Cover, Thermometer	1
49	EF02-033	Clamp 7/16 ID x 3/8 W	1
50	NS02-005	Nut - Hex Keps #6-32	2
51	41539	BKT - Thermometer	1
√ 52	28828	Thermometer	1
52	33042	Cover - Glass - Thermometer	1