



BEVERAGE-AIR

3779 Champion Blvd., Winston-Salem, NC 27105
1-888-845-9800 Fax# 1-336-245-6453
<http://www.Beverage-Air.com>

Commercial Refrigeration Equipment General Specification

BB 27" BASE SERIES—BACK BAR REFRIGERATOR

Back bar storage cabinets come in four basic, self-contained models up to 95" wide. Overall height is 37 1/4." Depth is 27" from face of door to back of cabinet. Handles project 1 3/4." Solid doors are standard. One size self-contained, end mount model (BB78E) and two remote models (BB58R and BB78R) complete the 27" base series of back bars.

CABINET CONSTRUCTION

Standard, cabinet exterior construction includes attractive, wear resistant vinyl on steel in black finish. Stainless exterior options available. Equipped with 2" stainless steel top. Doors are self-closing and include key locks. Magnetic door gaskets provide positive door sealing. Doors are field reversible with hinge kit accessory.

Standard interior construction utilizes galvanized steel walls and ceiling. Reinforced floor and doorsills are made from heavy-duty stainless steel to provide long lasting service. Interior, incandescent, lighting is standard with manual on/off switch.

Foamed-in-place CFC and HCFC-free polyurethane insulation enhances the structural strength of the cabinet and helps increase energy efficiency.

REFRIGERATION

Refrigeration system uses R134a refrigerant, which is CFC and HCFC-free for compliance with environmental safety concerns. Remote refrigeration models include expansion valve installed.

Condensate elimination is automatic and non-electric.

ELECTRICAL

Units wired at factory and ready for connection to a 115/60/1 phase, 15 amp dedicated outlet. 8' long cord and plug set included.

Item No. _____

Quantity _____

BEER EQUIPMENT SOLID DOOR BACK BAR REFRIGERATORS 27" BASE BB SERIES

MODELS:
BB58/58R
BB68
BB78/78E/78R
BB94



BB58



BB68 STAINLESS



BB78 END MOUNT



BB94

Available From:



*Note: Not all markings may apply to all model variations.

Model Specified _____

Store# _____

Location _____

Quantity _____



BEVERAGE-AIR

ELECTRICAL CONNECTION

Units pre-wired at factory and include 8' long cord and plug set.



115/60/1
NEMA-5-15P

Back Bar Refrigerators, 27" Base

Models: BB58, BB58R, BB68, BB78, BB78E, BB78R, BB94

MODEL	BB58	BB58R	BB68	BB78	BB78E	BB78R	BB94
EXTERNAL DIMENSIONAL DATA							
Length Overall (inches)	59"	59"	69"	79"	92 1/2"	79"	95"
Length Overall (mm)	1499	1499	1753	2007	2350	2007	2413
Depth Overall (inches)	28 3/16"	28 3/16"	28 3/16"	28 3/16"	28 3/16"	28 3/16"	28 3/16"
Depth Overall (mm)	716	716	716	716	716	716	716
Height Overall— (inches)	37 1/4"	37 1/4"	37 1/4"	37 1/4"	37 1/4"	37 1/4"	37 1/4"
Height Overall— (mm)	946	946	946	946	946	946	946
Clear Door Width (inches)	21" x 29 15/16"	21" x 29 15/16"	21" x 29 15/16"	21" x 29 15/16"	21" x 29 15/16"	21" x 29 15/16"	21" x 29 15/16"
Depth With Door Open 90°	50 1/2"	50 1/2"	50 1/2"	50 1/2"	50 1/2"	50 1/2"	50 1/2"
Number of doors	2	2	2	3	3	3	3
INTERNAL DIMENSIONAL DATA							
NET Capacity (cubic ft.)	23.8	23.8	28.4	33	33	33	39.7
NET Capacity (Liters)	674	674	804	935	935	935	1124
Internal Length Overall (inches)	55"	55"	65"	75"	75"	75"	91"
Internal Length Overall (mm)	1397	1397	1651	1905	1905	1905	2311
Internal Depth Overall (inches)	23"	23"	23"	23"	23"	23"	23"
Internal Depth Overall (mm)	584	584	584	584	584	584	584
Internal Height Overall (inches)	32"	32"	32"	32"	32"	32"	32"
Internal Height Overall (mm)	813	813	813	813	813	813	813
Number of Shelves	4	4	4	6	6	6	6
Number of Kegs (straight wall)	2	3	3	4	4	4	5
ELECTRICAL DATA							
Full Load Amperes 115/60/1	7.2	.5	7.2	7.2	7.2	.5	7.2
ENERGY CONSUMPTION (KWH)							
	4.37	n/a*	3.55	4.02	4.02	n/a*	4.8
REFRIGERATION DATA							
Horsepower	1/3	remote	1/3	1/3	1/3	remote	1/3
WEIGHT DATA							
Gross Weight (Crated lbs)	354	284	397	439	420	386	498
Gross Weight (Crated kg)	161	129	180	199	191	175	226



*Note: Not all markings may apply to all model variations.

*N/A: Not available at time of printing.

PLAN VIEWS

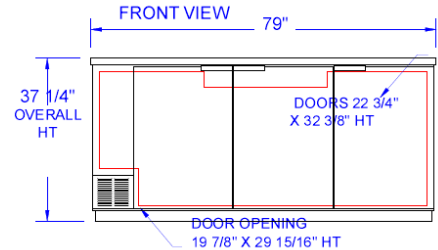
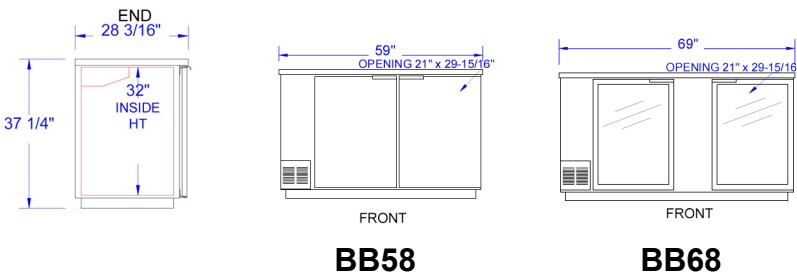

BB78

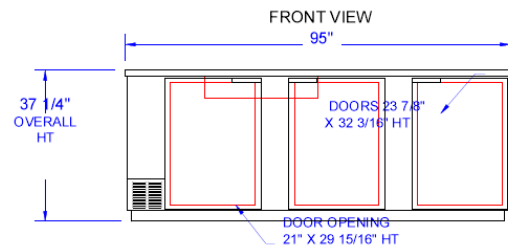

BB94

BEVERAGE-AIR® CORPORATION

3779 Champion Blvd. • Winston-Salem, NC 27105 USA • (336) 245-6400 • Fax (336) 245-6453 • (888) 845-9800 • www.beverage-air.com

Specifications are subject to change without prior notice. 06/10