



**BLOOMFIELD INDUSTRIES**  
2 Erik Circle  
Verdi, Nevada 89439  
**(775) 345-0444**

## SERVICE INSTRUCTIONS

### SOLENOID VALVE RETROFIT KIT 84571 (120V) and 84572 (220/240V)

#### A. APPLICABILITY

This kit replaces the solenoid valve and faucet supply tube on automatic brewer models:

Koffee-King™	8540	8572	Domestic and Export
Integrity™	9010	9012	Domestic and Export

#### B. INSTRUCTIONS



**CAUTION: ELECTRIC SHOCK HAZARD**  
Unplug brewer before beginning conversion

##### 1. REMOVE EXISTING SOLENOID (See fig. B.1 and B.2)

- Unplug brewer and shut off water supply. Open faucet to bleed off water pressure.
- Remove TOP PANEL, FRONT PANEL and SOLENOID ACCESS DOOR.
- Disconnect wires to solenoid. Remove silicone SUPPLY HOSE from solenoid.
- Disconnect FAUCET SUPPLY TUBE from solenoid and faucet shut-off valve.
- Remove BRASS NUT from INLET FITTING.  
Lift solenoid / timer / bracket assembly from mounting clip.
- Loosen screws on bottom of solenoid and separate solenoid from bracket.  
Remove solenoid and fittings from cabinet.  
Reinstall bracket on mounting clip.

Note::  
Integrity™ shown  
Koffee-King™ similar

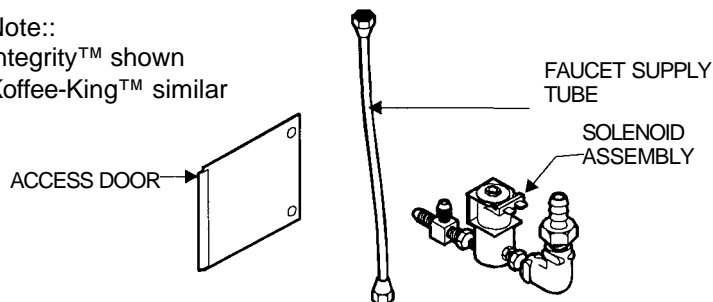

**Fig. B.1**

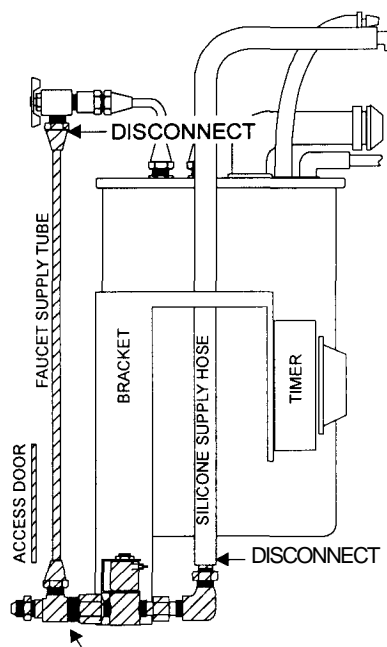

**Fig. B.2**

- REMOVE SHADED COMPONENTS
- SOLENOID ACCESS DOOR
  - SOLENOID AND FLOW CONTROL
  - INLET FITTING, TEE & ADAPTERS

## B. INSTRUCTIONS (continued)

### 2. INSTALL NEW SOLENOID (See figure B.3, B.4 and B.5)

- a. Attach faucet supply BRAIDED HOSE to SOLENOID. Push the hose fully onto the *bypass* outlet (the side without a solenoid coil). Install one CLAMP over the shaft of the outlet, and one CLAMP directly over the barb of the outlet.
- b. Assemble the SOLENOID BRACKET to the *new* ACCESS DOOR. Assemble the SOLENOID to the SOLENOID BRACKET.
- c. Route the silicone SUPPLY TUBE through the 3rd hole (from the front) then out the access door opening. Attach tube to SOLENOID. Push the tube fully onto the *controlled* outlet (the side with the solenoid coil).
- d. Route the BRAIDED HOSE through the 1st hole (from the front). Connect the flare SWIVEL NUT to the end of the braided hose. Rotate the FAUCET SHUT-OFF VALVE as needed (approximately 45° and connect the swivel nut to the valve. Verify all connections are tight.
- e. Assemble the ACCESS DOOR / SOLENOID to the cabinet.
- f. Turn water supply ON. Check for leaks.
- g. Insert BUTTON PLUG in the hole formerly occupied by the inlet fitting.
- h. Reinstall TOP PANEL and FRONT PANEL.  
Plug unit in and test.

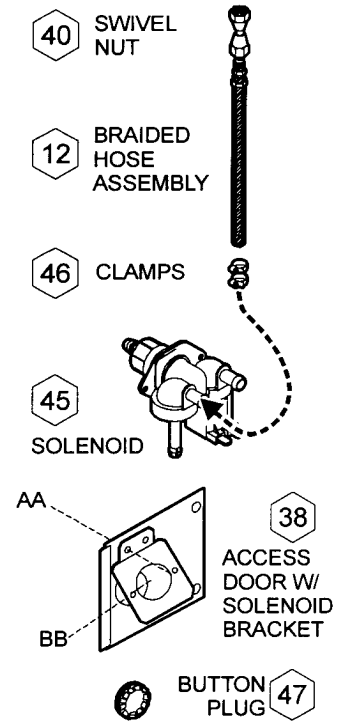

**Fig. B.3**

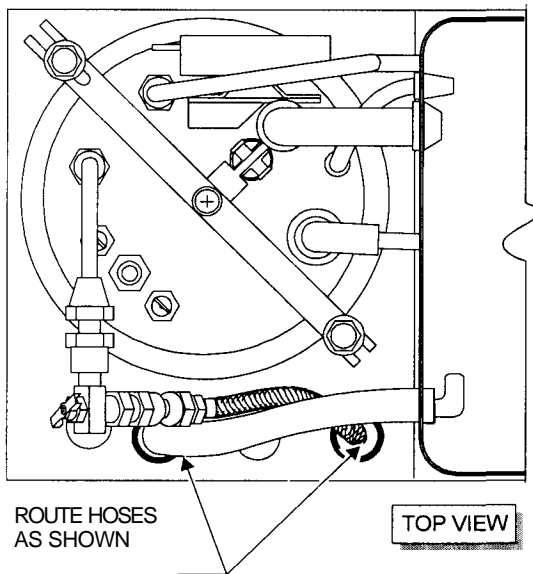

**Fig. B.4**

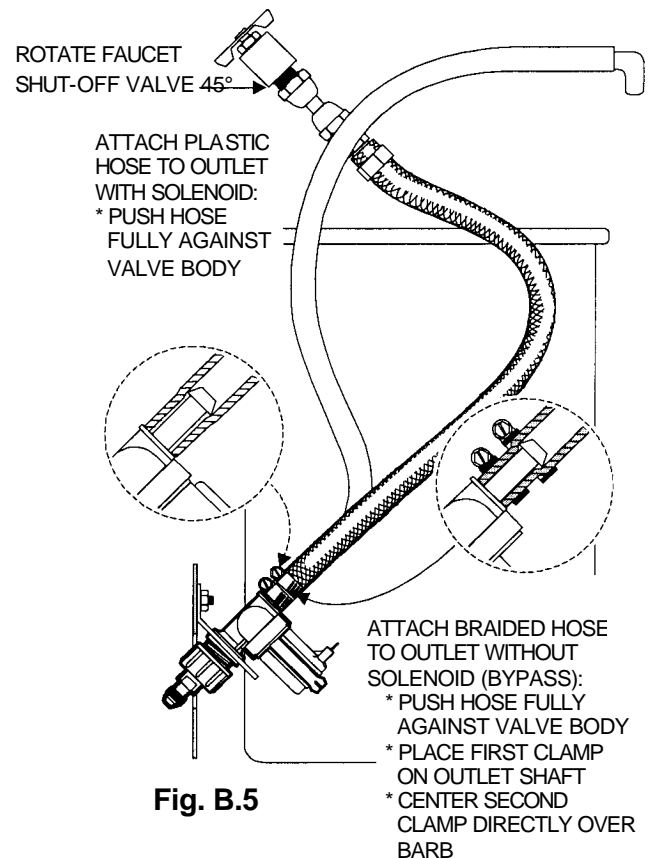

**Fig. B.5**

**PARTS LISTS: KIT NO. 84571 120V BREWER W/FAUCET**

ITEM	SERV P/N	DESCRIPTION	QTY
12	84461	BRAIDED HOSE ASSY	1
38	84412	SOLENOID ACCESS DOOR	1
38	84413	SOLENOID BRACKET	1
40	81165	COUPLING, FLARE SWIVEL	1
45	84455	SOLENOID ASSY, 120Vw/BYPASS	1
46	84460	HOSE CLAMP	2
47	8810-12	BUTTON PLUG, ½" DIA	1
AA		SCREW, FLT PHL SS 8-32 x ½"	2
BB		SCREW, PAN SLT SS 4mm x 6mm	2

**PARTS LIST: KIT NO. 84572 240V BREWER W/FAUCET**

ITEM	SERV P/N	DESCRIPTION	QTY
12	84461	BRAIDED HOSE ASSY	1
38	84412	SOLENOID ACCESS DOOR	1
38	84413	SOLENOID BRACKET	1
40	81165	COUPLING, FLARE SWIVEL	1
45	84570	SOLENOID ASSY, 240V w/BYPASS	1
46	84460	HOSE CLAMP	2
47	8810-12	BUTTON PLUG, ½" DIA	1
AA		SCREW, FLT PHL SS 8-32 x ½"	2
BB		SCREW, PAN SLT SS 4mm x 6mm	2