

WELLS BLOOMFIELD, LLC

2 ERIK CIRCLE, P. O. Box 280 Verdi, NV 89439
telephone: 775-689-5707 fax: 775-689-5976
www.wellsbloomfield.com

KIT # 87119

INSTALLATION INSTRUCTIONS SINGLE SOLENOID RETROFIT 8742 & 8748 Tea Brewers

Kit #86606 replaces the existing nylon-bodied dual solenoid valve and associated plumbing in Model 8742 and 8748 Tea Brewers.

STEP I - PREPARATION:

1. Unplug brewer from electric power and allow to cool. Shut off water supply to brewer.
2. Remove top panel and back panel.
3. Disconnect wiring and inlet water line from old solenoid.
4. Disconnect existing hoses from hot water tank and bypass nozzle. **Retain brew inlet hose.** Discard bypass nozzle inlet hose.
5. Remove and discard connector between two sections of vent tube. **Retain vent tubes.**
6. Remove existing solenoid and bracket.
NOTE: Retrieve the swivel elbow and connector from the needle valve. **DO NOT discard these items.**



**CAUTION:
ELECTRIC SHOCK
HAZARD**

Unplug brewer from electric power before beginning this procedure.



**CAUTION:
BURN HAZARD**

Allow brewer to cool before proceeding.

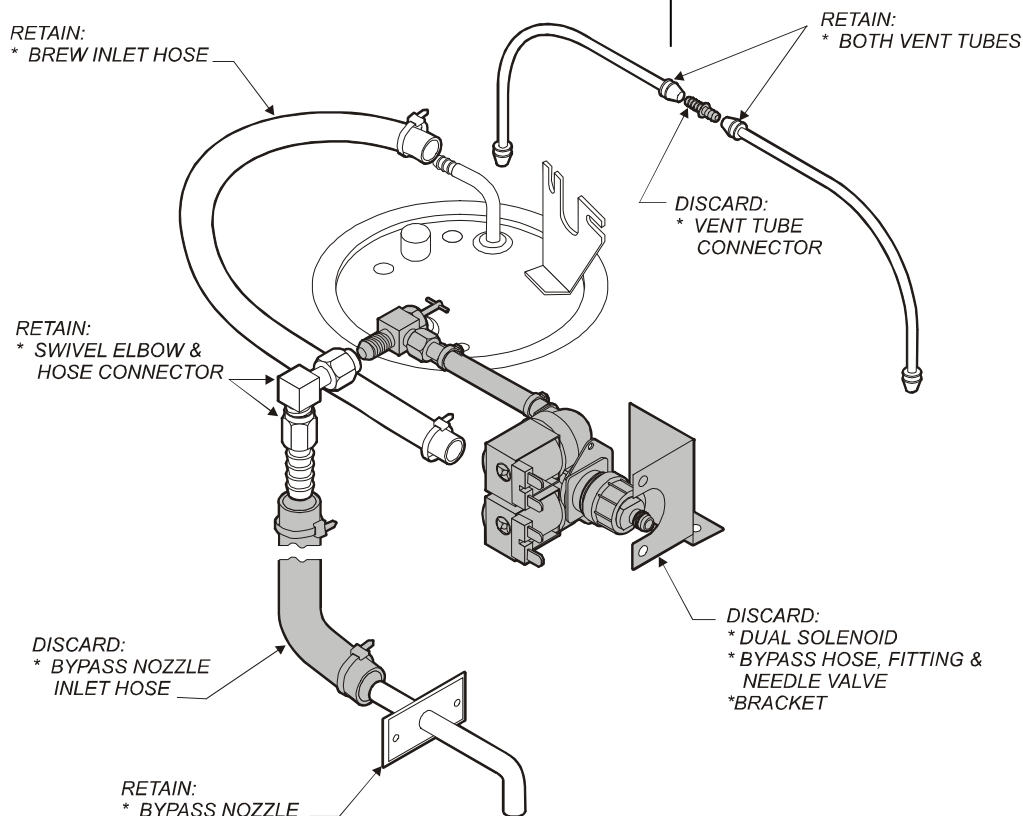

PRINTED IN UNITED STATES OF AMERICA



**CAUTION:
ELECTRIC SHOCK
HAZARD**

Unplug brewer from electric power
before beginning this procedure.



**CAUTION:
BURN HAZARD**

Allow brewer to cool before
proceeding.

STEP II - INSTALLATION OF CONVERSION

1. Attach swivel elbow and connector (from Step I) on needle valve of solenoid assembly. Attach brew inlet hose (from Step I) to connector. Secure hose with tie-wrap.
2. Attach solenoid assembly to bracket. Attach bracket to brewer upper brace.
3. Insert bypass inlet hose through front of cabinet. Connect to bypass nozzle and reattach nozzle to cabinet.
4. Connect brew inlet hose to tank fitting . Secure hose with tie-wrap.
5. Insert long end of "Y" in vent tube from tank. Insert short end of "Y" in vent tube to brew head. Insert angled end of "Y" in vent tube from solenoid assembly.
6. Connect water inlet flare fitting to solenoid.
7. Connect one connector on each of the two solenoid wires to solenoid terminals. Be sure wires are securely attached to solenoid. Tape unused connectors to prevent shorting.
8. Reinstall top and back panels.
9. Turn on water supply and reconnect brewer to electrical power. Test for proper operation.

