

SATELLITE DOCKING STATION

BLOOMFIELD MODEL: 9341

BY

BLOOMFIELD

BLOOMFIELD INDUSTRIES

2 ERIK CIRCLE

P.O.BOX 280

VERDI, NV 89439

U.S.A.

FAX (888) 492-2783

PH (702) 345-0444

Email address: service@wellsbloomfield.com

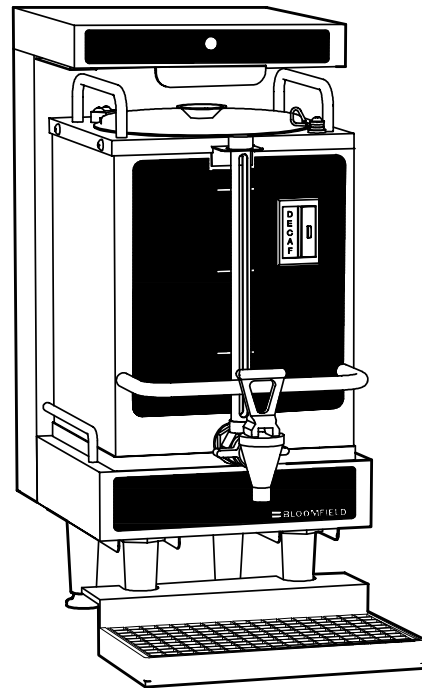

Docking Station Shown with optional Satellite and Drip Tray



LISTED
990H

TABLE OF CONTENTS

Introduction	Page 1	Initial Installation Instructions	Page 6
General Layout Data Sheet	Page 2	Quality Timer Adjustment Instructions	Page 7
Features	Page 3	Exploded View	Page 8
Warranty	Page 4	Parts Identification	Page 8
Safety	Page 5	Ordering/Service Procedure	Page 9
Installation Instruction	Page 6	Troubleshooting	Page 10
Leveling the Unit	Page 6	Schematic	Page 12
Electrician's Installation Instructions	Page 6	Wiring Diagram	Page 12

Printed in January, 2001

INTRODUCTION

BLOOMFIELD MODEL: 9341 HI-QUALITY SATELLITE DOCKING STATION

Thank you for purchasing a Bloomfield Satellite Docking Station. You will achieve maximum performance from this unit if you familiarize yourself with its many outstanding features. Please take a few minutes to read through the owner's manual. Proper installation is very important if maximum performance and satisfaction are to be achieved. If you have any difficulties, consult your nearest Bloomfield Authorized Distributor. They have the required expertise to provide the proper advice and assistance. If the Bloomfield Distributor is unable to assist you, please contact the factory directly.

Please be certain the electrical connections are compatible, as improper connections could damage the Unit and void the warranty.

Safe and satisfactory operation of your Bloomfield Satellite Docking Station depends to a great extent upon its proper installation. This Satellite Docking Station must be installed without alteration and in accordance with these printed instructions and applicable electrical codes. The performance and safety of the Brewer can be greatly impaired if it is altered in any way, or if installation deviates from the instructions printed herein, and will not be covered under any warranty service agreement.

This Bloomfield Docking Station has been designed with adjustment flexibility to cover a wide spectrum of customer needs.

GENERAL LAYOUT DATA
BLOOMFIELD SATELLITE DOCKING STATION
MODEL: 9341

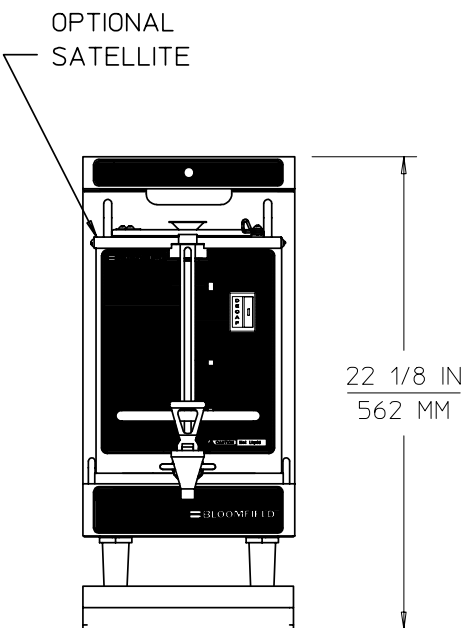
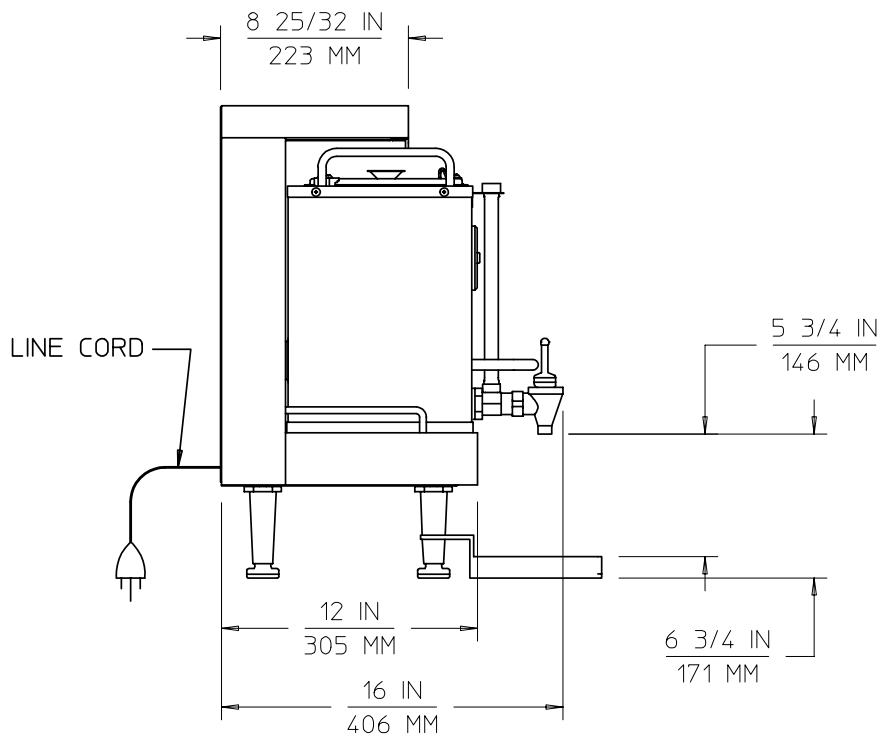
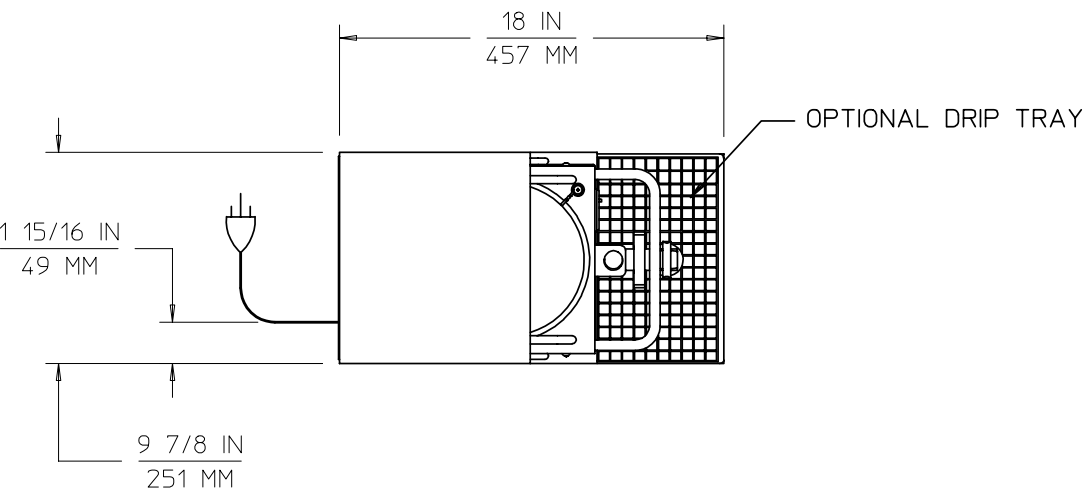

ELECTRICAL SPECIFICATIONS

MODEL	WATTS	VOLTS	AMPS
9341	45 (with one Satellite)	120	.4

FEATURES

MODEL 9341 SATELLITE DOCKING STATION manufactured by Bloomfield Industries Inc., is designed to hold coffee at a correct temperature for serving.

- o Operates on 120 Volt, .4 Amp, 45 Watt service.
- o Safety feature including absence of any hot surfaces.
- o Automatic Start when Satellite is in place,
- o Ideal for self service applications.
- o Auto safety electrical shut-off when Satellite is removed.
- o Adjustable non-skid rubber feet on brewer for easy leveling.
- o Adjustable coffee quality timer light which flashes at end of approved coffee holding time.
- o Optional Drip Tray.
- o Teflon color coded wiring, keyed to color tabs at connection points.
- o Unit size requires minimal counter space.
- o Satellite Brewer & Satellites OPTIONAL.
- o UL, CUL & NSF Listed (UL & CUL: E9253) (NSF: Standard 4)
- o Manufactured in USA

WARRANTY POLICY

All electrical products manufactured by Wells/Bloomfield are warranted against defects in material and workmanship by our authorized service agents with:

- o One (1) year replacement part warranty
- o One (1) year on labor
- o All genuine Wells/Bloomfield replacement parts are warranted for ninety (90) days from date of purchase on non-warranty equipment. This parts warranty is limited only to replacements of the defective part. Any use of non-genuine Bloomfield parts completely voids any warranty.

Labor includes cost of service invoice and is limited travel time to a sixty (60) mile radius (or up to a maximum of one hour) to the nearest authorized service agency or one of it's sub-service agencies. This service will be provided on the customers premises for non-portable models. Portable models (a device with a cord and plug) must be taken or shipped to the closest authorized service agency; transportation charges prepaid. All labor shall be performed during regular working hours. Overtime premium will be charged to the buyer.

In addition to this warranty policy are the following exceptions:

- A. Dispensers (i.e., tea and coffee) carry ninety (90) day parts replacement only.

Warranty does not include any coverage for:

- o Resetting the safety thermostats, circuit breakers, overload protectors, or fuse replacements unless warranted conditions are caused.
- o All problems due to operation at voltage other than specified on equipment nameplates – conversion to correct voltage must be the customer's responsibility.
- o All problems due to electrical connections not made in accordance with electrical code requirements and wiring diagrams supplied with the equipment.
- o All problems due to inadequate water supply, such as fluctuating, high or low water pressure, etc.
- o All problems due to mineral/calcium deposits, or contamination from chlorides and or chlorines. De-liming is considered a preventative maintenance function and not covered by warranty.
- o Calibration of thermostat. Replacement of items subject to normal wear to include such items as knobs, baskets, grids, mechanical timers, and thermocouples. Normal maintenance functions including lubrication, adjustment of thermostats, microswitches, replacement of fuses, and indicating lights.
- o Installation, labor, and job check-outs are not considered warranty.

THIS WARRANTY IS THE COMPLETE AND ONLY WARRANTY, EXPRESS OR IMPLIED IN LAW OR FACT, INCLUDING BUT NOT LIMITED TO WARRANTIES OF MERCHANTABILITY OR FITNESS FOR ANY PARTICULAR PURPOSE, AND/OR FOR DIRECT, INDIRECT OR CONSEQUENTIAL DAMAGES IN CONNECTION WITH WELLS/BLOOMFIELD PRODUCTS. This warranty is void if it is determined that upon inspection by an authorized Wells/Bloomfield dealer/distributor that the equipment has been modified, misused, misapplied, improperly installed, or damaged in transit or by fire, flood or act of nature. All problems due to water supply, lime build-up, or high or low water pressure are not covered by this warranty. It also does not apply if the serial nameplate has been removed or service is performed by unauthorized personnel.

NOTE: A Warranty Statement and Complete Service Agency Listing with Warranty exclusions is provided with each unit.

SATELLITE DOCKING STATION IS VOID IF:

Other than genuine Bloomfield replacement parts are used.

Unit is plugged into voltage other than specified on serial plate.

Recommended Bloomfield servicing procedures are not followed.

SAFETY

Knowledge of proper procedures is essential to the safe operation of electrically energized equipment. In accordance with generally accepted product safety labeling guidelines for potential hazards, the following 4 signal words are used throughout this chapter.



DANGER – Danger is used to indicate the presence of a hazard which will cause severe personal injury, death, or substantial property damage in the event the statement is ignored.



WARNING – Warning is used to indicate the presence of a hazard which can cause severe personal injury, death, or substantial property damage in the event the statement is ignored.



CAUTION – Caution is used to indicate the presence of a hazard which will or can cause minor personal injury, or property damage in the event the statement is ignored.

NOTE – Note is used to notify personnel of installation, operation or maintenance information which is important, but not hazard related.

NOTE – This piece of equipment is made in the USA and has American sizes on hardware. All metric conversions are approximate and can vary in size.

Hazard Communication Standard (HCS) – The procedures in this chapter include the use of chemical products. These chemical products will be highlighted with bold face letters followed by the abbreviation (HCS). See the Hazard Communication Standard (HCS) Manual for the appropriate Material Safety Data Sheet(s) (MSDS).

INSTALLATION INSTRUCTION

READ THIS COMPLETELY BEFORE STARTING THE INSTALLATION

 **CAUTION:** DO NOT plug in or energize this unit until installation instructions are read and followed. Damage to the Unit will occur if the instructions are not followed.

To enable the installer to make a quality installation and hold delay time to a minimum, the following suggestions and tests should be done before the actual unit installation is begun.

LEVELING THE UNIT

Set Satellite Docking Station in operating location and level. For proper unit operation, it is very important that the unit be level when it is standing in its proper operating position. A spirit level should be placed on the top plate of the unit, at the edge, as a guide when making level adjustments. Level the unit from left to right and front to back by turning the adjustable feet that support the unit.

 **CAUTION:** Rubber feet must be installed on each leg of the unit. Failure to do so will result in movement of the Satellite Docking Station which can cause personal injury and/or damage to unit.

ELECTRICIAN'S INSTALLATION INSTRUCTIONS

 **WARNING ELECTRICAL SHOCK HAZARD:** Satellite Docking Station must be properly grounded to prevent possible shock hazard. Electrical shock will cause death or serious injury.

The unit requires a dedicated power source capable of supplying: 120 Volt, A.C. (3) wire, 15 Amp Service.

The unit is shipped from the factory with a power cord.

INITIAL INSTALLATION INSTRUCTIONS

 **CAUTION:** Initial Installation should be performed by a qualified installer or qualified service technician. Improper installation will damage the Satellite Docking Station.

Be sure all electrical connections are secure.

Plug in Satellite Docking Station

NOTE: Satellite Light will flash momentarily to initialize the timer when initially plugged into electrical outlet. DO NOT plug in unit when Satellite is in place. This will cause light to flash constantly.

Position Satellite onto the Satellite Docking Station to insure light is on (there may be a slight delay before light comes on in some models)

The Light will start flashing after the preset time is reached. See Satellite Operation Section in the SS1 Instruction Manual for more information.

QUALITY TIMER ADJUSTMENT INSTRUCTIONS

Flashing light timer is preset from the factory for 30 minutes. To increase the holding time:



ELECTRICAL SHOCK HAZARD: Disconnect power supply to Unit before removal of any panel or replacement of any component. Electrical shock will cause death or serious injury.



CAUTION: All adjustments should be made by a authorized Bloomfield Service Technician

1. Unplug unit from the electrical outlet.
2. Remove Rear panel. (See item 5 on page 8)
3. Locate time control (See item 13 on page 8) and turn clockwise to holding time maximum. (See Figure 1)
NOTE: Maximum allowable time is 120 minutes.
4. Replace Rear Panel.
5. Plug unit in.

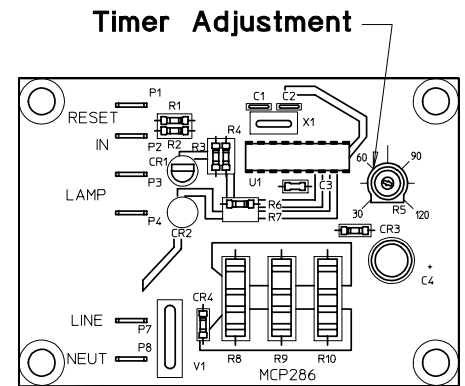

— Figure 1 —

NOTE: When light is flashing, Satellite unit will maintain temperature until the Satellite is removed from the Docking Station. Satellite must be removed for more than 4 seconds for the Timer to reset.

There is no power supplied to the satellite unless the Satellite is in place on the Unit and the light is on.

EXPLODED VIEW & PARTS LIST
(MODEL: 9431)

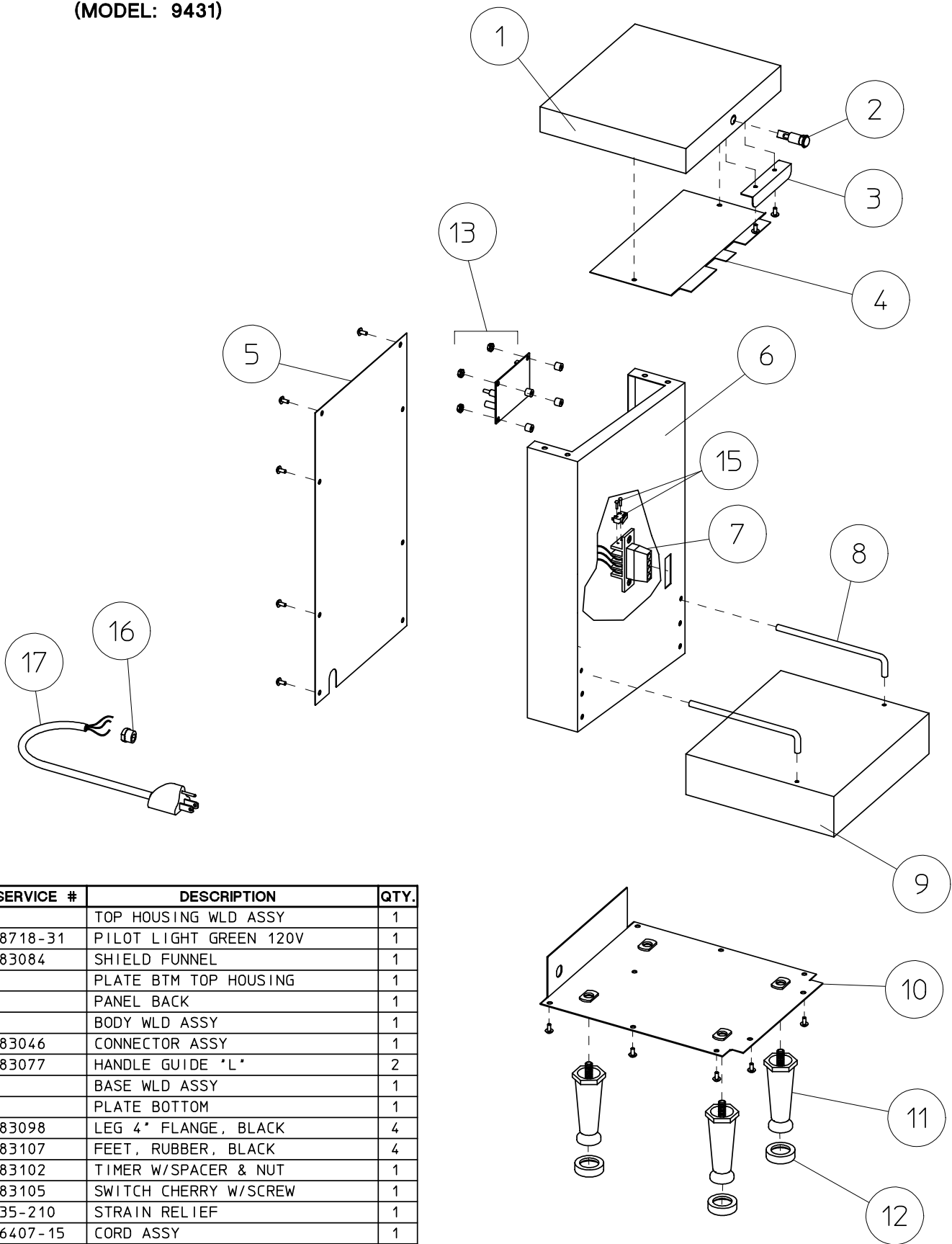

ITEM	SERVICE #	DESCRIPTION	QTY.
1		TOP HOUSING WLD ASSY	1
2	8718-31	PILOT LIGHT GREEN 120V	1
3	83084	SHIELD FUNNEL	1
4		PLATE BTM TOP HOUSING	1
5		PANEL BACK	1
6		BODY WLD ASSY	1
7	83046	CONNECTOR ASSY	1
8	83077	HANDLE GUIDE "L"	2
9		BASE WLD ASSY	1
10		PLATE BOTTOM	1
11	83098	LEG 4" FLANGE, BLACK	4
12	83107	FEET, RUBBER, BLACK	4
13	83102	TIMER W/SPACER & NUT	1
15	83105	SWITCH CHERRY W/SCREW	1
16	35-210	STRAIN RELIEF	1
17	6407-15	CORD ASSY	1

ACCESSORY

	3902	DRIP TRAY	1
--	------	-----------	---

ORDERING/SERVICE PROCEDURE

Use only genuine Bloomfield replacement parts in this Satellite Docking Station. The use of replacement parts other than those supplied by Bloomfield voids the warranty.

Parts are available at your Authorized Bloomfield Service Agency as provided in your Warranty Statement and Service Agency Listing.

To find the parts required to restore proper operation to the Satellite Docking Station, proceed as follows:

1. Refer to the exploded views located in this chapter to identify the parts needed. (Page 8)
2. Use the item number from the exploded view to locate the corresponding parts in the parts identification Table. (Page 8)

Ordering Information – Once the parts needed are known, record the following information from the Identification Name Plate on the side of the Unit and Parts Identification Section on page 8.

Model: **Serial Number:**

[illegible][illegible]

How to order – For immediate shipment, call your local BLOOMFIELD INDUSTRIES Authorized Service Agency.

Service Information – To obtain service assistance in addition to that contained in this chapter, call BLOOMFIELD in the U.S. at (702) 345-0444.

Be prepared to give the model and serial numbers of your Satellite Docking Station, as well as the problem and the troubleshooting steps already taken, to the service technician when calling for assistance.

TROUBLESHOOTING



ELECTRICAL SHOCK HAZARD: Inspecting, testing and repair of electrical equipment should be performed only by qualified service personnel. The Satellite Docking Station should be unplugged when servicing, except when electrical tests are required. Electrical shock will cause serious injury or death.

It is very important, when servicing equipment to:

1. Define the basic problem
2. Isolate the probable cause
3. Take corrective action regarding those items hampering proper operation of the equipment.

It is usually relatively easy to define the basic problem, but sometimes very difficult to pinpoint the precise cause.

A Troubleshooting guide is provided in this manual to suggest probable causes and corrective actions for each. Obviously, if the cause is not isolated and corrected, proper operation of the equipment cannot be restored.

Should the problem remain after exhausting the troubleshooting steps suggested, refer to the Order/Service information section of this chapter. (page 9)



ELECTRICAL SHOCK HAZARD: Use extreme care during electrical circuit test. Live circuits will be exposed. Electrical shock will cause serious injury or death.

TROUBLESHOOTING

PROBLEM	PROBABLE CAUSE	CORRECTIVE ACTION
Quality light is not on/flashing when Satellite is in place.	Satellite Receptical or Connector	Check Receptical and Connector Assembly, make sure all pins are tight and in place. Check all soldered wiring. Check continuity, replace if defective.
	Snap Action Switch In Connector	Check continuity, replace if defective.
	Satellite is not in proper position	Place Satellite unit in proper position, making sure the bottom dimples on Satellite base are located on the matching dimples on the Brewer.
Quality light stays on when Satellite is not in place.	Snap Action Switch	Snap Action switch on Connector should open when Satellite is removed from position, shutting off the light. If not, replace Switch.
Quality light flashes constantly	Satellite is still in place	Remove Satellite for more than 4 seconds for timer to reset.
	Satellite was in place when timer initialized	Remove Satellite, Unplug unit for more than 4 seconds. Plug unit in (with Satellite removed)
	Quality Timer	Remove Satellite, Unplug unit for more than 4 seconds. Plug unit in (with Satellite removed) If unit still flashes, replace Quality timer.

SCHEMATIC & WIRING DIAGRAM

(MODEL 9341)

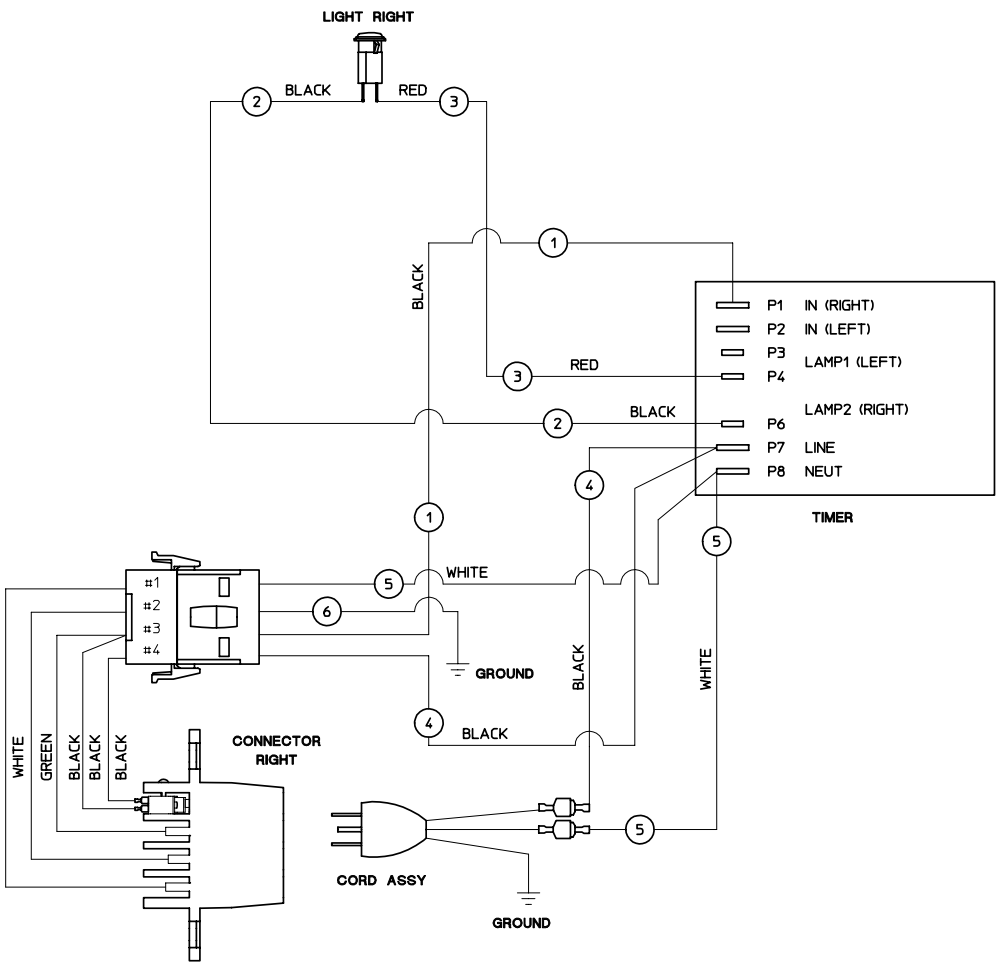
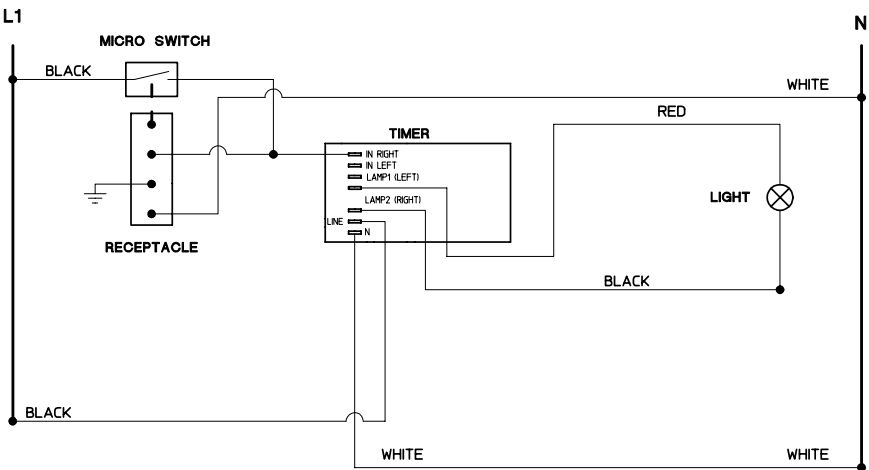

MODEL:	VOLTS:	WATTS:
9341	120	45 W (USE WITH [1] 9105DS OR 9105DP)