

SATELLITE DOCKING STATION
BLOOMFIELD MODEL: 9342

BY



BLOOMFIELD INDUSTRIES
2 ERIK CIRCLE
P.O.BOX 280
VERDI, NV 89439
U.S.A.

FAX (775) 345-8232
PH (775) 345-0444

Email address:
service@wellsbloomfield.com

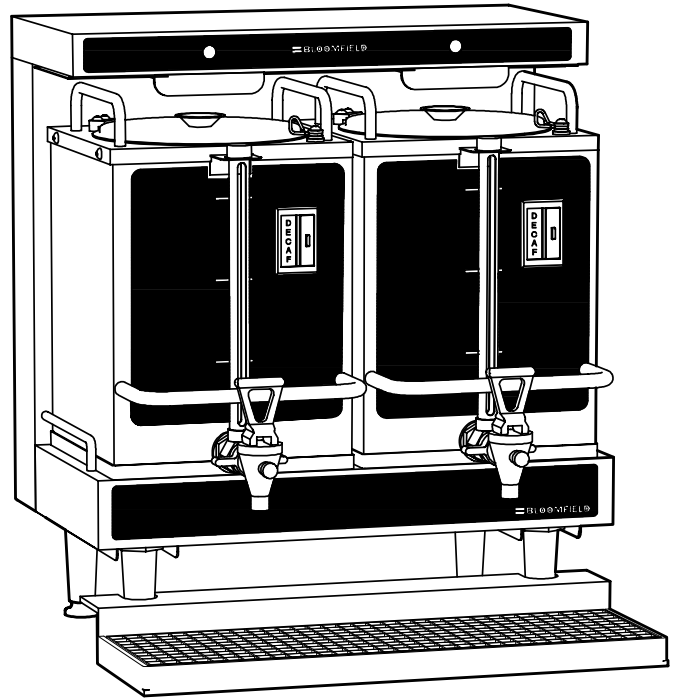

DOCKING STATION SHOWN WITH OPTIONAL SATELLITES AND DRIP TRAY

TABLE OF CONTENTS

OPERATING INSTRUCTIONS	PAGE 2
EXPLODED VIEW & PARTS LIST	PAGE 3
WIRING DIAGRAM	PAGE 4

OPERATING INSTRUCTIONS

WARNING: DO NOT plug in or energize this unit until instructions are read and followed.

Position Satellite to insure light is on (there may be a slight delay before light is on in some models) and bottom is in correct position. Unit will automatically maintain optimum holding temperature.

The light will start flashing after the preset time is reached, indicating if coffee has not been used – then it should be discarded and either brew a fresh batch or remove and clean satellite until ready to use.

TIMER ADJUSTMENT INSTRUCTIONS

Flashing light timer is preset from the factory for 30 minutes. If it is desirable to increase time:

1. Disconnect from power source.
2. Remove back panel.
3. Locate time control and turn to desired setting.
4. Reinstall back panel.
5. Connect power.

NOTE: When light is flashing, Satellite unit will maintain temperature until Satellite is removed from the Docking Station.

There is no power supplied to connector unless the Satellite is in place.

EXPLODED VIEW & PARTS LIST

(MODEL: 9342)

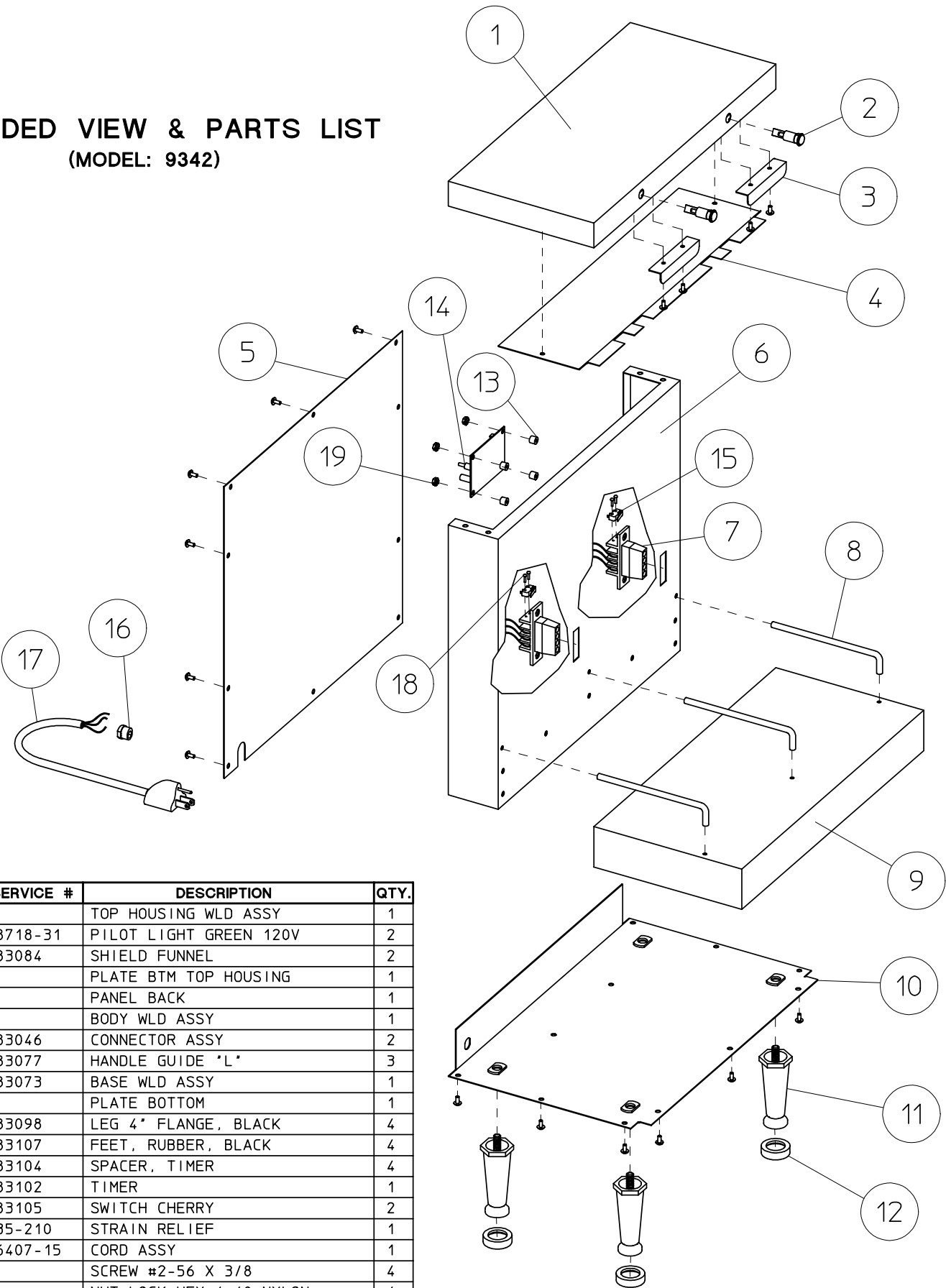

ITEM	SERVICE #	DESCRIPTION	QTY.
1		TOP HOUSING WLD ASSY	1
2	8718-31	PILOT LIGHT GREEN 120V	2
3	83084	SHIELD FUNNEL	2
4		PLATE BTM TOP HOUSING	1
5		PANEL BACK	1
6		BODY WLD ASSY	1
7	83046	CONNECTOR ASSY	2
8	83077	HANDLE GUIDE "L"	3
9	83073	BASE WLD ASSY	1
10		PLATE BOTTOM	1
11	83098	LEG 4" FLANGE, BLACK	4
12	83107	FEET, RUBBER, BLACK	4
13	83104	SPACER, TIMER	4
14	83102	TIMER	1
15	83105	SWITCH CHERRY	2
16	35-210	STRAIN RELIEF	1
17	6407-15	CORD ASSY	1
18		SCREW #2-56 X 3/8	4
19		NUT LOCK HEX 4-40 NYLON	4

ACCESSORY

	3901	DRIP TRAY	1
--	------	-----------	---

(MODEL 9342)

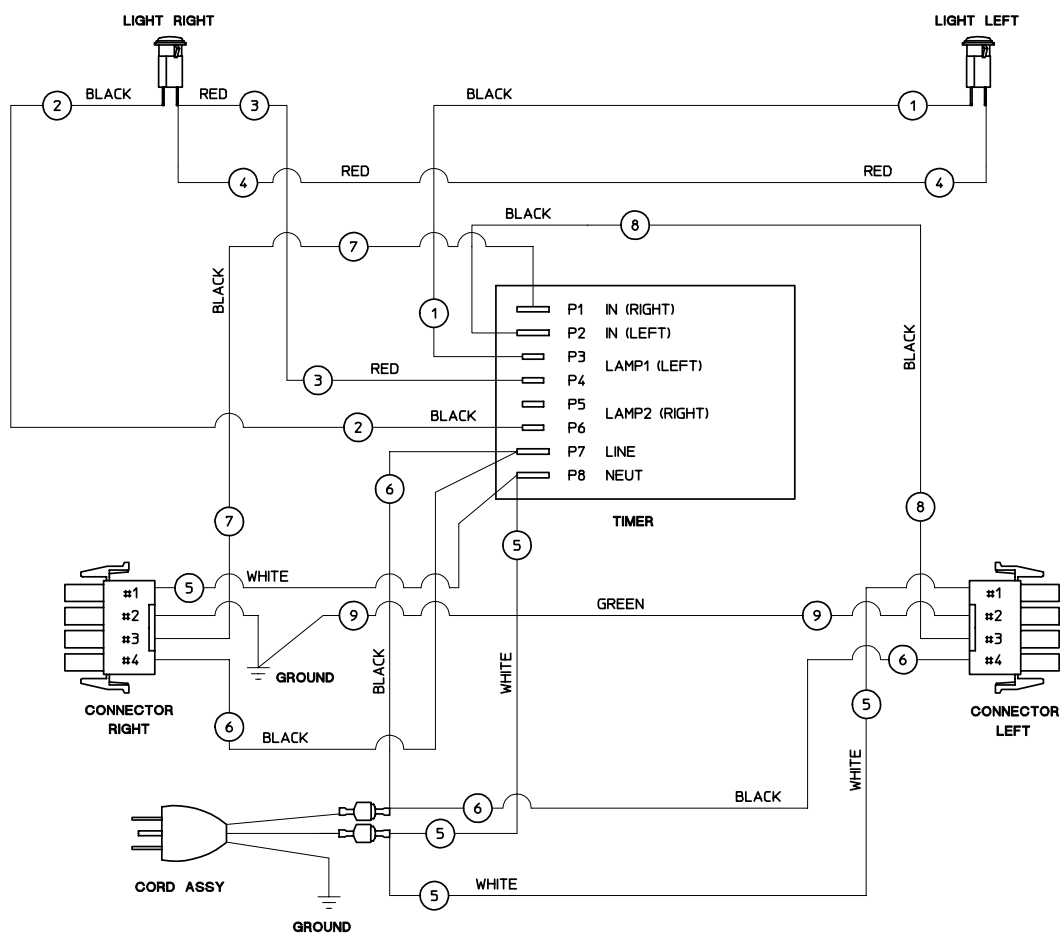
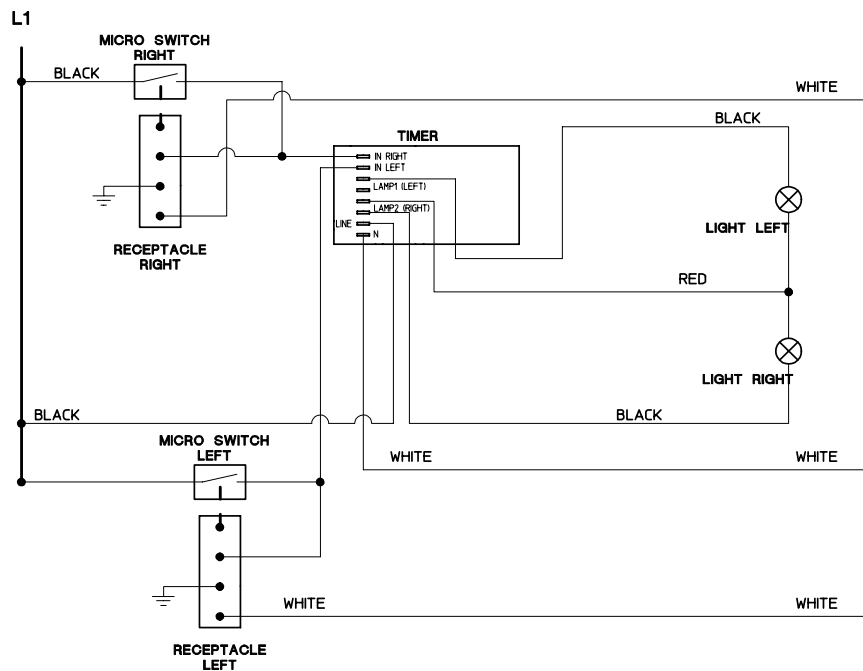

MODEL:	VOLTS:	WATTS:
9342	120	90 (WITH (2) SATELLITES)