

French Press Grinder

Features

Portion Control Grinder

- Accommodates up to 8" (20.3 cm) tall French press or funnel for drip-style brewer.
- Multi-batch setting allows users to specify a French press brew size or grind enough coffee into a funnel to brew larger amounts of drip-style coffee.
- Professional grind provided by large 3³/₁₆" (8.1 cm) diameter burrs powered by quiet, low speed, high torque motor.
- Equipped with commercial grinding burrs to provide maximum grinding precision for small amounts of coffee.
- Three-year warranty on grinding burrs.
- Can use Gourmet funnel for heavier throw weights of coffee.

FPGA-2 DBC Additional Features

- Two hoppers can hold 3 lbs. (1.36 kg) each of regular and decaf or specialty beans.
- Digital touchpad for front of machine programming and LCD read-out.



FPG-2 DBC

(French press not available)
Dimensions: 22.4"H x 8.3"W x 10"D
(56.8cm H x 21.1cm W x 25.4cm D)



FPG

(Funnel sold separately)
Dimensions: 20"H x 8.6"W x 10"D
(50.8cm H x 21.8cm W x 25.4cm D)

For current specification sheets and other information, go to www.bunn.com.

International models may vary in appearance.

Related Products

Precision Burrs

All BUNN grinders use precision burrs to cut (not crush) the coffee beans and deliver consistent grind distribution. BUNN burrs are rated at a Rockwell hardness of 66C, resulting in an exceptionally long burr life.



Short French Press Funnel

Product Number: 38124.0000

Gourmet C Funnel

Product No.: 34559.0000 (7.12" wide)
34559.0001 (7.62" wide)



Paper Filter Pack

Product No.: 20100.0000



Dimensions & Specifications

Model	Product #	Volts	Amps	Capacity	Shipping Weight	Cord Attached	Agency
FPGA (black)	36800.0001	230	1.5	6 lbs. (2.7 kg)	24.6 lbs. (11.2 kg)	Yes	CE
FPGA	36800.0002	230	1.5	6 lbs. (2.7 kg)	24.6 lbs. (11.2 kg)	Yes	CE
FPGA-2 DBC	36400.0003	230	1.5	3 lbs. per hopper (1.4 kg per hopper)	29.6 lbs. (13.4 kg)	Yes	CE
FPG-2 DBC	36400.0002	100	3.6	3 lbs. per hopper (1.4 kg per hopper)	29.6 lbs. (13.4 kg)	Yes	

Electrical: 230 volt 50Hz models require 2 wires plus ground service rated 220-240V, single phase.
100 volt 60Hz models require 2 wires with ground, single phase

Model FPG

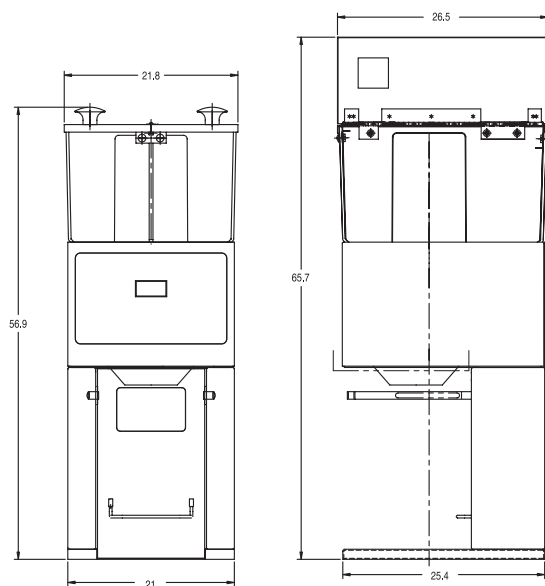

Model FPG-2 DBC

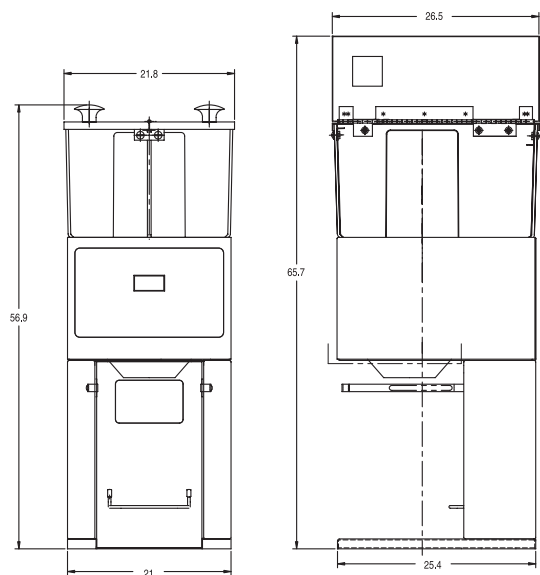

Bunn-O-Matic® Corporation - 1400 Stevenson Drive Springfield, Illinois 62703 • USA • +1-217-529-6601 • Fax +1-217-529-2827 • www.bunn.com

BUNN® practices continuous product research and improvement. We reserve the right to change specifications and product design without notice. Such revisions do not entitle the buyer to corresponding changes, improvements, additions or replacements for previously purchased equipment.

All dimensions shown in centimeters.