

Fresh Mix Dispenser with 1 or 2 Hoppers

ITEM#

PROJECT

DATE

Features

Fresh Mix Dispensers

- Space saving narrow 8" (20.3 cm) cabinet width.
- Variable speed hopper motors offer a wide range of product mix ratios (.75 to 6.6 grams of powder per second).
- Large easy-to-fill translucent hoppers ensure quick and timely refilling.
FMD-1 = one 8 lbs. (3.6 kg)
FMD-2 = two 4 lbs. each (1.8 kg)
- Lighted graphics merchandise drinks for maximizing profits.
- Large hot water reservoir provides 4.2 gal. (15.9 L)/hour serving capacity.
- Adjustable legs and drip tray allows up to 7" (17.8 cm) opening for 591.5 mL (20 oz.) cups.
- Specially designed mixing system guarantees perfect beverages every time.
- Improved automatic rinse reduces run-on after beverage is dispensed.
- Designed to be easily serviced from front and top of machine.



FMD-1

FMD-1 & FMD-2

Dimensions: 30"H x 7.9"W x 21"D
(76.2cm H x 20.1cm W x 53.3cm D)



FMD-2

For current specification sheets and other information, go to www.bunn.com.

Related Products

Easy Clear® EQHP-10
Product No. : 39000.0004

Easy Clear® EQHP-10L
Product No. : 39000.0001



Features deluxe whipper chambers:

1. Robust whipper to ensure full flavor yield.
2. Specially designed self cleaning mixing chamber.
3. Exhaust fan to siphon off moisture that can cause powder buildup.
4. Hot water dispense for easy clean-out.
5. Quick disconnecting parts for thorough sanitizing.

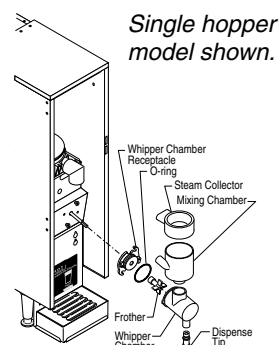

Single hopper
model shown.

Dimensions & Specifications

Model	Product #	Volts	Amps	Tank Heater Watts	Total Watts	Brewing Capacity	Shipping Weight	Cord Attached	Agency
FMD-1A BLK	SET00.0250	230	7.5	1700	1800	4.2 gal./hr.** 15.9 L/hr.	75 lbs. (34 kg)	Yes	CE
FMD-2A BLK	SET00.0252	230	7.5	1700	1800	4.2 gal./hr.** 15.9 L/hr.	81 lbs. (36.7 kg)	Yes	CE

**Based on incoming water temperature of 50°F/10°C.

Electrical: Model requires 2-wires plus ground service rated 220-240V, single phase, 50/60 hz.

Plumbing: 20-90 psi (138-621 kPa) from a 3/8" or larger supply line. A shut-off valve should be installed in the line before the unit. Install a regulator in line when pressure is greater than 90 psi to reduce it to 50 psi. Supplied with 1/4" male flare fitting.

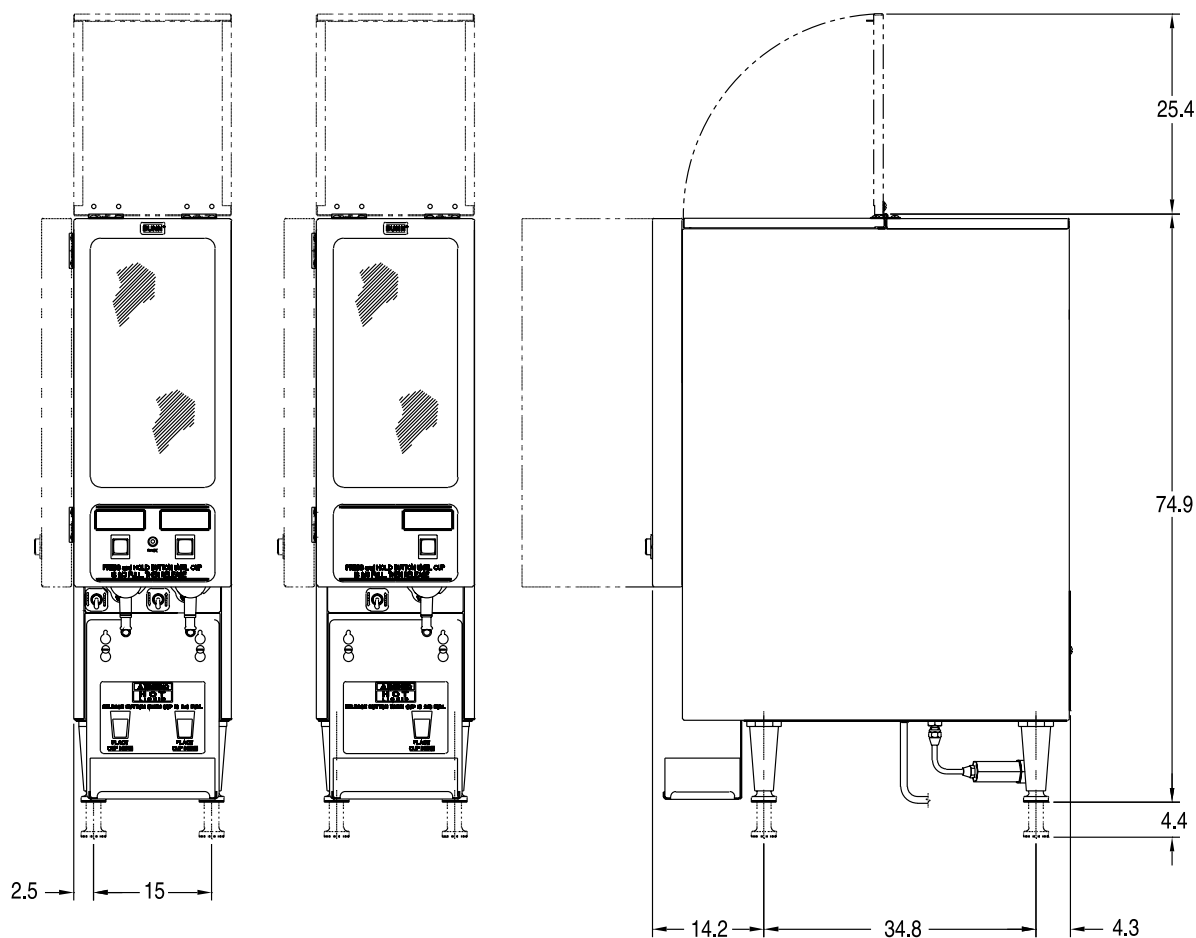
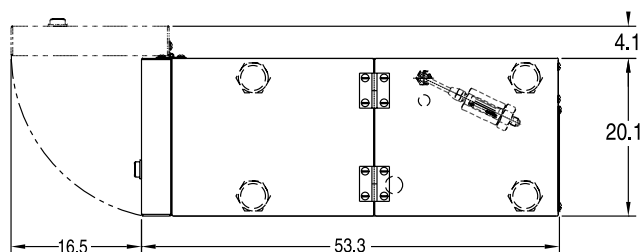

Bunn-O-Matic® Corporation - 1400 Stevenson Drive Springfield, Illinois 62703 • USA • +1-217-529-6601 • Fax +1-217-529-2827 • www.bunn.com

BUNN® practices continuous product research and improvement. We reserve the right to change specifications and product design without notice. Such revisions do not entitle the buyer to corresponding changes, improvements, additions or replacements for previously purchased equipment.

All dimensions shown in centimeters. Bunn-O-Matic Corporation owns all copyrights relating to materials in this publication. Please contact BUNN to request permission to reproduce any portion of this publication.