

Fresh Mix Dispenser with 3 Hoppers

ITEM#

PROJECT

DATE



Model FMD-3

Dimensions: 30"H x 11.3"W x 23.3"D
(76.2 cm H x 28.7 cm W x 59.2 cm D)



Model FMD DBC-3

Dimensions: 30"H x 11.3"W x 23.3"D
(76.2 cm H x 28.7 cm W x 59.2 cm D)

Model FMD DBC-3 4 CUP

Dimensions: 30"H x 11.3"W x 23.3"D
(76.2 cm H x 28.7 cm W x 59.2 cm D)

Features

Fresh Mix Dispenser

- Variable speed motors allow control of product consistency in mixing chamber (.75 to 6.6 grams of powder per second).
- Lighted front graphics for merchandising are easy to exchange: cappuccino or soup.
- Attractive high-impact resin door is dent and scratch resistant. Black finish or stainless with black door.
- Large easy-to-fill translucent hoppers hold 4 lbs. (1.81 Kg) of product each, ensuring quick and timely refilling.
- High speed heavy-duty whipper for complete product mixing.
- Improved automatic rinsing of whipper reduces run-on after beverage is dispensed.
- Adjustable legs and drip tray accommodate 20 oz. (.59 liter) mugs easily.
- Electrical and plumbing components easily accessible through front and top.
- International electrical configurations available.

FMD DBC Dispensers

- Easy-to-program, one-touch portion control for 3 or 4 cup sizes.
- Fast fill perfect for quick service restaurants.
- Each mixing chamber has independent powder to water ratio.
- System setup is password protected for safety.
- Simple setup and hopper throw calibration system.
- 4 - Cup model includes programmable Mocha feature allowing four additional cup sizes per flavour.



Model FMD-3 available
with optional Cafe
Display





**Model FMD DBC-3
Touchpad**



**Model FMD DBC-3 4 CUP
Touchpad**

For current specification sheets and other information, go to www.bunn.com.

Model	Agency Listing
FMD-3	
FMD DBC-3	
FMD DBC-3 4 CUP	

Dimensions & Specifications

CANADA



Model	Product #	Volts	Amps	Tank Heater Watts	Total Watts	Capacity gal/liters**	Cubic ft ³ /m ³	Weight lbs/kg	Cord Attached
FMD-3 BLK	28200.6000	120	11.7	1320	1400	4.2 / 15.9 per hr.	8.3/.23	84 / 38.1	Yes*
FMD-3 BLK	28200.6002	120/240	15.4	3500	3600	8.5 / 32.2 per hr.	8.3/.23	84 / 38.1	Yes†
FMD-3 SS	28200.6001	120	11.7	1320	1400	4.2 / 15.9 per hr.	8.3/.23	78 / 35.3	Yes*
FMD-3 SS	28200.6003	120/240	15.4	3500	3600	8.5 / 32.2 per hr.	8.3/.23	78 / 35.3	Yes†
FMD DBC-3	29250.6000	120	11.7	1320	1400	4.2 / 15.9 per hr.	8.3/.23	84 / 38.1	Yes*
FMD DBC-3 4 CUP	29250.6016	120	11.7	1320	1400	4.2 / 15.9 per hr	8.3/.23	84 / 38.1	Yes*

*Power cord (NEMA 5-15P) 15 Amp-120V machine only. † Power cord (NEMA L14-20P) 120/240 V machine only.

**Based on incoming water temperature of 50°F.

Note: SS=stainless steel cabinet with black door, BLK=black decor.

Electrical: 120V model requires 2-wires plus ground service rated 120V, single phase, 60 hz. 120/240V model requires 3-wires plus ground service rated 120/208 or 120/240V, single phase, 60Hz.

Plumbing: 20-90 psi (138-621 kPa) from a 3/8" (10 mm) or larger supply line. A shut-off valve should be installed in the line before the unit. Install a regulator in line when pressure is greater than 90 psi to reduce it to 50 psi. Supplied with 1/4" (6.4 mm) male flare fitting.

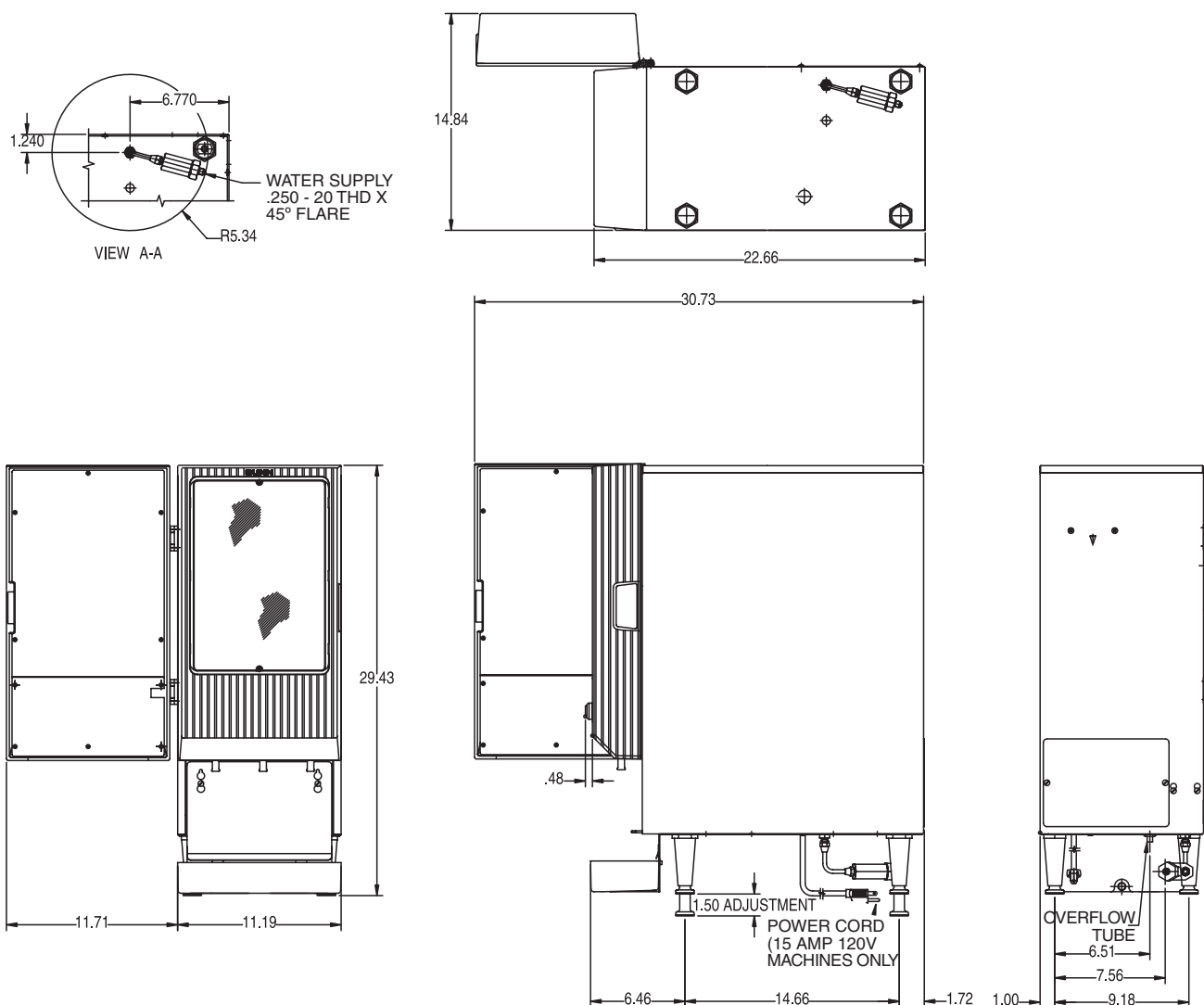

Bunn-O-Matic Corporation of Canada - 280 Industrial Pkwy. S. Aurora, Ontario L4G 3T9 • 905-841-2866 • Fax 905-841-2775 • www.bunn.com

BUNN® practices continuous product research and improvement. We reserve the right to change specifications and product design without notice. Such revisions do not entitle the buyer to corresponding changes, improvements, additions or replacements for previously purchased equipment.

All dimensions shown in inches. Bunn Corporation owns all copyrights relating to materials in this publication. Please contact Bunn Corporation to request permission to reproduce any portion of this publication.