



ECOS

E-Chef™ Open Shelf Module

Project _____
 Item _____
 Quantity _____
 CSI Section 11400
 Approved _____
 Date _____

ECOS: E-Chef™ Open Shelf Module

Models

- ECOS24 24" open shelf module
- ECOS36 36" open shelf module
- ECOS48 48" open shelf module



ECOS36

Standard Features

- Stainless steel top and sides
- Stainless steel bottom and center shelf with 3" riser at the rear
- Standard on 6" legs

Options & Accessories

- Raceways (shipped loose)

Specifications

Exterior: Top is one-piece heavy-gauge stainless steel with integral 2.12" square nosing on front with 1.62" turn up at the rear. Sides are heavy-gauge single thickness stainless steel with 2" bends on front and rear.

Interior: Bottom and center shelves are heavy-gauge stainless steel with a 3" riser at the rear.

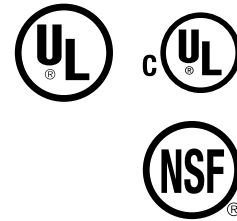

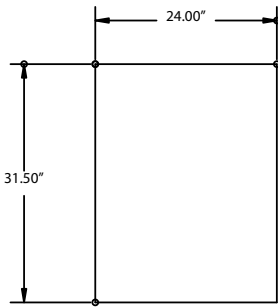
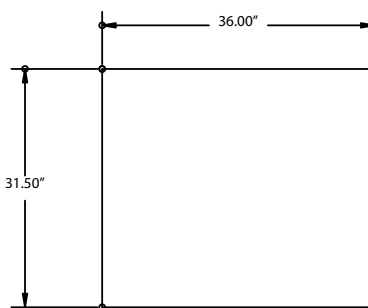
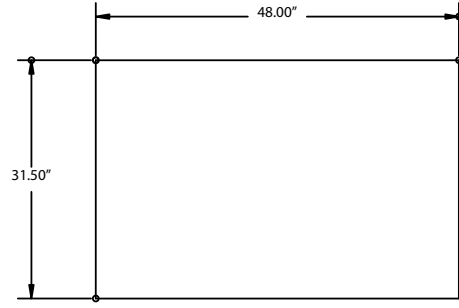
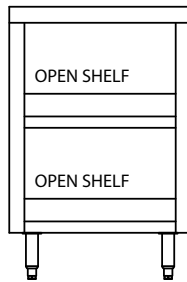
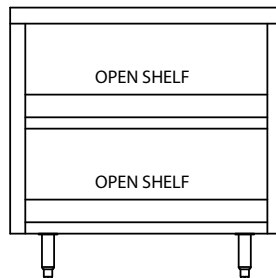
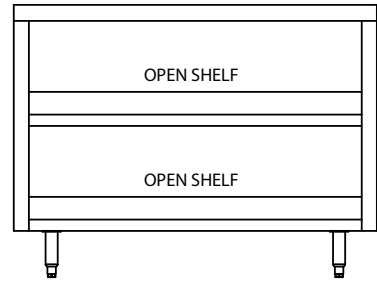
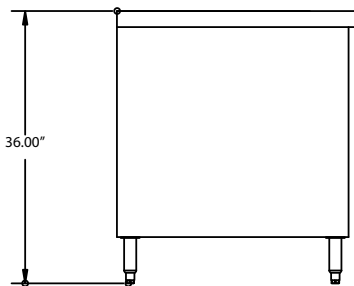
 Plan View
ECOS24

 Plan View
ECOS36

 Plan View
ECOS48

 Elevation View
ECOS24

 Elevation View
ECOS36

 Elevation View
ECOS48

 Side View
all ECOS models

Specifications				
Model	L	D	H	Ship Weight
ECOS24	24"	31.5"	36"	200
ECOS36	36"	31.5"	36"	220
ECOS48	48"	31.5"	36"	250