



PROJECT	
ITEM #	
QUANTITY	DATE
APPROVAL	

F18DR

31.5" (80cm) Deep Remote Quick Glance Rail

Short Form Specifications

Exterior top is one-piece, 16-gauge stainless steel, with integral 2.12" (5.4cm) high square nosing on front. Top has a mechanically cooled refrigerated raised rail at rear with openings to accommodate 1/6 size pans. Pans and adapter bars are provided by others. Pans are recessed .38" in the front for easy access and 3.38" in the rear for proper cooling (see cross section). Rail interior is 22-gauge stainless steel. Raised rail openings have 20-gauge stainless steel hinged removable lids. Unit is equipped with separate expansion valve and on/off switch for refrigerated rail. Temperature in top opening to maintain 33°F (1°C) to 41°F (5°C), at 86°F ambient room temperature, meeting NSF7 requirements.

Exterior Back and Bottom are 24-gauge galvanized steel. Exterior ends are finished with 18-gauge galvanized steel.

Base Interior is 22-gauge stainless steel back and bottom. Base interior ends and door frames are thermoformed ABS plastic. Base is insulated with 1.5" (3.8cm) high density foamed in place polyurethane.

Door(s) have a 22-gauge stainless steel exterior front, with thermoformed ABS plastic interior liner, black recessed handle and snap in magnetic gasket which is easily replaceable. Each interior door section has (1) removable epoxy coated wire shelf.

Base has a blower coil assembly with expansion valve located behind door mullion. Base is equipped with independently controlled thermostat and solenoid valve. On/off switch for unit is located behind the hinged panel.

Unit is mounted on 6.13" (15.6cm) high adjustable stainless steel legs.

Electrical connections are 115 volt, 60 Hertz, single phase. Unit must be hard wired.

Refrigeration System Components — HFC-404A



Optional Accessories & Modifications

- 906A** Stainless steel end
- 505H** Stainless steel back
- 505F** Laminate facing (full front)
- 906E** Laminate end
- 905A** Laminate back
- 1030A** Cutting board (Sanalite or composite)
- 109** Condensate evaporator (1 per coil) for base
- 107F** Tray rack
- 102** Drawers
 - A-(2) 19" in lieu of one door
 - B-(2) 27" in lieu of one door
 - C-(2) 32" in lieu of one door
 - E-(3) 19" in lieu of one door
 - F-(3) 27" in lieu of one door
 - G-(3) 32" in lieu of one door
 - H-(2) 24" in lieu of one door
 - J-(3) 24" in lieu of one door
- 108** Locks
- 120F** Cold pan drain
- 213** *220V/50 cycle

*Inclusion of this option will alter the electrical specifications of the unit



Delfield's
MARK7
modular equipment

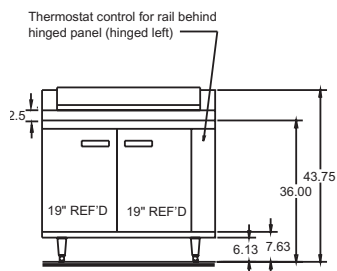

**ELEVATION VIEW
F18DR44**

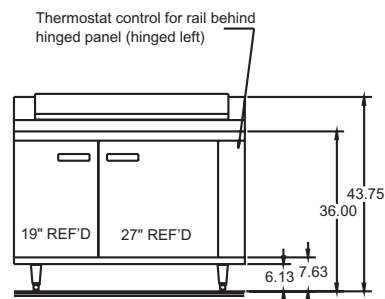

**ELEVATION VIEW
F18DR52**

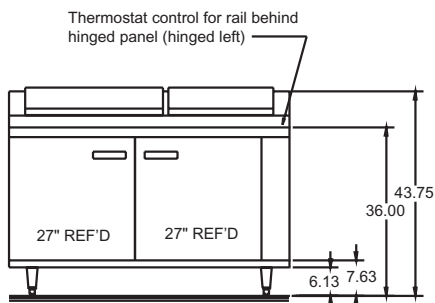

**ELEVATION VIEW
F18DR60**

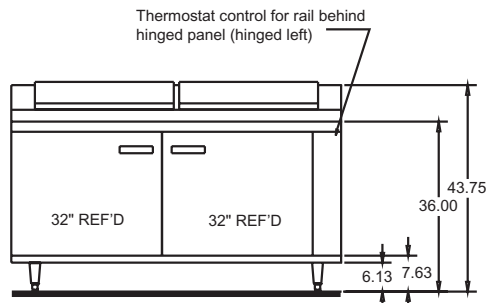

**ELEVATION VIEW
F18DR70**

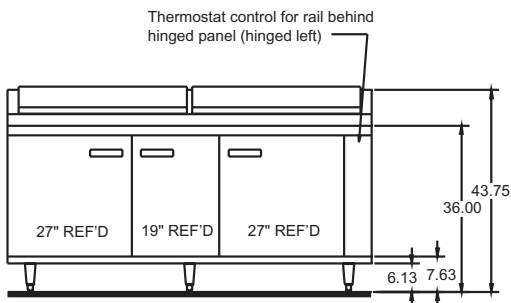

**ELEVATION VIEW
F18DR79**

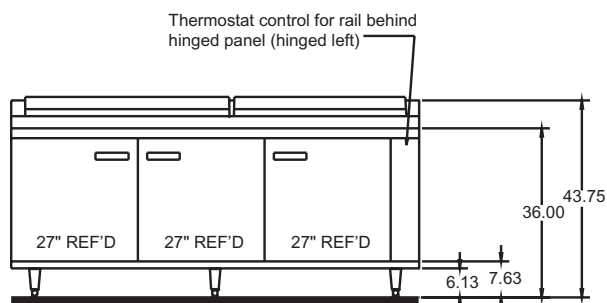

**ELEVATION VIEW
F18DR87**

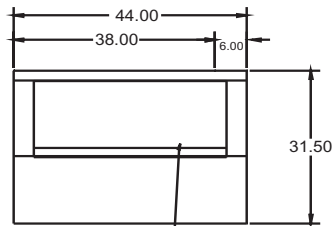

44.00" LG Mech. cooled NSF-7 style raised rail sized to accommodate (10) 1/6 size pans 6" deep. Provide with hinged removable cover, adjustable pan clips and (2) 1/2" adapter bars (pans and adapter bars by others)

**PLAN VIEW
F18DR44**

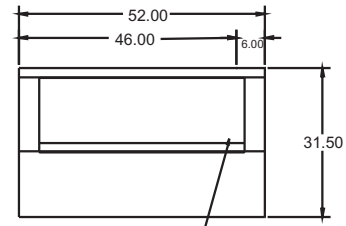

52.00" LG Mech. cooled NSF-7 style raised rail sized to accommodate (12) 1/6 size pans 6" deep. Provide with hinged removable cover, adjustable pan clips and (2) 1/2" adapter bars (pans and adapter bars by others)

**PLAN VIEW
F18DR52**

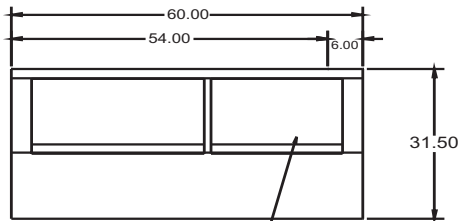

60.00" LG Mech. cooled NSF-7 style raised rail sized with (2) openings sized to accommodate (8) 1/6 size pans 6" deep. Provide with hinged removable cover, adjustable pan clips (pans and adapter bars by others)

**PLAN VIEW
F18DR60**

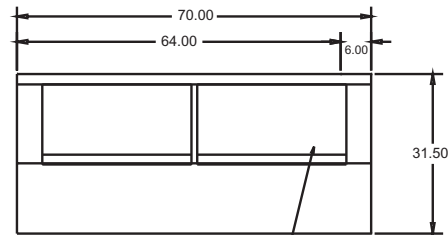

70.00" LG Mech. cooled NSF-7 style raised rail sized to accommodate (8) 1/6 size pans 6" deep each. Provide with hinged removable covers, adjustable pan clips. (pans and adapter bars by others)

**PLAN VIEW
F18DR70**

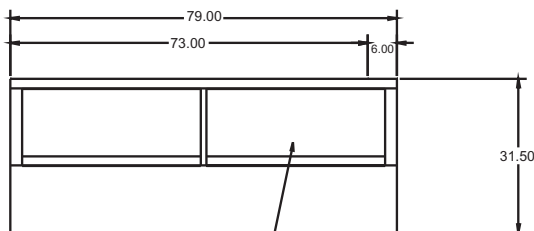

79.00" LG Mech. cooled NSF-7 style raised rail with (2) openings sized to accommodate (10) 1/6 size pans 6" deep each. Provide with hinged removable covers, adjustable pan clips. (pans and adapter bars by others)

**PLAN VIEW
F18DR79**

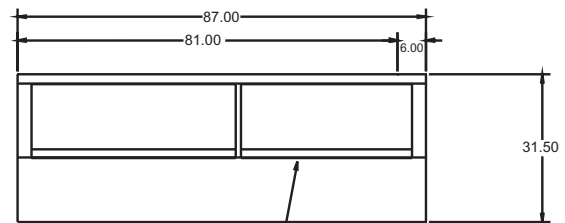

87.00" LG Mech. cooled NSF-7 style raised rail with (2) openings sized to accommodate (12) 1/6 size pans and (10) 1/6 size pans 6" deep. Provide with hinged removable covers, adjustable pan clips. (pans and adapter bars by others)

**PLAN VIEW
F18DR87**

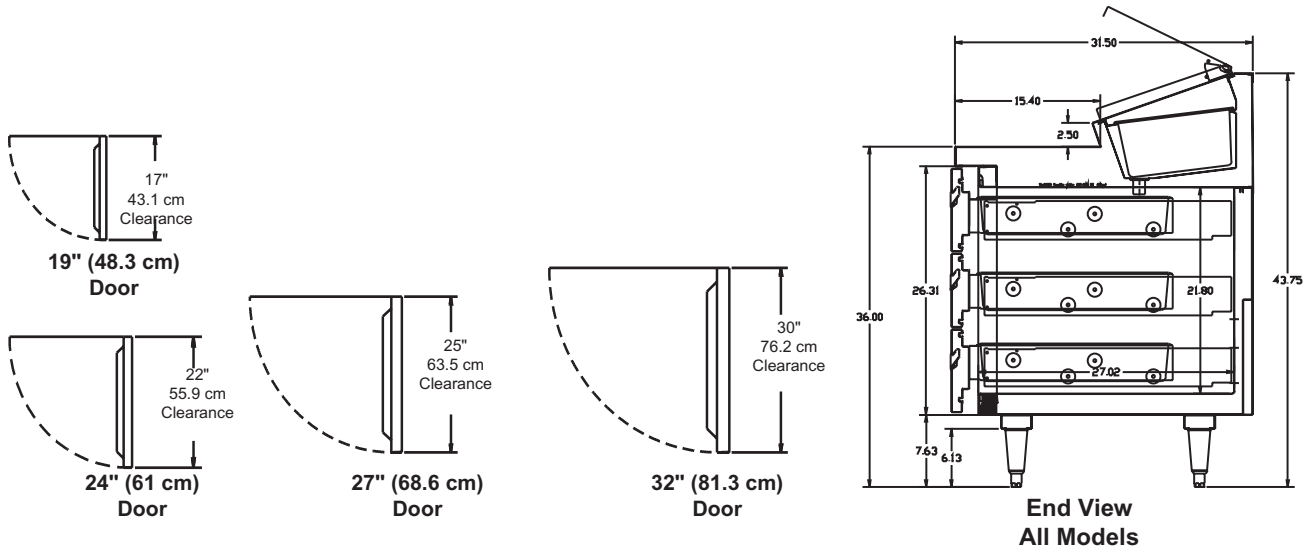

MECHANICAL DETAIL

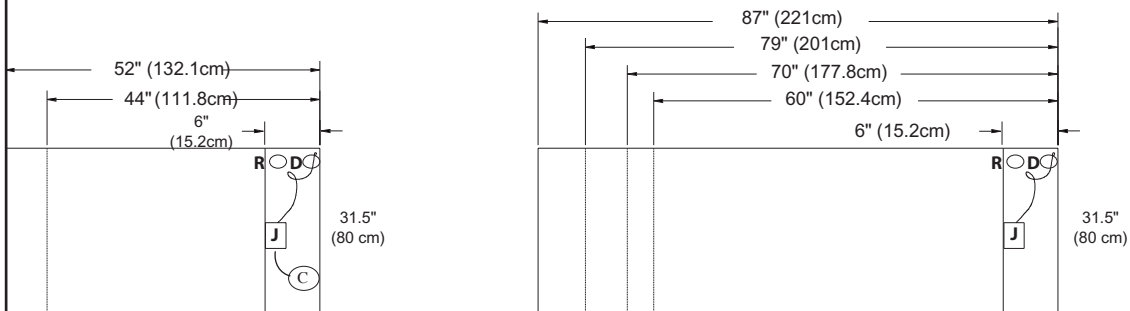

J=JUNCTION BOX
R= REFRIGERATION LINES 1/4" LIQUID, 3/8" SUCTION
D=DRAIN 1/2"

NOTE; UNOBSTRUCTED AIRFLOW MUST BE MAINTAINED TO INSURE UNIT PERFORMANCE AND MAINTAIN WARRANTY.

Technical Data—Standard Unit

MODEL NUMBER	NUMBER OF DOORS	NUMBER OF PANS	STORAGE CU. FT.	SHELF AREA SQ. FT.	H.P.*	AMPS	SHIP WEIGHT LBS/KG	BTU DESIGN LOAD BASE/RAIL	EVAP. CAP. BTU /°TD
F18DR44	(2) 19"	10	9.49	5.12	1/4	3.0	485/220	547/441	120/19
F18DR52	19" & 27"	12	11.81	6.51	1/3	3.0	540/245	625/529	120/23
F18DR60	(2) 27"	14	14.14	7.90	1/3	5.0	620/281	703/617	120/26
F18DR70	(2) 32"	16	17.05	9.64	1/2	5.0	700/317	800/794	120/32
F18DR79	(2) 27" & 19"	20	18.68	10.29	1/2	5.0	735 /333	962/882	240/36
F18DR87	(3) 27"	22	21.30	11.85	3/4	5.0	765/347	1032/970	240/39

*Recommended horsepower