



PROJECT	
ITEM #	
QUANTITY	DATE
APPROVAL	

# F18SC

## 31.5" (80cm) Deep Self-Contained Refrigerated Salad Top Tables

### Short Form Specifications

**Exterior top** is constructed of one-piece 16-gauge stainless steel, with integral 2.12" (5.4cm) square nosing at the front, and 4.00" (10.2cm) high by 2" (5.1cm) deep backsplash at the rear. Top has an opening for use with 1/6 size pans. Pans and adapter bars supplied by others. Pans are recessed 3" (7.6cm), or 2" (5.1cm) and rest on adjustable pan supports. Pan opening has a 20-gauge stainless steel removable cover. Temperature in top opening to maintain 33°F (1°C) to 41°F (5°C), with pans recessed 3" (7.6cm), at 86°F ambient room temperature, meeting NSF7 requirements. Unit has a stainless steel plate shelf 8.4" [21.3cm] above the doors.

**Exterior back** and bottom to be 24-gauge galvanized steel. Exterior ends are 18-gauge galvanized steel.

**Base interior** has a 22-gauge stainless steel back and bottom. Interior ends and door frames are thermoformed ABS plastic. Base is insulated with 1.5" (3.8cm) of high-density foamed-in-place polyurethane.

**Door(s)** have a 22-gauge stainless steel exterior front, with a thermoformed ABS plastic interior liner. Door(s) have a black recessed handle and a snap-in magnetic gasket which is easily replaceable.

**Base** has a machine compartment, standard on the right, with condensing unit, condensate evaporator and an electrical junction box installed. Machine compartment has a louver for access to condensing unit. Blower coil(s) are located behind the door mullions and refrigerate the cabinet. HFC-404A refrigerant and maintains 36°F (2°C) to 40°F (4°C) interior cabinet temperature in the base. Unit is mounted on 6.13" (15.6cm) high adjustable stainless steel legs.

**Electrical connections** are 115 volts, 60 Hertz, single phase. Unit has an 8' (2.4m) long cord and plug.

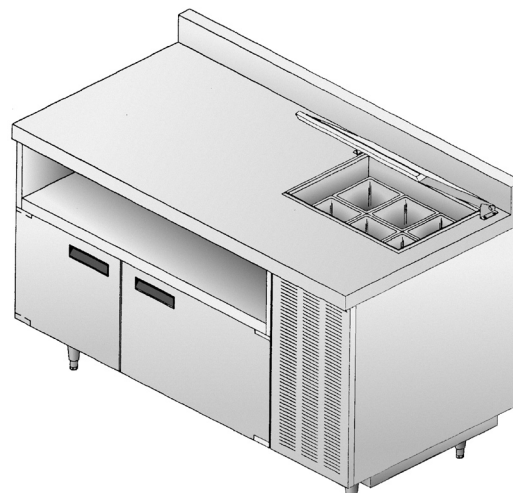

Model F18SC60A

### Optional Accessories & Modifications

<b>906A</b>	Stainless steel end
<b>505H</b>	Stainless steel back
<b>505F</b>	Laminate facing (full front)
<b>906E</b>	Laminate end
<b>905A</b>	Laminate back
<b>1030A</b>	Cutting board (Sanalite or composite)
<b>107F</b>	Tray rack
<b>102</b>	Drawers
	A-(2) 19" in lieu of one door
	B-(2) 27" in lieu of one door
	C-(2) 32" in lieu of one door
<b>108</b>	Locks
<b>120F</b>	Cold pan drain
<b>213</b>	*220V/50 cycle
<b>1027A</b>	Casters

\*Inclusion of this option will alter the electrical specifications of the unit



Delfield's  
**MARK7**  
modular equipment

## 31.5" (80cm) Deep Self-Contained Refrigerated Salad Top Tables

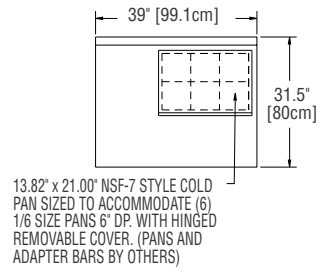

**PLAN VIEW**  
**18SC39A**

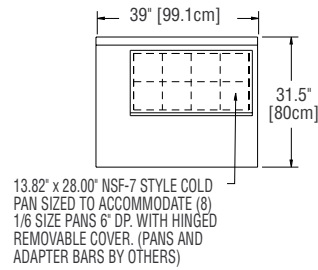

**PLAN VIEW**  
**18SC39B**

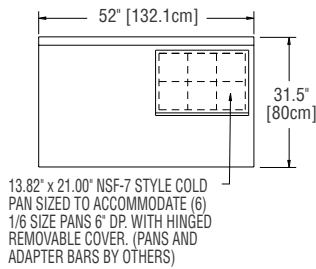

**PLAN VIEW**  
**18SC52A**

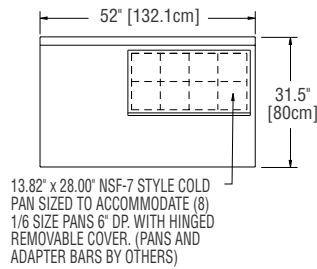

**PLAN VIEW**  
**18SC52B**

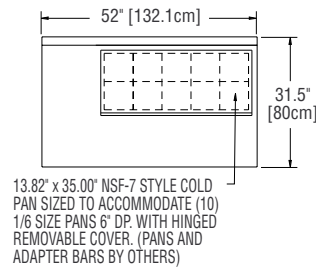

**PLAN VIEW**  
**18SC52C**

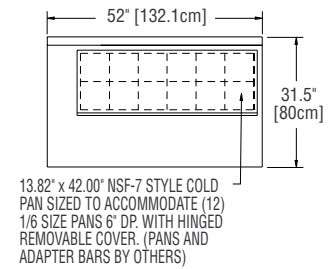

**PLAN VIEW**  
**18SC52D**

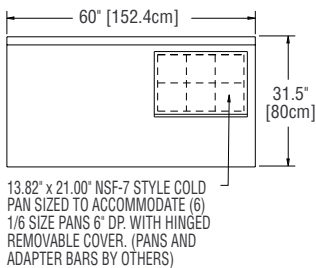

**PLAN VIEW**  
**18SC60A**

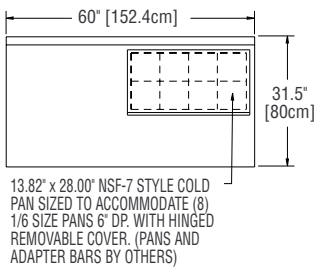

**PLAN VIEW**  
**18SC60B**

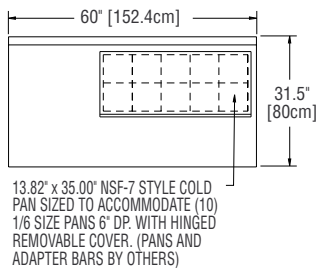

**PLAN VIEW**  
**18SC60C**

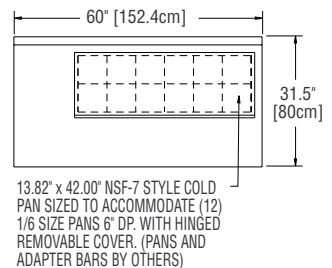

**PLAN VIEW**  
**18SC60D**

## 31.5" (80cm) Deep Self-Contained Refrigerated Salad Top Tables

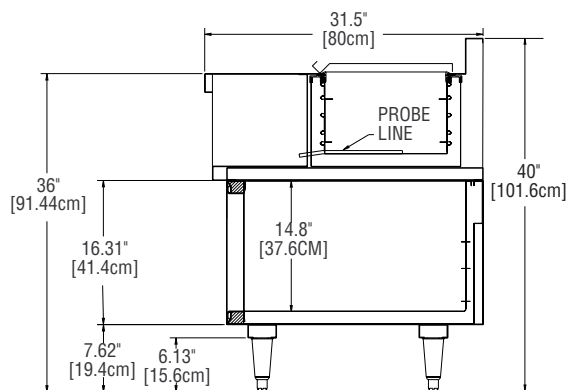

PAN COVER WHEN OPEN EXTENDS TO A HEIGHT OF 12" (30.5cm)

**END VIEW  
ALL MODELS**



**19" [48.3cm]  
DOOR**

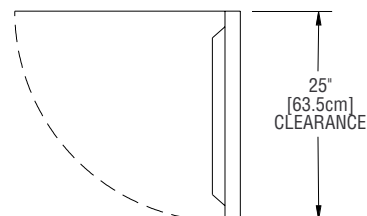

**27" [68.6cm]  
DOOR**

**ELEVATION VIEW  
F18SC39A,  
F18SC39B**

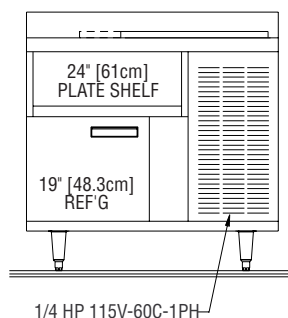

**ELEVATION VIEW  
F18SC52A,  
F18SC52B,  
F18SC52C,  
F18SC52D**

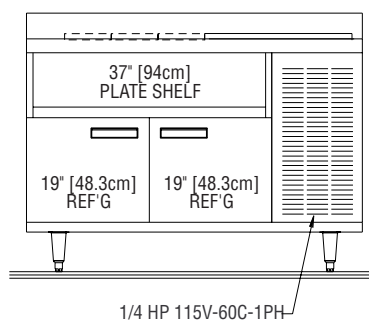

**ELEVATION VIEW  
F18SC60A,  
F18SC60B,  
F18SC60C,  
F18SC60D**

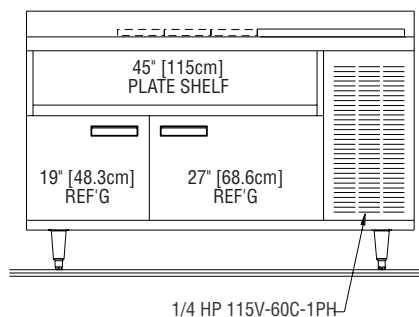

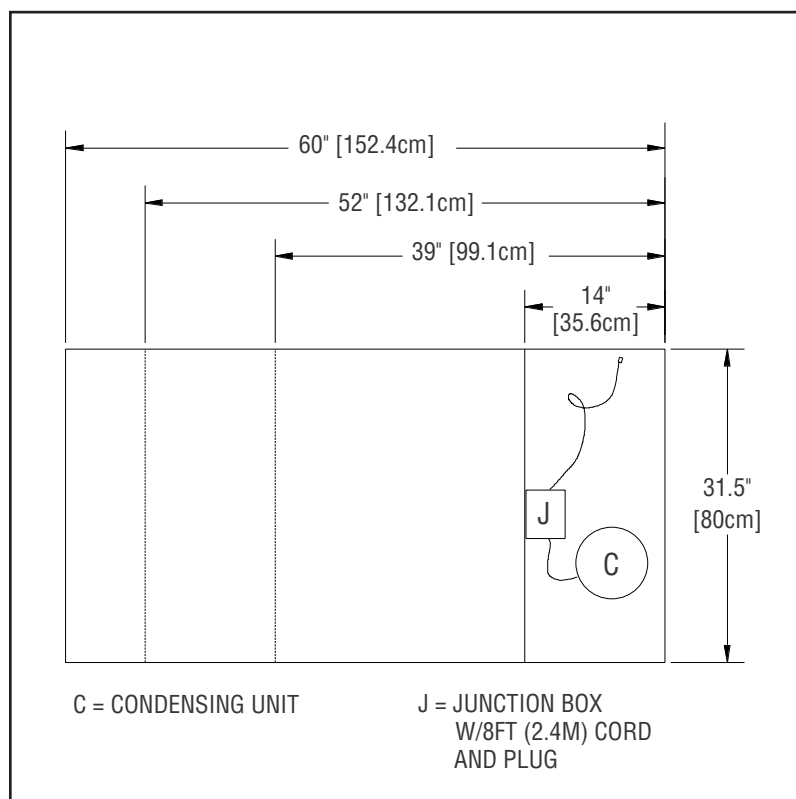
**31.5" (80cm) Deep Self-Contained Refrigerated Salad Top Tables**

NOTE; UNOBSTRUCTED AIRFLOW MUST BE MAINTAINED TO INSURE UNIT PERFORMANCE AND MAINTAIN WARRANTY.

**Mechanical Data—Standard Unit**

MODEL NUMBER	NUMBER OF DOORS	# OF PANS	STORAGE CU. FT.	H.P.	VOLTS/HERTZ/ PHASE	AMPS	NEMA	SHIP WEIGHT LBS / KG	BTU DESIGN BASE/RAIL	BTU SYSTEM CAP. BASE/RAIL
F18SC39A	(1) 19"	6	4.11	1/4	115/60/1	10.0	5-15P	400/181	280/265	1903/745
F18SC39B	(1) 19"	8	4.11	1/4	115/60/1	10.0	5-15P	390/177	280/353	1903/867
F18SC52A	(2) 19"	6	6.94	1/4	115/60/1	10.0	5-15P	460/208	444/265	1903/745
F18SC52B	(2) 19"	8	6.94	1/4	115/60/1	10.0	5-15P	450/204	444/353	1903/867
F18SC52C	(2) 19"	10	6.94	1/4	115/60/1	10.0	5-15P	440/199	444/441	1903/971
F18SC52D	(2) 19"	12	6.94	1/4	115/60/1	10.0	5-15P	480/195	444/529	1903/1061
F18SC60A	(2) 19" & 27"	6	8.69	1/4	115/60/1	10.0	5-15P	500/227	515/265	2314/667
F18SC60B	(2) 19" & 27"	8	8.69	1/4	115/60/1	10.0	5-15P	490/222	515/353	2314/798
F18SC60C	(2) 19" & 27"	10	8.69	1/4	115/60/1	10.0	5-15P	480/217	515/441	2314/916
F18SC60D	(2) 19" & 27"	12	8.69	1/4	115/60/1	10.0	5-15P	470/213	515/529	2314/1023