



PROJECT	
ITEM #	
QUANTITY	DATE
APPROVAL	

**F18SR****31.5" (80cm) Deep Remote Refrigerated Salad Top Tables****Short Form Specifications**

**Exterior Top** is constructed of one piece 16-gauge stainless steel, with integral 2.12" (5.4cm) square nosing on front and 4" (10.2cm) high by 2" (5.1cm) thick backsplash on rear. Top has an opening for use with 1/6 size pans. Pan and adapter bars supplied by others. Pans are recessed 3" (7.6cm) or 2" (5.1cm) and rest on adjustable pan supports. Pan opening to have a removable 20-gauge stainless steel cover. Temperature in top opening to maintain 33°F (1°C) to 41°F (5°C), with pans recessed 3" (7.6cm), at 86°F ambient room temperature, meeting NSF7 requirements.

**Exterior back** and bottom of base are constructed of 24-gauge galvanized steel. Exterior ends are constructed of 18-gauge galvanized steel.

Unit has a stainless steel plate shelf 8.4" [21.3cm] high above the doors.

**Base interior** has a 22-gauge stainless steel back and bottom. Interior ends and door frames are thermoformed ABS plastic. Base is insulated with 1.5" (3.8cm) of high density foamed in place polyurethane.

**Door(s)** are constructed with ABS plastic interior liner and 22-gauge stainless steel exterior front. Door(s) have a black recessed handle and a snap in magnetic gasket which is easily replaceable.

**Base** is furnished with a blower coil especially made to fit behind door mullion. Blower coil housing to enclose refrigeration lines, evaporator coil, expansion valve and fans and includes thermostat and solenoid valve.

Unit is mounted on 6.13" (15.6cm) high adjustable stainless steel legs.

**Refrigeration System Components** — HFC-404A.

**Electrical connections** are 115 volts, 60 Hertz, single phase. Unit must be hard wired.

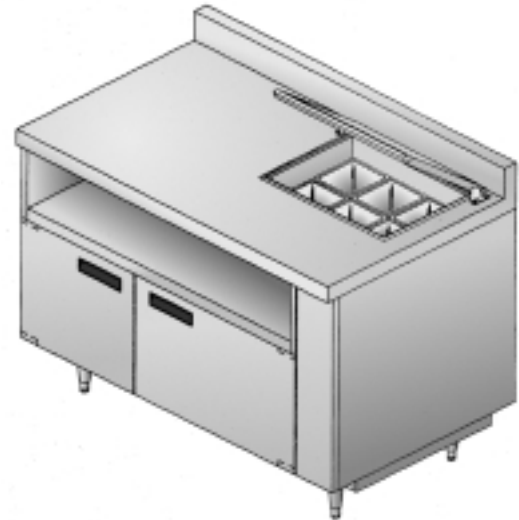
**Model F18SR52A****Optional Accessories & Modifications**

- 906A** Stainless steel end
- 505H** Stainless steel back
- 505F** Laminate facing (full front)
- 906E** Laminate end
- 905A** Laminate back
- 1030F** Cutting board (Sanalite or composite)
- 109** Condensate evaporator (1 per coil) for base
- 107F** Tray rack
- 102** Drawers
  - A-(2) 19" in lieu of one door
  - B-(2) 27" in lieu of one door
  - C-(2) 32" in lieu of one door
- 108** Locks
- 120F** Cold pan drain
- 213** \*220V/50 cycle

\*Inclusion of this option will alter the electrical specifications of the unit



Delfield's  
**MARK7**  
modular equipment

## 31.5" (80cm) Deep Remote Refrigerated Salad Top Tables

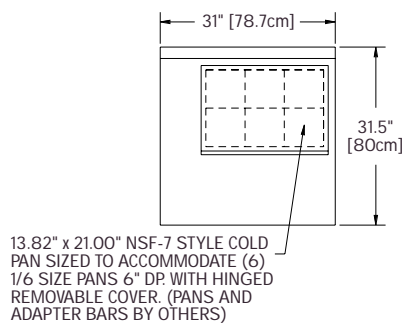

**PLAN VIEW  
F18SR31A**

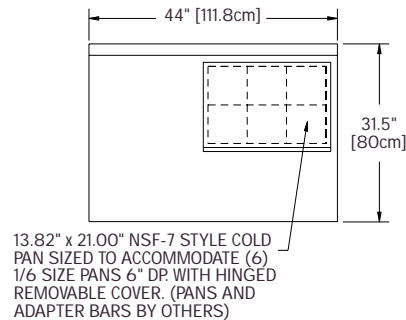

**PLAN VIEW  
F18SR44A**

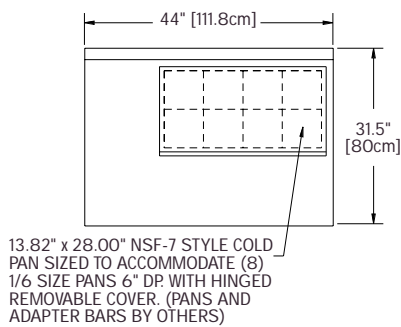

**PLAN VIEW  
F18SR44B**

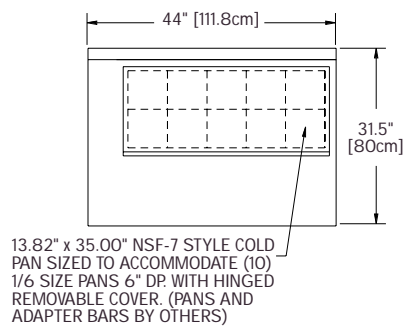

**PLAN VIEW  
F18SR44C**

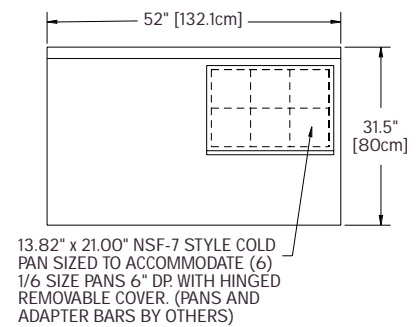

**PLAN VIEW  
F18SR52A**

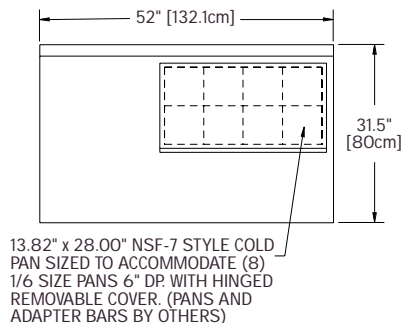

**PLAN VIEW  
F18SR52B**

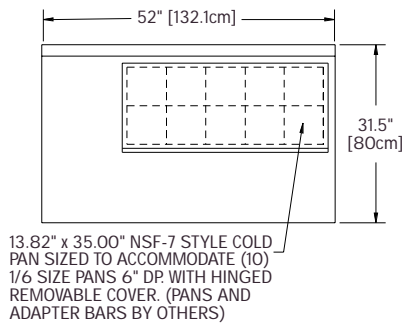

**PLAN VIEW  
F18SR52C**

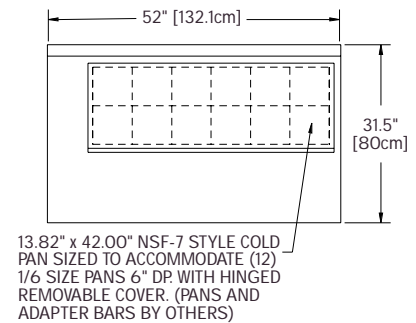

**PLAN VIEW  
F18SR52D**

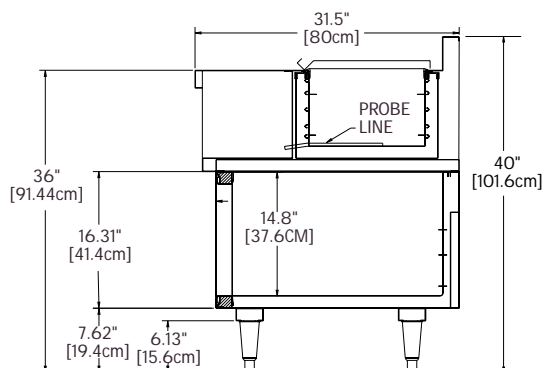

PAN COVER WHEN OPEN EXTENDS TO A HEIGHT OF 12" (30.5cm)

**END VIEW  
ALL MODELS**



**19" [48.3cm]  
DOOR**

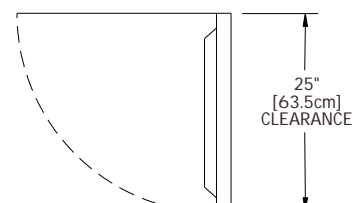

**27" [68.6cm]  
DOOR**

**ELEVATION VIEW  
F18SR31A**

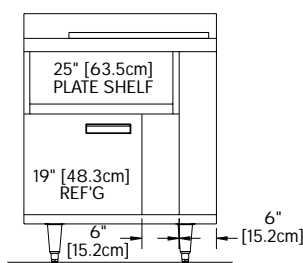

**ELEVATION VIEW  
F18SR44A,  
F18SR44B,  
F18SR44C**

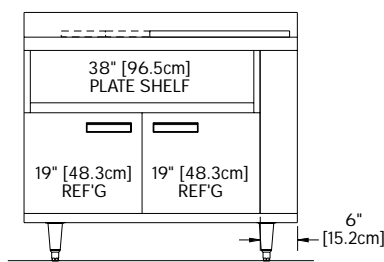

**ELEVATION VIEW  
F18SR52A,  
F18SR52B,  
F18SR52C,  
F18SR52D**

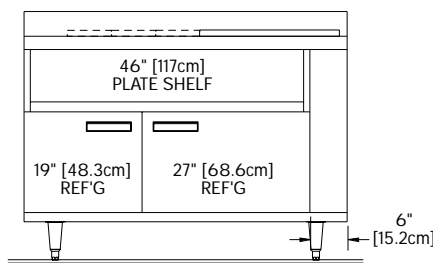

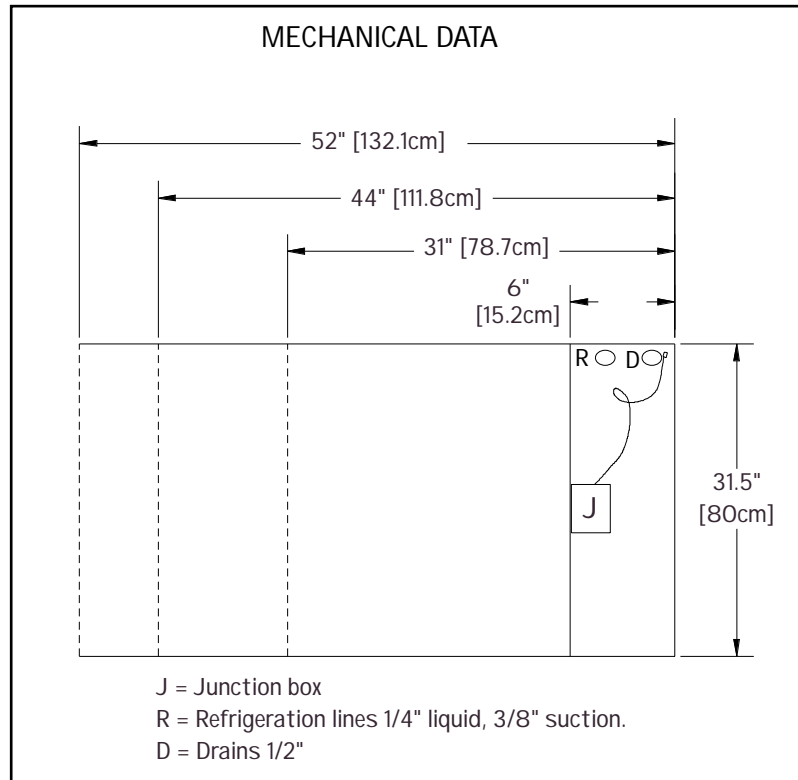

### Mechanical Data-Standard Unit

MODEL NUMBER	NUMBER OF DOORS	NUMBER OF PANS	STORAGE CU. FT.	H.P.*	VOLTS/HERTZ/ PHASE	AMPS	SHIP WEIGHT LBS / KG	BTU DESIGN LOAD BASE/RAIL	EVAP. CAP. BTU/°TD
F18SR31A	(1) 19"	6	4.11	1/4*	115/60/1	3.0	340/154	280/265	120
F18SR44A	(2) 19"	6	6.94	1/4*	115/60/1	3.0	380/172	491/441	120
F18SR44B	(2) 19"	8	6.94	1/4*	115/60/1	3.0	370/168	491/441	120
F18SR44C	(2) 19"	10	6.94	1/4*	115/60/1	3.0	360/163	491/441	120
F18SR52A	19" & 27"	6	8.69	1/4*	115/60/1	3.0	430/195	532/529	120
F18SR52B	19" & 27"	8	8.69	1/4*	115/60/1	3.0	420/190	532/529	120
F18SR52C	19" & 27"	10	8.69	1/4*	115/60/1	3.0	410/186	532/529	120
F18SR52D	19" & 27"	12	8.69	1/4*	115/60/1	3.0	400/181	532/529	120

\*Recommended horsepower