



PROJECT	
ITEM #	
QUANTITY	DATE
APPROVAL	

# F18WR

## 31.5" (80cm) Deep Remote Refrigerated Work Tables

### Short Form Specifications

**Exterior top** is constructed of one piece 16-gauge stainless steel, with integral 2.12" (5.4cm) square nosing on front and 4" (10.2cm) high by 2" (5.1cm) thick backsplash on rear. Top is insulated with 2" (5.1cm) high density insulation.

**Exterior back** and bottom of base are 24-gauge galvanized steel. Exterior ends are constructed of 18-gauge galvanized steel.

**Base interior** has 22-gauge stainless steel back and bottom. Interior ends and door frames are thermoformed ABS plastic. Base is insulated with 1.5" (3.8cm) high density foamed in place polyurethane.

**Door(s)** have a thermoformed plastic ABS plastic interior liner and 22-gauge stainless steel exterior front. Door(s) have black recessed handle(s) and a snap-in magnetic gasket which is easily replaceable. Unit is furnished with (1) epoxy coated wire shelf for each door section.

**Base** is furnished with blower coil made to fit behind door mullion. Blower coil housing encloses refrigeration lines, evaporator coil, expansion valve, fans and includes thermostat and solenoid valve. Unit is designed to maintain 36°F (2°C) to 40°F (4°C) interior cabinet temperature.

Unit is mounted on 6.13" (15.6cm) high adjustable stainless steel legs.

**Refrigeration Systems Component** — HFC-404A

**Electrical connections** are 115 volt, 60 Hertz, single phase. Unit must be hard wired.



Model F18WR44

### Optional Accessories & Modifications

- 906A** Stainless steel end
- 505H** Stainless steel back
- 505F** Laminate facing (full front)
- 906E** Laminate end
- 905A** Laminate back
- 1030A** Cutting board (Sanalite or composite)
- 109** Condensate evaporator (1 per coil)
- 107F** Tray rack
- 102** Drawers
  - A-(2) 19" in lieu of one door
  - B-(2) 27" in lieu of one door
  - C-(2) 32" in lieu of one door
  - E-(3) 19", 27" or 32" in lieu of one door
- 108** Locks
- 213** \*220V/50 cycle

\*Inclusion of this option will alter the electrical specifications of the unit



Delfield's  
**MARK7**  
modular equipment

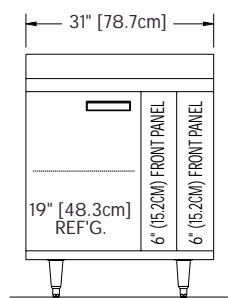

ELEVATION VIEW  
F18WR31

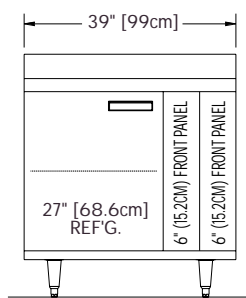

ELEVATION VIEW  
F18WR39

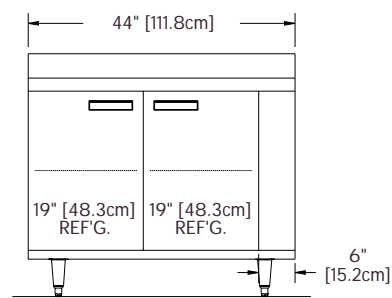

ELEVATION VIEW  
F18WR44

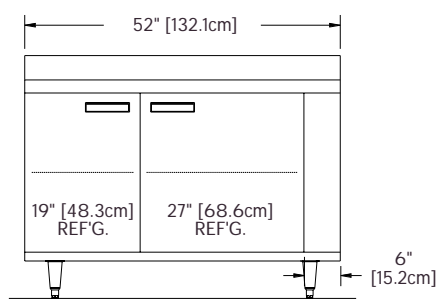

ELEVATION VIEW  
F18WR52

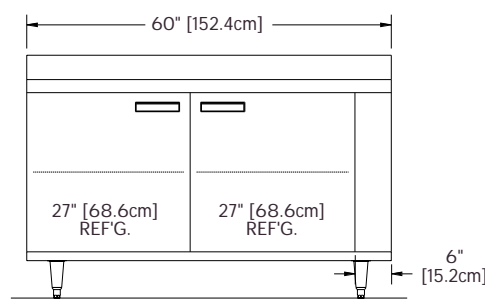

ELEVATION VIEW  
F18WR60

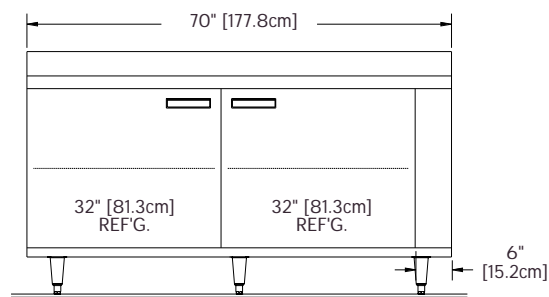

ELEVATION VIEW  
F18WR70

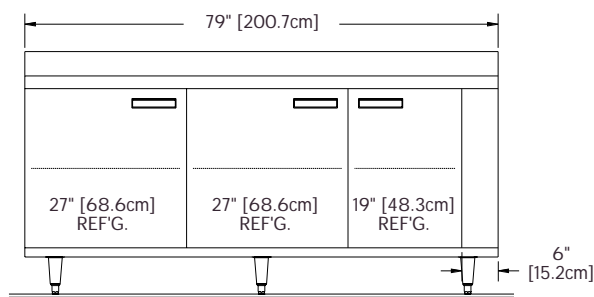

ELEVATION VIEW  
F18WR79

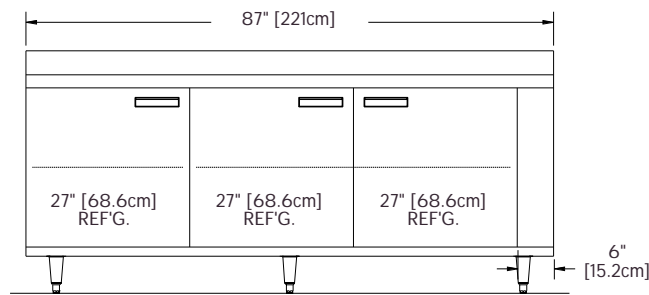

ELEVATION VIEW  
F18WR87

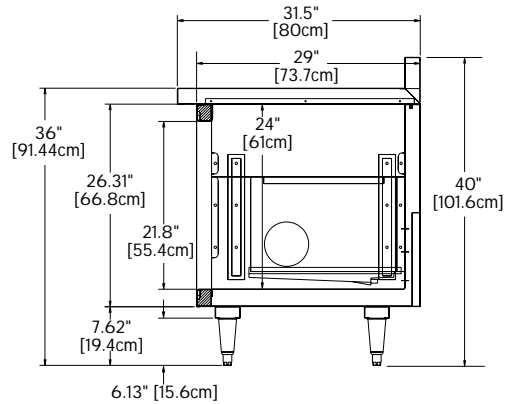

END VIEW  
ALL MODELS

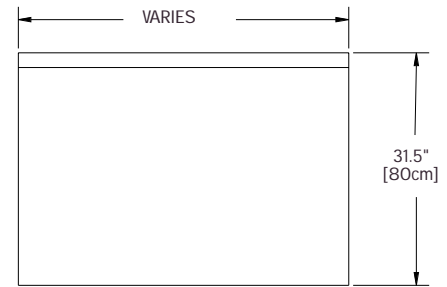

PLAN VIEW  
ALL MODELS



19" [48.3cm]  
DOOR

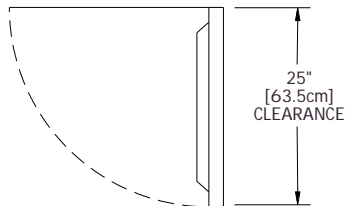

27" [68.6cm]  
DOOR

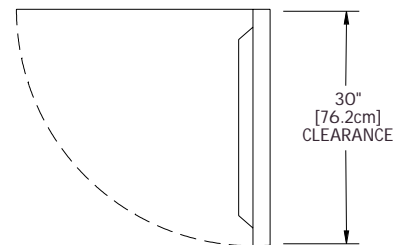

32" [81.3cm]  
DOOR

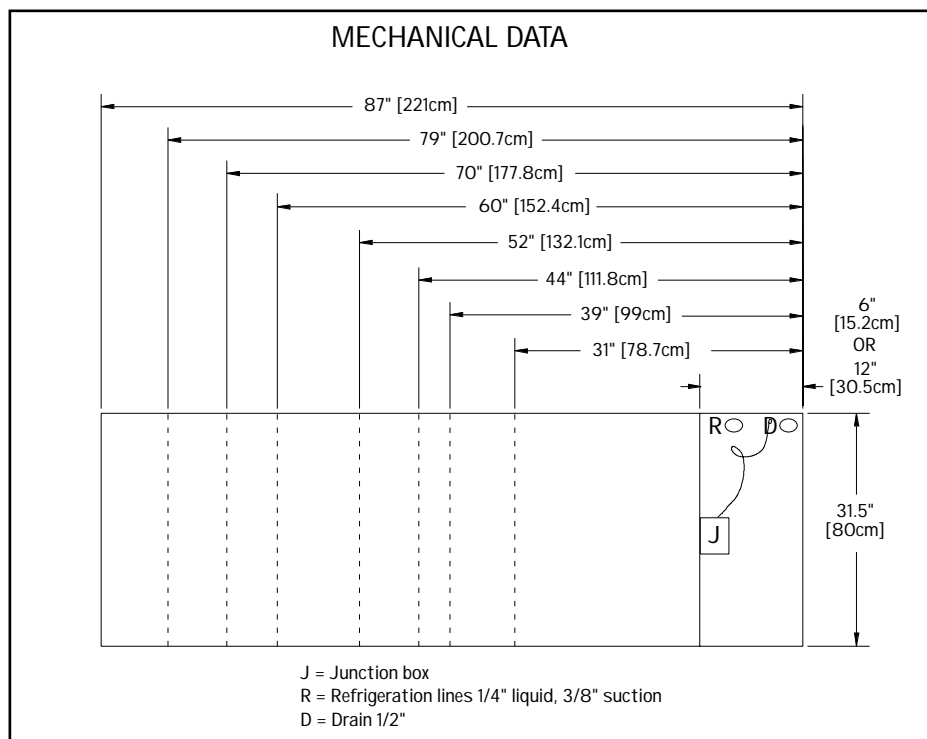

### Mechanical Data-Standard Unit

MODEL NUMBER	NUMBER OF DOORS	STORAGE CU. FT.	SHELF AREA SQ. FT.	H.P.*	VOLTS/HERTZ/ PHASE	AMPS	SHIP WEIGHT LBS/KG	BTU LOAD	EVAP. CAP. BTU/°TD
F18WR31	(1) 19"	6.99	2.56	1/5*	115/60/1	3.0	345/157	383	120
F18WR39	(1) 27"	9.77	3.95	1/5*	115/60/1	3.0	350/159	465	120
F18WR44	(2) 19"	11.52	5.12	1/5*	115/60/1	3.0	365/166	605	120
F18WR52	19" & 27"	14.31	6.51	1/5*	115/60/1	3.0	380/173	686	120
F18WR60	(2) 27"	18.85	7.90	1/4*	115/60/1	3.0	400/182	768	120
F18WR70	(2) 32"	20.59	9.64	1/4*	115/60/1	3.0	415/188	869	120
F18WR79	(2) 27" & 19"	23.05	10.29	1/4*	115/60/1	6.0	435/197	1050	240
F18WR87	(3) 27"	25.83	11.85	1/4*	115/60/1	6.0	495/225	1131	240

\*Recommended horsepower