



PROJECT	
ITEM #	
QUANTITY	DATE
APPROVAL	

**F17DD****Dry Drawer Equipment Stands****Long Form Specifications**

Top is constructed of 18-gauge stainless steel, with integral front marine edge nosing and rear backsplash. Spline bars are made of 12-gauge stainless steel and run front to back on both the left and right stainless steel sides for support and spline purposes. Two pieces of 14-gauge U-channel are welded and glued with Construction adhesive to the under side of the top for strength and sound deadening. As a standard, 14-gauge cutting board brackets are attached to each side and house a 1.25" thick x 9.5" deep maple cutting board.

Dry drawer system is sized to hold 12 x 20 x 4 or 6" deep hotel pans and smaller fractional pans. Drawer track assembly is constructed of 11-gauge stainless steel and each set of tracks are mounted in individual galvanized boxes. Drawer track rollers are made of Delrin 100 NC-10 and do not require grease for operation. Intermediate tracks are removable without tools. Drawer boxes are designed with "easy pan grip flanges". Tracks are designed with a stay shut feature that holds the drawer tight to the base front on uneven floors. Exterior drawer fronts are made of 22-gauge stainless steel; and an interior stainless liner backed with 14-gauge braces. Handles are recessed black plastic and held in with a positive lock system.

Unit is supported with two 14-gauge leg rails that run the entire length of the unit. Leg rails are welded to the bottom drawer boxes and are tied together with two 12-gauge braces running front to back. Caster/leg boxes are welded inside the leg rail and 6.12" adjustable legs are mounted as standard with (4) 5/16" bolts.

**Model F17DD54****Optional Accessories and Modifications**

- 905B Stainless steel back
- 906A Stainless steel end
- 905A Laminate back
- 906E Laminate end
- 1027A Casters
- 505G Laminate facing (drawer base)
- 108 Lock



Delfield's  
**MARK7**  
modular equipment

## Dry Drawer Equipment Stands

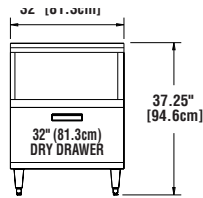

**ELEVATION VIEW  
F17DD32**

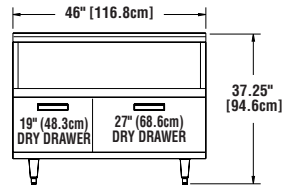

**ELEVATION VIEW  
F17DD46**

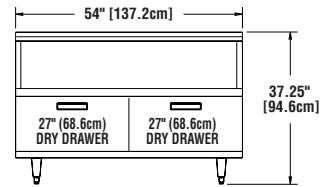

**ELEVATION VIEW  
F17DD54**

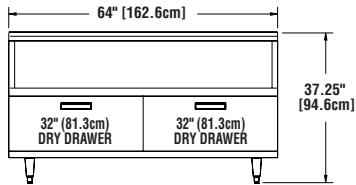

**ELEVATION VIEW  
F17DD64**

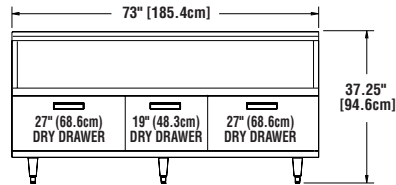

**ELEVATION VIEW  
F17DD73**

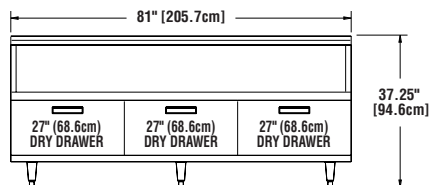

**ELEVATION VIEW  
F17DD81**

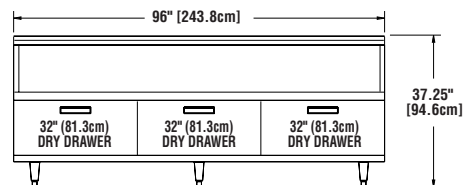

**ELEVATION VIEW  
F17DD96**

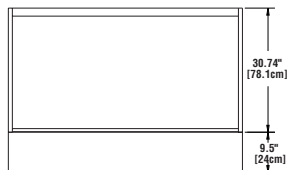

**PLAN VIEW  
ALL MODELS**

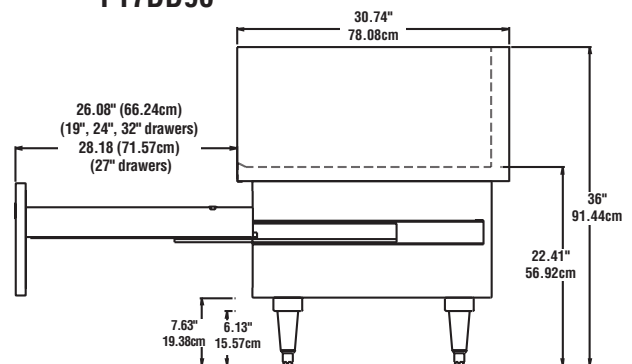

### Mechanical Data—Standard Unit

MODEL NUMBER	NUMBER OF DRAWERS	12X20X6 PAN CAPACITY	MODEL LENGTH	SHIP WEIGHT
<b>F17DD32</b>	(1) 32"	2	32" (81.3cm)	290 lbs/ 131 kg
<b>F17DD46</b>	(1) 19" (1) 27"	3	46" (116.8cm)	350 lbs/ 159 kg
<b>F17DD54</b>	(2) 27"	4	54" (137.2cm)	390 lbs/ 177 kg
<b>F17DD64</b>	(2) 32"	4	64" (162.6cm)	430 lbs/ 195 kg
<b>F17DD73</b>	(1) 19 (2) 27"	5	73" (185.4cm)	475 lbs/ 215 kg
<b>F17DD81</b>	(3) 27"	6	81" (205.7cm)	520 lbs/ 236 kg
<b>F17DD96</b>	(3) 32"	6	96" (243.8cm)	600 lbs/ 272 kg

**NOTE:** 12" x 20" x 6" deep pans are not included.

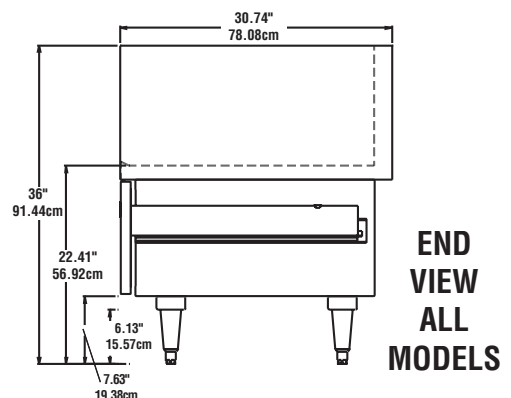

**END  
VIEW  
ALL  
MODELS**