

# KHCR-B

Mobile Self-Contained Hot/Cold Combination Counters

Project \_\_\_\_\_  
Item \_\_\_\_\_  
Quantity \_\_\_\_\_  
CSI Section 11400  
Approved \_\_\_\_\_  
Date \_\_\_\_\_

## Models

• KHCR-50B	1 hot well, 26" x 21.62" cold pan	• KHCR-96B	1 hot well, 65" x 21.62" cold pan
• KHCR-60B	1 hot well, 26" x 21.62" cold pan	• KH2CR-96B	2 hot wells, 52" x 21.62" cold pan
• KHCR-74B	1 hot well, 39" x 21.62" cold pan	• KH3CR-96B	3 hot wells, 39" x 21.62" cold pan
• KH2CR-74B	2 hot well2, 26" x 21.62" cold pan	• KH4CR-96B	4 hot wells, 26" x 21.62" cold pan



KH2CR-74-B

Shown with option double flip-up sneeze guard, stainless steel fold-down tray slide and work shelf

## Standard Features

- One piece, molded fiberglass pylon (base), fully rounded corners, permanent color
- All corners and center sides reinforced with galvanized bracing, laminated into the fiberglass
- 14-gauge tops
- Standard on 5" polyurethane swivel casters
- Easy to use stainless steel interlock system is standard on base and tray slides
- A maximum 10' long cord and plug
- Enclosed bases
- One to four electrically heated, recessed die-stamped stainless steel hot food warmers
- Each warmer accommodates a 12" x 20" x 6" pan (pans supplied by others)
- All body cutouts reinforced with 14-gauge channel supports
- Cold pan is 7" deep constructed of stainless steel, equipped with a 1" drain with valve
- Environmentally friendly HFC-404A refrigerant
- One year parts and 90 day labor standard warranty

## Options & Accessories

- Tray slides and work shelves
  - 10" (25.4cm) wide composite fold-down cutting board
  - Line-up interlock device
  - Glass front counter protector
  - Food shields
  - 12" (30.5cm) wide 18-gauge stainless steel overshef
  - Incandescent light fixtures\*
  - Radiant or bullet style heat lamps\*
  - Open understorage with shelf
  - 120V/60Hz/1ø, 15 amp convenience outlet with 10 amp breaker\*
  - Drains from food wells, plumbed to common valve
  - Stainless steel trim strips
  - Molded fiberglass trim strips
  - Adjustable stainless steel legs
  - Adapter bars (specify length)
- \* Inclusion of these options will alter the electrical specifications of the unit

## Specifications

**Exterior body** is seamless, one piece molded fiberglass, having smooth exterior surfaces and all corners fully rounded. The fiberglass reinforced polyester (F.R.P.) is molded with permanent color. Stress points are internally reinforced.

**Exterior top** is constructed of 14-gauge stainless steel, welded, ground and polished into one integral unit. Top has one to four electrically heated, recessed, die-stamped stainless steel hot food warmers. Each warmer accommodates a 12.75" x 20.75" x 6" (32.4cm x 52.7cm x 15.2cm) deep pan.

**Heated food warmers** are constructed of die-stamped stainless steel. Each heated food warmer is individually equipped with a heating element rated at 1000 watts for 120 volt or 208/230 volt, 60 Hertz, single phase service and wired to an adjustable control switch and indicator light in the control panel. Heated food warmers are interwired to a maximum 10' (3m) long cord with grounded plug for 115 volt or 208/230 volt, 60 Hertz, single phase electrical service.

**The refrigerated cold pan** is 7" (17.8cm) deep and constructed of stainless steel. The cold pan is separated from the exterior top by a thermal break. Copper refrigeration tubing is attached

to the sides and bottom of the cold pan and is fully insulated with foamed in place environmentally friendly, Kyoto Protocol Compliant, Non ODP (Ozone Depletion Potential), Non GWP (Global Warming Potential) polyurethane insulation. Cold pan is equipped with a 1" (2.5cm) I.P.S. drain with a drain valve located at the bottom of the unit. Temperatures of 33°F (1°C) to 41°F (5°C) are maintained with pans recessed 2" (5cm) at 86°F ambient room temperature. Pans rest on a stainless steel bracket. (Pans by others)

**Refrigeration system** uses HFC-404A refrigerant and has a self-contained 115 volt, 60 Hertz, single phase hermetically sealed condensing unit with adjustable cold pan temperature control. Unit is wired with a 3-wire, grounded, maximum 10' (3m) cord and plug. Unit has an on/off switch for the cold pan mounted on the exterior.

**Casters:** Unit is mounted on 5" (12.7cm) diameter swivel casters with non-marking polyurethane tires and plate brakes. Overall height of caster assembly is 6.00" (15.2cm).



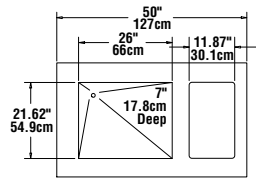

**Plan View  
KHCR-50-B**

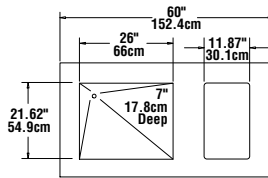

**Plan View  
KHCR-60-B**

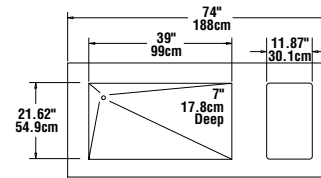

**Plan View  
KHCR-74-B**

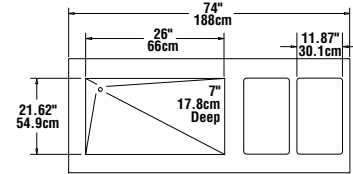

**Plan View  
KH2CR-74-B**

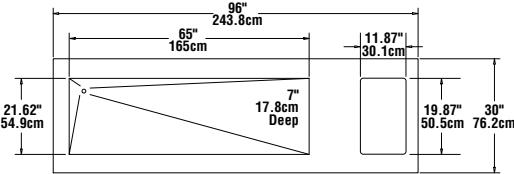

**Plan View  
KHCR-96-B**

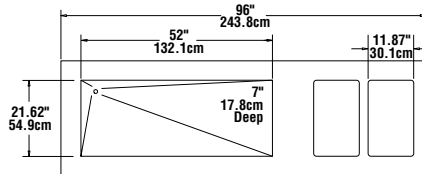

**Plan View  
KH2CR-96-B**

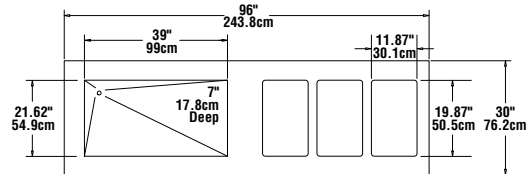

**Plan View  
KH3CR-96-B**

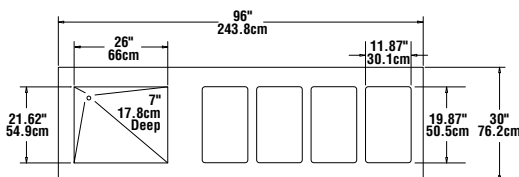

**Plan View  
KH4CR-96-B**

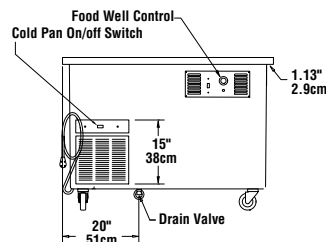

**Typical Elevation View  
All KHCR Models**

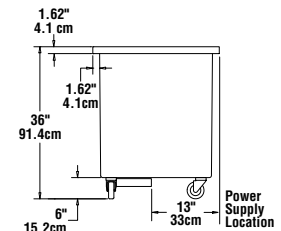

**Typical Plan View  
All KHCR Models**

**Specifications**

Model	Voltage (60 Hz/ 1Ø)	Amperage	H.P.	Nema Plug	Ship Weight lbs/kg
KHCR-50B	120	16.0	1/4	5-20P	475/216
KHCR-60B	120	16.0	1/4	5-20P	575/261
KHCR-74B	120	16.0	1/4	5-20P	688/312
KHCR-96B	120	16.0	1/4	5-20P	730/331
KH2CR-74B	120/208-230	18.0	1/4	14-30P	690/313
KH2CR-96B	120/208-230	18.0	1/4	14-30P	740/336
KH3CR-96B	120/208-230	23.0	1/4	14-30P	750/340
KH4CR-96B	120/208-230	29.0	1/4	14-50P	760/ 345

Delfield reserves the right to make changes to the design or specifications without prior notice.