

# Parts Directory

---

# Glas tender®

GT-24, GT-30

**GLASSWASHERS**

(Manufactured after June 1, 1990 with digital temperature gauges)

---



GT-24-CW



GT-30-CCW

---

Glastender, Inc. · 5400 North Michigan Road · Saginaw, MI · 48604-9780  
800.748.0423 · 989.752.4275 · Fax 989.752.4444 · [www.glastender.com](http://www.glastender.com)

---



# WARRANTY STATEMENT

## APPLICABLE TO ALL PRODUCTS SOLD WITHIN THE UNITED STATES AND CANADA

**LABOR:** Glastender, Inc. warrants all products to be free of defects in material and workmanship. In established areas, a start-up and a 90-day labor warranty are included with glasswasher models GT-24 and GT-30. The GT-18 series glasswashers include a 90-day labor warranty. Self-contained refrigeration models, except beer line chillers, include a 1-year labor warranty, for the duration of one year from date of installation or up to 18 months from date of factory shipment, whichever occurs sooner. For warranty labor claims beyond 15 months from the date of factory shipment, proof of date of installation or occupancy must be provided. Authorization for labor must be obtained from Glastender within the warranty period and prior to the service being performed. Labor warranty applies to the United States and Canada only.

**PARTS:** Within one year from date of installation or 18 months from date of factory shipment, whichever occurs sooner, Glastender, Inc. will replace any part or assembly found defective under normal use and service. Field replacement parts include a warranty of 90 days from date of installation.

**FOUR YEAR ADDITIONAL COMPRESSOR WARRANTY:** Glastender will warrant to the original user the compressor for all self-contained refrigeration models for an additional four years following the regular one-year warranty period. This plan applies to the compressor only.

A warranty claim form **MUST** accompany all returned defective parts or assemblies. This form **MUST** be completed in full. Failure to do so may result in delay or denial of credit. Any defective part or assembly must be returned to Glastender, Inc., Saginaw, Michigan, with all transportation and delivery charges prepaid. Warranty repairs or replacements will be shipped FOB factory in Saginaw, Michigan. Reimbursement for applicable freight charges covers ground service only.

Glastender provides in-warranty repairs during a service company's regular working days and hours. There is no provision for payment of a premium rate during "overtime" hours. When warranty service is requested during other than normal working hours, the end user will be charged the premium portion of the overtime rate.

The warranty does not cover equipment subjected to accidents, freight damage, alterations from the original design, improper power and/or plumbing hookups, improper chemical use, general misuse, or lack of routine required maintenance as determined by Glastender, Inc. Installation, normal control adjustments, general maintenance, correcting an installation error, or service calls that reveal the unit is functioning normally will not be reimbursed under warranty.

Condenser coils on self-contained refrigeration products must be cleaned regularly. Failure to provide adequate air flow to a refrigeration unit will void the warranty.

Glastender shall not be liable for loss of use, revenue, or profit, or for any other indirect, incidental, special, or consequential damage including, but not limited to, product spoilage or loss.

This warranty is conditioned upon Glastender receiving notice of any defect subject to this warranty within sixty (60) days of its discovery by the end user or dealer. All products are warranted only for the initial place of installation. Removal of a product automatically terminates this warranty.

### **SECOND YEAR EXTENDED PARTS & LABOR WARRANTY:**

Glastender's one-year parts and labor warranty on self-contained refrigeration units, excluding beer line chillers, can be extended to two years with the purchase of a two year parts and labor warranty. Specify part number EWR2 (\$150 net price) when ordering.

**EXPORT WARRANTY** - One year parts only.

### **EXCLUSION OF WARRANTIES**

EXCEPT AS PROVIDED ABOVE, GLASTENDER MAKES NO WARRANTIES, EXPRESS OR IMPLIED, INCLUDING, BUT NOT LIMITED TO, ANY IMPLIED WARRANTY OF MERCHANTABILITY, FITNESS FOR A PARTICULAR PURPOSE OR NON-INFRINGEMENT.

### **LIMITATION OF REMEDIES AND DAMAGES**

If Buyer makes a valid and timely claim as outlined above, Glastender's liability and Buyer's remedies under this agreement will be limited solely to labor charges authorized and/or replacement or credit, at Glastender's option, with respect to Products returned at Buyer's expense within thirty (30) days after warranty repair. GLASTENDER'S LIABILITY WILL IN NO EVENT BE GREATER IN AMOUNT THAN THE PURCHASE PRICE OF THE RETURNED PRODUCTS. GLASTENDER WILL NOT BE LIABLE UNDER ANY CIRCUMSTANCE FOR CONSEQUENTIAL OR INCIDENTAL DAMAGES, INCLUDING, BUT NOT LIMITED TO, LABOR COSTS EXCEPT AS COVERED UNDER OUR WARRANTY, LOST PROFITS OR THE LOSS OF PERISHABLE PRODUCTS RESULTING FROM THE USE OF OR INABILITY TO USE OUR PRODUCTS OR FROM OUR PRODUCTS' INCORPORATION INTO OR BECOMING A COMPONENT OF ANY OTHER PRODUCT. NEITHER PARTY WILL HAVE ANY NEGLIGENCE OR OTHER TORT LIABILITY TO THE OTHER, OR TO ANY THIRD PARTY, ARISING FROM ANY BREACH OF THIS AGREEMENT.

### **GOVERNING LAW - JURISDICTION**

The terms and conditions of an order are to be governed and construed according to the laws of the State of Michigan, without regard to conflict of laws principles. Buyer hereby consents to the jurisdiction and venue of the courts located in Saginaw County, Michigan.

No representative, distributor, dealer, or any other person is authorized to modify this warranty. This warranty replaces all other written or verbal warranties.

**NOTE:** Glastender, Inc.'s policy of constant quality improvement means that prices, specifications, and policies are subject to change without notice. Questions regarding this warranty should be directed to Glastender's Customer Service Representative.

03/03/10

## **IMPORTANT!!**

### Attention Refrigeration Service Companies

Please review the important warranty information on this page. If you believe a service call should be covered by the factory, please call the factory for authorization between 8AM and 5PM EST, Monday through Friday.

Exterior Components .....	1-2
Glass Stops, Curtains, Rinse Tank Guides and Conveyors .....	3-4
Sray Boxes, Gaskets, Inlet Screens and Level Controls .....	5-6
Electrical Components .....	7-8
Drive Assembly Components .....	9-10
Recirculating Pump Components .....	11-14
Chemical Tubing, Level Sensor Tubing and Related Parts ....	15-16
Paristaltic Pump Components .....	17-20
Plumbing Components .....	21-22

## TERMS AND CONDITIONS

### PRICES:

All prices are LIST. Applicable taxes will be added.

### QUOTATIONS:

Unless otherwise stated, quotations are effective for 30 days only.

### ACCEPTANCE:

All orders are subject to acceptance by Glastender, Inc.'s headquarters in Saginaw, Michigan. Possession of the Product Directory and Price List is not an offer to sell.

### SHIPMENTS:

F.O.B. factory in Saginaw, Michigan. Freight terms are Third Party or Collect if shipped directly to you. Prepay and Add to Invoice freight terms are available upon request. The approximate shipping weights of all products are listed with the prices. Partial shipments will be made unless otherwise specified by the customer. Surface freight classifications are:

- Glasswashers, Line Chillers - Class 92.5
- Cocktail Stations, Underbar Equipment - Class 85
- Bar Die/Underbar Equipment - Class 125
- Refrigeration Equipment, 48" long or smaller - Class 100
- Refrigeration Equipment, greater than 48" long - Class 110

All small items are evaluated to see the most cost effective means for shipment. Many small items ship via UPS or FedEx; however, when dimensional weight is excessive DB Schenker, UPS Supply Chain, or even common LTL carriers are the most cost effective choice. Spare parts orders received before 1:00 PM EST can usually be shipped the same day.

The order department is happy to assist with routing or shipping questions.

### PAYMENT TERMS:

Cash should be included with all orders unless credit terms have been arranged. To establish credit, banking and trade references are required. A convenient credit application is available upon request. Payment via credit card is not our normal means of receiving payment. Visa and MasterCard will be accepted, but must be charged at the time of shipment. In addition, a payment via credit card for orders totaling more than \$500 will incur a 3% convenience fee on the total transaction amount.

### DELIVERY:

The majority of equipment is manufactured to order and typically ships within three to six weeks after complete order information is received by the factory. In-stock equipment typically ships within two to three days of the factory receiving complete order information.

### RETURNS:

Items specified as "Manufactured to Order" are NOT returnable.

A Return Material Authorization (RMA) number must be issued by the factory in advance for any items that are returnable. The RMA number MUST be noted on the outside of the returned package. Returns must be received within 90 days of the RMA issue date. Shipping charges must be prepaid. A minimum 20% restocking charge will be applied to all authorized returns if received in new, unused condition in the original packaging.

The above conditions apply to spare part returns, except spare part returns must be received within 30 days of original shipment for electronic or electrical parts or within 90 days for all other parts.

### LOSS OR DAMAGE:

For customer routed shipments, Glastender, Inc. is not responsible for any loss, damage, or delay of merchandise during shipment. Such transit claims must be filed with the carrier. Merchandise must be examined on arrival. If shortages occur, Glastender, Inc. must be notified in writing within five (5) days of delivery to honor any shortage claim. Glastender will assume responsibility for freight claims on Prepay and Add shipments but the customer must inspect freight and note any damage upon receipt. Failure to do so may result in losses at the customer's expense.

### CUSTOM ORDERS:

Custom orders must be paid in advance and are not subject to cancellation.

### LAMINATES:

Some products include common, readily available plastic laminates of the customer's selection. There may be an additional charge if uncommon varieties are ordered.

05/18/10

# EXTERIOR COMPONENTS

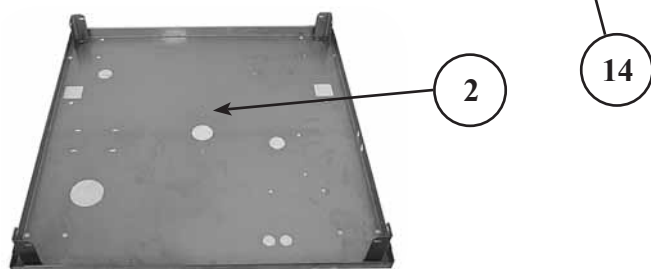
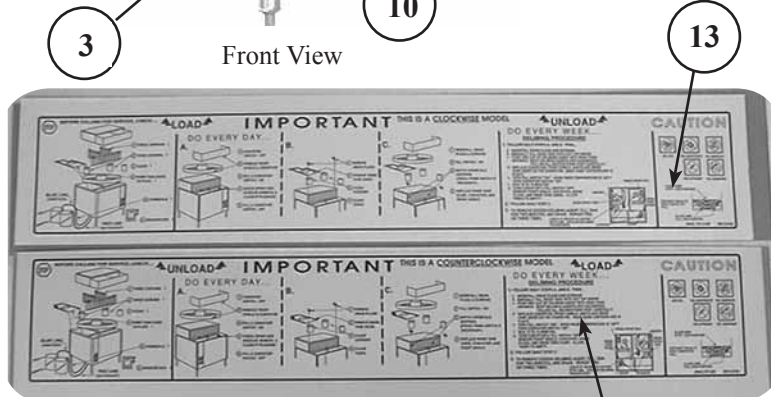
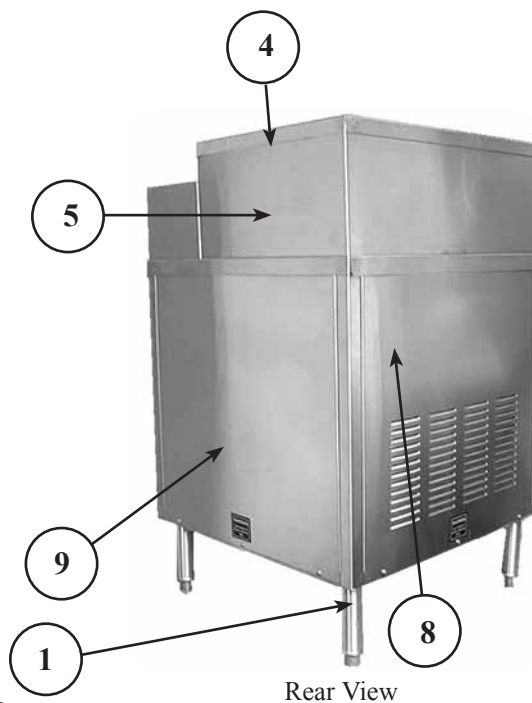
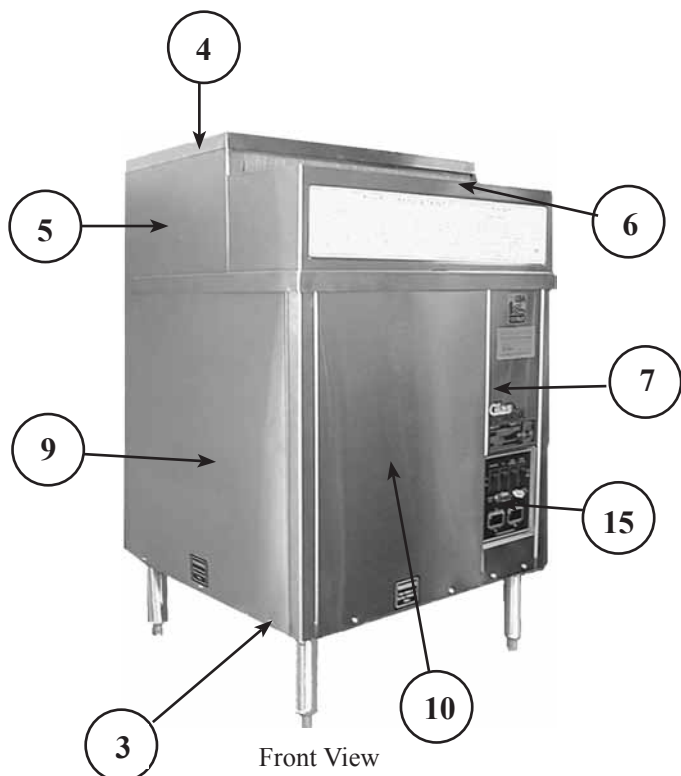

Counterclockwise Model Shown

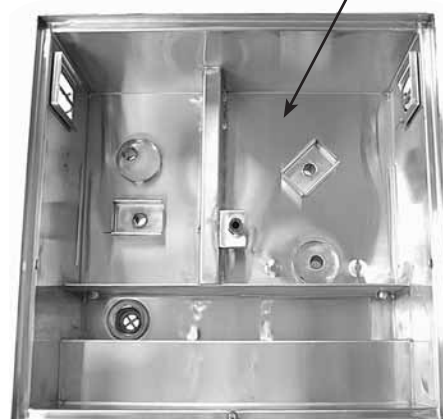
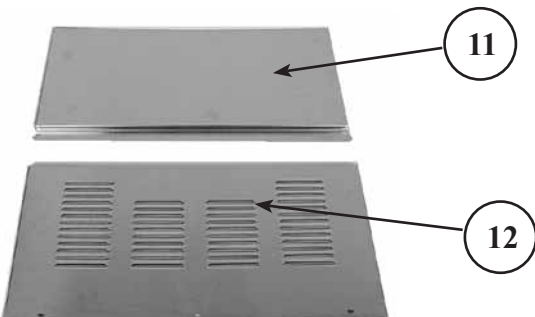

Counterclockwise Model Shown

# EXTERIOR COMPONENTS



<u>Part No.</u>	<u>Old Part No.</u>	<u>Description</u>	<u>Price</u>
1. 04000111	GT-037300	Leg, stainless steel, 7" (4 required)	\$39.00
00000041	GT-038746	Bolt, leg, 1/4"-20 x 5/8" (4 required per leg)	.50
2. 01000701	GT-037700	Floor, GT-24, clockwise	278.00
01000702	GT-037701	Floor, GT-24, counterclockwise	278.00
01000703	GT-037702	Floor, GT-30, clockwise	328.00
01000704	GT-037703	Floor, GT-30, counterclockwise	328.00
3. 00000031	GT-038729	Screw, exterior, 10-24 x 1/2", PPH, SMS, 410 SS	1.00
4. 01000715	GT-038100	Skin top, GT-24	76.00
01000718	GT-038103	Skin top, GT-30	102.00
5. 01000716	GT-038101	Top, GT-24, clockwise	749.00
01000717	GT-038102	Top, GT-24, counterclockwise	749.00
01000719	GT-038104	Top, GT-30, clockwise	942.00
01000720	GT-038105	Top, GT-30, counterclockwise	942.00
6. 01000713	GT-037900	Front shield, GT-24 (decals not included)	140.00
01000714	GT-037901	Front shield, GT-30 (decals not included)	167.00
7. 01000628	GT-035804	Panel, switch, GT-24 and GT-30 (decals not included)	89.00
8. 01000629	GT-035805	Panel, back, GT-24	89.00
01000634	GT-035810	Panel, back, GT-30	106.00
9. 01000630	GT-035806	Panel, side, GT-24 (2 required)	83.00
01000635	GT-035811	Panel, side, GT-30 (2 required)	101.00
10. 01000631	GT-035807	Panel, front, GT-24 (15-1/2")	76.00
01000636	GT-035812	Panel, front, GT-30 (21-1/2")	104.00
11. 01000632	GT-035808	Panel, split front, TOP, GT-24	48.00
01000637	GT-035813	Panel, split front, TOP, GT-30	60.00
12. 01000633	GT-035809	Panel, split front, BOTTOM, GT-24	48.00
01000638	GT-035814	Panel, split front, BOTTOM, GT-30	60.00
13. 01000487	GT-031602	Decal, cleaning instructions, clockwise	26.00
14. 01000488	GT-031603	Decal, cleaning instructions, counterclockwise	25.00
15. 01000494	GT-031625	Decal, switch panel	12.00
16. 01000678	GT-037100	Tank complete*, GT-24, clockwise	1,054.00
01000679	GT-037101	Tank complete*, GT-24, counterclockwise	1,054.00
01000680	GT-037102	Tank complete*, GT-30, clockwise	1,274.00
01000681	GT-037103	Tank complete*, GT-30, counterclockwise	1,274.00

\* Includes all welded components and under coating





Clockwise Model Shown

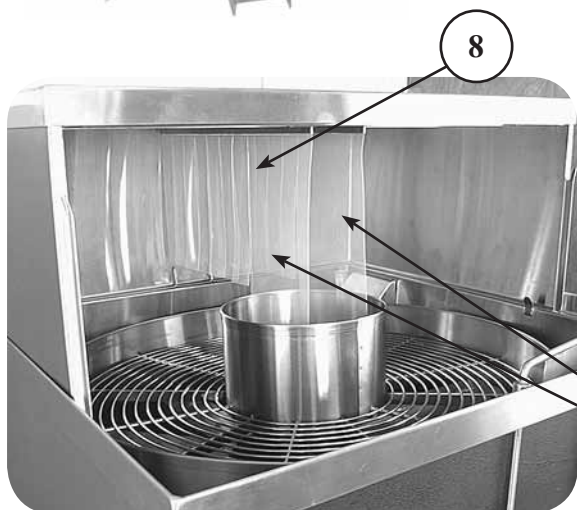
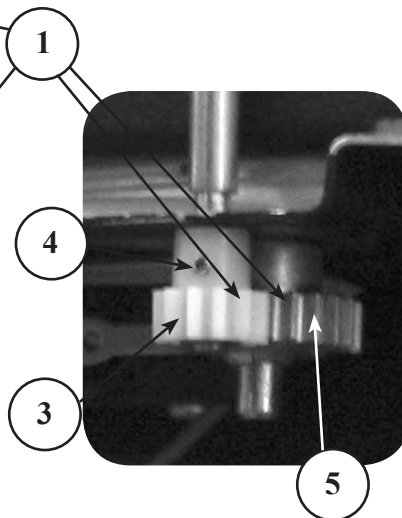
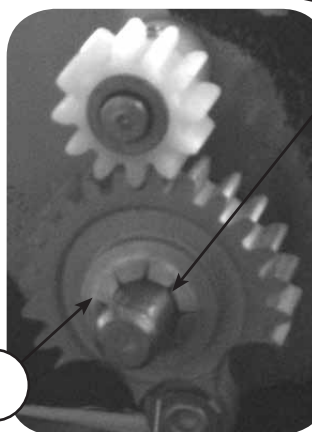
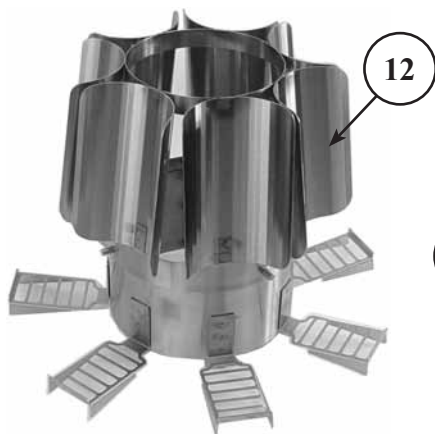

<u>Part No.</u>	<u>Old Part No.</u>	<u>Description</u>	<u>Price</u>
1. 01000727	GT-038300	Glass stop arm assembly, GT-24 (consists of: 01000728, 01000729, 01000730 and 01000731)	\$78.00
01000733	GT-038323	Glass stop arm assembly, GT-30 ( consists of: 01000732, 01000729, 01000730, and 01000731)	80.00
2. 01000728	GT-038301	Glass stop arm with flag, GT-24	50.00
01000732	GT-038322	Glass stop arm with flag, GT-30	52.00
3. 01000729	GT-038302	Gear, small, with allen screw	12.00
4. 01000838	GT-038711	Allen screw only	.60
5. 01000730	GT-038303	Gear, large	15.00
6. 01000731	GT-038319	Washer, retaining, for large gear	.60
7. 01000653	GT-036300	Curtain, front, GT-24	34.00
01000654	GT-036301	Curtain, front, GT-30	42.00
8. 01000655	GT-036302	Curtain, wash or rinse, GT-24, 13 1/2" (2 required)	22.00
01000656	GT-036303	Curtain, wash or rinse, GT-30, 17" (2 required)	27.00
9. 01000684	GT-037200	Curtain set, GT-24 (consists of: one 01000653 and two 01000655)	78.00
01000685	GT-037201	Curtain set, GT-30 (consists of: one 01000654 and two 01000656)	96.00
10. 01000659	GT-036400	Rinse tank guide, GT-24, clockwise	64.00
01000660	GT-036401	Rinse tank guide, GT-24, counterclockwise	64.00
01000661	GT-036402	Rinse tank guide, GT-30, clockwise	74.00
01000662	GT-036403	Rinse tank guide, GT-30, counterclockwise	74.00
11. 01000563	GT-034400	Conveyor, GT-24	460.00
01000565	GT-034401	Conveyor, GT-30	574.00
12. 01000534	GT-032907	Stemware rack for GT-24	489.00
01000535	GT-032910	Stemware rack for GT-30	489.00

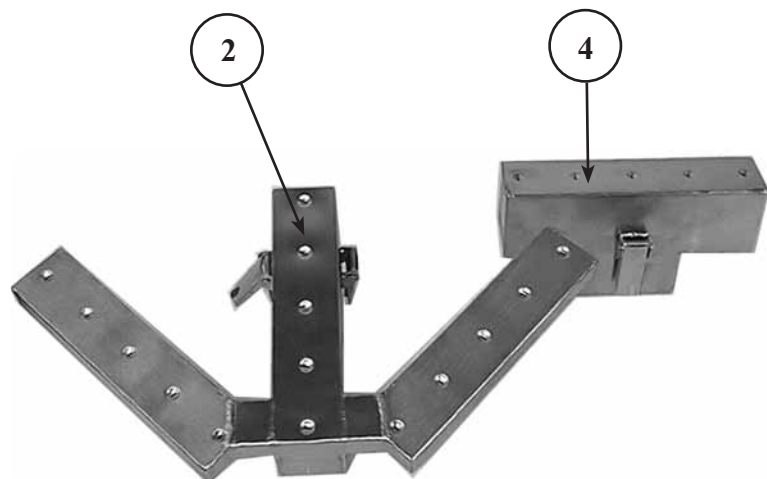
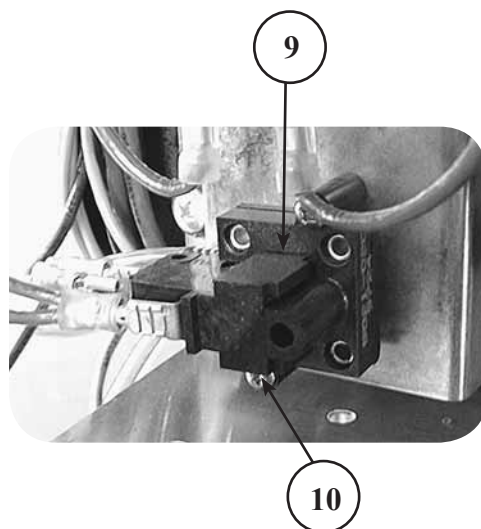
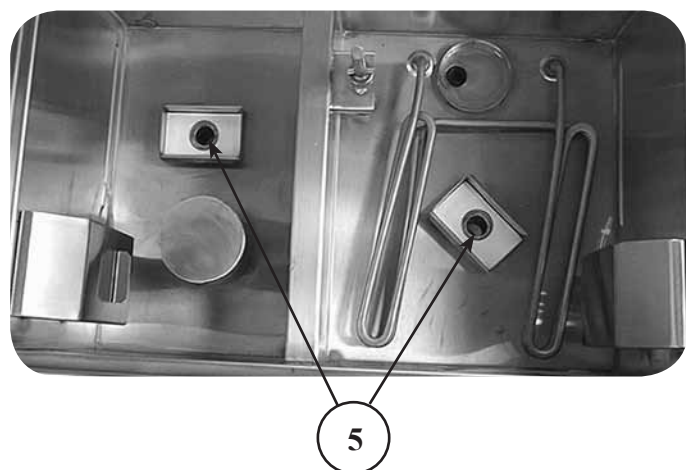
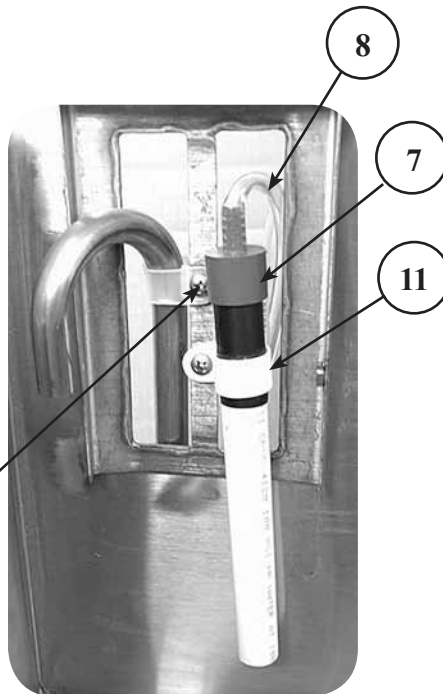
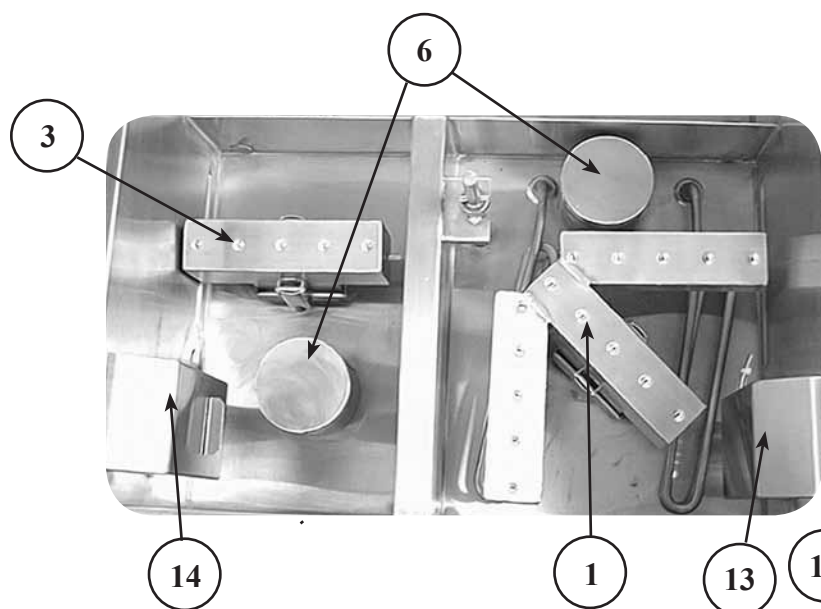



# SPRAY BOXES, GASKETS, INLET SCREENS, AND LEVEL CONTROLS



<u>Part No.</u>	<u>Old Part No.</u>	<u>Description</u>	<u>Price</u>
1. 01000663	GT-036500	Spray box, wash, GT-24	\$454.00
2. 01000664	GT-036501	Spray box, wash, GT-30	479.00
3. 01000665	GT-036502	Spray box, rinseclockwise, GT-24	227.00
01000668	GT-036511	Spray box, rinse, counterclockwise, GT-24	227.00
4. 01000666	GT-036503	Spray box, rinse, GT-30	240.00
5. 01000470	GT-031300	Gasket, wash or rinse spray box (GT-24 and GT-30)	5.00
01000471	GT-031301	Gasket set, spray box (consists of: (2) 01000470)	10.00
6. 01000675	GT-037003	Screen, pump inlet (GT-24 and GT-30)	70.00
7. 01000520	GT-031708	Pickup tube, liquid level	16.00
8. 01000521	GT-031709	Tubing, liquid level, GT-24 (36" long)	6.00
01000522	GT-031710	Tubing, liquid level, GT-30 (42" long)	8.00
9. 01000550	GT-033402	Switch, liquid level and low level air	35.00
10. 00000022	GT-038702	Screw, air switch mounting, #6 x 1/2"	.50
11. 00000001	GT-031106	Clamp, cable, white nylon, 5/8" ID	.50
12. 00000025	GT-038710	Screw, water inlet straps, pickup tube straps, and water inlet cover, 8-32 x 5/8"	.50
13. 01000644*	GT-036104	Cover, pickup tube and water inlet, wash	48.00
14. 01000645*	GT-036144	Cover, pickup tube and water inlet, rinse	48.00

\* NOTE: For these parts, you must specify if the unit is clockwise or counterclockwise when ordering.

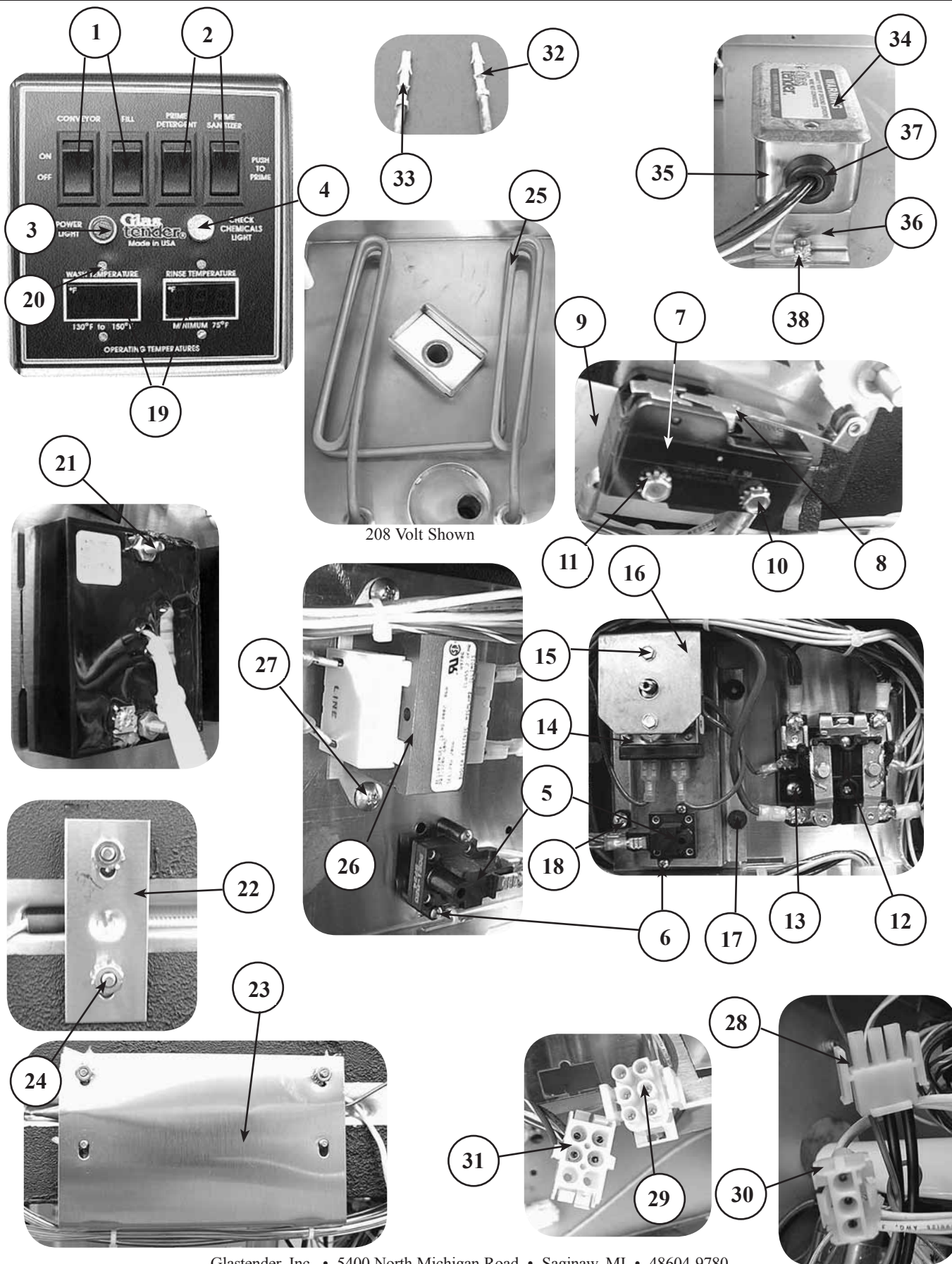

# ELECTRICAL COMPONENTS



<u>Part No.</u>	<u>Old Part No.</u>	<u>Description</u>	<u>Price</u>
01000608	GT-035500	Wire harness, GT-24 & GT-30	\$155.00
1. 01000549	GT-033400	Switch, conveyor and fill (2 required)	14.00
2. 07000257	GT-033401	Switch, prime, momentary (2 required)	20.00
3. 01000591	GT-034900	Light, power, green, 240VAC	5.50
4. 01000593	GT-034906	Light, check chemicals, flasher, 125VAC	18.00
5. 01000550	GT-033402	Switch, liquid level and low level air	35.00
6. 01000866	GT-038700	Screw, air switch mounting, 4-40 x 3/4" phillips (2 required)	.50
7. 01000551	GT-033409	Switch, glass stop with roller	50.00
8. 01000859	GT-038439	Spring, 18-1/2 ounce	1.00
9. 07000259	GT-033417	Switch insulator	1.50
10. 00000032	GT-038731	Screw, switch retaining, 6-32 x 1", HH, MS, zinc (2 required)	.50
11. 01000641	GT-036000	Washer, switch retaining screw, star, #6 (2 required)	.50
12. 01001230		Relay, 120V (GT24 S#24007833, GT30 S#30005183 and greater)	35.00
01000186		Heater relay kit, (prior to GT24 S#24007833, GT30 S#30005183)	45.00
13. 00000050	GT-038772	Screw, relay mounting, 10-32 x 1-1/4" PPH, MS, SS (2 required)	.50
14. 01000545	GT-033200	Thermostat	110.00
15. 00000022	GT-038702	Screw, thermostat mounting, #6 x 1/2" (2 required)	.50
16. 01000484	GT-031541	Bracket, thermostat mounting	5.00
17. 01000740	GT-038433	Grommet, thermostat mounting bracket, relay mounting	1.00
18. 00000044	GT-038753	Screw, thermostat mounting bracket, 10 x 5/8", PPH, zinc (2 req.)	.50
19. 01000606	GT-035300	Gauge, digital temperature with probe	145.00
20. 00000023	GT-038703	Screw, temperature gauge mounting, flat head, 4-40 x 1"	.50
21. 01000618	GT-035700	Nut, temperature gauge mounting, 4-40	.50
22. 01000741		Retaining plate, rinse tank sensor bulb	2.00
23. 01000738	GT-038414	Cover, thermometer	4.00
24. 00000026	GT-035701	Nut, sensor and thermostat bulb, retaining plate, electrical box mounting, 8-32	.50
01000641	GT-036000	Washer, sensor and thermostat bulb, retaining plate, star, #6	.50
25. 01000583	GT-034700	Heater, perimeter style, 240 volt	265.00
01000584	GT-034701	Heater, perimeter style, 208 volt	265.00
26. 01000555	GT-034200	Transformer, low level sensor and temperature gauges (primary- 120VAC, secondary- 24VAC)	50.00
27. 00000039	GT-038744	Screw, transformer mounting, 10-32 x 3/8" phillips, TH, MS, SS	.50
28. 01000669	GT-036700	Plug, three wire	1.00
29. 06001537	GT-036701	Plug, six wire	1.50
30. 01000547	GT-033301	Receptacle, three wire	1.00
31. 06001634	GT-033302	Receptacle, six wire	1.50
32. 01000670	GT-036702	Plug, solderless terminal	.50
33. 01000548	GT-033303	Receptacle, solderless terminal	.50
34. 06001584	GT-040730	Cover, electrical box	1.50
35. 00000168	GT-040729	Electrical box	4.00
36. 01000474	GT-031500	Bracket, electrical box	17.00
37. 06001552	GT-038401	Grommet, electrical box	3.50
38. 00000076	GT-038716	Bolt, electrical box, 8-32 x 1/2", hex head (2 required)	.50
01000642	GT-036001	Lockwasher, large, star, #10	.50



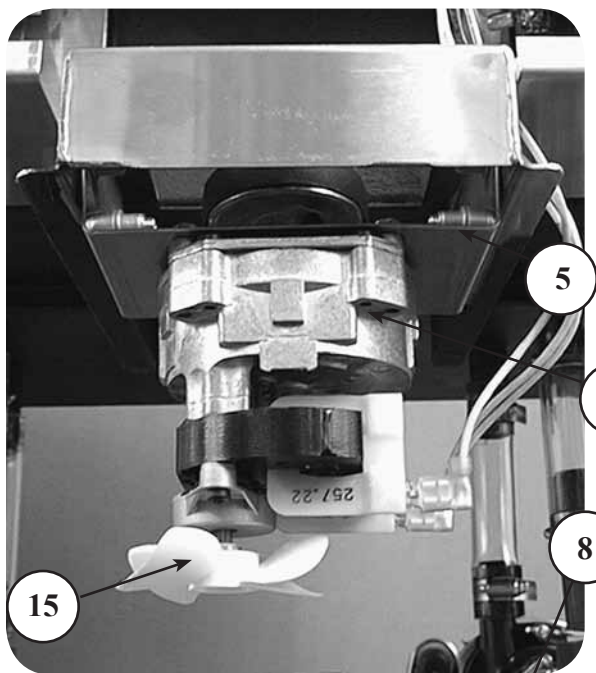

CCW View

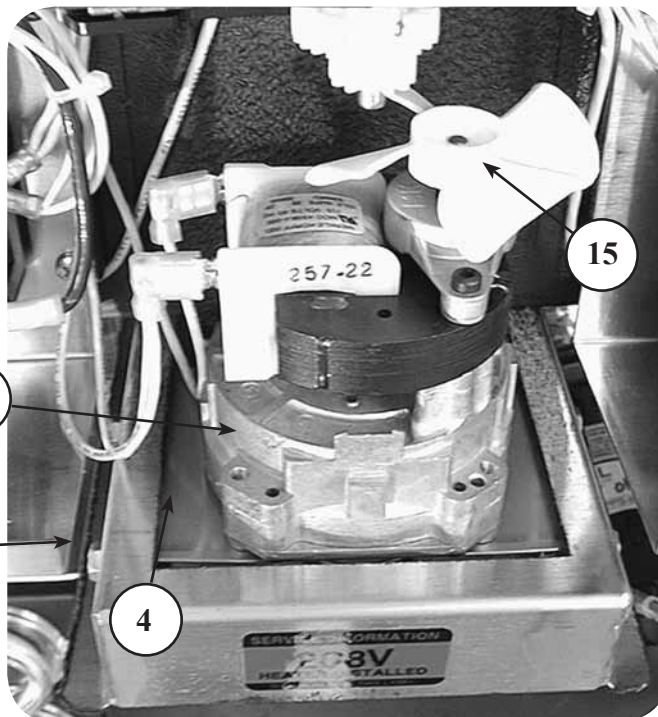

CW View

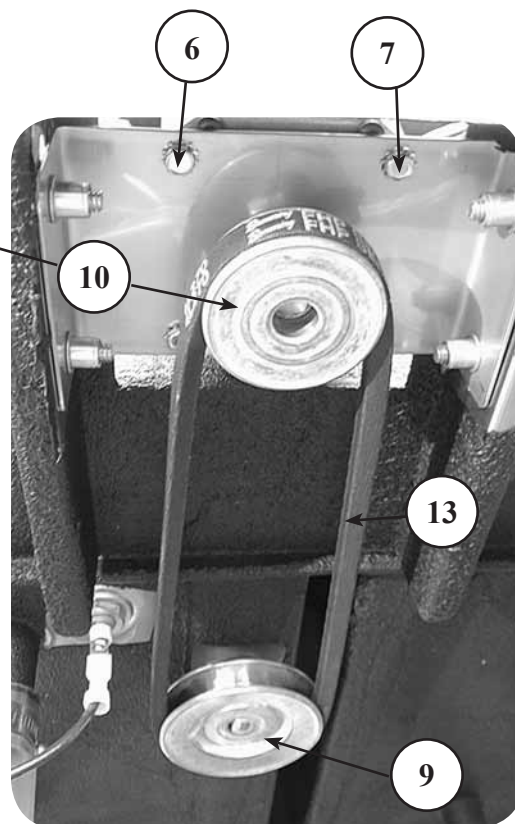
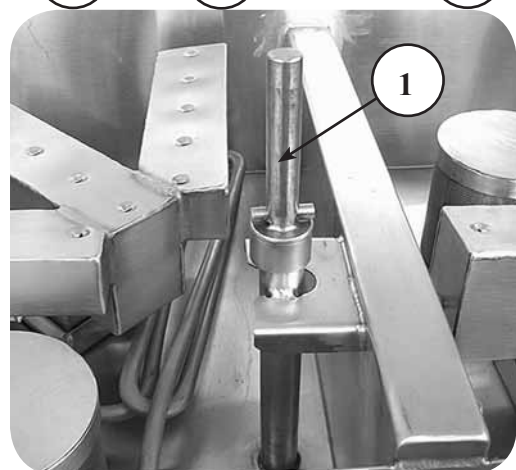
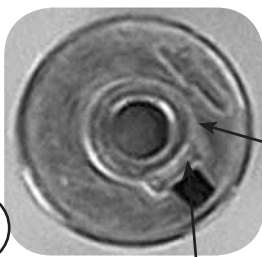
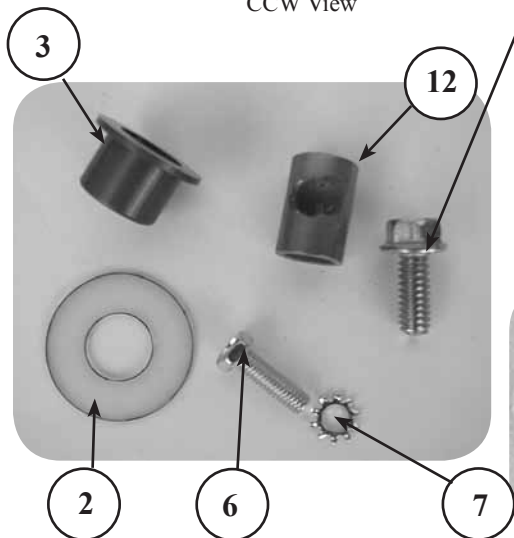



## DRIVE ASSEMBLY COMPONENTS



<u>Part No.</u>	<u>Old Part No.</u>	<u>Description</u>	<u>Price</u>
1. 01000801	GT-037600	Drive shaft	\$111.00
2. 01000847	GT-036025	Washer, drive shaft, nylon (3 required)	.50
3. 01000671	GT-036800	Flange bearing (2 required)	3.00
4. 01000475	GT-031504	Mount, motor, CW rotation	26.00
5. 01000476	GT-031506	Mount, motor, CCW rotation	26.00
6. 01000855	GT-038763	Screw, drive motor mounting, 10-32 x 5/8" (4 required)	.50
7. 01000642	GT-036001	Lockwasher, #10, drive motor mounting screw (4 required)	.50
8. 00000041	GT-038746	Bolt, motor mounting to tank, hex, washer head, 1/4"-20 x 5/8" (4 required)	.50
9. 01000467	GT-031002	Pulley, 3", with set screw and machined center, drive shaft	20.00
10. 01000466	GT-031001	Pulley, 2", with set screw and sleeve, drive motor	12.50
11. 00000024	GT-038706	Screw, set, drive shaft or drive motor pulley, 5/16"-18 x 1/2"	.50
12. 01000735	GT-038404	Sleeve, drive motor pulley, 3/8" to 1/2"	4.00
13. 01000587	GT-034800	Belt, 27", GT-24	20.00
01000588	GT-034801	Belt, 33", GT-30	20.00
14. 01000594	GT-035100	Motor, drive, 1/2 RPM (Merkle-Korff)	185.00
15. 01000531	GT-032800	Fan blade, drive motor	3.00

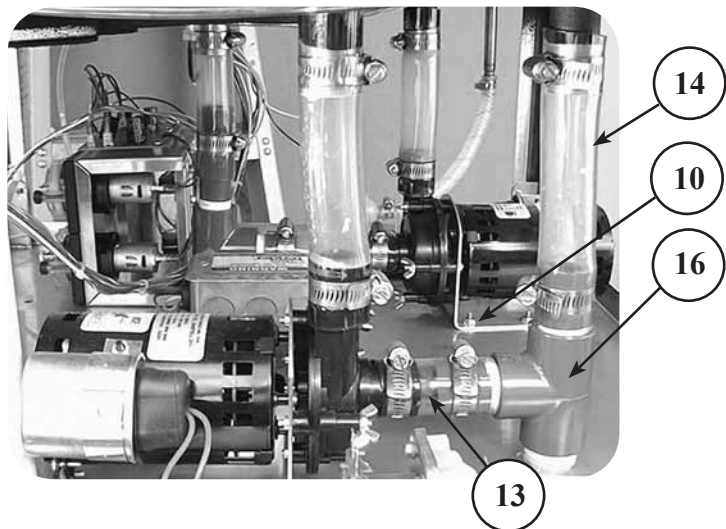
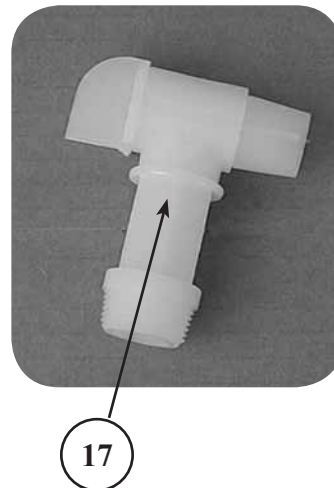
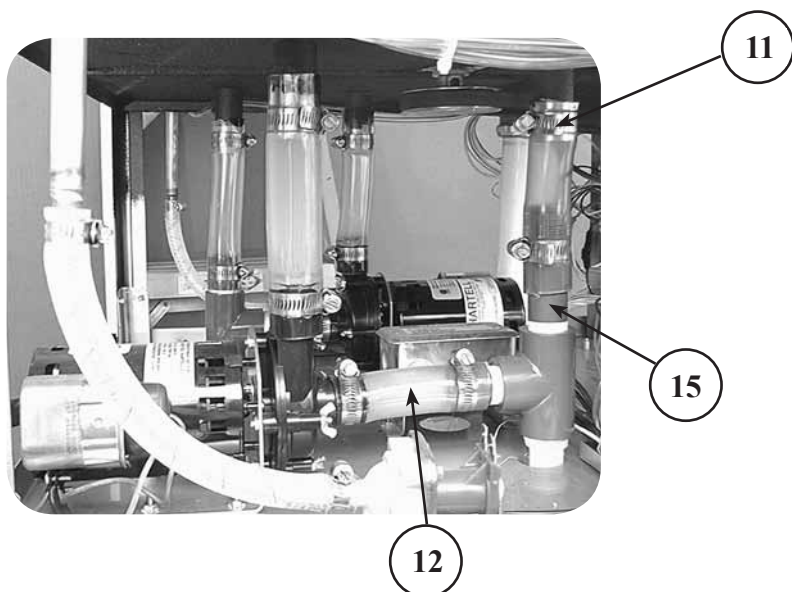
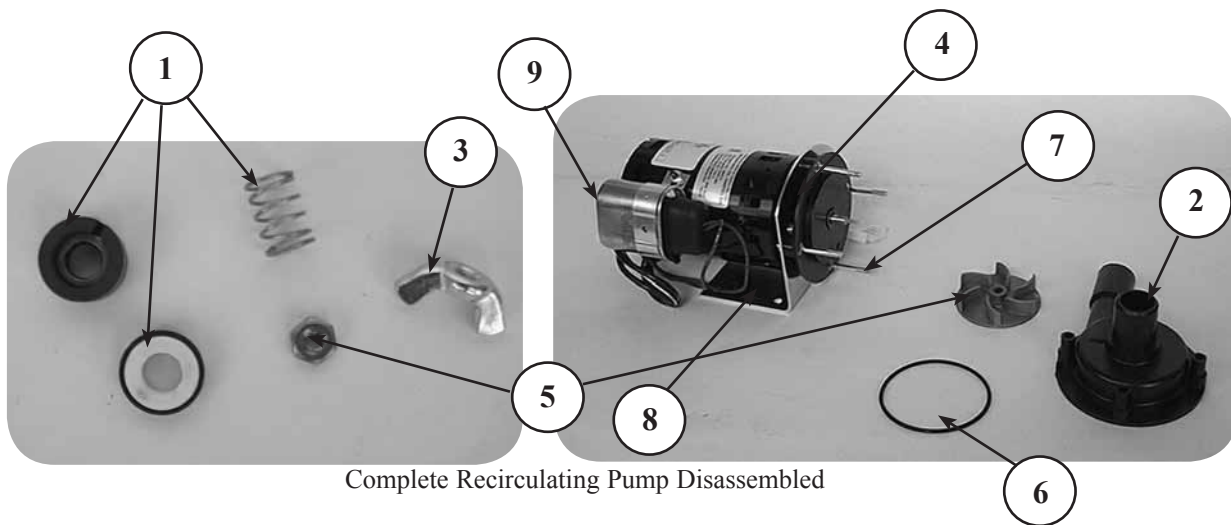

# RECIRCULATING PUMP COMPONENTS

MANUFACTURED PRIOR TO NOVEMBER 2004



<u>Part No.</u>	<u>Old Part No.</u>	<u>Description</u>	<u>Price</u>
1. 01000819	GT-037400	Seal assembly, water recirculating pump	\$60.00
2. 01000818	GT-034506	Housing, water recirculating pump	20.00
3. 01000622	GT-035727	Nut, wing, water recirculating pump (4 required)	.50
4. 01000823	GT-034509	Base plate, water recirculating pump	11.00
5. 01000574	GT-034510	Impeller with lock nut, water recirculating pump	50.00
6. 01000573	GT-034508	O'ring, water recirculating pump	5.00
7. 01000779	GT-041021	Stud, water recirculating pump	.50
01000650	GT-036203	Washer, flat, stud, water recirculating pump #8	.50
8. 01000483	GT-031536	Bracket, water recirculating pump mounting	35.00
9. 01000529	GT-032202	Capacitor, water recirculating pump	40.00
10. 00000076	GT-038716	Bolt, water recirculating pump mounting, 8-32 x 1/2", hex head (4 required per pump)	.50
01000642	GT-036001	Lockwasher, water recirculating pump mounting, large, star, #10	.50
00000026	GT-035701	Nut, water recirculating pump mounting, 8-32	.50
11. 00000000	GT-031100	Clamp, water recirculating pump hose (6 required per pump)	1.00
12. 01000612	GT-035600	Hose, bottom, long, wash pump, GT-24	5.00
01000614	GT-035602	Hose, bottom, long, wash pump, GT-30	5.00
13. 01000613	GT-035601	Hose, bottom, short, rinse pump, GT-24	4.00
01000615	GT-035603	Hose, bottom, short, rinse pump, GT-30	4.00
14. 01000616	GT-035604	Hose, top (2 required per pump)	5.00
06001468	GT-035611	Hose, 1" ID x 1-1/4" OD x 1/8" (per foot)	5.00
15. 01000598	GT-035200	Pipe, PVC, 3/4" x 4 in.	4.00
16. 01000599	GT-035201	Tee, PVC, 3/4"	10.00
01000604	GT-035235	Pipe, PVC, 3/4" x 6 in. (GT-30 wash pump only)	4.00
17. 01000562	GT-034302	Valve, drain (2 required)	11.00

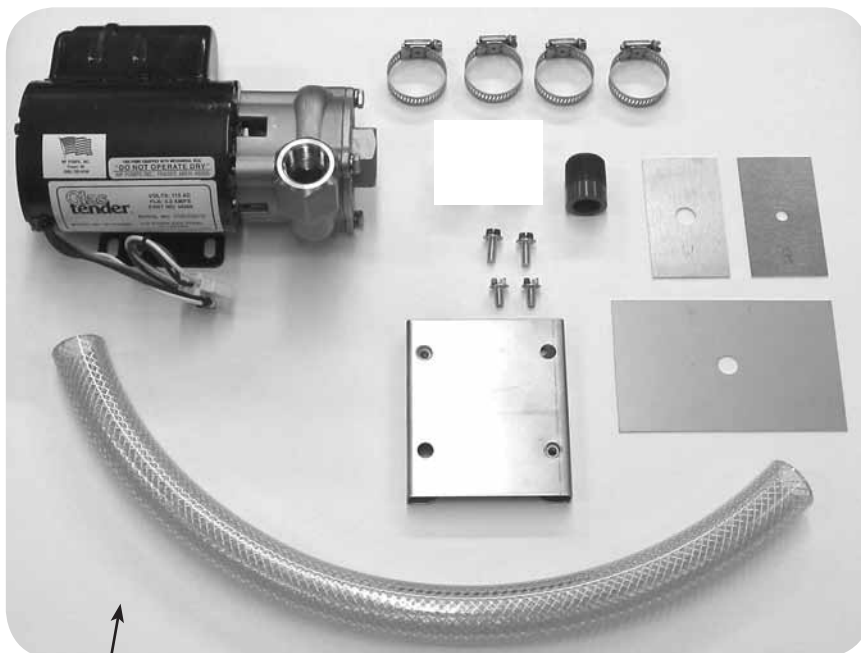

1 Recirculating Pump Kit  
Curtain not pictured



4



8

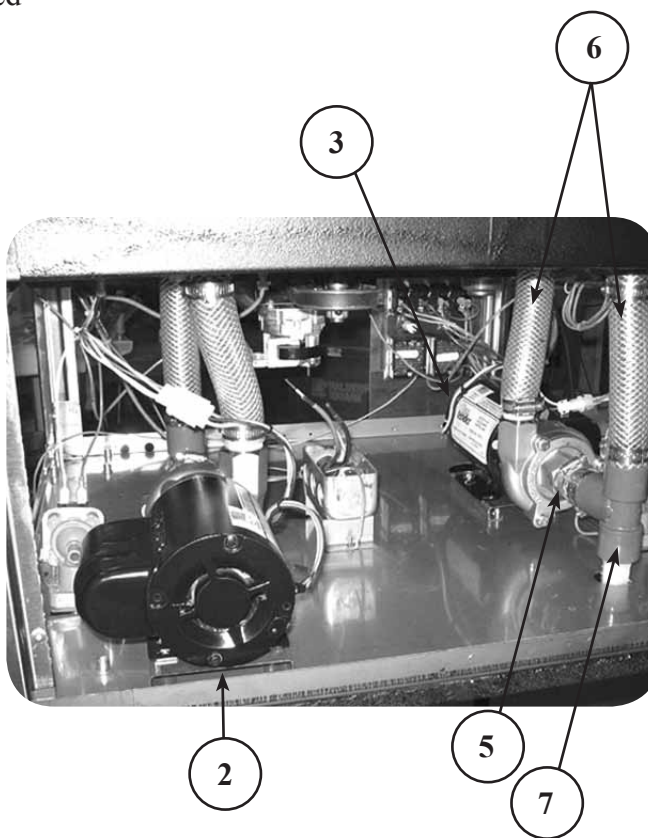

2

3

6

5

7



# RECIRCULATING PUMP COMPONENTS

MANUFACTURED NOVEMBER 2004 AND LATER



<u>Part No.</u>	<u>Old Part No.</u>	<u>Description</u>	<u>Price</u>
1. 01000581*	GT-034554	Pump conversion kit, GT24, water recirculating	\$692.00
01000582*	GT-034555	Pump conversion kit, GT30, water recirculating	700.00
01000826	GT-034557	Mounting kit, GT-24 (pump not included)	92.00
01000827	GT-034558	Mounting kit, GT-30 (pump not included)	100.00
2. 01000415	GT-034550	Pump, water recirculating, all stainless construction with impellers, 115, w/fittings* (*2-01001306) (this pump is the larger of the two pumps)	660.00
3. 01001270		Pump, water recirculating, GT-24 and GT-30 rinse, 115V, 1/10 hp - for use in all GT-24 SN 24008346 and after, and GT-30 SN 30005302 and after (built after May 1, 2008) (this pump is the smaller of the two pumps)	500.00
4. 01000612	GT-035600	Hose, bottom, long, wash pump, GT-24	5.00
01000614	GT-035602	Hose, bottom, long, wash pump, GT-30	5.00
5. 01000613	GT-035601	Hose, bottom, short, rinse pump, GT-24	4.00
01000615	GT-035603	Hose, bottom, short, rinse pump, GT-30	4.00
6. 01000616	GT-035604	Hose, top (2 required per pump)	5.00
7. 01000599	GT-035201	Tee, PVC, 3/4"	10.00
8. 01000562	GT-034302	Valve, drain (2 required)	11.00
01000851		Shaft Seal	50.00
01000854		O-ring	5.00
01000852		Impeller	23.00
01000853		Acorn Nut	11.50
01001285		Seal, for rinse pump #01001270	25.00

\* These kits are needed to replace Hartell Pumps, installed in Glasswashers prior to November 2004.

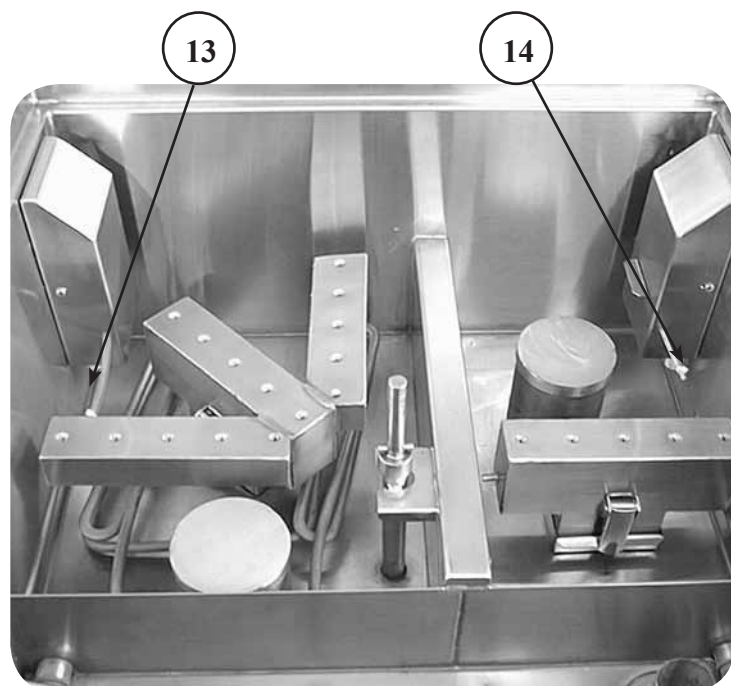

Clockwise Model Shown

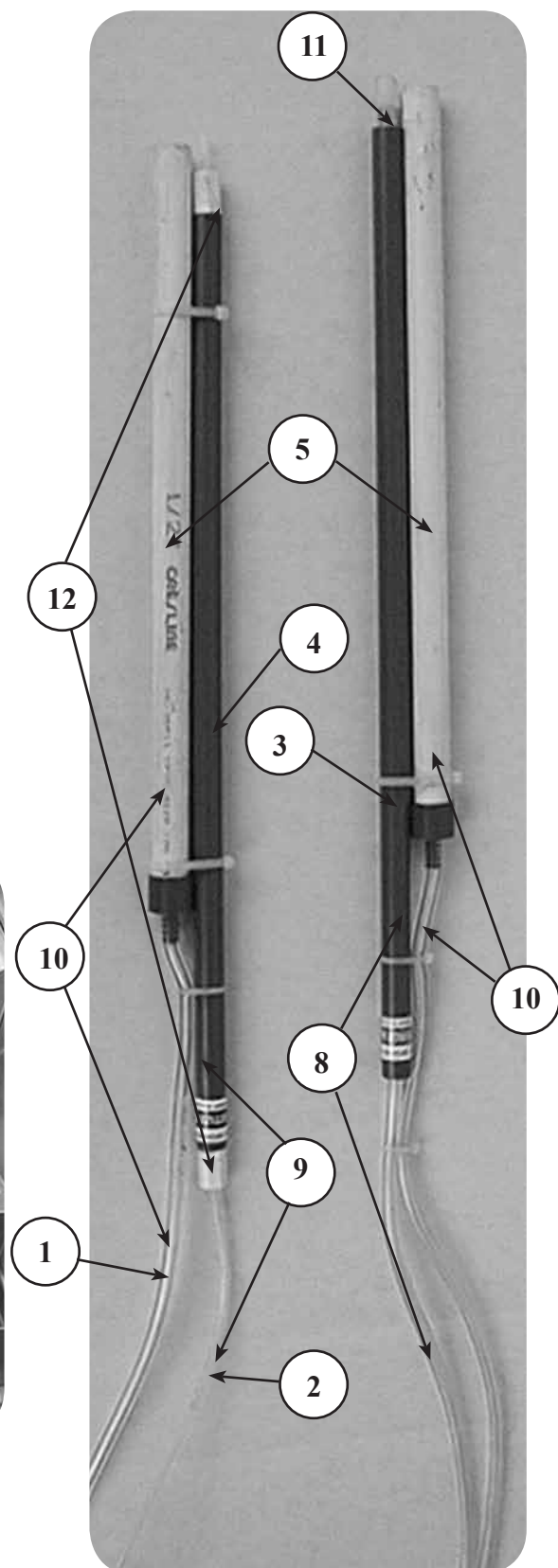

# CHEMICAL TUBING, LEVEL SENSOR TUBING, AND RELATED PARTS



<u>PART NO.</u>	<u>OLD PART NO.</u>	<u>DESCRIPTION</u>	<u>PRICE</u>
1. 01000517	GT-031705	Tubing, clear, 1/8" ID x 1/4" OD (per foot)	\$2.50
2. 01000527	GT-031752	Tubing, clear, 1/16" ID x 1/8" OD (per foot)	1.00
3. 01000526	GT-031750	Tubing support, detergent	6.00
4. 01000858		Tubing support, sanitizer	6.00
5. 01000518	GT-031706	Pickup tube, low level sensor, PVC	25.00
6. 01000485	GT-031600	Decal, detergent	1.00
7. 01000486	GT-031601	Decal, sanitizer	1.00
01000844	GT-036900	Test kit, detergent	110.00
01000845	GT-036901	Test kit, sanitizer (chlorine and iodine)	220.00
8. 01000696	GT-037430	Tubing, assembly, lower, detergent (consists of: 01000517 [6' length], 01000601 and 01000526)	20.00
9. 01000694	GT-037427	Tubing, assembly, lower, sanitizer (consists of: 01000527 [6' length], 01000858 and (2) 01000603)	20.00
10. 01000687	GT-037404	Tubing, assembly, liquid low level sensor (consists of: 01000517 [6' length] and 01000518)	37.00
11. 01000601	GT-035222	Fitting, chemical pickup, detergent, 1/8"	2.00
12. 01000603	GT-035232	Connector with nut, sanitizer feedline, 1/8" (2 required)	2.50
13. 01000697	GT-037431	Tubing, assembly, upper, detergent, 1/8" ID (6' length) (pump to tank)	12.00
14. 01000695	GT-037428	Tubing, assembly, upper, sanitizer, 1/16" ID (6' length) (pump to tank)	6.00

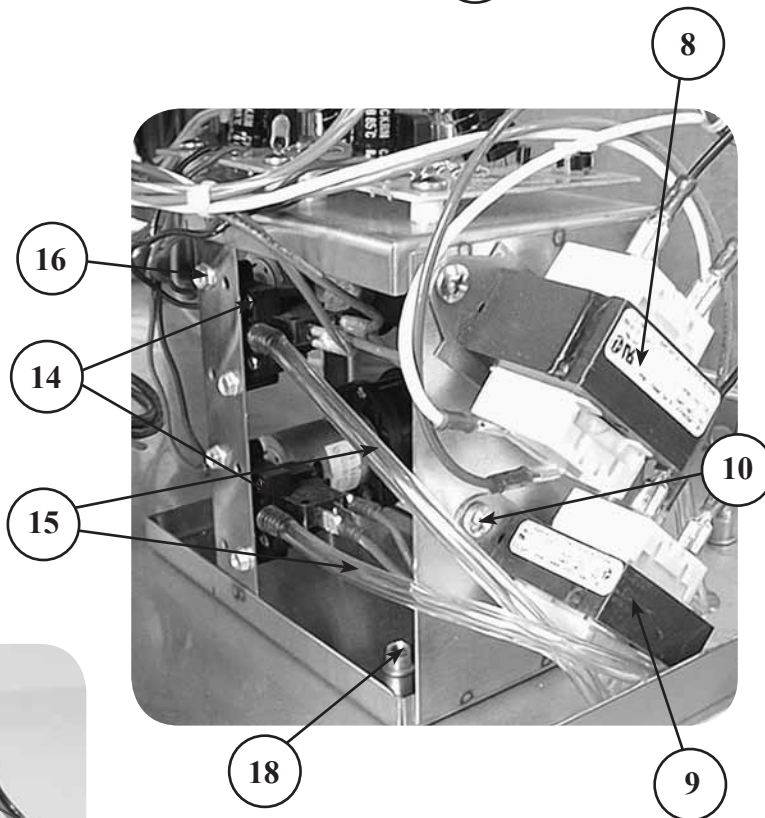
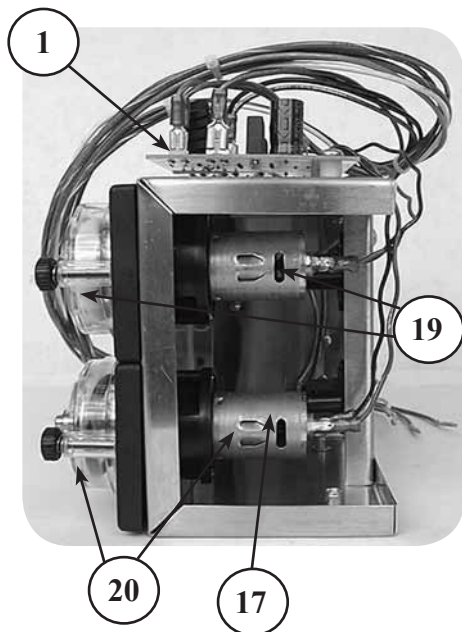
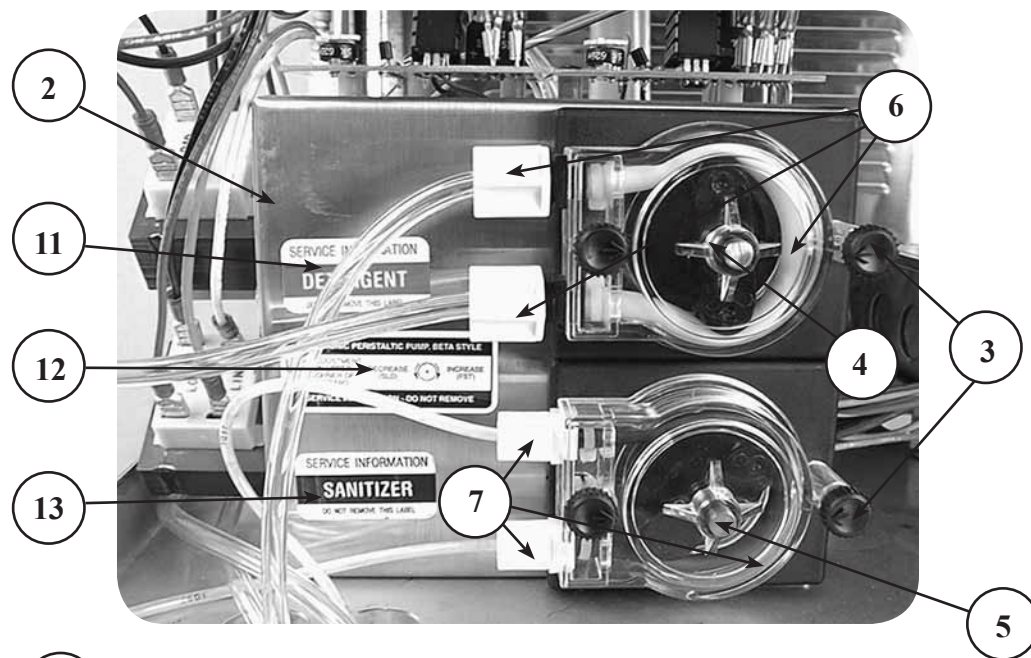



**ELECTRONIC PERISTALTIC PUMP COMPONENTS**

MANUFACTURED PRIOR TO JANUARY 2003



<u>PART NO.</u>	<u>OLD PART NO.</u>	<u>DESCRIPTION</u>	<u>PRICE</u>
01000829	GT-034552	Pump complete, dual, beta, with tubing assemblies	\$780.00
01000579	GT-034532	Pump complete, dual, beta, LESS tubing assemblies	700.00
1 NA	GT-032701	Circuit Board (no longer available, see part numbers 01000543 & 01000544)	NA
2. 01000482	GT-031534	Bracket, dual pump, stainless steel	58.00
3. 01000578	GT-034514	Pin, snap clip (2 required per pump) DISCONTINUED	7.00
01001241		Pump cartridge kit, peristaltic pump (no tubing)	85.00
4. 01000571	GT-034505	Pump cartridge kit, detergent, pump tube with fittings, 1/8" ID, 1/4" OD	120.00
5. 01000577	GT-034513	Pump cartridge kit, sanitizer, pump tube with fittings, 1/16" ID, 1/8" OD	120.00
6. 01000692	GT-037425	Pump tube, detergent, with fittings, 1/8" ID	35.00
7. 01000693	GT-037426	Pump tube, sanitizer, with fittings, 1/16" ID	25.00
8. 01000555	GT-034200	Transformer, detergent, 24 volt (primary- 120VAC, secondary- 24VDC)	50.00
9. 01000558	GT-034203	Transformer, sanitizer, 12 volt	45.00
10. 00000030	GT-038728	Screw, transformer mounting, #10 x 1/2", PPH, SMS, drill kwik (2 required)	1.00
11. 01000485	GT-031600	Decal, detergent	1.00
12. 01000491	GT-031616	Decal, adjustment	1.00
13. 01000486	GT-031601	Decal, sanitizer	1.00
14. 01000550	GT-033402	Switch, liquid level and low level air (2 required)	35.00
15. 01000517	GT-031705	Tubing, liquid level control and low level sensor, 1/8" ID x 1/4" OD (per foot)	2.50
16. 00000022	GT-038702	Screw, air switch mounting, #6 x 1/2", HH, SMS	.50
17. 01000596	GT-035104	Motor, drive, peristaltic pump	95.00
18. 00000039	GT-038744	Screw, pump bracket mounting, 10-32 x 3/8", PH, TH, MS, SS (2 required)	.50
01000642	GT-036001	Lockwasher, star, pump bracket mounting screw, #10	.50
19. 01000572	GT-034507	Pump cartridge and motor assembly, detergent (consists of: 01000571 and 01000596)	210.00
20. 01000575	GT-034511	Pump cartridge and motor assembly, sanitizer (consists of: 01000577 and 01000596)	210.00
21. 01000541	GT-033009	Relay timer only, sanitizer, 12VDC	85.00
01000543	GT-033011	Relay timer assembly, sanitizer, 12VDC	100.00
22. 01000542	GT-033010	Relay timer only, detergent, 24VDC	90.00
01000544	GT-033012	Relay timer assembly, detergent, 24VDC	100.00

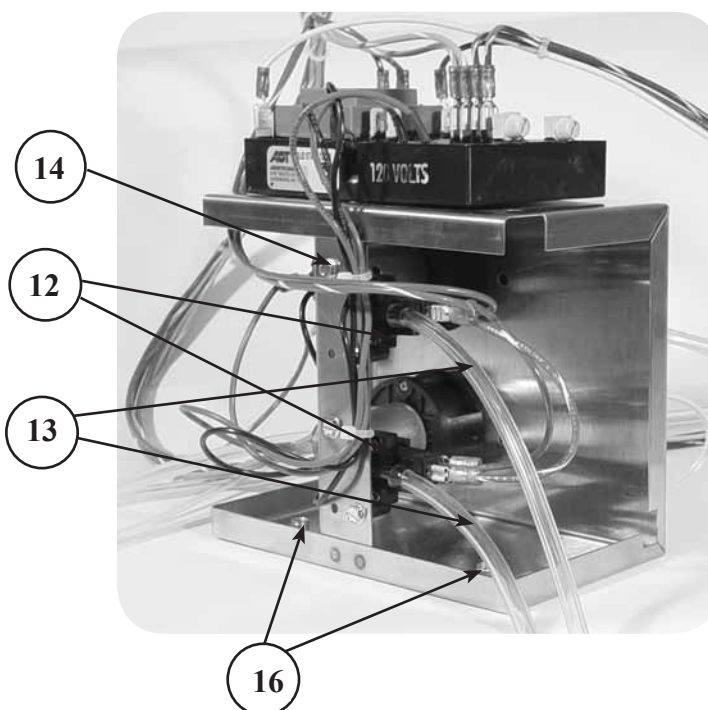
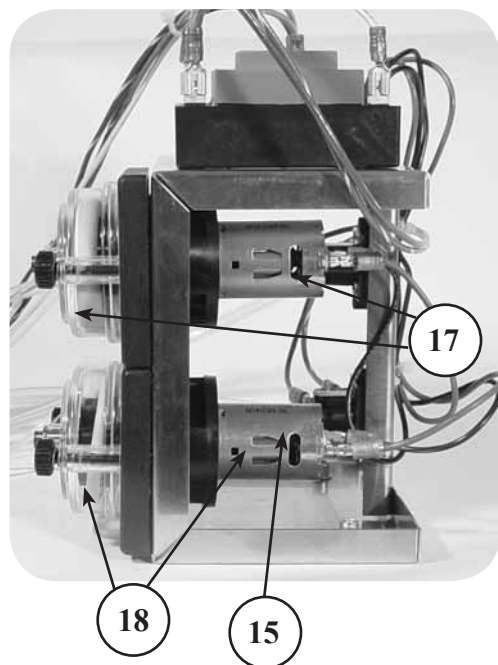
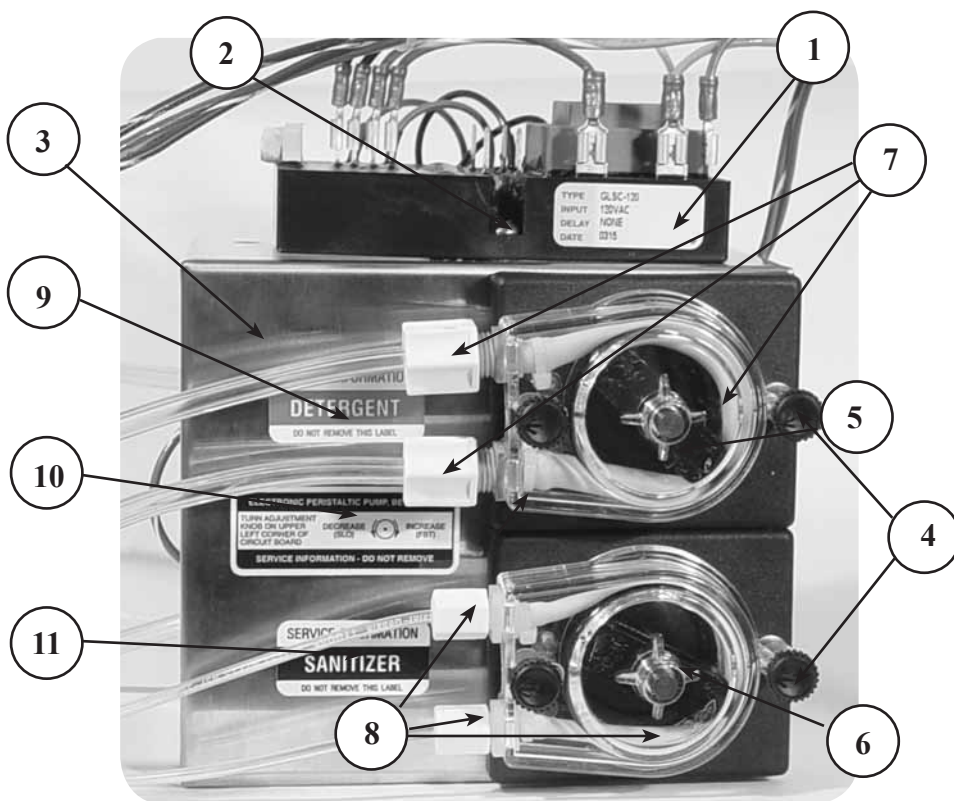

# ELECTRONIC PERISTALTIC PUMP COMPONENTS

MANUFACTURED JANUARY 2003 AND LATER



<u>PART NO.</u>	<u>OLD PART NO.</u>	<u>DESCRIPTION</u>	<u>PRICE</u>
01000569	GT-034502	Peristaltic pump dual complete with tubing assemblies	\$780.00
01000856	GT-034537	Peristaltic pump dual complete LESS tubing assemblies	700.00
1. 01000540	GT-033008	Chemical Pump Control Module	190.00
2. 01000857	GT-038739	Screw, chemical pump control module mounting	0.50
3. 01000482	GT-031534	Bracket, dual pump, stainless steel	58.00
4. 01000578	GT-034514	Pin, snap clip (2 required per pump) DISCONTINUED	7.00
01001241		Pump cartridge kit, peristaltic pump (no tubing)	85.00
5. 01000571	GT-034505	Pump cartridge kit, detergent, pump tube with fittings, 1/8" ID, 1/4" OD	120.00
6. 01000577	GT-034513	Pump cartridge kit, sanitizer, pump tube with fittings, 1/16" ID, 1/8" OD	120.00
7. 01000692	GT-037425	Pump tube, detergent, with fittings, 1/8" ID	35.00
8. 01000693	GT-037426	Pump tube, sanitizer, with fittings, 1/16" ID	25.00
9. 01000485	GT-031600	Decal, detergent	1.00
10. 01000491	GT-031616	Decal, adjustment	1.00
11. 01000486	GT-031601	Decal, sanitizer	1.00
12. 01000550	GT-033402	Switch, liquid level and low level air (2 required)	35.00
13. 01000517	GT-031705	Tubing, liquid level control and low level sensor, 1/8" ID x 1/4" OD (per foot)	2.50
14. 00000022	GT-038702	Screw, air switch mounting, #6 x 1/2", HH, SMS	.50
15. 01000596	GT-035104	Motor, drive, peristaltic pump	95.00
16. 00000039	GT-038744	Screw, pump bracket mounting, 10-32 x 3/8", PH, TH, MS, SS (2 required)	.50
01000642	GT-036001	Lockwasher, star, pump bracket mounting screw, #10	.50
17. 01000572	GT-034507	Pump cartridge and motor assembly, detergent (consists of: 01000571 and 01000596)	210.00
18. 01000575	GT-034511	Pump cartridge and motor assembly, sanitizer (consists of: 01000577 and 01000596)	210.00

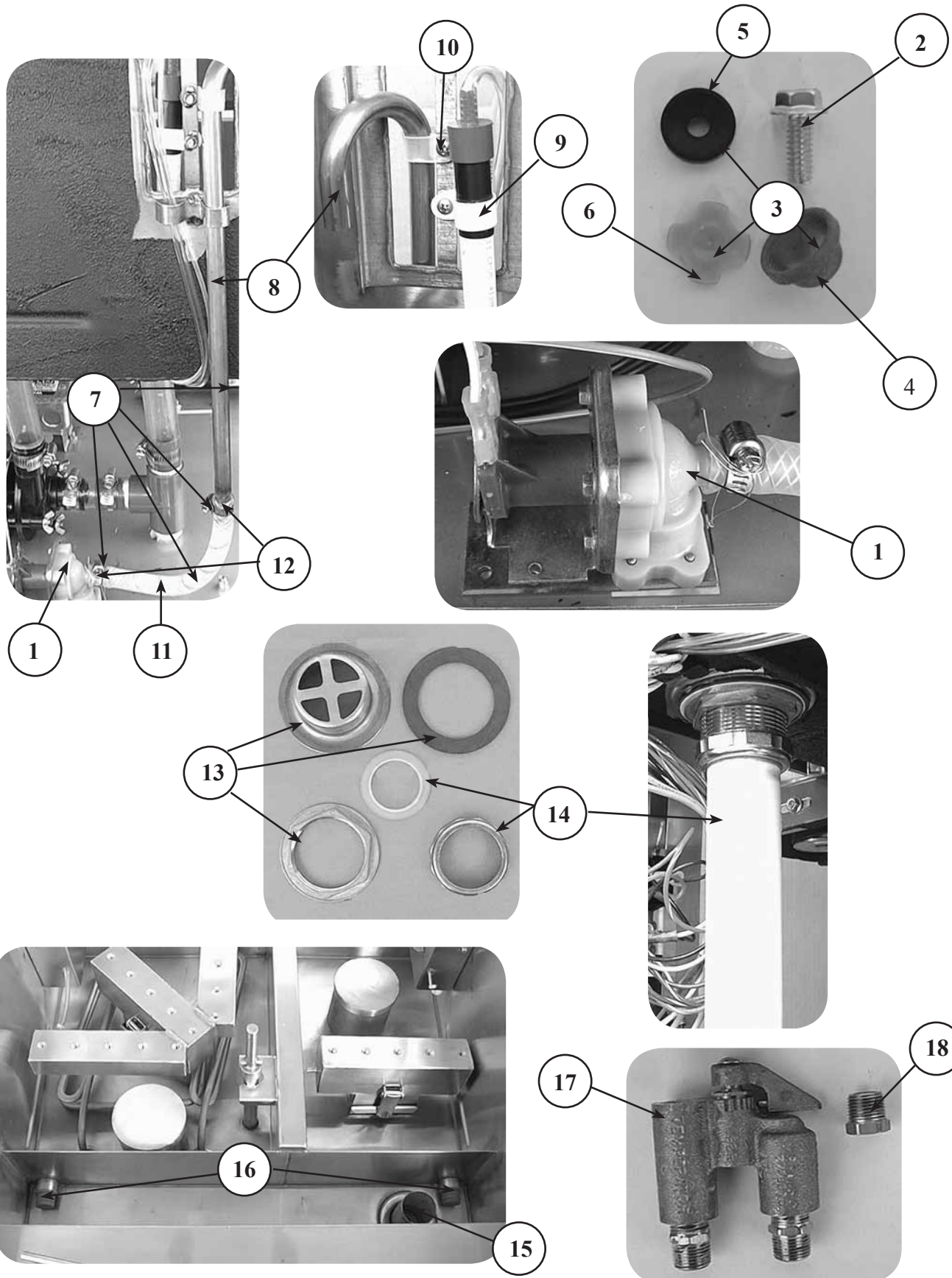



## PLUMBING COMPONENTS



<u>PART NO.</u>	<u>OLD PART NO.</u>	<u>DESCRIPTION</u>	<u>PRICE</u>
1. 01000561	GT-034301	Valve, water inlet	\$55.00
2. 00000041	GT-038746	Bolt, water inlet valve mounting, 1/4"-20 x 5/8", HWH	.50
3. 01000672	GT-036902	Water inlet valve screen kit	9.00
4. 01000848	GT-037001	Screen, water inlet valve (K-017716)	2.00
5. 01000812	GT-036002	Washer, water inlet valve flow (K-27632)	8.00
6. 01000813	GT-038451	Retainer, water inlet valve flow washer (K-26554)	2.00
7. 01000688	GT-037405	Water inlet assembly, GT-24 (consists of: 01000617, 01000519, and two 01000468)	33.00
01000689	GT-037406	Water inlet assembly, GT-30 (consists of: 01000617, 01000519, and two 01000468)	34.00
8. 01000519	GT-031707	Tube, water inlet, stainless steel	14.00
9. 00000005	GT-031114	Clamp, cable white nylon, 1/2" ID	.50
10. 00000025	GT-038710	Screw, cable clamp, 8-32 x 5/8", PPH	.50
11. 01000617	GT-035605	Hose, nylon braided, water inlet (per foot)	1.50
12. 01000468	GT-031110	Clamp, hose (2 required)	1.00
13. 01000766	GT-040904	Drain fitting with nut and gasket, stainless, 1-1/2"	12.00
14. 01000765	GT-040903	Drain tailpiece	6.00
15. 01000674	GT-037002	Screen, drain	21.00
16. 01000770	GT-040914	Plug, wash or rinse tank drain (2 required)	12.00

## ACCESSORIES

17. 01000828	GT-034300	Valve, mixing (Central Brass #555)	223.00
18. 01000600	GT-035217	Adapter, water inlet valve, 1/4" MPT to 3/8" FMPT	5.00

