

Replacement Parts Diagram

PROPRIETARY RIGHTS NOTICE This document and all information contained within it is the property of Hamilton Beach/Proctor-Silex, Inc. (HB/PS). It is confidential and proprietary and has been provided to you for a limited purpose. It must be returned upon request or destroyed as set forth in the Specification Notice. Disclosure, reproduction or use of this document and any information contained within it, in full or in part, for any purpose is forbidden without the prior written consent of HB/PS. No photographs may be taken of any article fabricated or assembled from this document without the prior written consent of HB/PS.

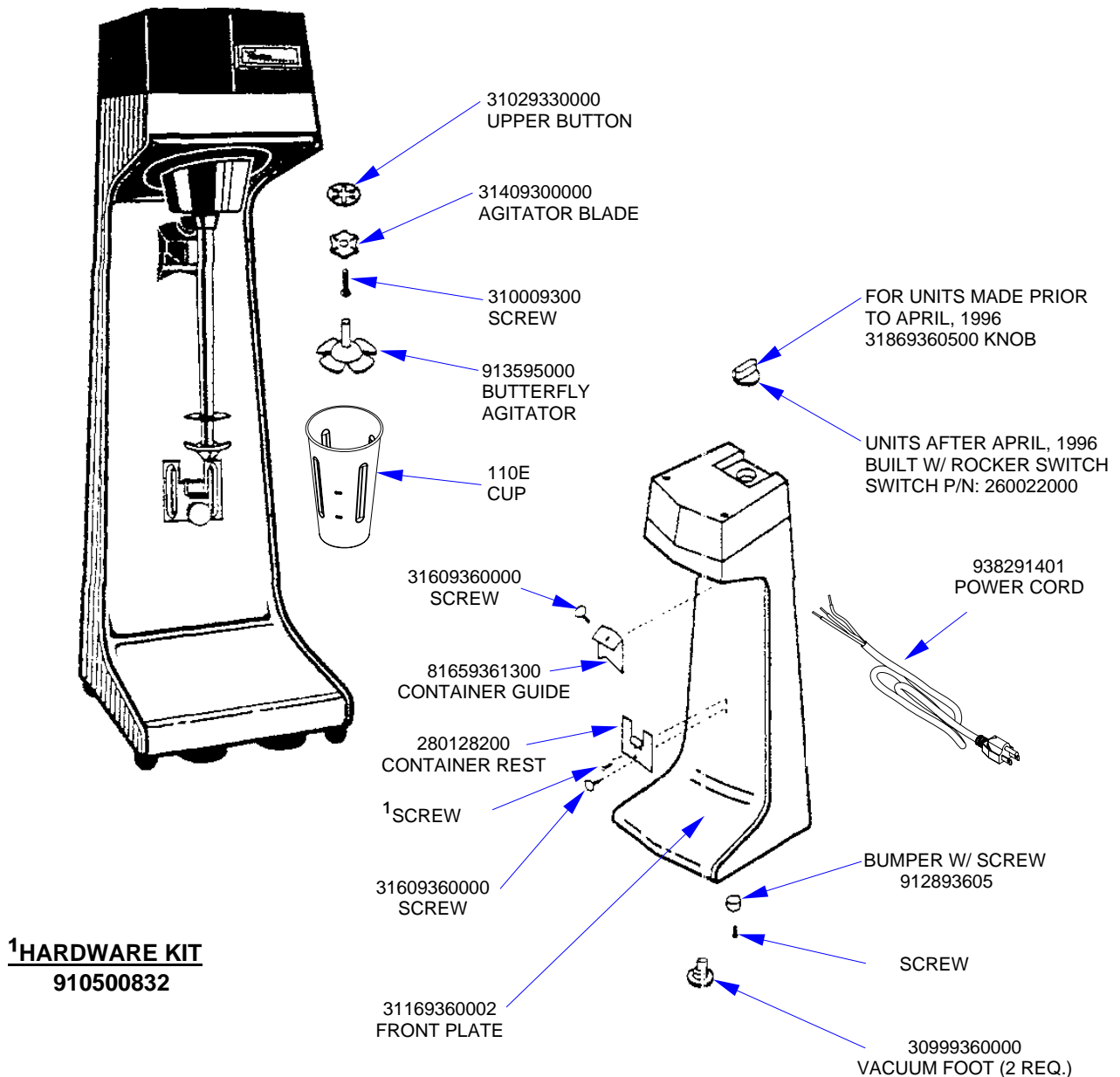

HAMILTON BEACH / PROCTOR-SILEX, INC. 4421 WATERFRONT DRIVE GLEN ALLEN, VA 23060		HQE-4817: Added Power Cord 938291401.			ISSUE CODE	
DRAWN BY: SN	ENG. IN CHG. TAG	DATE: 02/21/07	APPROVED BY:		SP	CS
INITIAL USE: 936	INITIAL TYPE GM36	SHEET 1 / 3	DRAWING NO. 5100016XX	REV. D		

Replacement Parts Diagram

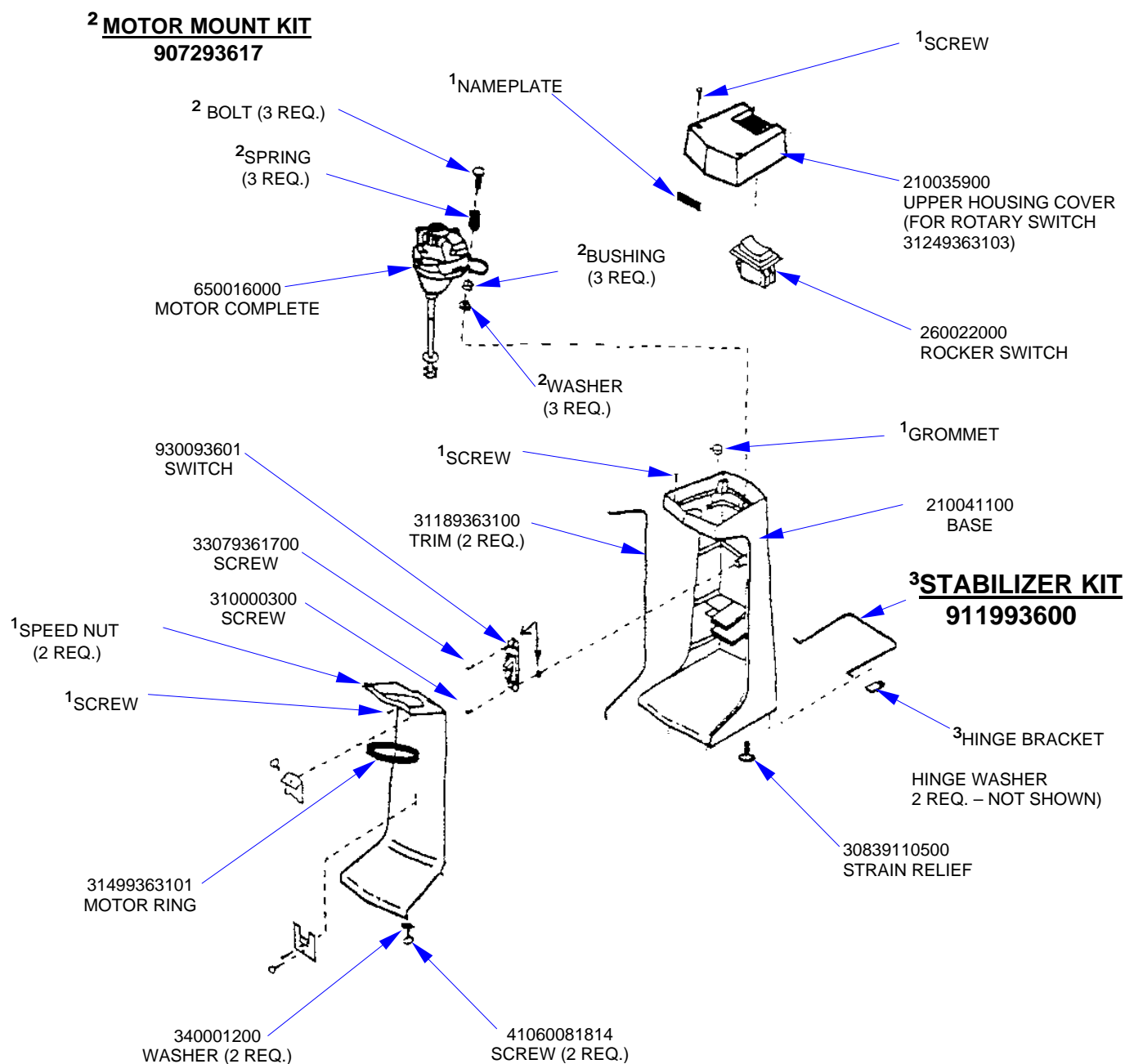

HAMILTON BEACH / PROCTOR-SILEX, INC. 4421 WATERFRONT DRIVE GLEN ALLEN, VA 23060		HQE-4817: Added Power Cord 938291401.			ISSUE CODE	
DRAWN BY: SN	ENG. IN CHG. TAG	DATE: 02/21/07	APPROVED BY:		SP	CS
INITIAL USE: 936	INITIAL TYPE GM36	SHEET 2 / 3	DRAWING NO. 5100016XX	REV. D		

Replacement Parts Diagram

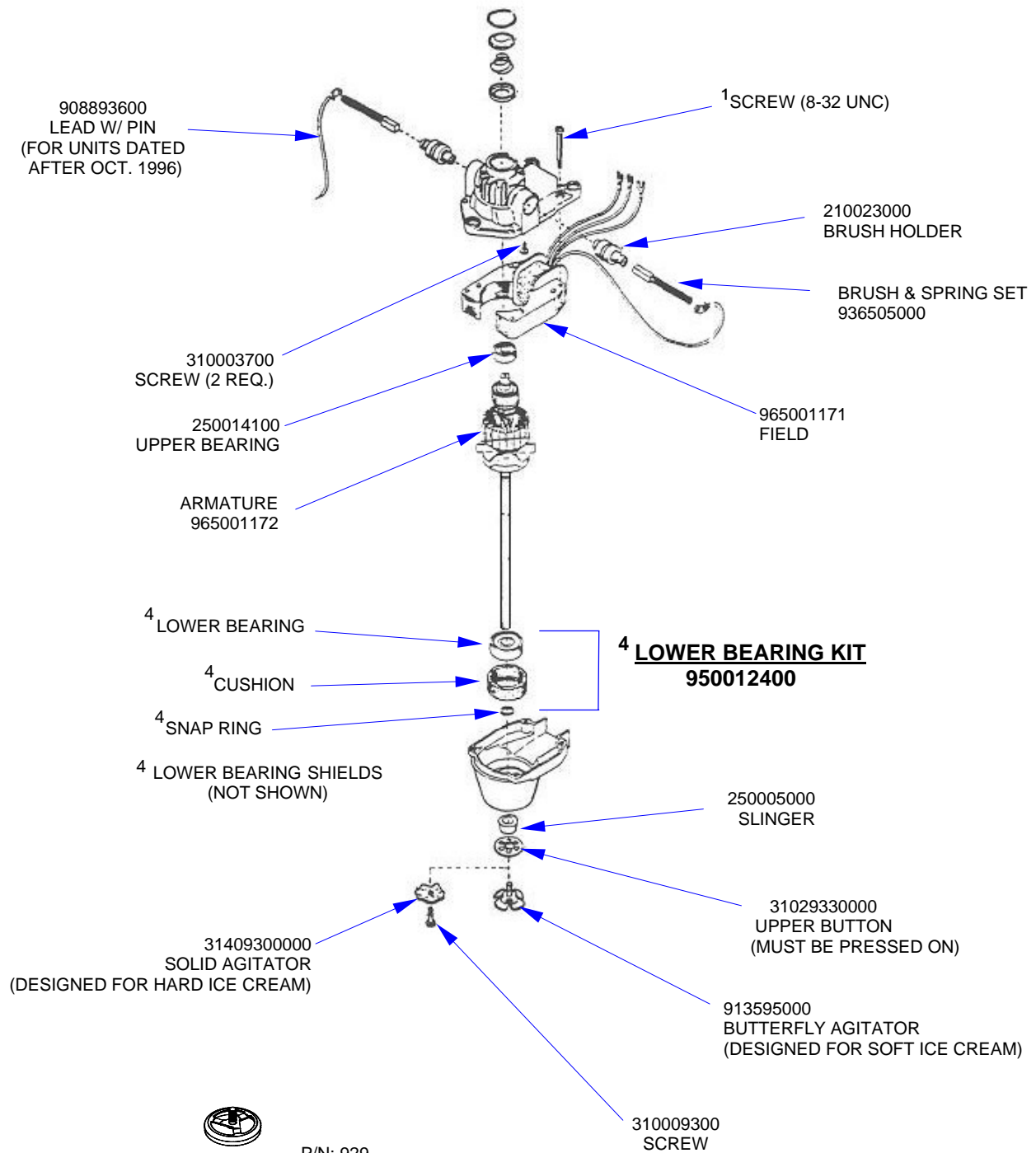

P/N: 929

OPTIONAL AGITATOR FOR ICE CREAM
(LARGER DIAMETER THAN SOLID AGITATOR)

HAMILTON BEACH / PROCTOR-SILEX, INC. 4421 WATERFRONT DRIVE GLEN ALLEN, VA 23060		HQE-4817: Added Power Cord 938291401.			ISSUE CODE	
DRAWN BY: SN	ENG. IN CHG. TAG	DATE: 02/21/07	APPROVED BY:		SP	CS
INITIAL USE: 936	INITIAL TYPE GM36	SHEET 3 / 3	DRAWING NO. 5100016XX	REV. D		