



# **GLO-RAY®**

## **Merchandising Warmer**

### **GRCMW-1 Series**

---

## **Installation and Operating Manual**

I&W #07.05.213.00

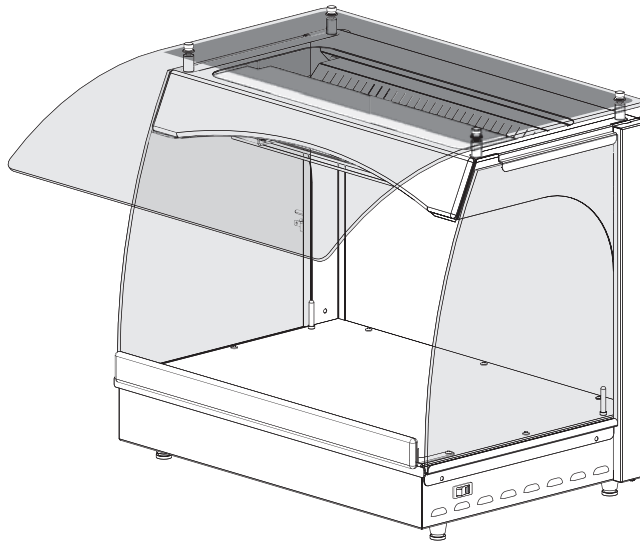

Do not operate this equipment unless you have read and understood the contents of this manual! Failure to follow the instructions contained in this manual may result in serious injury or death. This manual contains important safety information concerning the maintenance, use, and operation of this product. If you're unable to understand the contents of this manual, please bring it to the attention of your supervisor. Keep this manual in a safe location for future reference.



No opere este equipo al menos que haya leído y comprendido el contenido de este manual! Cualquier falla en el seguimiento de las instrucciones contenidas en este manual puede resultar en un serio lesión o muerte. Este manual contiene importante información sobre seguridad concerniente al mantenimiento, uso y operación de este producto. Si usted no puede entender el contenido de este manual por favor pregunte a su supervisor. Almacenar este manual en una localización segura para la referencia futura.

# CONTENTS

Important Owner Information .....	i	Operation .....	5
Introduction .....	i	General .....	5
Important Safety Information .....	1	Maintenance .....	6
Model Description .....	2	General .....	6
Model Designation .....	2	Cleaning .....	6
Specifications .....	2	Replacing Xenon Display Light Bulbs .....	6
Plug Configurations .....	2	Troubleshooting Guide .....	7
Electrical Rating Chart .....	2	Options and Accessories .....	8
Dimensions .....	3	Hatco Limited Warranty .....	9
Installation .....	3	Authorized Parts Distributors .....	Back Cover
General .....	3		
Assembly .....	4		

## IMPORTANT OWNER INFORMATION

Record the model number, serial number (specification label located on the bottom of the unit), voltage, and purchase date of the unit in the spaces below. Please have this information available when calling Hatco for service assistance.

Model No. \_\_\_\_\_

Serial No. \_\_\_\_\_

Voltage \_\_\_\_\_

Date of Purchase \_\_\_\_\_

Business Hours: 8:00 a.m. to 5:00 p.m.  
Central Standard Time  
  
(Summer Hours: June to September –  
8:00 a.m. to 5:00 p.m. C.S.T.  
Monday through Thursday  
8:00 a.m. to 2:30 p.m. C.S.T. Friday)

Telephone: (800) 558-0607; (414) 671-6350

Fax: (800) 690-2966 (Parts and Service)  
(414) 671-3976 (International)



24 Hour 7 Day Parts and Service Assistance  
available in the United States and Canada  
by calling (800) 558-0607.

Additional information can be found by visiting our web site at  
[www.hatcocorp.com](http://www.hatcocorp.com).

## INTRODUCTION

The Glo-Ray® Merchandising Warmer keeps food hot at kitchen work areas, waitress pick-up stations, or customer serving points.

The GRCMW-1 incorporates Hatco's precise temperature control to safely hold foods longer at optimum serving temperatures. Xenon display lights enhance product displays. The overhead infrared metal sheath heating element is guaranteed against breakage and burnout for two years, and the foil blanket base heating element is guaranteed against burnout for one year.

Model GRCMW-1 features easy access to the food product and 1 (25 mm) adjustable legs as standard equipment.

The Hatco Glo-Ray Merchandising Warmer is a product of extensive research and field testing. The materials used were selected for maximum durability, attractive appearance and optimum performance. Every unit is inspected and tested thoroughly prior to shipment.

This manual provides installation, safety, and operating instructions for the Glo-Ray Merchandising Warmer. Hatco recommends all installation, operating, and safety instructions appearing in this manual be read prior to installation or operation of the Merchandising Warmer.

Safety information that appears in this manual is identified by the following signal word panels:

### **WARNING**

**WARNING** indicates a hazardous situation which, if not avoided, could result in death or serious injury.

### **CAUTION**

**CAUTION** indicates a hazardous situation which, if not avoided, could result in minor or moderate injury.

### **NOTICE**

**NOTICE** is used to address practices not related to personal injury.

## IMPORTANT SAFETY INFORMATION



Read the following important safety information before using this equipment to avoid serious injury or death and to avoid damage to equipment or property.

### WARNING

#### ELECTRIC SHOCK HAZARD:

- Plug unit into a properly grounded electrical receptacle of the correct voltage, size, and plug configuration. If the plug and receptacle do not match, contact a qualified electrician to determine and install the proper voltage and size electrical receptacle.
- Turn the power switch OFF, unplug the power cord, and allow the unit to cool before performing any maintenance or cleaning.
- DO NOT submerge or saturate with water. Unit is not waterproof. Do not operate if unit has been submerged or saturated with water.
- Unit is not weatherproof. Locate the unit indoors where the ambient air temperature is a minimum of 70°F (21°C).
- Do not steam clean or use excessive water on the unit.
- Do not pull unit by power cord.
- Discontinue use if power cord is frayed or worn.
- Do not attempt to repair or replace a damaged power cord. The cord must be replaced by Hatco, an Authorized Hatco Service Agent, or a person with similar qualifications.
- This unit must be serviced by qualified personnel only. Service by unqualified personnel may lead to electric shock or burn.
- Use only Genuine Hatco Replacement Parts when service is required. Failure to use Genuine Hatco Replacement Parts will void all warranties and may subject operators of the equipment to hazardous electrical voltage, resulting in electrical shock or burn. Genuine Hatco Replacement Parts are specified to operate safely in the environments in which they are used. Some aftermarket or generic replacement parts do not have the characteristics that will allow them to operate safely in Hatco equipment.

**FIRE HAZARD:** Locate the unit a minimum of 1 (25 mm) from combustible walls and materials. If safe distances are not maintained, discoloration or combustion could occur.

This unit has no “user-serviceable” parts. If service is required on this unit, contact an Authorized Hatco Service Agent or contact the Hatco Service Department at 800-558-0607 or 414-671-6350; fax 800-690-2966; or International fax 414-671-3976.

### CAUTION

**BURN HAZARD:** Some exterior surfaces on the unit will get hot. Use caution when touching these areas.

Locate the unit at the proper counter height in an area that is convenient for use. The location should be level to prevent the unit or its contents from falling accidentally and strong enough to support the weight of the unit and contents.

Standard and approved manufacturing oils may smoke up to 30 minutes during initial startup. This is a temporary condition. Operate unit without food product until smoke dissipates.

### NOTICE

Use non-abrasive cleaners only. Abrasive cleaners could scratch the finish of the unit, marring its appearance and making it susceptible to soil accumulation.

Do not lay unit on the side with the control panel. Damage to the unit could occur.

Do not drag or slide the unit when moving or installing. Carefully lift the unit to prevent the rubber feet from tearing off.

**IMPORTANT — DO NOT** use paper towel or glass cleaner to clean polycarbonate surfaces. Paper towel and glass cleaner may scratch the material. Wipe off polycarbonate surfaces using a soft, clean and damp cloth.

## MODEL DESCRIPTION

### All Models

The GRCMW-1 Merchandising Warmer is ideal for holding food hot at customer serving points. This model features a pre-focused overhead infrared heating element and a heated base. The display lights, overhead heating element, and heated base are controlled by a lighted Power switch. The temperature of the heated base is controlled by a thermostatic temperature control on the back of the unit.

The unit also features glass or polycarbonate side panels, an upper sneeze guard, 1 (25 mm) adjustable legs, Xenon display lights, and 6 (1829 mm) cord and plug set.

The unit holds two 1/2-size pans or one full-size pan. The sneeze guard, side panels, and back mirror glass panel are removable for easy cleaning.

Options and accessories available include pan skirts, a polycarbonate front access door (in place of the sneeze guard), Decorative Stone trim pieces, and sign holders. Refer to the OPTIONS AND ACCESSORIES section for details.

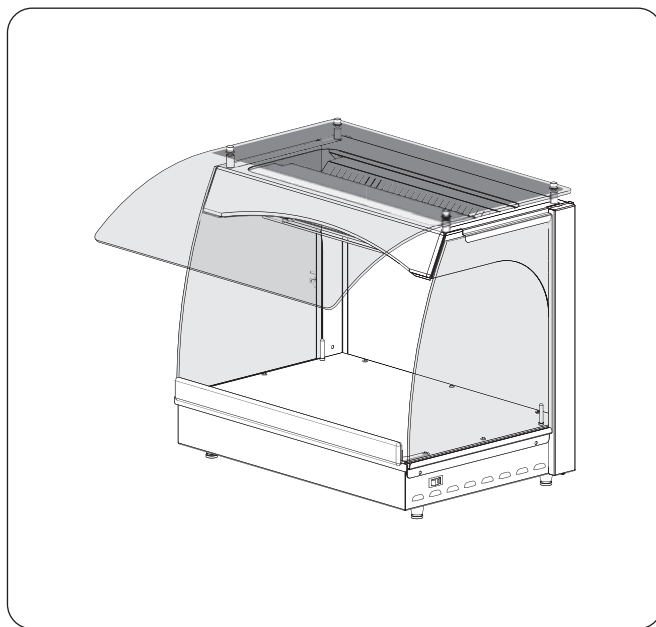

Figure 1. Model Description

## MODEL DESIGNATION

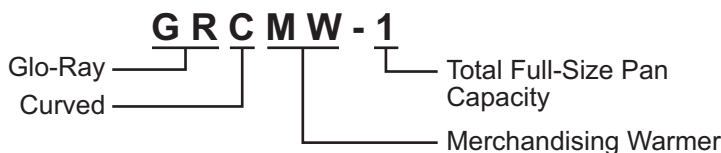

Figure 2. Model Designation

## SPECIFICATIONS

### Plug Configuration

Units are supplied from the factory with an electrical cord and plug installed. Plugs are supplied according to the applications.



**ELECTRIC SHOCK HAZARD:** Plug unit into a properly grounded electrical receptacle of the correct voltage, size, and plug configuration. If the plug and receptacle do not match, contact a qualified electrician to determine and install the proper voltage and size electrical receptacle.

*NOTE: Specification label located on bottom of unit. See label for serial number and verification of unit electrical information.*

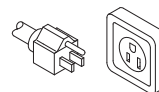

NEMA 5-15P

Figure 3. Plug Configuration

*NOTE: Receptacle not supplied by Hatco.*

### Electrical Rating Chart

Model	Voltage	Watts	Amps	Plug Configuration	Shipping Weight
GRCMW-1	120	670	5.6	NEMA 5-15P	52 lbs. (24 kg)

## Dimensions

Model	Width (A)	Bottom Depth (B)	Top Depth (C)	Height (D)	Footprint Width (E)	Footprint Depth (F)
GRCMW-1	22-1/8 (562 mm)	15 (381 mm)	21-1/2 (546 mm)	19-7/8 (505 mm)	19-3/4 (502 mm)	11-7/8 (302 mm)

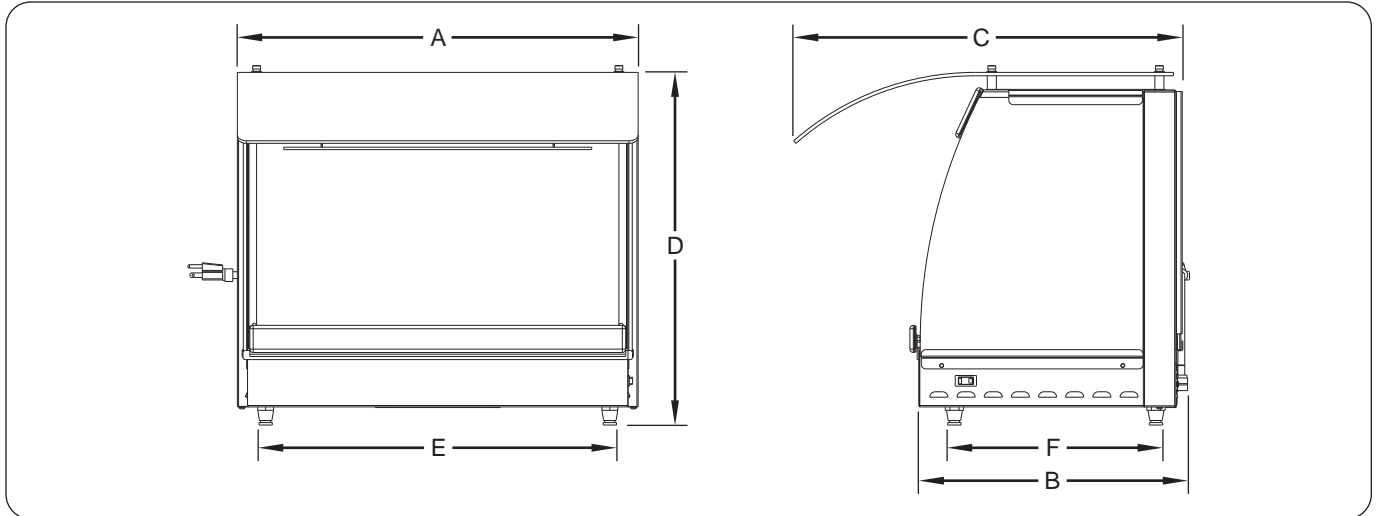

Figure 4. Dimensions

## INSTALLATION

### General

The Glo-Ray® Merchandiser Warmer is shipped with most components pre-assembled. Care should be taken when unpacking shipping carton to avoid damage to unit and components enclosed.



### WARNING

**ELECTRIC SHOCK HAZARD:** Unit is not weatherproof. Locate the unit indoors where the ambient air temperature is a minimum of 70°F (21°C).

### FIRE HAZARD:

- Locate the unit a minimum of 1 (25 mm) from combustible walls and materials. If safe distances are not maintained, discoloration or combustion could occur.



### CAUTION

Locate the unit at the proper counter height in an area that is convenient for use. The location should be level to prevent the unit or its contents from falling accidentally and strong enough to support the weight of the unit and contents.

*NOTE: Unit must be transported in the upright position.*

1. Remove the unit from the carton.

2. Remove the information packet.

*NOTE: To prevent delay in obtaining warranty coverage, fill out and mail in the warranty card to Hatco.*

3. Remove tape and protective packaging from all surfaces of the unit and any accessories.

### NOTICE

**Do not lay unit on the side with the control panel. Damage to the unit could occur.**

**Do not drag or slide the unit when moving or installing. Carefully lift the unit to prevent the rubber feet from tearing off.**

4. Place the unit in the desired location.

- Locate the unit in an area where the ambient air temperature is constant and a minimum of 70° F (21° C). Avoid areas that may be subject to active air movements or currents (i.e., near exhaust fans/hoods and air conditioning ducts).
- Make sure the unit is at the proper counter height in an area convenient for use.
- Make sure the countertop is level and strong enough to support the weight of the unit and food product.
- Make sure all the feet on the bottom of the unit are positioned securely on the countertop.

# INSTALLATION

## Assembly

Position the unit upright on the counter near the location it will be used. Installation of the following items is required before operating the unit:

### Qty. Item

- 1 Back Mirror Glass Panel, P/N 04.40.291.00
- 2 Glass Side Panel, P/N 04.40.289.00  
(Polycarbonate side panels are available as an option [P/N 04.12.348.00])
- 1 Polycarbonate Sneeze Guard, P/N 04.12.326.00

### Installing the Mirror Glass Panel

Use the following procedure to install the back mirror glass panel.

1. Position the mirror glass panel with the mirror side of the glass facing the inside of the unit.
2. Very carefully guide the mirror glass panel into the rear brackets located on the back of the unit, and lower the panel until it reaches the bottom bracket.

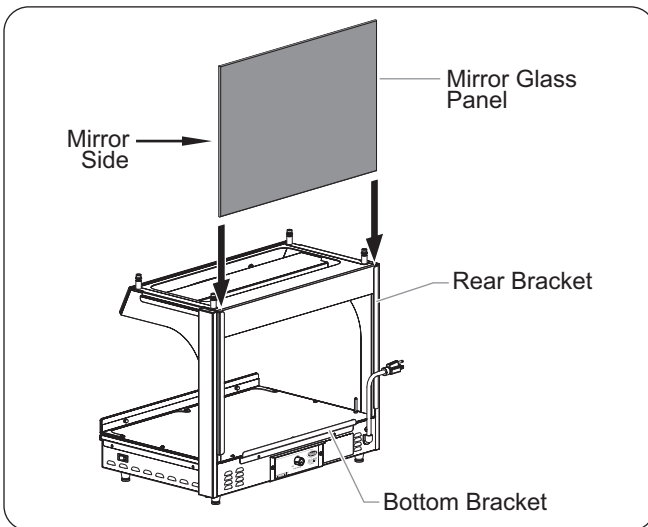

Figure 5. Installing the Back Mirror Glass Panel

### Installing the Side Panels

Use the following procedure to install the glass side panels or the optional polycarbonate side panels.

1. Remove the thumbscrews, washers, spacers, and top bracket from the top frame.
2. Position the side panel so that the curved edge is facing the front of the unit.
3. Carefully lower the bottom edge of the side panel into the bottom bracket.



**Do not allow the side panel to drop into position. Chipping or breakage could occur. Carefully set the side panel into the bottom bracket.**

4. Place the top bracket over the two screw pegs on the top frame. The top bracket will fit over and secure the top edge of the side panel.
5. Thread the two (2) spacers onto the screw pegs. Tighten securely, but do not over-tighten.

**NOTE:** Save the thumbscrews and washers for use during installation of the sneeze guard.

6. Repeat the above procedure to install the other side panel.

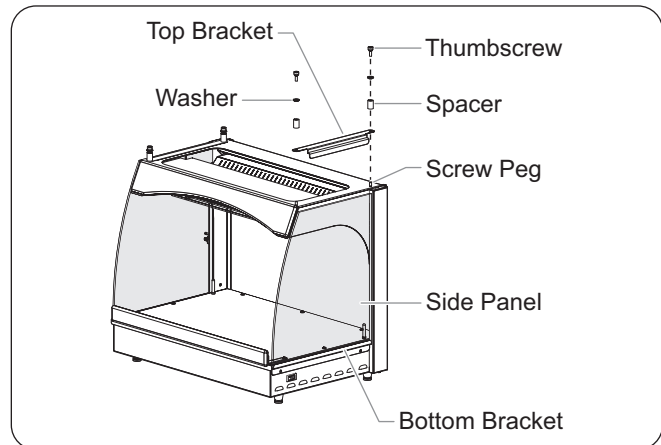

Figure 6. Installing a Side Panel

### Installing the Sneeze Guard

Use the following procedure to install the sneeze guard.

1. Remove any protective paper from the polycarbonate sneeze guard.
2. Remove the four (4) thumbscrews and washers from the top of the unit, if they haven't been already.
3. Position the sneeze guard on top of the unit, aligning the holes in the sneeze guard with the holes in the spacers on top of the unit.
4. Place a washer (previously removed) in each sneeze guard hole.
5. Secure the sneeze guard using the thumbscrews. Do not over-tighten.

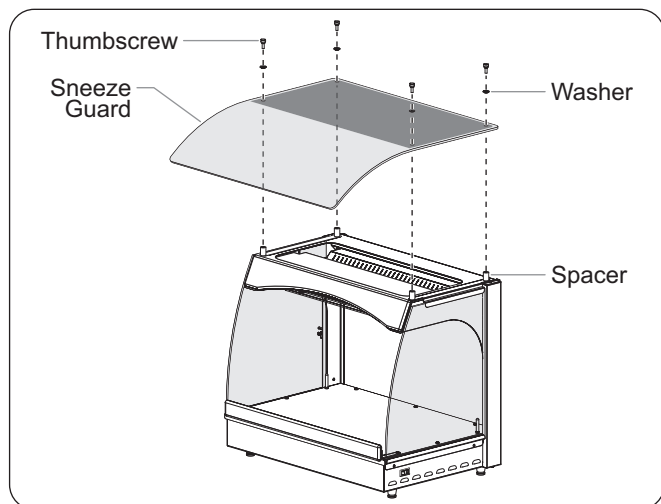

Figure 7. Installing the Sneeze Guard

## General

Use the following procedure to operate the Merchandising Warmer.



### WARNING

Read all safety messages in the IMPORTANT SAFETY INFORMATION section before operating this equipment.



### CAUTION

**BURN HAZARD:** Some exterior surfaces on the unit will get hot. Use caution when touching these areas.

Standard and approved manufacturing oils may smoke up to 30 minutes during initial startup. This is a temporary condition. Operate unit without food product until smoke dissipates.

1. Plug unit into a properly grounded electrical receptacle of the correct voltage, size and plug configuration. See the SPECIFICATIONS section for details.
2. Move the Power Switch to the "On" position (located on the side of the unit).
  - The switch will illuminate and the display lights will turn on.
  - The overhead heating element and the heated base will energize.

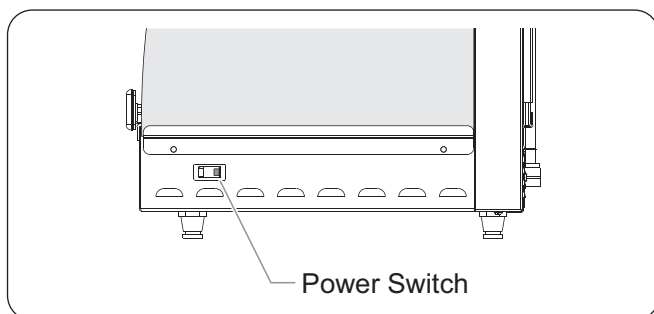

Figure 8 Power Switch

3. Turn the BASE HEAT control knob to the desired setting (located on the back of the unit).

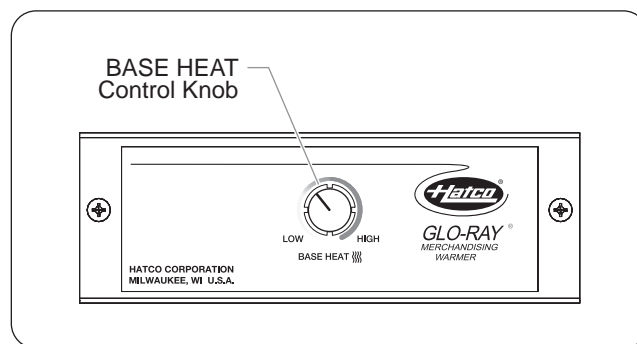

Figure 9 Control Panel

4. Allow 15-20 minutes for the unit to reach operating temperature.



# MAINTENANCE

## General

The Glo-Ray® Merchandising Warmer is designed for maximum durability and performance, with minimum maintenance.

### **WARNING**

#### ELECTRIC SHOCK HAZARD:

- Turn the power switch OFF, unplug the power cord, and allow the unit to cool before performing any maintenance or cleaning.
- DO NOT submerge or saturate with water. Unit is not waterproof. Do not operate if unit has been submerged or saturated with water.
- Do not steam clean or use excessive water on the unit.
- Use only Genuine Hatco Replacement Parts when service is required. Failure to use Genuine Hatco Replacement Parts will void all warranties and may subject operators of the equipment to hazardous electrical voltage, resulting in electrical shock or burn. Genuine Hatco Replacement Parts are specified to operate safely in the environments in which they are used. Some aftermarket or generic replacement parts do not have the characteristics that will allow them to operate safely in Hatco equipment.

This unit has no “user-serviceable” parts. If service is required on this unit, contact an Authorized Hatco Service Agent or contact the Hatco Service Department at 800-558-0607 or 414-671-6350; fax 800-690-2966; or International fax 414-671-3976.

## Cleaning

To preserve the finish of the Glo-Ray Merchandising Warmer, perform the following cleaning procedure daily.

### **NOTICE**

Use non-abrasive cleaners only. Abrasive cleaners could scratch the finish of the unit, marring its appearance and making it susceptible to soil accumulation.

**IMPORTANT** — DO NOT use paper towel or glass cleaner to clean the polycarbonate surfaces. Paper towel and glass cleaner may scratch the material. Wipe off polycarbonate surfaces using a soft, clean and damp cloth.

*NOTE: The sneeze guard, side panels, and back mirror glass panel are removable for cleaning. Reverse the procedures in the INSTALLATION section of this manual for removal.*

- Wipe all metal surfaces with a damp cloth. Stubborn stains may be removed with a good non abrasive cleaner.
- Clean hard to reach areas using a small brush and mild soap.
- Clean the glass side panels and back mirror glass panels using ordinary glass cleaner and a damp, soft cloth or paper towel.
- Clean the polycarbonate sneeze guard, doors, and side panels (if equipped) using a mild, soapy water solution and a damp, soft cloth. **NOTICE: DO NOT use paper towel.**

## Replacing Xenon Display Light Bulbs

The warmer is equipped with two Xenon display lamps to illuminate the warming area. Use the following procedure to replace the Xenon light bulbs (Hatco P/N 02.30.122.00).

1. Move the Power Switch to the “Off” position and unplug the power cord. Allow the unit to cool.
2. Pull the wire guard out of the display lamp housing.
3. Unscrew the light bulb from the housing and replace it with a new Xenon light bulb.
4. Replace the wire guard into the display lamp housing.

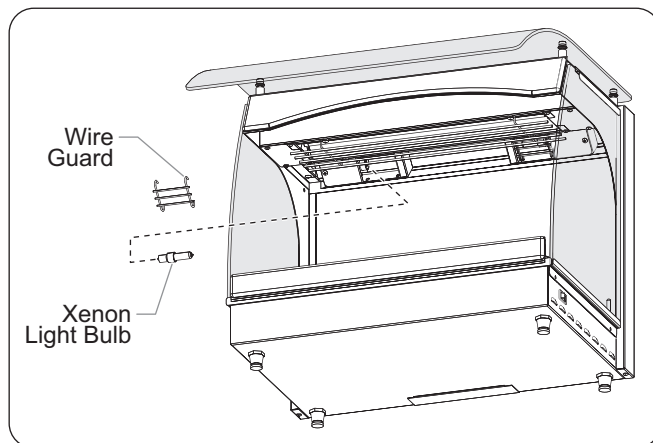

Figure 10. Replacing the Display Light Bulbs



# TROUBLESHOOTING GUIDE



## WARNING

This unit must be serviced by trained and qualified personnel only. Service by unqualified personnel may lead to electric shock or burn.



## WARNING

**ELECTRIC SHOCK HAZARD:** Turn the power switch OFF, unplug the power cord, and allow the unit to cool before performing any maintenance or cleaning.

Symptom	Probable Cause	Corrective Action
Light bulb not working.	Light bulb loose or defective.	Tighten or replace light bulb. Use Hatco P/N 02.30.122.00.
	Power Switch turned OFF.	Move Power Switch to "On" position.
	Unit not plugged in or receptacle not working.	Plug in unit, have receptacle repaired by a certified electrician, or use a different receptacle.
Overhead heat is too hot.	Internal overhead heat temperature control not working properly.	Contact Authorized Service Agent or Hatco for assistance.
Overhead heat is not hot enough.	Internal overhead heat temperature control not working properly.	Contact Authorized Service Agent or Hatco for assistance.
	Heating element not working.	Contact Authorized Service Agent or Hatco for assistance.
	Excessive air movement around warming unit.	Relocate unit or redirect air movement (i.e. air conditioning duct or exhaust fan) away from unit. Replace sneeze guard with optional front access door assembly to keep heat contained.
Base heat is too hot.	BASE HEAT control knob set too high.	Adjust BASE HEAT control knob to a lower setting.
	Base heat thermostat control defective.	Contact Authorized Service Agent or Hatco for assistance.
Base heat is not hot enough.	BASE HEAT control knob set too low.	Adjust BASE HEAT control knob to a higher setting.
	Base heat thermostat control defective.	Contact Authorized Service Agent or Hatco for assistance.
	Base heating element not working.	Contact Authorized Service Agent or Hatco for assistance.
	Excessive air movement around warming unit.	Relocate unit or redirect air movement (i.e. air conditioning duct or exhaust fan) away from unit. Replace sneeze guard with optional front access door assembly to keep heat contained.
No heat, but lights work.	Heating elements not working.	Contact Authorized Service Agent or Hatco for assistance.
	Temperature control not working properly.	Contact Authorized Service Agent or Hatco for assistance.
No heat and no lights.	Power Switch turned off.	Move Power Switch to "On" position.
	Unit not plugged in or receptacle not working.	Plug in unit, have receptacle repaired by a certified electrician, or use a different receptacle.
	Circuit breaker tripped.	Reset circuit breaker. If circuit breaker continues to trip, contact Authorized Service Agent or Hatco for assistance.
	Power Switch defective.	Contact Authorized Service Agent or Hatco for assistance.

# OPTIONS AND ACCESSORIES

## **⚠ WARNING**

**ELECTRIC SHOCK HAZARD:** Turn the power switch OFF, unplug the power cord, and allow the unit to cool before performing any maintenance or cleaning.

### Sign Holders

Several sign holders are available for the Glo-Ray® Merchandising Warmer.

#### Top Sign Holder (P/N 04.49.057.00)

The top sign holder mounts on the top of the unit and allows the display of custom signs.

1. Remove the four (4) thumbscrews and washers from the top of the unit. Remove the sneeze guard.
2. Unscrew the four spacers from the screw pegs on the top frame.
3. Position the top sign holder on the screw pegs.
4. Thread the four spacers onto the screw pegs and tighten securely.
5. Position the sneeze guard on top of the unit, aligning the holes in the sneeze guard with the holes in the spacers on top of the unit.
6. Place a washer (previously removed) in each sneeze guard hole.
7. Secure the sneeze guard using the thumbscrews. Do not over-tighten.

#### Front Sign Holders

The following front sign holder options are available for the unit. The front sign holders will be installed at the factory if ordered at the time of sale, but can be retro-fitted using the following procedure.

<u>Part Number</u>	<u>Accessory</u>
04.49.049.00 .....	<b>Sign Holder</b> — Allows placement of a custom sign on units without the front access door.
04.49.063.00 .....	<b>Sign Holder w/Door</b> — Allows placement of a custom sign on units equipped with the front access door.

1. Remove the two outside front screws on the heated base.
2. Align the holes on the sign holder mounting brackets with the screw holes in the heated base.
3. Insert the screws removed in step #1 through the mounting brackets and into the heated base. Tighten securely.

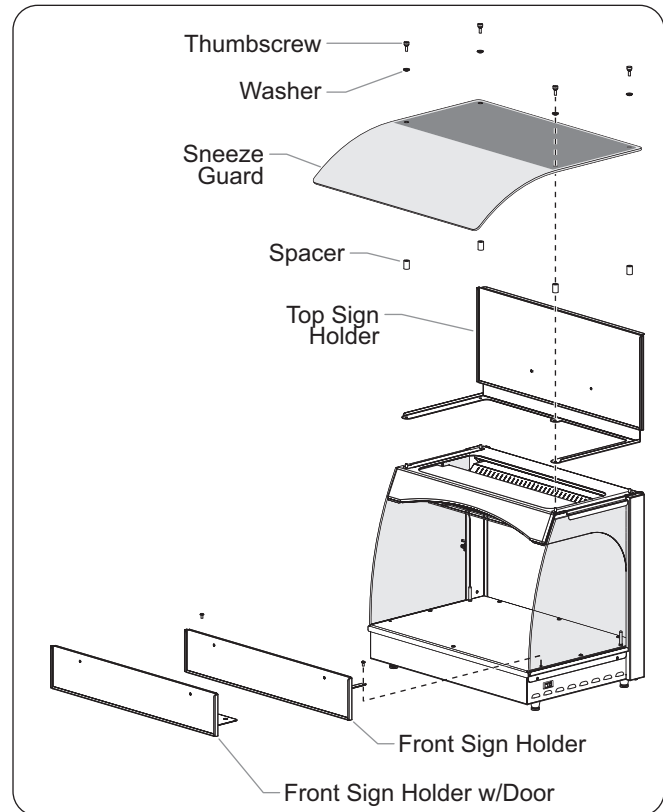

Figure 11. Sign Holders and Door Locks

### Pan Skirts

Pan skirts are available to fit various pan sizes. To install a pan skirt, position the skirt on top of the heated base. The two base pins located at the rear of the heated base will be on the inside of the skirt.

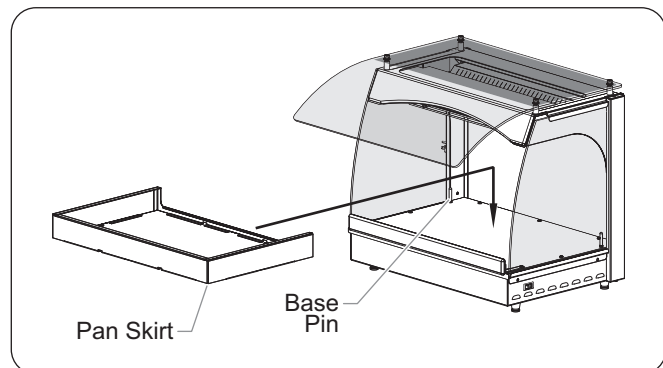

Figure 12. Installing a Pan Skirt

## OPTIONS AND ACCESSORIES

### Front Access Door

A front access door is available for the unit. The front access door will be installed at the factory if ordered at the time of sale, but can be retro-fitted using the following procedure. When installing the front access door, the sneeze guard must be replaced with top protector P/N 04.12.341.00. The following parts are needed to install the front access doors.

Part Number	Item	Qty.
-----	Front Access Door Assembly	1
05.04.146.00	Hinge Screw	2
04.49.002.00	Right Hinge Bracket	1
04.49.003.00	Left Hinge Bracket	1

1. Remove the four (4) thumbscrews and washers from the sneeze guard. Remove the sneeze guard.
2. Position the right hinge bracket and the left hinge bracket on top of their corresponding spacers, aligning the holes in the brackets with the holes in the spacers.
3. Position the top protector on top of the hinge brackets, aligning the holes in the top protector with the holes in the hinge brackets/spacers.
4. Place a washer (previously removed) into each hole in the top protector.
5. Secure the top protector and hinge brackets using the thumbscrews. Do not over-tighten.
6. Thread a hinge screw into one side of the hinge on the top of the door. Tighten securely.

7. Insert the hinge screw on the door into the hole in the hinge bracket on the unit.
8. Align the hole on the opposite side of the hinge with the hole in the hinge bracket on the opposite side of the unit.
9. Insert the remaining hinge screw through the hinge bracket and into the hinge on the door. Tighten securely.

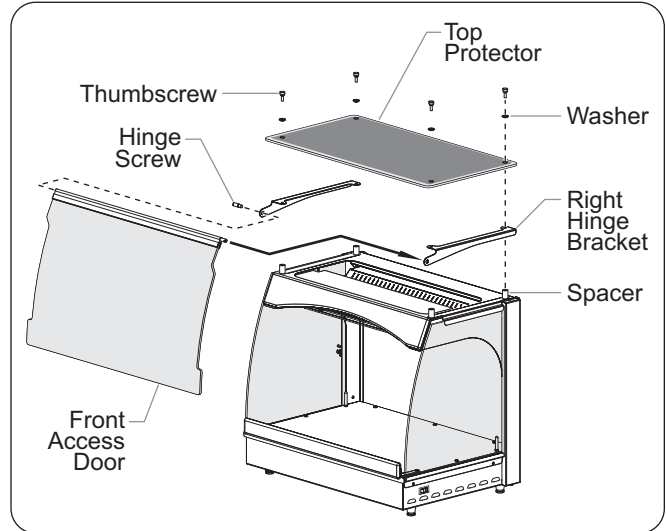

Figure 13. Installing the Front Access Door

## LIMITED WARRANTY

### 1. PRODUCT WARRANTY

Hatco warrants the products that it manufactures (the "Products") to be free from defects in materials and workmanship, under normal use and service, for a period of one (1) year from the date of purchase when installed and maintained in accordance with Hatco's written instructions or 18 months from the date of shipment from Hatco. Buyer must establish the Product's purchase date by returning Hatco's Warranty Registration Card or by other means satisfactory to Hatco in its sole discretion.

Hatco warrants the following Product components to be free from defects in materials and workmanship from the date of purchase (subject to the foregoing conditions) for the period(s) of time and on the conditions listed below:

- a) One (1) Year Parts and Labor PLUS One (1) Additional Year Parts-Only Warranty:**  
Conveyor Toaster Elements (metal sheathed)  
Drawer Warmer Elements (metal sheathed)  
Drawer Warmer Drawer Rollers and Slides  
Food Warmer Elements (metal sheathed)  
Display Warmer Elements (metal sheathed air heating)  
Holding Cabinet Elements (metal sheathed air heating)  
Built-In Heated Well Elements (metal sheathed)
- b) One (1) Year Parts and Labor PLUS Four (4) Years Parts-Only Warranty on pro-rated terms that Hatco will explain at Buyer's request:**  
3CS and FR Tanks
- c) One (1) Year Parts and Labor PLUS Nine (9) Years Parts-Only Warranty on:**  
Electric Booster Heater Tanks  
Gas Booster Heater Tanks
- d) Ninety (90) Day Parts-Only Warranty:**  
Replacement Parts

THE FOREGOING WARRANTIES ARE EXCLUSIVE AND IN LIEU OF ANY OTHER WARRANTY, EXPRESSED OR IMPLIED, INCLUDING BUT NOT LIMITED TO ANY IMPLIED WARRANTY OF MERCHANTABILITY OR FITNESS FOR A PARTICULAR PURPOSE OR PATENT OR OTHER INTELLECTUAL PROPERTY RIGHT INFRINGEMENT. Without limiting the generality of the foregoing, SUCH WARRANTIES DO NOT COVER: Coated incandescent light bulbs, fluorescent lights, decorative heat lamp bulbs, coated halogen light bulbs, halogen heat lamp bulbs, heated glass shelves, glass components, and fuses. Product failure in booster tank, fin tube heat exchanger, or other water heating equipment caused by liming, sediment buildup, chemical attack, or freezing. Product misuse, tampering or misapplication, improper installation, or application of improper voltage.

### 2. LIMITATION OF REMEDIES AND DAMAGES

Hatco's liability and Buyer's exclusive remedy hereunder will be limited solely, at Hatco's option, to repair or replacement by a Hatco-authorized service agency (other than where Buyer is located outside of the United States, Canada, United Kingdom, or Australia, in which case Hatco's liability and Buyer's exclusive remedy hereunder will be limited solely to replacement of part under warranty) with respect to any claim made within the applicable warranty period referred to above. Hatco reserves the right to accept or reject any such claim in whole or in part. Hatco will not accept the return of any Product without prior written approval from Hatco, and all such approved returns shall be made at Buyer's sole expense. HATCO WILL NOT BE LIABLE, UNDER ANY CIRCUMSTANCES, FOR CONSEQUENTIAL OR INCIDENTAL DAMAGES, INCLUDING BUT NOT LIMITED TO LABOR COSTS OR LOST PROFITS RESULTING FROM THE USE OF OR INABILITY TO USE THE PRODUCTS OR FROM THE PRODUCTS BEING INCORPORATED IN OR BECOMING A COMPONENT OF ANY OTHER PRODUCT OR GOODS.

# HATCO AUTHORIZED PARTS DISTRIBUTORS

## ALABAMA

Jones McLeod Appl. Svc.  
Birmingham 205-251-0159

## ARIZONA

Auth. Comm. Food Equip.  
Phoenix 602-234-2443

Byassee Equipment Co.  
Phoenix 602-252-0402

## CALIFORNIA

Industrial Electric  
Commercial Parts & Service, Inc.  
Huntington Beach 714-379-7100

Chapman Appl. Service  
San Diego 619-298-7106

P & D Appliance  
Commercial Parts & Service, Inc.  
S. San Francisco 650-635-1900

## COLORADO

Hawkins Commercial Appliance  
Englewood 303-781-5548

## FLORIDA

Whaley Foodservice Repair  
Jacksonville 904-725-7800

Nass Service Co., Inc.  
Orlando 407-425-2681

B.G.S.I.  
Pompano Beach 954-971-0456

Comm. Appliance Service  
Tampa 813-663-0313

## GEORGIA

TWC Services  
Smyrna 770-438-9797

Heritage Service Group  
Norcross 866-388-9837

Southeastern Rest. Svc.  
Norcross 770-446-6177

## HAWAII

Burney's Comm. Service, Inc.  
Honolulu 808-848-1466

Food Equip Parts & Service  
Honolulu 808-847-4871

## ILLINOIS

Parts Town  
Lombard 708-865-7278

Eichenauer Elec. Service  
Decatur 217-429-4229

Midwest Elec. Appl. Service  
Elmhurst 630-279-8000

Cone's Repair Service  
Moline 309-797-5323

## INDIANA

GCS Service  
Indianapolis 317-545-9655

## IOWA

Electric Motor Service Co.  
Davenport 319-323-1823

Goodwin Tucker Group  
Des Moines 515-262-9308

## KENTUCKY

Certified Service Center  
Lexington 859-254-8854

Certified Service Center  
Louisville 502-964-7007

## LOUISIANA

Chandlers Parts & Service  
Baton Rouge 225-272-6620

## MARYLAND

Electric Motor Service  
Baltimore 410-467-8080

GCS Service  
Silver Spring 301-585-7550

## MASSACHUSETTS

Ace Service Co., Inc.  
Needham 781-449-4220

## MICHIGAN

Commercial Kitchen Service  
Bay City 517-893-4561

Bildons Appliance Service  
Detroit 248-478-3320

Midwest Food Equip. Service  
Grandville 616-261-2000

## MINNESOTA

GCS Service  
Minneapolis 800-822-2303

## MISSOURI

General Parts  
Kansas City 816-421-5400

Commercial Kitchen Services  
St. Louis 314-890-0700

Kaemmerlen Parts & Service  
St. Louis 314-535-2222

## NEBRASKA

Anderson Electric  
Omaha 402-341-1414

## NEVADA

Burney's Commercial  
Las Vegas 702-736-0006

Hi. Tech Commercial Service  
N. Las Vegas 702-649-4616

## NEW JERSEY

Jay Hill Repair  
Fairfield 973-575-9145

Service Plus  
Flanders 973-691-6300

## NEW YORK

Acme American Repairs, Inc.  
Brooklyn 718-456-6544

Alpro Service Co.  
Brooklyn 718-386-2515

Appliance Installation  
Buffalo 716-884-7425

3Wire Northern  
Plattsburgh 800-634-5005

J.B. Brady, Inc.  
Syracuse 315-422-9271

## NORTH CAROLINA

Authorized Appliance  
Charlotte 704-377-4501

## OHIO

Akron/Canton Comm. Svc. Inc.  
Akron 330-753-6635

Certified Service Center  
Cincinnati 513-772-6600

Commercial Parts and Service  
Columbus 614-221-0057

Electrical Appl. Repair Service  
Independence 216-459-8700

E. A. Wichman Co.  
Toledo 419-385-9121

## OKLAHOMA

Hagar Rest. Service, Inc.  
Oklahoma City 405-235-2184

Krueger, Inc.  
Oklahoma City 405-528-8883

## OREGON

Ron's Service, Inc.  
Portland 503-624-0890

## PENNSYLVANIA

Elmer Schultz Services  
Philadelphia 215-627-5401

FAST Comm. Appl. Service  
Philadelphia 215-288-4800

Appliance Installation & Service  
Pittsburgh 412-809-0244

K & D Service Co.  
Harrisburg 717-236-9039

Electric Repair Co.  
Reading 610-376-5444

## RHODE ISLAND

Marshall Electric Co.  
Providence 401-331-1163

## SOUTH CAROLINA

Whaley Foodservice Repair  
W. Columbia 803-791-4420

## TENNESSEE

Camp Electric  
Memphis 901-527-7543

## TEXAS

GCS Service  
Fort Worth 800-433-1804

Armstrong Repair Service  
Houston 713-666-7100

Cooking Equipment Specialist  
Mesquite 972-686-6666

Commercial Kitchen Repair Co.  
San Antonio 210-735-2811

## UTAH

La Monica's Rest. Equip. Service  
Murray 801-263-3221

## VIRGINIA

Daubers  
Norfolk 757-855-4097

Daubers  
Springfield 703-866-3600

## WASHINGTON

3Wire Restaurant Appliance  
Seattle 866-770-2022

## WISCONSIN

A.S.C., Inc.  
Madison 608-246-3160

A.S.C., Inc.  
Milwaukee 414-543-6460

## Canada

### ALBERTA

Key Food Equipment Service  
Edmonton 780-438-1690

### BRITISH COLUMBIA

Key Food Equipment Service  
Vancouver 604-433-4484

Key Food Equipment Service  
Victoria 250-920-4888

### MANITOBA

Air Rite, Inc.  
Winnipeg 204-895-2300

### NEW BRUNSWICK

EMR Services, Ltd.  
Moncton 506-855-4228

### ONTARIO

R.G. Henderson Ltd.  
Toronto 416-422-5580

Choquette CKS  
Ottawa 613-739-8458

### QUÉBEC

Choquette CKS  
Montreal 514-722-2000

Choquette CKS  
Québec City 418-681-3944

## United Kingdom

Marren Group  
Northants +44(0)1933 666233

HATCO CORPORATION  
P.O. Box 340500  
Milwaukee, WI 53234-0500 U.S.A.  
(800) 558-0607 (414) 671-6350  
Parts and Service Fax (800) 690-2966  
International Fax (414) 671-3976  
www.hatcocorp.com