

SECTION 4. PARTS INFORMATION

4-1. INTRODUCTION

This section identifies and lists the replaceable parts of the Henny Penny display.

4-2. GENUINE PARTS

Use only genuine Henny Penny parts in your cabinet. Using a part of lesser quality or substitute design may result in cabinet damage or personal injury.

4-3. HOW TO ORDER

Once the part you want to order has been found in the Parts List, write down the following information:

1. From the Parts List
(Sample)

Item Number 8
Part Number EF02-105
Description Fuse

2. From the data plate
(Sample)

Product Number HDS320.0
Serial Number JG05060102
Voltage 120/240V

4-4. PRICES

Your independent Henny Penny distributor has a price parts list and will be glad to inform you of the cost of your parts order.

4-5. DELIVERY

Commonly replaced items are stocked by your independent Henny Penny distributor and will be sent out when your order is received. Other parts will be ordered by the distributor from Henny Penny Corporation. Normally, these will be sent to your distributor within three working days.

4-6. WARRANTY

All replacement parts (except lamps and fuses) are covered under warranty for 90 days against manufacturing defects and workmanship. If damage occurs during shipping, notify the carrier at once so that a claim may be properly filed. Refer to warranty on the front of this section for other rights and limitations.

4-7. RECOMMENDED SPARE PARTS FOR DISTRIBUTORS

Recommended replacement parts, stocked by your distributor, are indicated with ✓ in the parts lists. Please use care when ordering recommended parts, because all voltages and variations are marked. Distributors should order parts based upon common voltages and equipment sold in their territory.

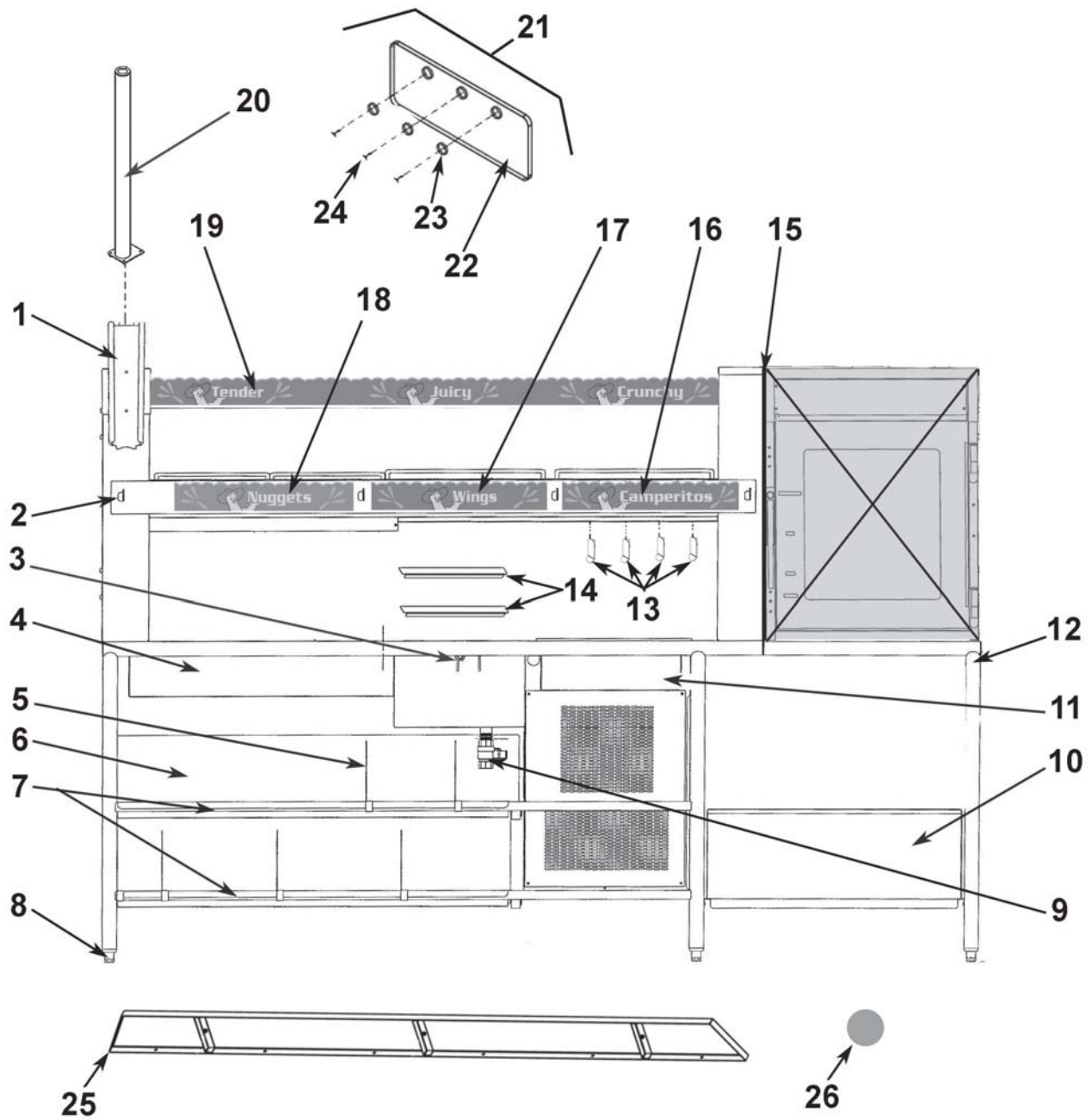

Figure 4-1. Customer Side Parts

Figure

Figure & Item No.	Part No.	Description	Quantity
4-1		Customer Side Parts	
1	71317	Weld Assy - Small Envelope Dispenser	2
2	70985	Stud Assy - Tongs Hanger	8
3	71425	Hanger - T-Shirt Bag	2
4	70663	Bin - 6 inch Tall HDS Storage	2
✓ 5	71219	Divider - Removable Shelf	25
6	70447	Wall - HDS310 - Middle	1
7	71216	Shelf - Removable Table	2
8	26120	Foot - Adjustable	4
9	70043	Valve - 1 inch NPT SS Ball	1
10	03545	Support - MP941 Cabinet (Optional)	1
11	70664	Bin - 5 inch Tall HDS Storage	2
12	03544	Extension Table	1
13	70751	Stud Assy - Clip Card Holder	6
✓ 14	69782	Support - Hot Well Pan	2
15a	69567	Gasket - Vertical HDs	2
15b	69568	Gasket - Horizontal HDS	1
16	72402	Banner - Camperitos	1
17	72401	Banner - Wings	1
18	72400	Banner - Nuggets	1
19	72399	Banner - Tender, Juicy, Crunchy	1
20	70928	Weld Assy - Flanged Wireway (Optional)	1
21	03546	Board - Magnetic HDPE Cutting (Optioinal)	2
22	71397	Board - Countertop Extension	2
23	MS01-531	Magnet - Encased Ceramic Cup	3
24	SC02-023	Screw - #8-B X 3/8 PH Pan S	3
25	73798	Weld Assy - 5 in. Table Extension (Optional)	2
26	PL01-036	Plug Button - 9/32"	12

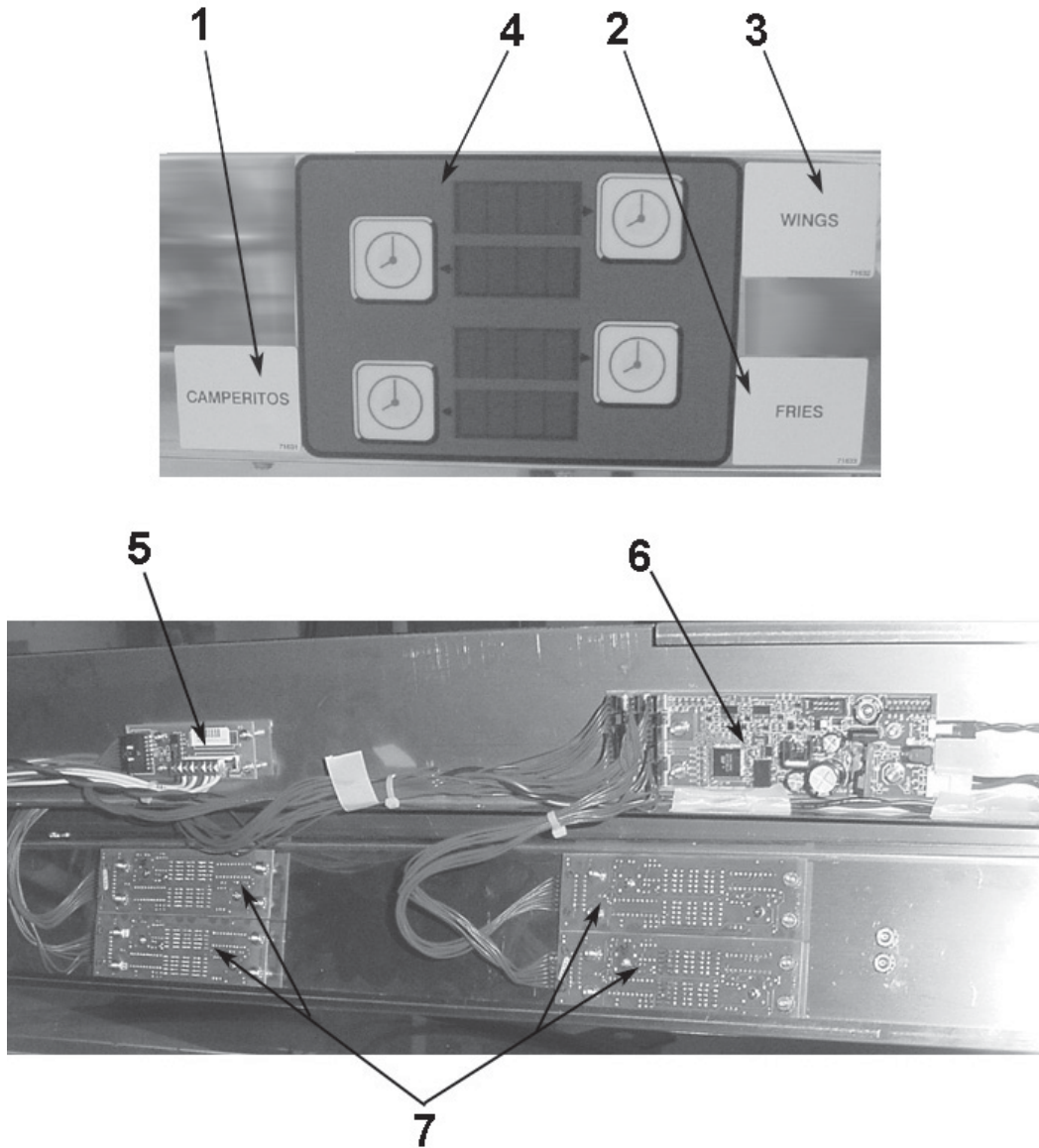

Figure 4-2. Control Parts

Figure & Item No.	Part No.	Description	Quantity
4-2		Control Parts	
✓ 1	71631	Label - Camperitos - Magnet	2
✓ 2	71633	Label - Fries - Magnet	2
✓ 3	71632	Label - Wings - Magnet	2
4	71759	Decal - Campero 4 Button - Blank	2
✓ 5	71620	PCB - 8-Output - 5V Only	1
✓ 6	70866	Control - HDS - CPU - PCB	1
✓ 7	65022	Assy - 2-Timer Touch Switch - Display	4

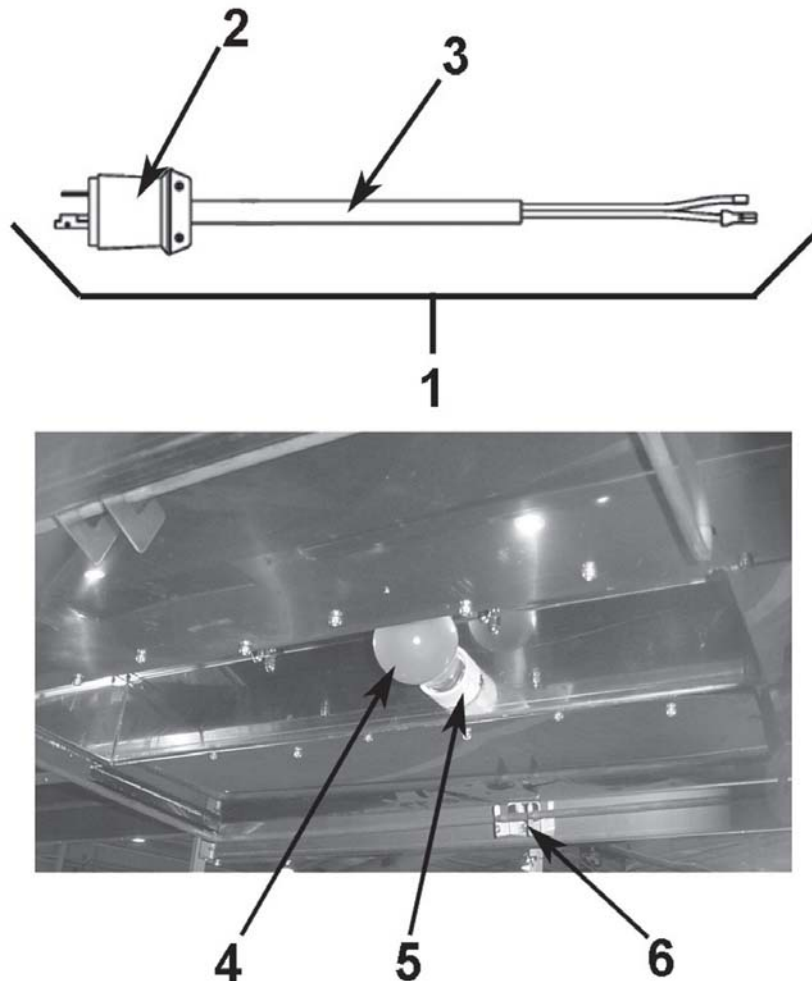

Figure 4-3. Ceiling and Power Cord Parts

Figure & Item No.	Part No.	Description	Quantity
4-3		Ceiling and Power Cord Parts	
1	71002	Assy - 208/240V/15A - Power Cord (Hot Well)	1
2	71020	Plug - Angled - 250V-15A - NEMA - 6-15P	1
3	MS01-175	Cable - #14/3 Black Jacket	1
1	71841-001	Assy - 208/30A/3PH Cord & Plug (103 in. - bottom exit)	1
1	71841-002	Assy - 208/30A/3PH Cord & Plug (127 in. - top exit)	1
2	55802	Plug - 120/208V - 5 Wire 3PH-30A - NEMA-L21-30P	1
3	MS01-440	Cable - #10/3 Black Jacket	1
√ 4	BL01-018	Lamp - 90W-130V - Halogen Dbl. Jacket	5
√ 4	BL01-015	Lamp - 60W-240V - GLS Teflon Coated - CE	5
√ 5	39795	Lamp Holder - Ceramic	5
√ 5	54041	Lamp Holder - Porcelain - CE	5
6	71609	Hanger - Dump Station Heater	3
6	69116	Hanger - Radiant Heater	4

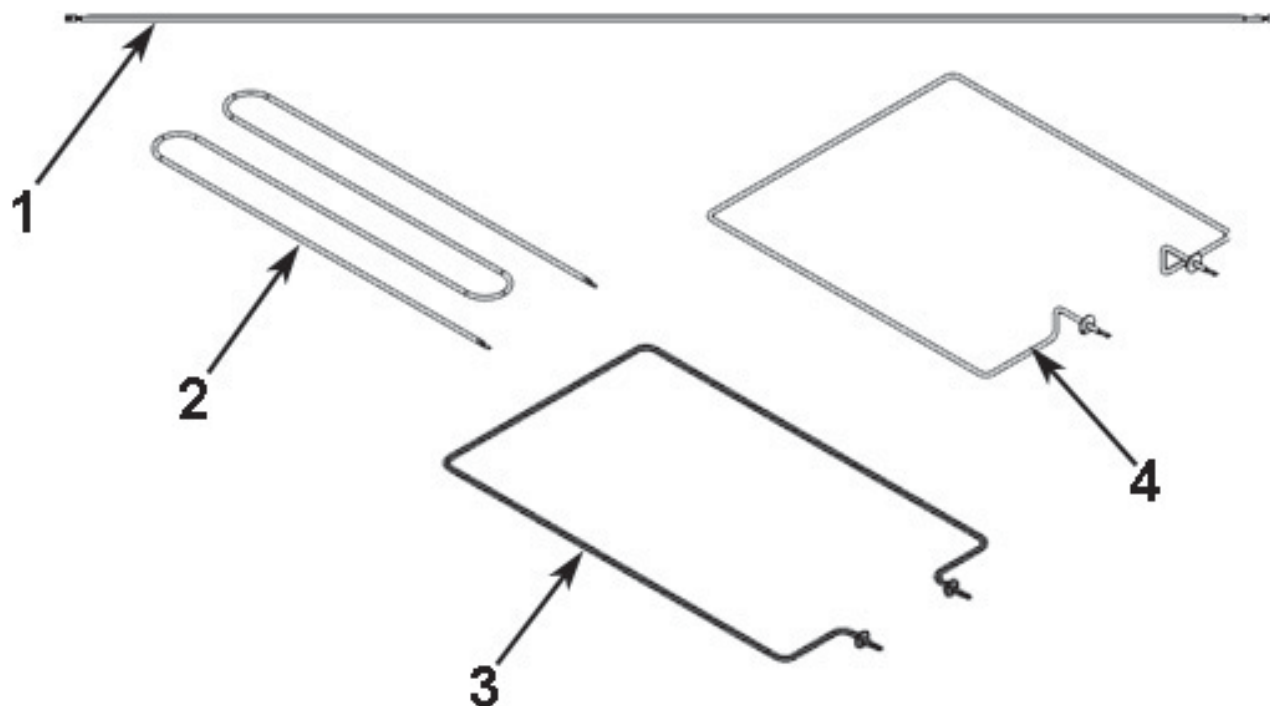

Figure 4-4. Heaters

Figure & Item No.	Part No.	Description	Quantity
4-4		Heaters	
✓ 1	69078-01	Heater - 240V - 2000W - Radiant	1
✓ 1	69078-03	Heater - 240V - 1600W - Radiant	1
✓ 2	69870	Heater - 240V - 1000W - Water Pan	1
✓ 3	69398-01	Heater - 240V - 750W - Shelf	1
✓ 4	69401-01	Heater - 240V - 1600W - FF Dump Station	1

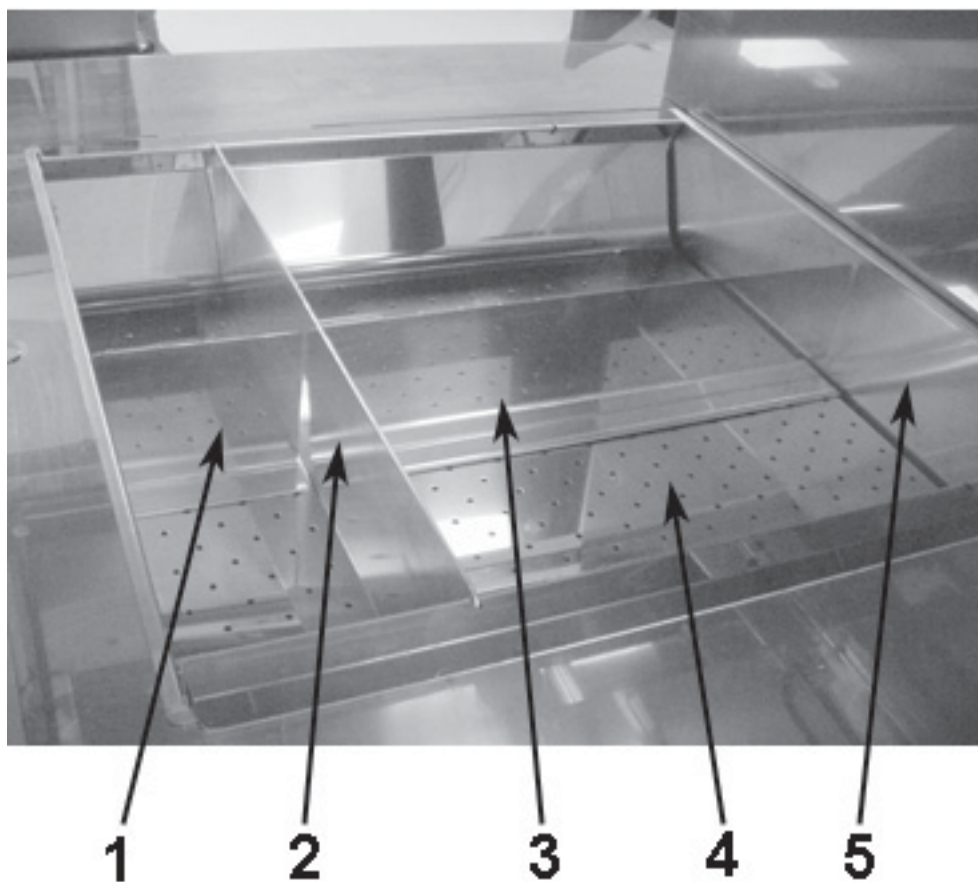

Figure 4-5. French-Fry Dump Tray Parts

Figure & Item No.	Part No.	Description	Quantity
4-5		French-Fry Bin Parts	
✓ 1	71140	Stud Assy - Short Tray Divider	1
✓ 2	69498	Divider - Dump Tray	1
✓ 3	71141	Stud Assy - Long Tray Divider	1
4	69433	Tray - Perforated Dump	1
5	69426	Liner - Dump Tray - Removable	1

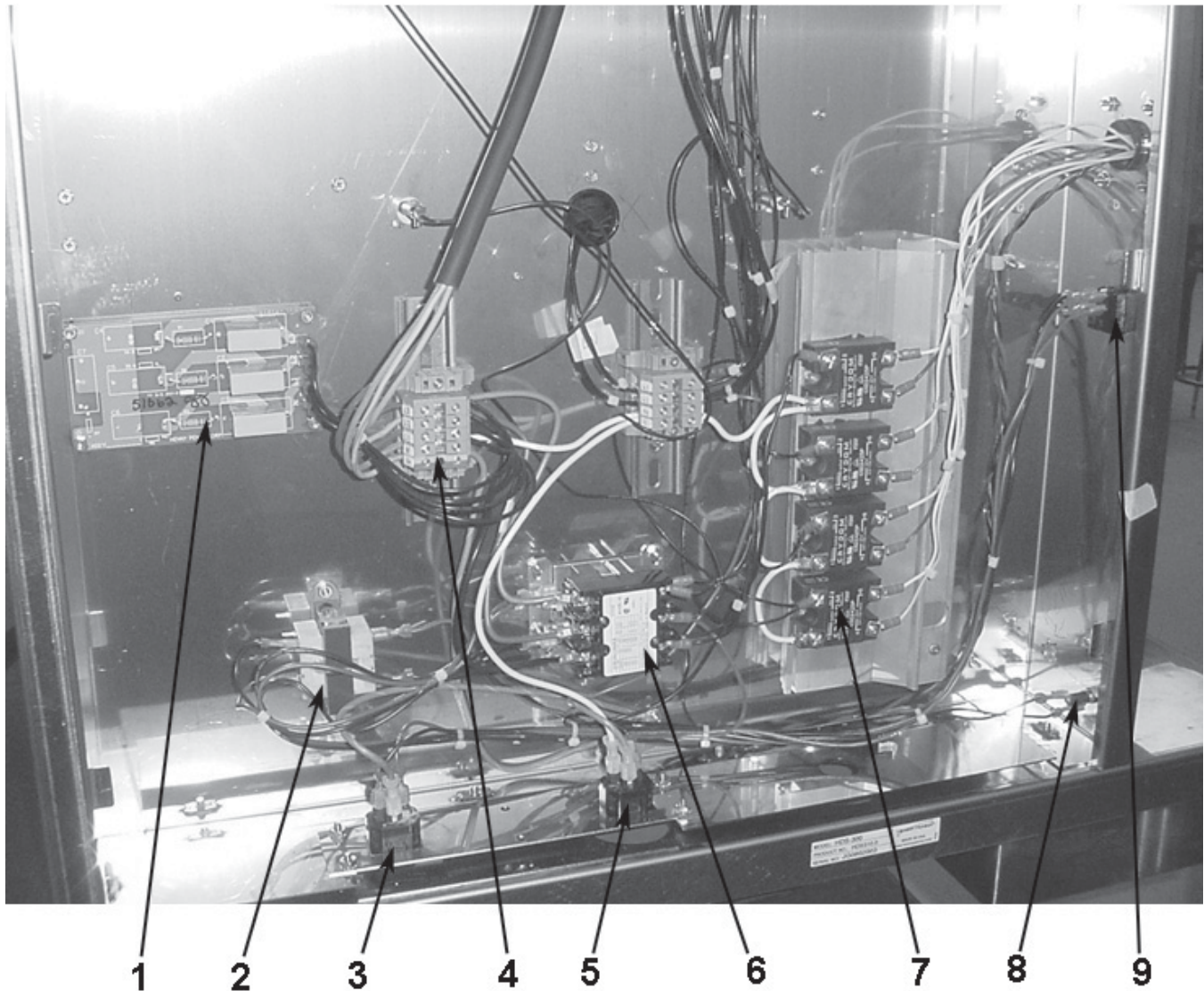

Figure 4-6. Power Supply Components

Figure & Item No.	Part No.	Description	Quantity
4-6		Power Supply Components	
1	51062	Board - EMC Filter - CE	1
✓ 2	28979	Transformer - 208/240VP - 12VS	1
✓ 3	36811	Receptacle - 15A-250V (Hot Well)	1
4	71752	Assy - 4-Pole Terminal Block (non-CE)	1
✓ 5	MS01-197	Receptacle - NEMA 5-15R (Cold Well)	1
✓ 6	19405	Contactor - 208-240VAC Coil	1
✓ 7	40645	Relay - 25A Solid State	4
✓ 8	EF02-104	Fuse - 20 Amp	2
✓ 8	EF02-105	Fuse - 15 Amp	2
✓ 9	72277	Switch - Power DPST 125-250V	1

✓ recommended parts

