

RAISED GRIDDLE

IMPERIAL 2000

BROILER

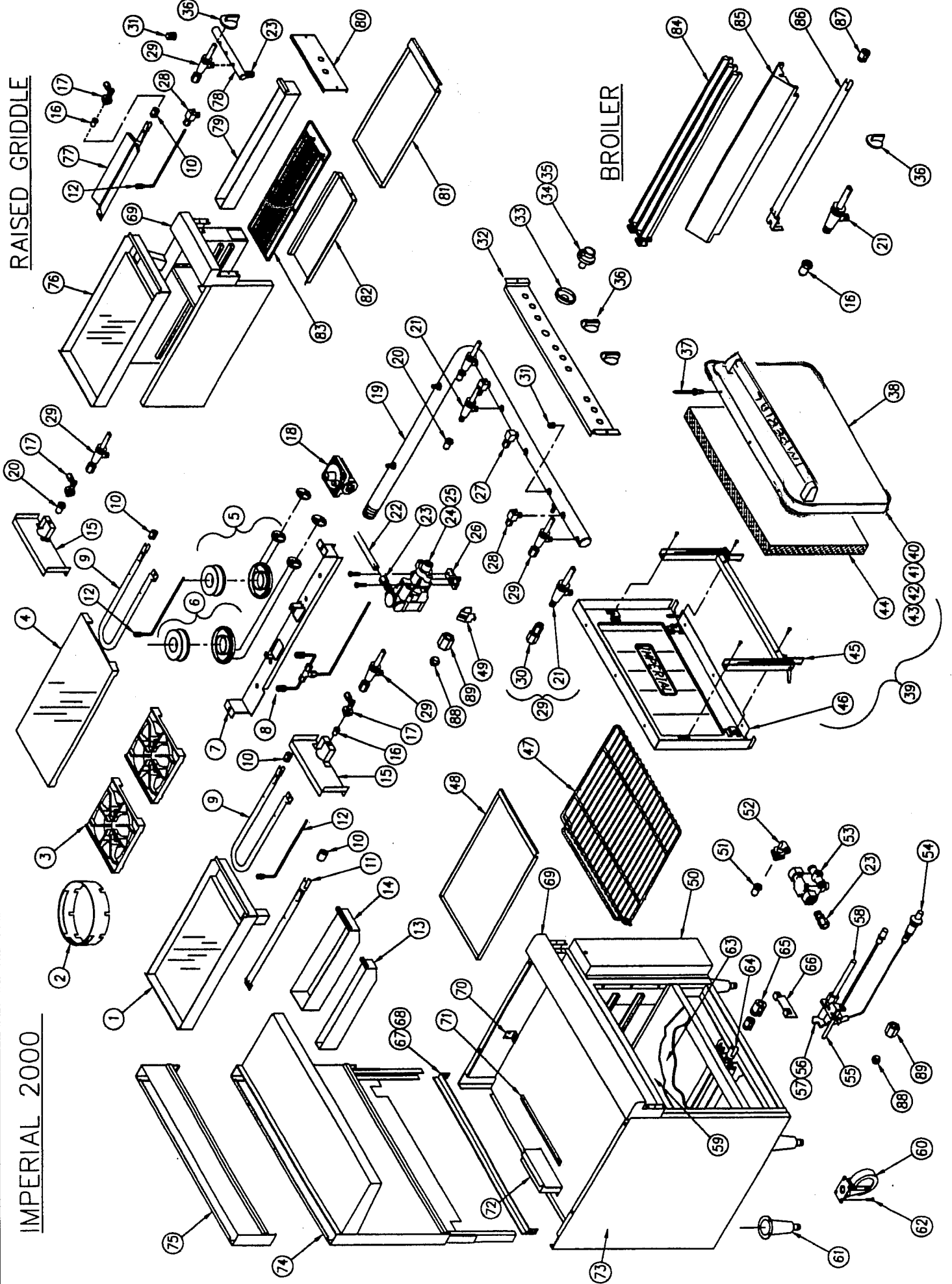

## IR 2000 Series Medium Duty Range w/Standard Oven

ITEM NO	DESCRIPTION	PART #	24"	36"	48"	60"	72"
1	Griddle Plate Assembly 12"	20006	1	1	1	1	1
	Griddle Plate Assembly 24"	20007	1	1	1	1	1
	Griddle Plate Assembly 36"	20008		1	1	1	1
	Griddle Plate Assembly 48"	20009			1	1	1
	Griddle Plate Assembly 60"	20010				1	1
	Griddle Plate Assembly 72"	20011					1
2	Wok Ring	21065	Optional	Optional	Optional	Optional	Optional
3	Top Grate IR 2000 12" X 12"	1233	4	6	8	10	12
***	"S" Grate 6" X 24" Top Grate	33502	2	3	4	5	6
4	Hot Top Polished 12" x 24"	5009	2	3	4	5	6
5	Open Burner Front Venturi	1231	2	3	4	5	6
	Anti Clogging Burner Head	2119	4	6	8	10	12
	Wok Jet Burner Head	1230-J	4	6	8	10	12
	Saute Burner Head	1230-S	4	6	8	10	12
	Open Burner Air Shutter / Mixer Only	1007	4	6	8	10	12
6	Open Burner Rear Venturi	1232	2	3	4	5	6
	Anti Clogging Burner Head	2119	4	6	8	10	12
	Wok Jet burner Head	1230-J	4	6	8	10	12
	Saute Burner Head	1230-S	4	6	8	10	12
	Open Burner Air Shutter / Mixer Only	1007	4	6	8	10	12
7**	Burner Support Bracket	2682	2	3	4	5	6
8	Pilot Burner Complete Assembly	2683	2	3	4	5	6
	Pilot Burner Assembly (5in.)	2684	2	3	4	5	6
***	Pilot Burner Assembly Complete (Open Top Elite)	20001	2	3	4	5	6
***	Pilot Burner Assembly (7in.)	10000-7	2	3	4	5	6
	Tee (Brass) 3/16"	3097	2	3	4	5	6
	Inlet Tubing	2100-14	2	3	4	5	6
9	Griddle Or Hot Top Burner ("U" Shape)	1032	2	3	4	5	6
10	Air Shutter (Used W / Part 1032)	1024	2	3	4	5	6
11	Griddle Burner ("I" Shape) W / Air Shutter	1033	1	2	3	4	5
12	Griddle Or Hot Top Pilot Burner Assembly	20020	2	3	4	5	6
13	Wide Grease Can IR 2000 2"	21095	1	1	1	1	1
14	Wide Grease Can IR 2000 (22 x 3-1/2 x 2-3/4)	31721	1	1	1	1	1
14A	Grease Can Shield	33567	1	1	1	1	1
15	Griddle Front Baffle 12"	20031	1	1	1	1	1
	Griddle Front Baffle 24"	20032	1	1	1	1	1
	Griddle Front Baffle 36"	20033		1	1	1	1
	Griddle Front Baffle 48"	20034			1	1	1
	Griddle Front Baffle 60"	20035				1	1
	Griddle Front Baffle 72"	20036					1
16	Griddle Or RG. / Broiler Orifice NAT.	2065	2	3	4	5	6
	Griddle Or RG. / Broiler Orifice L.P.	2068-1	2	3	4	5	6
17	Orifice 90 Elbow - Brass (With Out Orifice)	37188	2	3	4	5	6
18	Gas Pressure Regulator 3/4" NAT.	1050	1	1	1	1	1
	Gas Pressure Regulator 3/4" L.P.	1051	1	1	1	1	1
19	Manifold Pipe - <b>CALL FACTORY FOR MORE INFO</b>		1	1	1	1	1
20	Open Burner Orifice NAT.	2059	4	6	8	10	12
	Open Burner Orifice L.P.	2076	4	6	8	10	12
	Hot Top Orifice NAT.	2063	2	3	4	5	6
	Hot Top Orifice L.P.	2068	2	3	4	5	6
21	Open Burner Valve (With Out Orifice)	1610	4	6	8	10	12
22	Stainless Steel Flex Tubing 3/16"	37001-58	1	1	1 or 2	1 or 2	1 or 2
23	Straight Fitting - Brass	30293	2	2	2	4	4
24	Oven Thermostat	1150	1	1	1	2	2
	Griddle Thermostat	1100	1	2	2	3	3
****	New Griddle Thermostat	36015					
26	Thermostat Saddle Mount	1104	1	1 or 2	1 or 2	2 or 3	2 or 3
27	Elbow 90 Degree Fitting For Oven Pilot	30278	1	1	1	2	2
28	Adjustable Single Pilot Valve	1604	1	1	1	2	2
****	Adjustable Double Pilot Valve	1003					
29	Griddle Or RG / Broiler Valve W/O Adapter	1610	2	3	4	5	6
30	Adapter Used With PN # 1610	30286	2	3	4	5	6
31	Plug 1/8"	30257	1 or 2	1 or 2	1 or 2	1 or 2	1 or 2
32	Valve Cover - S/S		1	1	1	1	1
33	Thermostat Bezel - Chrome	1103	1	1	1	2	2

## IR 2000 Series Medium Duty Range w/Standard Oven

ITEM NO	DESCRIPTION	PART #	24"	36"	48"	60"	72"
34	Oven Thermostat Knob	1151	1	1	1	2	2
35	Griddle Thermostat Knob	1101	1	2	2	3	3
36	Burner Knob - W / Logo Chrome Blue	36330	4	6	8	10	12
37	Door Rivets S/S	1070-SK	8	8	8	8 or 16	8 or 16
38	Kick Plate S/S Pivot Style 20" Oven	20142	1		2		
	Kick Plate S/S Pivot Style 26-1/2" Oven	20143		1	1	2	2
	Kick Plate Bracket	20144	1	1	1	8 or 16	2
39	Door Complete Assembly 20" Oven	2685	1		2		
	Door Complete Assembly 26-1/2" Oven	2688		1	1	2	2
<b>ASSEMBLY CONSISTS OF NEXT 7 ITEMS</b>							
40	Door Cover S/S 20" Oven	2687	1		2		
	Door Cover S/S 26-1/2" Oven	2689		1	1	2	2
41	Oven Door Handle S/S 20" Oven	36099	1		2		
	Oven Door Handle S/S 26-1/2" Oven	36100		1	1	2	2
42	Oven Handle Right Side	36101	2	2	8 or 16	4	4
42A	Oven Handle Left Side	36102	2	2	1 or 2	4	4
43	Imperial Logo	35840	1	1	1 or 2	2	2
	Name Plate Speed Nut	36569	2	2	1 or 2	2	2
44	Door Insulation 20" Oven	20154	1		2		
	Door Insulation 26-1/2" Oven	8040-1		1	1	2	2
45	Door Closing Mechanism 20" Oven	20160	1		2		
	Door Closing Mechanism 26-1/2" Oven	20161			1	2	2
46	Door Liner (20" Oven) - Porcelainized	9030	1		2		
	Door Liner 26-1/2" Oven - Porcelainized	2128		1	1	1	1
47	Oven Rack 20" Oven	2120	1		2		
	Oven Rack 26-1/2" Oven	2130		1	1	2	2
48	Crumb Tray 12"	20002	1	1	1	1	1
	Crumb Tray 24"	20003	1		2		
	Crumb Tray 24" (New Style 4/06)	34683-1	1		2		
	Crumb Tray 36"	20004		1			2
	Crumb Tray 36" (New Style 4/06)	34683-2		1			2
49	Thermostat Bulb Clip	3038	1	1	1 or 2	2	2
50	Right Side Front Panel S/S	20110		1			1
	Left Side Front Panel S/S	20111					1
51	Oven Orifice NAT. 26-1/2"	2061		1	1	2	2
	Oven Orifice L.P. 26-1/2"	2065		1	1	2	2
	Oven Orifice NAT. 20"	2074	1		2		
	Oven Orifice L.P. 20"	2076	1		2		
52	Oven Orifice 90 Degree Elbow Fitting Only	1615	1	1	1	2	2
***	90 Deg.Brass Elbow	30118	1	1	1 or 2	2	2
53	Oven Safety Valve	1110	1	1	1	2	2
	Inverted Flare Nut	30281	2	2	1 or 2	4	4
	Ferrel	30280	2	2	2 or 4	4	4
***	Oven Safety Valve - BASO	1110-1	1	1	1 or 2	2	2
54	Manual Spark Igniter	1075	1	1	1 or 2	2	2
55	Oven Thermocouple 12" Long	1121	1	1	1 or 2	2	2
***	12" Inch Thermocouple - BASO	1121-1	1	1	1 or 2	2	2
56	Oven Pilot Burner W / Ignition Wire Attach - NAT.	1120	1	1	1 or 2	2	2
	Oven Pilot Burner W / Ignition Wire Attach - L.P.	1120 & 1018	1	1	1 or 2	2	2
***	Oven Pilot Burner W / Out Wire Attach - NAT.	1120-1	1	1	1 or 2	2	2
***	Oven Pilot Burner W / Out Wire Attach - L.P.	1291	1	1	1 or 2	2	2
***	3/8" x 3/8" Mip. St. Fitting W / Nut & Sleeve	2995	1	1	1 or 2	2	2
***	3/8" Compression Nut For All	30266	1	1	1 or 2	2	2
***	3/8" Ferrel For All	30272	1	1	1 or 2	2	2
***	1/4" Inverted Brass Flare Nut	30271	2	2	2 or 4	2	2
	Ferrel (Oversized) 3/16"	30319	1	1	1 or 2	2	2
	Compression Fitting (Nut) 3/16"	30262	1	1	1 or 2	2	2
57	Oven Pilot Orifice - NAT. #18	1017	1	1	1 or 2	2	2
	Oven Pilot Orifice - L.P. #10	1018	1	1	1 or 2	2	2
58	Stainless Steel Flex Tubing 3/16"	37001-58	1	1	1 or 2	1 or 2	1 or 2
***	Stainless Steel Flex Tubing 1/4"	34681-60	1	1	1 or 2	1 or 2	1 or 2
59	Oven Bottom 20" Oven - Porcelainized	20268	1		2		
	Oven Bottom 26-1/2" - Porcelainized	9047		1	1	2	2
60	Caster - 6" With Swivel Plate	1060	2	2	2	2	3
60	Caster With Brake - 6" With Swivel Plate	1061	2	2	2	2	3

## IR 2000 Series Medium Duty Range w/Standard Oven

ITEM NO	DESCRIPTION	PART #	24"	36"	48"	60"	72"	
61	Leg With Adjustable Foot 6"	30555	4	4	4	4	6	
62	Screw 14" X 3/4" (4 Per Caster)	30358	12 or 16	12 or 16	12 or 16	12 or 16	18 or 24	
63	Oven Flame Spreader 26 1/2" Oven	20235		1	1	2	2	
***	Oven Flame Spreader 26 1/2" Oven (New Style)	31584		1	1	2	2	
***	Oven Flame Spreader 20" Oven	31583	1		2			
64	Oven Burner W / Air Shutter	2099	1	1	1	2	2	
***	Burner Compartment Baffle							
65	Air Shutter - For Oven Burner	1037	1	1	1	2	2	
66	Safety Valve Bracket	20021	1	1	1	2	2	
67	Rear Angle Support 24"	20680	1	1	1	1	1	
	Rear Angle Support 36"	20681		1	1	1	1	
	Rear Angle Support 48"	20682			1	1	1	
	Rear Angle Support 60"	20683				1	1	
	Rear Angle Support 72"	20684					1	
	Rear Angle Support RG. Only 23"	20690	1	1	1	1	1	
	Rear Angle Support RG. Only 35"	20691		1	1	1	1	
	Rear Angle Support RG. Only 47"	20692			1	1	1	
68	Front Angle Support 24"	20685	1	1	1	1	1	
	Front Angle Support 36"	20686		1	1	1	1	
	Front Angle Support 48"	20687			1	1	1	
	Front Angle Support 60"	20688				1	1	
	Front Angle Support 72"	20689					1	
	Front Angle Support RG. Only 23"	20660	1	1	1	1	1	
	Front Angle Support RG. Only 35"	20661		1	1	1	1	
	Front Angle Support RG. Only 47"	20662			1	1	1	
69	Landing Ledge 12"	21168	1	1	1	1	1	
	Landing Ledge 24"	21160	1	1	1	1	1	
	Landing Ledge 36"	21161		1	1	1	1	
	Landing Ledge 48"	21162			1	1	1	
	Landing Ledge 60"	21163				1	1	
	Landing Ledge 72"	21164					1	
	Landing Ledge RG. Only 25"	21165	1	1	1	1	1	
	Landing Ledge RG. Only 37"	21166		1	1	1	1	
	Landing Ledge RG. Only 49"	21167			1	1	1	
***	Note, Landing Ledge after 3/10/03 different							
70	Manifold Bracket	20020	1	1	1	1	1	
71	Crumb Tray Back Stop	21120	1	1	2	2	2	
72	Flue Box	21125	1	1	1	2	2	
73	Side Panel	21140	2	2	2	2	2	
	Side Panel For RG. Left Or Right	21141	1	1	1	1	1	
***	IR Side Panel Left Hand	31617	1	1	1	1	1	
***	IR Side Panel Right Hand	31618	1	1	1	1	1	
74	Backguard Assembly 24"	21200	1					
	Backguard Assembly 36"	21201		1				
	Backguard Assembly 48"	21202			1			
	Backguard Assembly 60"	21203				1	1	
	Backguard Assembly 72"	21204					1	
	<b>ASSEMBLY CONSISTS OF NEXT 4 ITEMS</b>							
	Shelf S/S 24"	21190	1					
	Shelf S/S 36"	21191		1				
	Shelf S/S 48"	21192			1			
	Shelf S/S 60"	21193				1		
	Shelf S/S 72"	21194					1	
	Backguard 24"	21100	1					
	Backguard 36"	21101		1				
	Backguard 48"	21102			1			
	Backguard 60"	21103				1		
	Backguard 72"	21104					1	
	Outside Back For Backguard 24"	21195	1					
	Outside Back For Backguard 36"	21196		1				
	Outside Back For Backguard 48"	21197			1			
	Outside Back For Backguard 60"	21198				1		
	Outside Back For Backguard 72"	21199					1	
	Channel Support For Standard Backguard	21130						
<b>REINFORCEMENT CHANNEL TO RANGE MOUNT CHEESEMELTERS OF SALAMANDERS SEE PAGE 11 OR 13</b>								

## IR 2000 Series Medium Duty Range w/Standard Oven

ITEM NO	DESCRIPTION	PART #	24"	36"	48"	60"	72"
75	Stub Back Assembly 24"	21175	1				
	Stub Back Assembly 36"	21176		1			
	Stub Back Assembly 48"	21177			1		
	Stub Back Assembly 60"	21178				1	
	Stub Back Assembly 72"	21179					1
<b>ASSEMBLY CONSIST OF NEXT 2 ITEMS</b>							
	Front Panel 24"	20265	1				
	Front Panel 36"	20266		1			
	Front Panel 48"	20267			1		
	Front Panel 60"	20362				1	
	Front Panel 72"	20363					1
	Outside Back (Galv.) 24"	20991	1				
	Outside Back (Galv.) 36"	20992		1			
	Outside Back (Galv.) 48"	20993			1		
	Outside Back (Galv.) 60"	20994				1	
	Outside Back (Galv.) 72"	20995					1
<b>IR RAISED GRIDDLE/BROILER</b>			<b>24"</b>	<b>36"</b>	<b>48"</b>	<b>60"</b>	<b>72"</b>
76	RG. Assembly 12"	20012	1	1	1	1	1
	RG. Assembly 24"	20013	1	1	1	1	1
77	Burner Assembly W / Air Shutter	20125	1	1	1	1	1
	Wire Mesh For Raised Griddle Burner	20126	1	1	1	1	1
78	Manifold Pipe		1	1	1	1	1
79	Grease Can For Raised Griddle Burner	20042	1	1	1	1	1
80	Valve Cover S/S <b>CALL FACTORY FOR MORE INFO</b>		1	1	1	1	1
81	Crumb Tray For Raised Griddle Broiler 12"	20017	1	1	1	1	1
	Crumb Tray, Raised Griddle Broiler, 19 1/4 X 22 3/8	20018	1	1	1	1	1
82	Drip Pan For RG. Broiler 12"	20014	1	1	1	1	1
	Drip Pan For RG. Broiler 24"	20015	1	1	1	1	1
83	Rack For RG. Broiler 12"	2024	1	1	1	1	1
	Rack For RG. Broiler 24"	2025	1	1	1	1	1
<b>IR RADIANT BROILER</b>							
****	Rack Guide	30922	4	4	4-Jan	4	4
84	Top Grate, 3 Bar, 3" X 21"	1201	7	11	15	19	23
	<b>Top Grate Opt. For Fish, 4 Bar 3" X 21"</b>	1203	7	11	15	19	23
85	Burner Radiant - Cast Iron	5025	4	6	8	10	12
	Burner Radiant - S/S	1302	4	4 or 6	4 or 6	4 or 6	4 or 6
86	Burner W / Air Shutter - S/S	1020	4	6	8	10	12
87	Air Shutter	1024	4	6	8	10	12
88	Compression Fitting (Nut) 3/16"	30277	4	6	8	10	12
	Ferrel 3/16"	30280	8	12	16	20	24
89	Compression Fitting (Nut) 3/8"	30266	4	6	8	10	12
	Ferrel 3/8"	30272	8	12	16	20	24
<b>IR RADIANT BROILER</b>							
90	Liner 24"	11400	1	1	1	1	1
	Liner 36"	11402	1	1	1	1	1
91	Burner Orifice - Brass - NAT.	2065	4	4 or 6	4 or 6	4 or 6	4 or 6
	Burner Orifice - Brass - L.P.	2068-1	4	4 or 6	4 or 6	4 or 6	4 or 6
92	Burner Gas Valve - Brass	1610	4	4 or 6	4 or 6	4 or 6	4 or 6
93	Adjustable Double Pilot Valve - Brass	1003					
94	Burner Knob - Chrome	36330	4	1 or 2	1 or 2	1 or 2	1 or 2
95	Crumb Tray 24"	11412	1	1	1	1	1
	Crumb Tray 36"	11414	1	1	1	1	1
96	Pilot Burner Assembly	10000-14	4	1 or 2	1 or 2	1 or 2	1 or 2
	Pilot Burner Assembly - S/S	10000-14S	4	1 or 2	1 or 2	1 or 2	1 or 2