

IR, IHR SERIES RANGE
WITH CONVECTION OVEN BASE

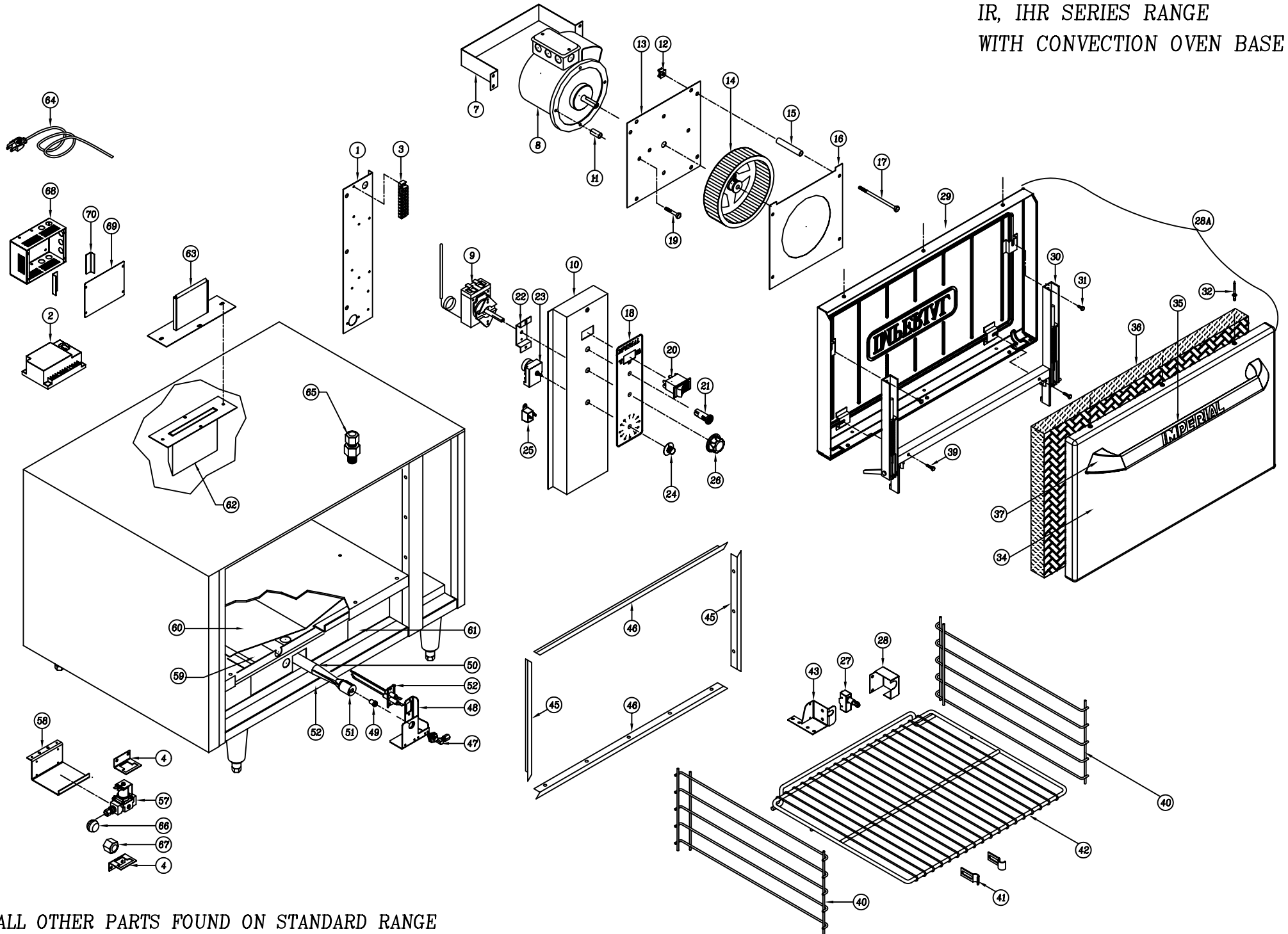

ALL OTHER PARTS FOUND ON STANDARD RANGE

IR/IHR-Diamond Series Ranges with Convection Oven Base

ITEM NO	DESCRIPTION	PART #	36"	48"	60"	72"
1	Control Bracket	20270	1	1	2	2
2	Ignition Control Module	35682	1	1	2	2
**	Ignition cable (part # comes with 4 cables)	35771	1	1	2	2
3	Terminal Block	1136	1			2
4	Solenoid Bracket	20271	2	2	4	4
5	Straight Fitting	2995	2	2	4	4
7	Motor Guard	35341	1	1	2	2
8	Motor 115V	1165-115	1	1	2	2
	Motor 220V	1165-220	1	1	2	2
9	Thermostat	1160	1	1	2	2
10	Control Panel - (R/H) Side	20290	1	1	2	2
	Control Panel - (L/H) Side	20291	1	1	2	2
11	Spacer 1/2"	30396	4	4	8	8
12	Self Retaining Nut	30378	4	4	8	8
13	Motor Mounting Plate Assembly	20273	1	1	2	2
14	Squirrel Cage	1166	1	1	2	2
15	Spacer 3"	30397	4	4	8	8
16	Squirrel Cage Cover	20274	1	1	2	2
17	Bolt 5"	30342	4	4	8	8
18	Control Decal	34623	1	1	2	2
19	Bolt 1-3/4"	30318	4	4	8	8
20	Power Switch	1126	1	1	2	2
21	Indicator Light	1124	1	1	2	2
22	Thermostat Bracket	20275	1	1	2	2
23	Timer 115V 60Hz	32209	1	1	2	2
24	Timer Knob	1171	1	1	2	2
25	Buzzer 120 V	33496	1	1	2	2
	Buzzer 220V	33496-230	1	1	2	2
26	Knob for IR Convection Oven	36329	1	1	2	2
	Knob for IHR Convection Oven	36326	1	1	2	2
27	Micro Snap Action Roller Switch	35717	1	1	2	2
28	Door Switch Cover R/H	35639	1	1	2	2
	Door Switch Cover L/H	35640	1	1	2	2
28A	Door Assembly	20285	1	1	2	2
	ASSEMBLY CONSISTS OF NEXT 11 ITEMS					
29	IR Door Liner - Porcelainized	21063	1	1	2	2
	IHR Door Liner	36597	1			
30	Door Closing Mechanism	20161	1	1	2	2
31	Bolt 1/2"	30302	4	4	8	8
32	Door Rivets - S/S (bag of 10)	1070-SK	6	6	12	12
34	IR Door Cover - S/S	20151	1	1	2	2
	IHR Door Cover - S/S	36598	1			
***	Kick Plate	20143	1	1	2	2
35	IR Oven Door Handle - S/S	36100	1	1	2	2
	IHR Oven Door Handle - S/S	36853	1			
	IHR Oven Handle Name Plate	36855	1			
36	Door Insulation	8040-1	1	1	2	2
37	IR Door Handle Bracket (Right Side)	36101	1	1	2	2
	IR Door Handle Bracket (Left Side)	36102	1	1	2	2
	IHR Door Handle Bracket (Right or Left Side)	36854	2			

IR/IHR-Diamond Series Ranges with Convection Oven Base

ITEM NO	DESCRIPTION	PART #	36"	48"	60"	72"
39	Bolt 1-1/2"	30320	4	4	8	8
40	Rack Guide - Chrome Plated	2023	2	2	4	4
41	Rack Guide Clips	30879	4	4	8	8
42	Oven Rack - Chrome Plated	4042-2	3	3	6	6
43	Door Switch Bracket R/H	35637	1	2	4	4
44	Door Switch Bracket L/H	35638	1	2	4	4
45	Side Door Gasket	20071	2	2	4	4
46	Top & Bottom Door Gasket	20070	2	2	4	4
47	90 Orifice Elbow	37188	1	1	2	2
48	IR-C Igniter Bracket	35935	1	1	2	2
	IHR-C Igniter Bracket	36089	1			
49	Oven Orifice - #39 for NAT.	2062	1	1	2	2
	Oven Orifice - #52 for LP	2067	1	1	2	2
50	Oven Burner W/ Air Shutter	1035	1	1	2	2
51	Air Shutter Only - For Oven Burner	1036	1	1	2	2
52	Spark & Sense Electrode	33883	1	1	2	2
56	90 Elbow	30278	1	1	2	2
57	Solenoid Valve 120 VAC 60Hz	1134	1	1	2	2
58	Valve Mounting Bracket	35934	1	1	2	2
59	Aeration Plate / Burner Support	20276	1	1	2	2
60	Flame Spreader	20277	1	1	2	2
61	Baffle Side Cover	20296	1	1	2	2
62	Snorkel Tube	20278	1	1	2	2
63	Flue Assembly	20279	1	1	2	2
64	Electrical Cord	1142	1	1	1	1
65	CC Straight Fitting 1/8" NPT X 3/8"	30870	1	4	2	2
66	Ferrel (Over Size) 3/16"	30319	1	1	2	2
	Ferrel 3/8"	30272	2	2	4	4
67	Compression Nut 3/16"	30277	1	1	2	2
	Compression Nut 3/8"	30266	2	2	4	4
68	Control Module Housing	35931	1	1	2	2
69	Control Module Cover	35932	1	1	2	2
70	Control Module Mounting Bracket	35933	2	2	4	4