

DOMESTIC RANGE

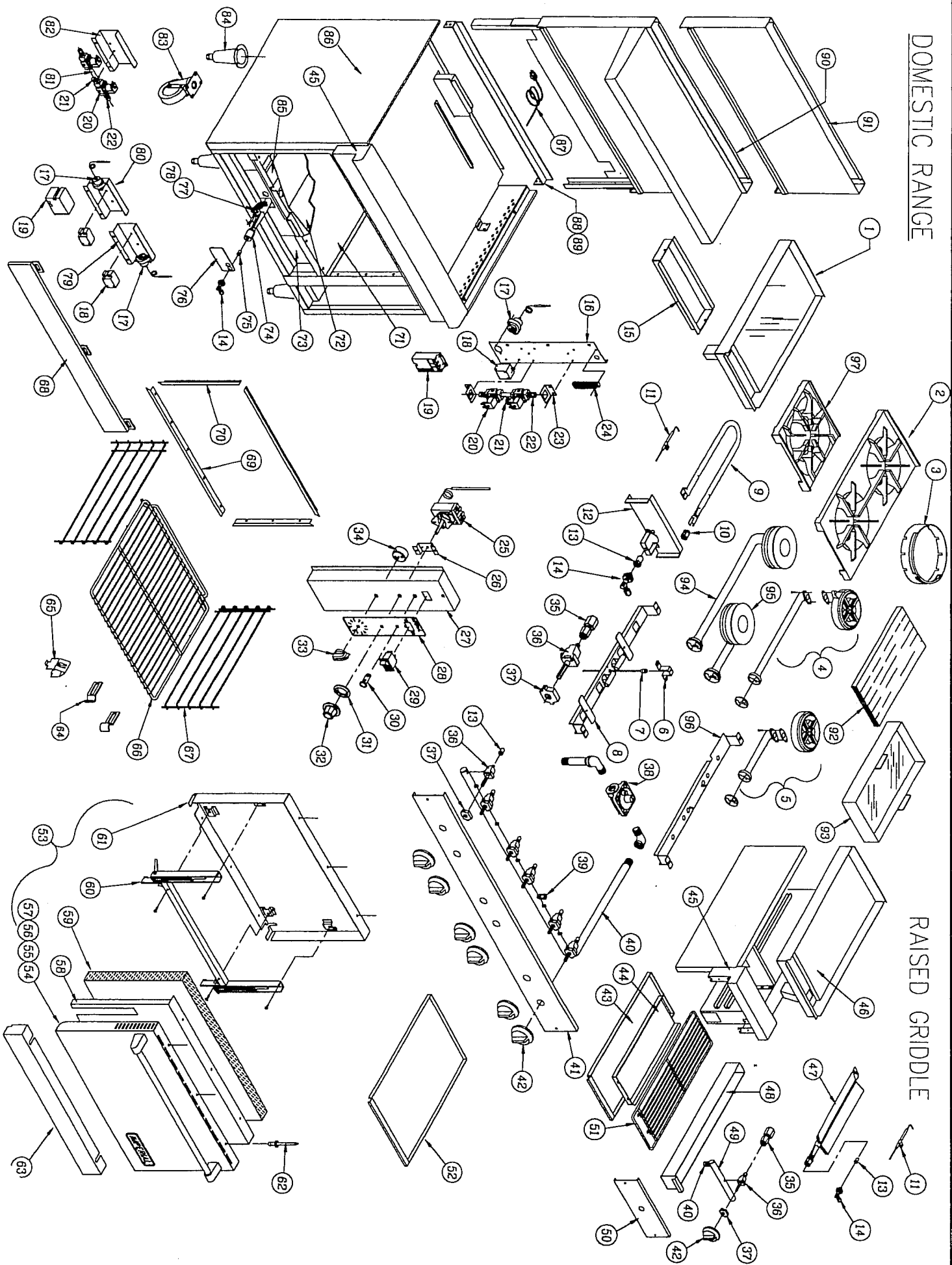

RAISED GRIDDLE

IDR SERIES HOME RANGES

| ITEM NO. | DESCRIPTION | PART # | 37" | 49" | 61" |
|----------|--|---------|------------|------------|-------------|
| 1 | Griddle Plate Assembly 12" | 20006 | 1 | 1 | 1 |
| | Griddle Plate Assembly 24" | 20007 | 1 | 1 | 1 |
| | Griddle Plate Assembly 36" | 20008 | 1 | 1 | 1 |
| 2 | Top Grate 12" x 24" | 1185 | 3 | 4 | 5 |
| 3 | Wok Ring | 23100 | Optional | Optional | Optional |
| 4 | Open Burner - Head Only Rear | 1182 | 3 | 4 | 5 |
| | Open Burner - Gasket | 1006 | 3 | 4 | 5 |
| | Open Burner Rear - Venturi Only 18" Length | 1022 | 3 | 4 | 5 |
| 5 | Open Burner -Head Only Front | 1182 | 3 | 4 | 5 |
| | Open Burner - Gasket | 1006 | 3 | 4 | 5 |
| | Open Burner-Front - Venturi Only 6" Length | 1021 | 3 | 4 | 5 |
| 6 | Ground Strap | 0435 | 3 | 4 | 5 |
| 7 | Open Burner Igniter | 1131 | 3 | 4 | 5 |
| | Open Burner Igniter - New Style IDR | 1531 | 3 | 4 | 5 |
| 8 | Burner Hanger | 23045 | 3 | 4 | 5 |
| 9 | Griddle Burner W / Air Shutter | 2095 | 1 or 2 | 1 or 2 | 1 or 2 |
| 11 | Griddle Igniter | 2089-2 | 1 or 2 | 1 or 2 | 1 or 2 |
| 12 | Griddle Front Baffle 12" | 25031 | 1 | 1 | 1 |
| | Griddle Front Baffle 24" | 25033 | 1 | 1 | 1 |
| | Griddle Front Baffle 36" | 25034 | 1 | 1 | 1 |
| 13 | Open Burner/Griddle Orifice - NAT. | 1700-50 | 6 | 8 | 10 |
| | Open Burner/Griddle Orifice - L.P. | 1700-56 | 6 | 8 | 10 |
| 14 | Orifice 90 Elbow Brass | 1604 | 1 | 1 | 1 or 2 |
| 15 | Grease Can | 23070 | 1 | 1 | 1 |
| 16 | Control Bracket | 20270 | 1 | 1 | 1 or 2 |
| 17 | Flame Switch | 1133 | 1 | 1 | 1 or 2 |
| 18 | 0+1 Spark Module (for oven) | 1140 | 1 | 1 | 1 or 2 |
| 19 | 3+1 Spark Module (for open-top burners) | 1141 | 1 | 1 | 1 |
| 20 | Gas Solenoid Valve | 1134 | 2 | 2 | 2 or 4 |
| 21 | 1/8 NPT x 3/16 CC 90 Elbow | 30278 | 1 | 1 | 1 or 2 |
| 22 | 3/8 NPT x 3/8 CC Straight Fitting | 2995 | 2 | 2 | 2 or 4 |
| 23 | Solenoid Bracket | 20271 | 1 | 1 | 1 or 2 |
| 24 | Terminal Block | 0541 | 1 | 1 | 1 or 2 |
| 25 | Thermostat | 1160 | 1 | 1 | 1 or 2 |
| 26 | Thermostat Bracket | 20275 | 1 | 1 | 1 or 2 |
| 27 | Control Cover Panel | 20290 | 1 | 1 | 1 or 2 |
| *** | Control Cover Panel L / H | 31988 | | | 1 or 2 |
| *** | Control Panel Inner | 31989 | 1 | 1 | 1 or 2 |
| 28 | Control Decal | 34624 | 1 | 1 | 1 or 2 |
| 29 | Power Switch | 1126 | 1 | 1 | 1 or 2 |
| 30 | Burner "ON" Light | 1124 | 1 | 1 | 1 or 2 |
| 31 | Thermostat Bezel | 1162 | 1 | 1 | 1 or 2 |
| 32 | Thermostat Knob | 1161 | 1 | 1 | 1 or 2 |
| 33 | Timer W/ Knob | 1170 | 1 | 1 | 1 or 2 |
| 34 | Timer Knob | 1171 | 1 | 1 | 1 or 2 |
| *** | Electric Timer | 32209 | 1 | 1 | 1 or 2 |
| 35 | Adapter | 30286 | 1 or 2 | 1 or 2 | 1 or 2 |
| 36 | Gas Valve | 1111 | 4 , 5 or 6 | 6 , 7 or 8 | 8 , 9 or 10 |
| 37 | Igniter Switch Open Burner | 1115 | 4 , 5 or 6 | 6 , 7 or 8 | 8 , 9 or 10 |
| | Igniter Switch Griddle - RG | 0410 | 1 or 2 | 1 or 2 | 1 or 2 |
| 38 | Regulator | 0430 | 1 | 1 | 1 |
| 39 | 1/8" NPT x 3/8" CC Straight Fitting | 30870 | 1 | 1 | 1 or 2 |
| 40 | Manifold Pipe 37" | 1361 | 1 | | |
| | Manifold Pipe 49" | 0858 | | 1 | |
| | Manifold Pipe 61" | 0859 | | | 1 |

IDR SERIES HOME RANGES

| ITEM NO. | DESCRIPTION | PART # | 37" | 49" | 61" |
|-----------|---|--------------|--------|----------|---------------|
| | Lower Manifold Pipe 4 Open Burner (RG) Models | 0885 | 1 | | |
| | Lower Manifold Pipe 6 Open Burner (RG) Models | 0885 | | 1 | |
| | Lower manifold Pipe 8 Open Burner (RG) Models | 0885 | | | 1 |
| 41 | Valve Cover (S/S) - Call Factory For More Info | | 1 | 1 | 1 |
| 42 | Open Burner Knob - Front | 1112 | 3 | 4 | 5 |
| | Open Burner Knob - Rear | 1113 | 3 | 4 | 5 |
| | Griddle Knob | 1114 | 1 or 2 | 1 or 2 | 1 or 2 |
| 43 | Crumb Tray - For (RG) Broiler 12" | 20017 | 1 | 1 | 1 |
| | Crumb Tray - For Raised Griddle/ Broiler 24" | 20018 | 1 | 1 | 1 |
| 44 | Drain Pan 12" | 20014 | 1 | 1 | 1 |
| | Drain Pan 24" | 20015 | 1 | 1 | 1 |
| 45 | Landing Ledge (S/S) 12" | 20068 | 1 | 1 | 1 |
| | Landing Ledge (S/S) 24" | 20060 | 1 | 1 | 1 |
| | Landing Ledge (S/S) 36" | 20061 | 1 | 1 | 1 |
| | Landing Ledge (S/S) 48" | 20062 | | 1 | 1 |
| | Landing Ledge (S/S) 60" | 20063 | | | 1 |
| | Lower Landing Ledge (RG) Models Only 25" | 20065 | 1 | 1 | 1 |
| | Lower Landing Ledge (RG) Models Only 37" | 20066 | | 1 | 1 |
| | Lower Landing Ledge (RG) Models Only 49" | 20067 | | | 1 |
| 46 | Raised Griddle Assembly 12" | 20012 | 1 | 1 | 1 |
| | Raised Griddle Assembly 24" | 20013 | 1 | 1 | 1 |
| 47 | Raised Griddle Burner Assembly | 20125 | 1 or 2 | 1 or 2 | 1 or 2 |
| 48 | Grease Can For Raised Griddle Broiler | 20042 | 1 | 1 | 1 |
| 49 | Upper Manifold Pipe 12" - RG | 0905-1 | 1 | 1 | 1 |
| | Upper Manifold Pipe 24" - RG | 0905-1 | 1 | 1 | 1 |
| 50 | Raised Griddle Valve Cover 12" | 23090 | 1 | 1 | 1 |
| | Raised Griddle Valve Cover 24" | 23091 | 1 | 1 | 1 |
| 51 | Raised Griddle Broiler Rack 12" | 2024 | 1 | 1 | 1 |
| | Raised Griddle Broiler Rack 24" | 2025 | 1 | 1 | 1 |
| 52 | Drip Pan Used On 37" Unit | 23041 | 1 | | |
| | Drip Pan Used On 49" Unit | 23040 | | 1 | |
| | Drip Pan Used On 61" Unit | 23040 | | | 1 |
| | Drip Pan Used On 61" Unit | 23041 | | | 1 |
| 53 | Door Assembly | 23080 | 1 | 1 | 1 or 2 |
| | Door Assembly with glass | 31998 | | 1 | 1 or 2 |
| 54 | Door Cover - S/S | 23081 | 1 | 1 | 1 or 2 |
| 55 | Door Handle Bracket (L/H) | 36102 | 2 | 2 | 2 or 4 |
| | Door Handle Bracket (R/H) | 36101 | 3 | 3 | 3 or 4 |
| 56 | Oven Door Handle - S/S (OLD) | 4055 | 1 | 1 | 1 or 2 |
| | Oven Door Handle - S/S | 36100 | 2 | 2 | 2 or 2 |
| 57 | Imperial Logo | 35840 | 1 | 1 | 1 or 2 |
| | Name Plate Speed Nut | 36569 | 2 | 2 | 2 or 4 |
| 58 | Insulation Cover | 23082 | 1 | 1 | 1 or 2 |
| 59 | Door Insulation | 8040-1 | 1 | 1 | 1 or 2 |
| 60 | Door Closing Mechanism Assembly | 20161 | 1 | 1 | 1 or 2 |
| 61 | Door Liner - Porcelainized | 20157 | 1 | 1 | 1 or 2 |
| 62 | Door Rivets (Set Of Ten) | 1070-SK | 1 | 1 | 1 or 2 |
| 63 | Kick Plate - S/S | 20141 | 1 | 1 | 1 or 2 |
| | Kick Plate (S/S) - Pivot Style | 20143 | 1 | 1 | 1 or 2 |
| | Kick Plate Bracket - Used Only With PN # 20143 | 20144 | 2 | 2 | 2 or 4 |
| 64 | Rack Guide Clips | 30879 | 4 | 4 | 4 or 8 |
| 65 | Thermostat Bulb Clip | 30347 | 1 | 1 | 1 or 2 |
| 66 | Oven Rack - Chrome Plated | 4042-2 | 2 | 2 | 2 or 4 |
| 67 | Rack Guide - Chrome Plated | 2023 | 2 | 2 | 2 or 4 |
| 68 | Curb Base Kit 37" | 23065 | 1 | | |

IDR SERIES HOME RANGES

| ITEM NO. | DESCRIPTION | PART # | 37" | 49" | 61" |
|----------|---|-------------|----------|----------|----------|
| | Curb Base Kit 49" | 23066 | | 1 | |
| | Curb Base Kit 61" | 23067 | | | 1 |
| 69 | Door Seal Top Bottom - S/S | 20070 | 2 | 2 | 2 or 4 |
| 70 | Door Seal Sides - S/S | 20071 | 2 | 2 | 2 or 4 |
| 71 | Oven Bottom - Porcelain Coated | 23005 | 1 | 1 | 1 or 2 |
| 72 | Oven Flame Spreader | 20135 | 1 | 1 | 1 or 2 |
| 73 | Baffle Side Cover | 20296 | 1 | 1 | 1 or 2 |
| 74 | Oven Burner W / Air Shutter | 1035 | 1 | 1 | 1 or 2 |
| | Air Shutter Only | 1036 | 1 | 1 | 1 or 2 |
| 75 | Oven Orifice - NAT. | 1700-39 | 1 | 1 | 1 or 2 |
| | Oven Orifice - L.P. | 1700-52 | 1 | 1 | 1 or 2 |
| 76 | Orifice Mounting Bracket | 20289 | 1 | 1 | 1 or 2 |
| 77 | Oven Pilot Burner W / Ignition Wire Attached - NAT. | 1120 | 1 | 1 | 1 or 2 |
| | Oven Pilot Burner W / Ignition Wire Attached - L.P. | 1120 & 1018 | 1 | 1 | 1 or 2 |
| 78 | Oven Pilot Orifice - NAT. | 1017 | 1 | 1 | 1 or 2 |
| | Oven Pilot Orifice - L.P. | 1018 | 1 | 1 | 1 or 2 |
| 79 | Spark Module Bracket - Right Side | 20293 | 1 | 1 | 1 |
| 80 | Spark Module Bracket - Left Side | 20294 | | 1 | 1 |
| 81 | Manifold Pipe - Used On 37" Unit | 20280 | 1 | | |
| | Manifold Pipe - Used On 49" And 61" Unit | 20281 | | 1 | 1 |
| 82 | Solenoid Mounting Bracket | 20295 | 1 | 1 | 1 or 2 |
| 83 | Casters | 1060 | 2 | 2 | 2 |
| | Casters W / Self Locking Brakes | 1061 | 2 | 2 | 2 |
| 84 | Legs 6" | 5027 & 1045 | 4 | 4 | 4 |
| | Adjustable Foot Only | 1045 | 4 | 4 | 4 |
| *** | S/S Leg 6" 5/8" Stud W / Nylon Glide | 30555 | 4 | 4 | 4 |
| *** | 14x3/4" Screw (3 Per Leg & 4 Per Caster) | 1900 | 12 or 16 | 12 or 16 | 18 or 24 |
| 85 | Aeration Plate / Burner Support | 20276 | 1 | 1 | 1 or 2 |
| 86 | Left Hand Side Panel - S/S | 23051S | 1 | 1 | 1 |
| | Left Hand (RG) Side - S/S | 23061S | 1 | 1 | 1 |
| | Right Hand Side Panel - S/S | 23050S | 1 | 1 | 1 |
| | Right Hand (RG) Side - S/S | 23060S | 1 | 1 | 1 |
| 87 | Power Cord | 1142 | 1 | 1 | 1 |
| 88 | Rear Angle Support 37" | 20181 | 1 | | |
| | Rear Angle Support 49" | 20182 | | 1 | |
| | Rear Angle Support 61" | 20183 | | | 1 |
| | Rear Angle Support Units W / (RG) Only 23" | 20205 | 1 | | |
| | Rear Angle Support Units W / (RG) Only 35" | 20206 | | 1 | |
| | Rear Angle Support Units W / (RG) Only 47" | 20207 | | | 1 |
| 89 | Front Angle Support 37" | 20186 | 1 | | |
| | Front Angle Support 49" | 20187 | | 1 | |
| | Front Angle Support 61" | 20188 | | | 1 |
| | Front Angle Support Units W / (RG) Only 23" | 21215 | 1 | | |
| | Front Angle Support Units W / (RG) Only 35" | 21216 | | 1 | |
| | Front Angle Support Units W / (RG) Only 47" | 21217 | | | 1 |
| 90 | Backguard Assembly 37" | 23033 | 1 | | |
| | Backguard Assembly 49" | 23034 | | 1 | |
| | Backguard Assembly 61" | 23035 | | | 1 |
| | ***Add "S" For S/S | | | | |
| | ***On RG Models Add "-**" To Part Number # | | | | |
| | Shelf (S/S) 37" | 20191 | 1 | | |
| | Shelf (S/S) 49" | 20192 | | 1 | |
| | Shelf (S/S) 61" | 20193 | | | 1 |
| | Backguard (S/S) 37" | 23052 | 1 | | |
| | Backguard (S/S) 49" | 23053 | | 1 | |

IDR SERIES HOME RANGES

| ITEM NO. | DESCRIPTION | PART # | 37" | 49" | 61" |
|-----------|---|--------|----------|----------|----------|
| | Backguard (S/S) 61" | 23054 | | | 1 |
| | ***Add "S" For S/S | | | | |
| | ***On RG Models Add "-**" To Part Number # | | | | |
| | Outside Back For Backguard 37" | 23055 | 1 | | |
| | Outside Back For Backguard 49" | 23056 | | 1 | |
| | Outside Back For Backguard 61" | 23057 | | | 1 |
| | Channel Support For Standard Backguard | 20030 | 1 | 1 | 1 |
| 91 | Backguard Assembly 11" High (S/S) 37" | 23030 | 1 | | |
| | Backguard Assembly 11" High (S/S) 49" | 23031 | | 1 | |
| | Backguard Assembly 11" High (S/S) 61" | 23032 | | | 1 |
| | ***On RG Models Add "-**" To Part Number # | | | | |
| | Backguard 11" High 37" | 23036 | 1 | | |
| | Backguard 11" High 49" | 23037 | | 1 | |
| | Backguard 11" High 61" | 23038 | | | 1 |
| | ***On RG Models Add "-**" To Part Number # | | | | |
| | Outside Back For Backguard 11" High 37" | 23042 | 1 | | |
| | Outside Back For Backguard 11" High 49" | 23043 | | 1 | |
| | Outside Back For Backguard 11" High 61" | 23044 | | | 1 |
| 92 | Cutting Board | 1500 | Optional | Optional | Optional |
| 93 | Add A Griddle 12" Wide | 23075 | 1 | 1 | 1 |
| 94 | Rear Open Burner Complete Assembly - Porcelainized | 0450 | 3 | 4 | 5 |
| | Open Burner Head Only - Porcelainized | 1182 | 3 | 4 | 5 |
| 95 | Front Open Burner (Complete Assembly) - Porcelainized | 0445 | 3 | 4 | 5 |
| | Open Burner Head Only - Porcelainized | 1182 | 3 | 4 | 5 |
| 96 | Burner Hanger | 20469 | 3 | 4 | 5 |
| 97 | Top Grate New Style IDR 12" X 12" | 2121 | 6 | 8 | 10 |