

(14176 AS101 - 1 = 120 Volt / 1/2-2 H.P. / 1 phase)
(14176A AS101 - 2 = 208-240 Volt / 1/2-2 H.P. / 1 phase)

(14176B AS101 - 3 = 208-240 Volt / 1/2-10 H.P. / 3 phase)
(14176C AS101 - 4 = 380-460 Volt / 1/2-10 H.P. / 3 phase)

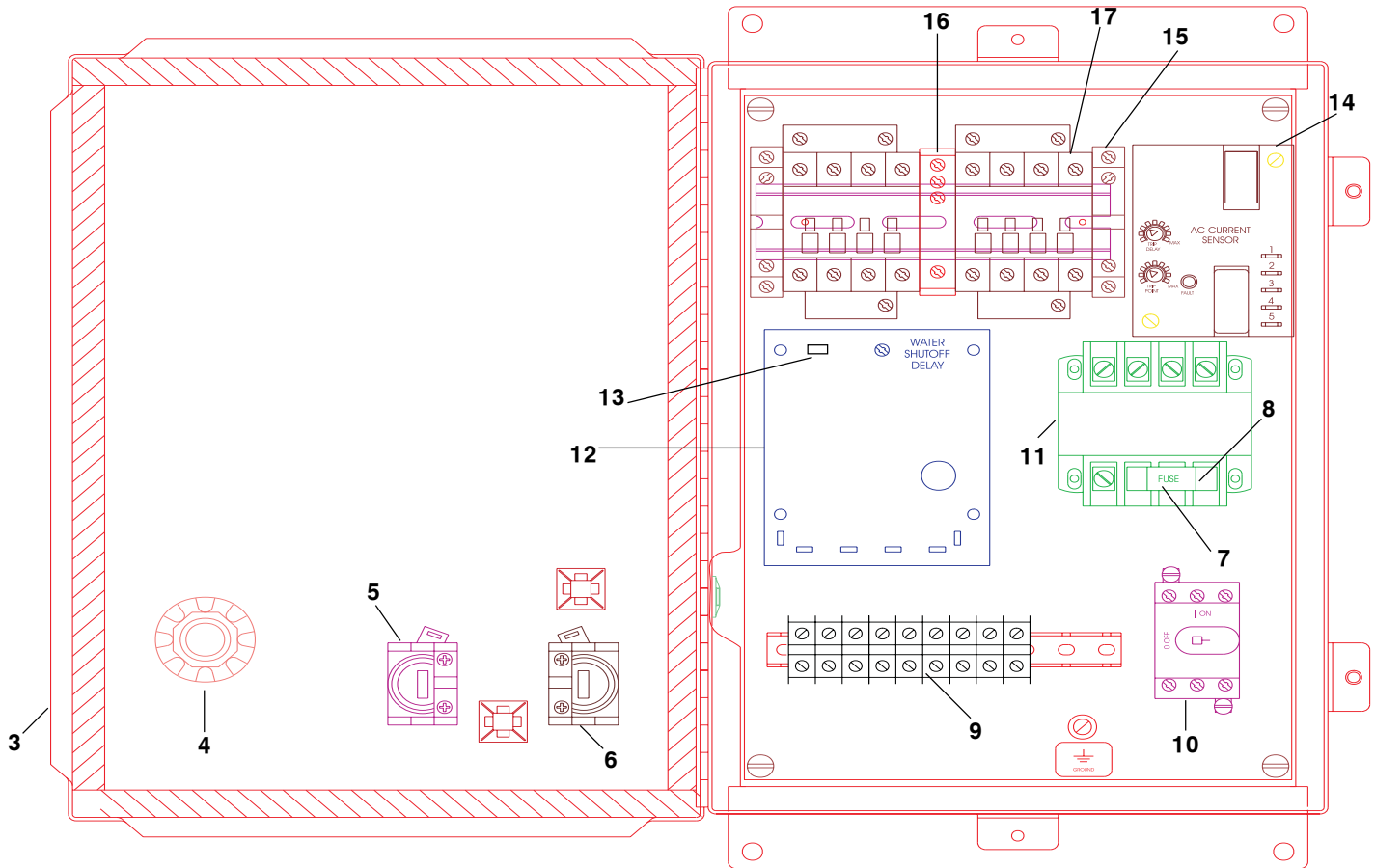

See Back Sheet For General Information

ORDER BY PART NUMBER, NOT CODE NUMBER

CODE NO.	PART NO.	NO. REQ.	DESCRIPTION	CODE NO.	PART NO.	NO. REQ.	DESCRIPTION
1	13236-B	2	Solenoid Valve - 24 V Coil (Not Shown)	11	14185	1	Transformer - 3 phase (Secondary voltage - 24) (208V-460V)
2	13763	1	Flow Control Valve (1GPM-all units) (Not Shown)		14161	1	Transformer - 1 phase (Secondary voltage - 24 volts) (120V - 240V)
	13763-B	1	Flow Control Valve(1/2 - 1 1/4HP- 5GPM) (Not Shown)	12	14168	1	Circuit board, printed
	13763-D	1	Flow Control Valve (1-1/2 - 2HP - 8GPM) (Not Shown)	13	13498	1	Auto/Manual jumper
	13763-E	1	Flow Control Valve (3 - 10HP - 10 GPM) (Not Shown)	14	13930	1	Sensor, Current
3	N/A	1	Stainless Steel Enclosure	15	14163	2	Auxiliary contact block (used on 1PH units ONLY)
4	14164	1	Door Disconnect Knob	16	14169	1	Mechanical Interlock
5	14158	1	Pushbutton-Stop (N.C. Red)	17	14160	1	Reversing Contactor-(3 PH)
6	14159	1	Pushbutton-Start (N.O.Black)		14162	1	Reversing Contactor-(1 PH) (Includes code 6)
7	13466	1	Fuse (2 amp-125 volts) (FNA-2 or FNM-2)		13625	4	Tamper Proof Screws (Not Shown)
8	14165	2	Fuse Holder		13935	4	Top Cover Retainer (Not Shown)
9	14166	4	Terminal block - 3 phase		13942	4	Screws (Not Shown)
10	14167	4	Terminal block - 1 phase				



Aqua Saver / Control Center
MODEL NO. AS101J

13941 Series

Start Date:
 04-96
 Engineer Number:
 13941

- (13491 AS101J-1 = 120 Volt / 1/2-2 H.P. / 1 phase)
- (13491-A AS101J-2 = 208-240 Volt / 1/2-2 H.P. / 1 phase)
- (13491-B AS101J-3 = 208-240 Volt / 1/2-5 H.P. / 3 phase)
- (13491-C AS101J-4 = 380-460 Volt / 1/2-5 H.P. / 3 phase)
- (13491-D AS101J-5 = 208-240 Volt / 7-1/2-10 H.P. / 3 phase)
- (13491-E AS101J-6 = 380-460 Volt / 7-1/2-10 H.P. / 3 phase)

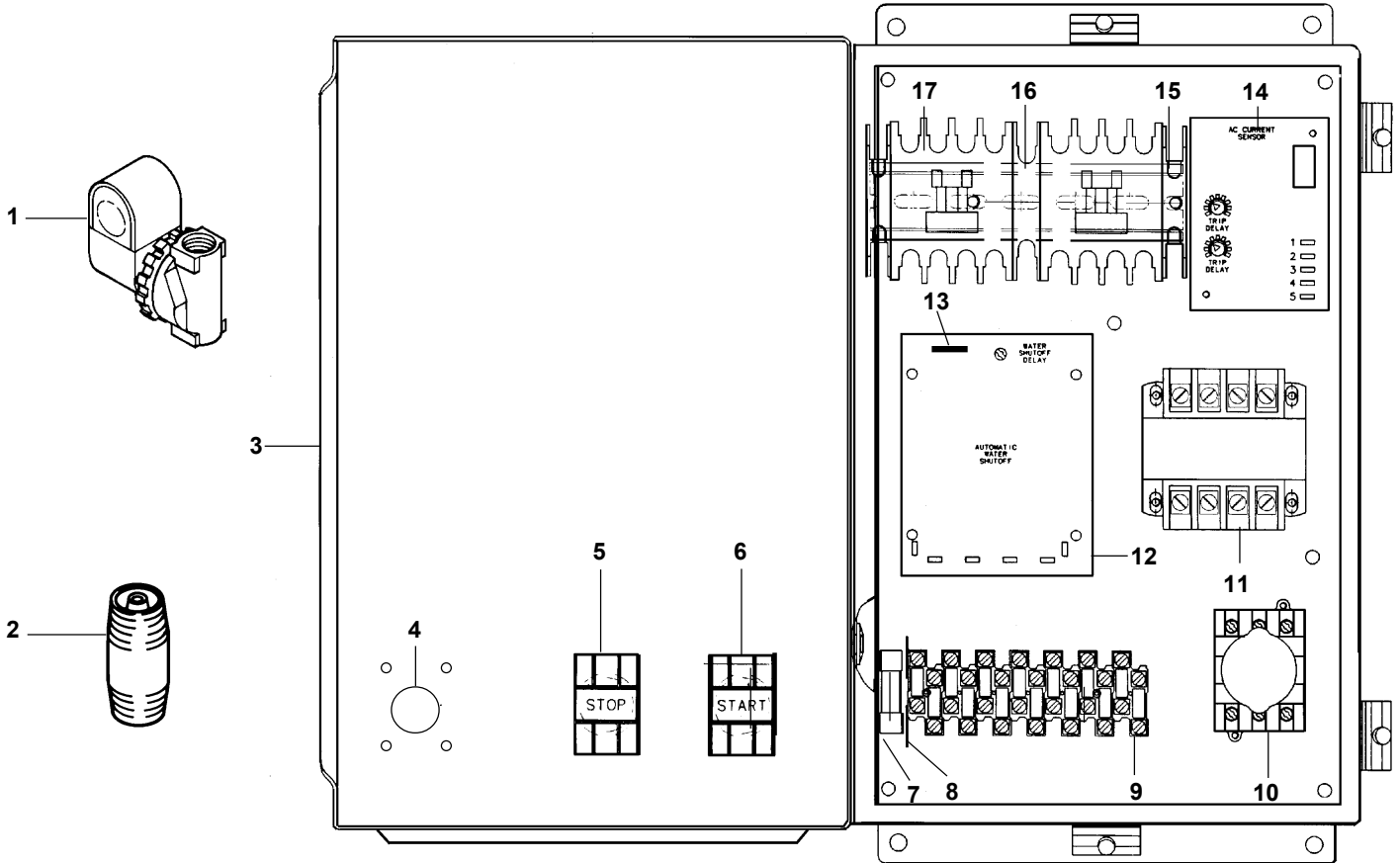

See Back Sheet For General Information

ORDER BY PART NUMBER, NOT CODE NUMBER

CODE NO.	PART NO.	NO. REQ.	DESCRIPTION	CODE NO.	PART NO.	NO. REQ.	DESCRIPTION
1	13236-B	2	Solenoid Valve - 24 V Coil		13871	1	Transformer - 1 phase Secondary voltage - 24 volts)
2	13763	1	Flow Control Valve (1GPM - all units)				(120V - 240V)
	13763-B	1	Flow Control Valve (1/2 - 1-1/4HP - 5GPM)	12	13467	1	Circuit board, printed
	13763-D	1	Flow Control Valve (1-1/2 - 2HP - 8GPM)	13	13498	1	Auto/Manual jumper
	13763-E	1	Flow Control Valve (3 - 10 HP - 10 GPM)	14	13930	1	Sensor, Current
3	N/A	1	Stainless Steel Enclosure	15	13866	2	Auxiliary contact block (used on 1 PH units ONLY)
4	13863	1	Door Disconnect Knob & Shaft	16	13873	1	Mechanical Interlock
5	13864	1	Pushbutton - Stop (N.C. Red)	17	13867	1	Reversing Contactor-(3PH) AS101J-3 & AS101J-4
6	13865	1	Pushbutton - Start (N.O.Black)		13868	1	Reversing Contactor - (3 PH) AS101J-5 & AS101J-6
7	13466	1	Fuse (2 amp - 125 volts) (FNA-2 or FNM-2)		13869	1	Reversing Contactor - (1 PH) AS101J-1 & AS101J-2 (includes Code 15)
8	13463	1	Fuse Holder		13625	4	Tamper Proof Screws (not shown)
9	13465	5	Terminal block - 3 phase		13935	4	Top Cover Retainer (not shown)
	13465	7	Terminal block - 1 phase		13942	4	Screws (not shown)
10	13872	1	Door Disconnect Switch				
11	13870	1	Transformer - 3 phase (Secondary voltage - 24 volts) (208V - 460V)				