



## ***200 SERIES DISHMACHINES***

***INCLUDING:***

***200 & 200B (DUAL TEMPERATURE, HOT  
WATER SANITIZING, UPRIGHT DOOR  
MACHINES)***

***200LT (CHEMICAL SANITIZING,  
UPRIGHT DOOR MACHINE)***

## **SERVICE MANUAL**

**Visit Jackson on the Internet at:  
[www.jacksonmsc.com](http://www.jacksonmsc.com)**

## **MANUFACTURERS WARRANTY**

### **ONE YEAR LIMITED PARTS & LABOR WARRANTY**

ALL NEW JACKSON DISHWASHERS ARE WARRANTED TO THE ORIGINAL PURCHASER TO BE FREE FROM DEFECTS IN MATERIAL OR WORKMANSHIP, UNDER NORMAL USE AND OPERATION FOR A PERIOD OF (1) ONE YEAR FROM THE DATE OF PURCHASE, BUT IN NO EVENT TO EXCEED (18) EIGHTEEN MONTHS FROM THE DATE OF SHIPMENT FROM THE FACTORY.

Jackson MSC agrees under this warranty to repair or replace, at its discretion, any original part which fails under normal use due to faulty material or workmanship during the warranty period, providing the equipment has been unaltered, and has been properly installed, maintained and operated in accordance with the applicable factory instruction manual furnished with the machine and the failure is reported to the authorized service agency within the warranty period. This includes the use of factory specified genuine replacement parts, purchased directly from a Jackson authorized parts distributor or service agency. Use of generic replacement parts may create a hazard and void warranty certification.

The labor to repair or replace such failed part will be paid by Jackson MSC, within the continental United States, Hawaii and Canada, during the warranty period provided a Jackson MSC authorized service agency, or those having prior authorization from the factory, performs the service. Any repair work by persons other than a Jackson MSC authorized service agency is the sole responsibility of the customer. Labor coverage is limited to regular hourly rates, overtime premiums and emergency service charges will not be paid by Jackson MSC.

Accessory components not installed by the factory carry a (1) one year parts warranty only. Accessory components such as table limit switches, pressure regulators, pre rinse units, etc. that are shipped with the unit and installed at the site are included. Labor to repair or replace these components is not covered by Jackson MSC.

This warranty is void if failure is a direct result from shipping, handling, fire, water, accident, misuse, acts of god, attempted repair by unauthorized persons, improper installation, if serial number has been removed or altered, or if unit is used for purpose other than it was originally intended.

#### **TRAVEL LIMITATIONS**

Jackson MSC limits warranty travel time to (2) two hours and mileage to (100) one hundred miles. Jackson MSC will not pay for travel time and mileage that exceeds this, or any fees such as those for air or boat travel without prior authorization.

#### **WARRANTY REGISTRATION CARD**

The warranty registration card supplied with the machine must be returned to Jackson MSC within 30 days to validate the warranty.

#### **REPLACEMENT PARTS WARRANTY**

Jackson replacement parts are warranted for a period of 90 days from the date of installation or 180 days from the date of shipment from the factory, which ever occurs first.

#### **PRODUCT CHANGES AND UPDATES**

Jackson MSC reserves the right to make changes in design and specification of any equipment as engineering or necessity requires.

**THIS IS THE ENTIRE AND ONLY WARRANTY OF JACKSON MSC. JACKSON'S LIABILITY ON ANY CLAIM OF ANY KIND, INCLUDING NEGLIGENCE, WITH RESPECT TO THE GOODS OR SERVICES COVERED HEREUNDER, SHALL IN NO CASE EXCEED THE PRICE OF THE GOODS OR SERVICES OR PART THEREOF WHICH GIVES RISE TO THE CLAIM.**

THERE ARE NO WARRANTIES, EXPRESSED OR IMPLIED, INCLUDING FOR FITNESS OR MERCHANTABILITY, THAT ARE NOT SET FORTH HEREIN, OR THAT EXTEND BEYOND THE DURATION HEREOF. UNDER NO CIRCUMSTANCES WILL JACKSON MSC BE LIABLE FOR ANY LOSS OR DAMAGE, DIRECT OR CONSEQUENTIAL, OR FOR THE DAMAGES IN THE NATURE OF PENALTIES, ARISING OUT OF THE USE OR INABILITY TO USE ANY OF ITS PRODUCTS.

#### **ITEMS NOT COVERED**

This warranty does not cover cleaning or deliming of the unit or any component such as, but not limited to, wash arms, rinse arms or strainers at anytime. Nor does it cover adjustments such as, but not limited to timer cams, thermostats or doors, beyond 30 days from the date of installation. In addition, the warranty will only cover the replacement of wear items such as curtains, drain balls, door guides or gaskets during the first 30 days after installation. Also, not covered are conditions caused by the use of incorrect (non-Commercial) grade detergents, incorrect water temperature or pressure, or hard water conditions.



# TABLE OF CONTENTS

<b>GENERAL</b>	<b>PAGE</b>
Specifications .....	1
Nomenclature .....	2
Detail of Data Plate.....	3
General Notes.....	4
 <b>INSTALLATION</b>	
Unpacking.....	5
Plumbing Connections.....	5
Electrical Connections.....	5
Installation Checklist.....	6
Detergent Control.....	7
 <b>OPERATIONAL INSTRUCTIONS</b>	
Preparation.....	8
Power Up.....	8
Initial Fill.....	8
Preparing the Dishes.....	8
Daily Machine Preparation.....	8
Washing a Rack of Ware.....	8
Shut Down and Cleaning.....	8
 <b>TROUBLE SHOOTING SECTION.....</b>	<b>9</b>
 <b>DIMENSIONS.....</b>	<b>12</b>
 <b>PHOTOGRAPHS</b>	
Main Assembly .....	13
Table Dimensions.....	15
Control Box Assembly (200B-1 Phase).....	16
Control Box Assembly (200B-3 Phase).....	18
Control Box Assembly (200-200LT1 Phase).....	20
Control Box Assembly (200-200LT3 Phase).....	22
Cantilever Arm Assembly.....	24
Yoke Assembly.....	26
Hood To Tub Assembly.....	27
Wash Tank Assembly.....	28
Lower Wash & Rinse Assembly.....	29
Upper Wash & Rinse Assembly.....	30
Incoming Plumbing Assembly 200B.....	31
Incoming Plumbing Assembly 200/200LT.....	33
Solenoid Valve Repair Kit.....	34
Vacuum Breaker Repair Kit.....	35
Booster Tank & Motor to Tub Assembly.....	36
 <b>REPLACEMENT WIRES &amp; CONDUIT.....</b>	<b>38</b>
 <b>JACKSON MAINTENANCE &amp; REPAIR CENTER NETWORK.....</b>	<b>42</b>
 <b>ELECTRICAL SCHEMATIC.....</b>	<b>49</b>
 <b>IMPORTANT INFORMATION DATA SHEET.....</b>	<b>50</b>

## SPECIFICATIONS OF THE 200 SERIES

### PERFORMANCE/CAPABILITIES

#### OPERATING CAPACITY (RACKS/HOUR)

RACKS PER HOUR	57
DISHES PER HOUR	1425
GLASSES PER HOUR	1425

#### OPERATING CYCLE (SECONDS)

WASH TIME	45
RINSE TIME	11
TOTAL CYCLE	58

#### TANK CAPACITY (GALLONS)

WASH TANK (MINIMUM)	8.0
BOOSTER TANK	3.0

#### WASH PUMP CAPACITY

GALLONS PER MINUTE	150
--------------------	-----

#### TEMPERATURES

WASH---°F (MINIMUM)	150
RINSE---°F (MINIMUM)	180
WASH---°F, 200 LT (MINIMUM)	130
RINSE---°F, 200 LT (MINIMUM)	130

#### FRAME DIMENSIONS

WIDTH	25 3/4"
DEPTH	25 5/16"
HEIGHT	56 3/4"
STANDARD TABLE HEIGHT	34"
MAXIMUM INSIDE CLEARANCE	17 1/4"

#### RACKS

DISH 20" X 20"	OPTIONAL
GLASS & SILVER 20" X 20"	OPTIONAL

#### ELECTRICAL REQUIREMENTS

WASH PUMP MOTOR HP	1
--------------------	---

#### AMPERAGE LOAD (12 KW BOOSTER HEATER)

##### 200B UNITS ONLY

VOLTS	PHASE	AMPS
208	1	71.4
230	1	78.1
208	3	39.6
230	3	43.5
460	3	21.7

#### AMPERAGE LOAD (14 KW BOOSTER HEATER)

##### 200B UNITS ONLY

VOLTS	PHASE	AMPS
208	1	78.6
230	1	86.3
208	3	43.8
230	3	48.2
460	3	24.1

#### AMPERAGE LOAD (200 & 200LT UNITS)

VOLTS	PHASE	AMPS
208	1	28.1
230	1	30.2
208	3	14.6
230	3	15.8
460	3	7.9

#### WATER REQUIREMENTS

INLET TEMPERATURE (200)	180°F min
INLET TEMPERATURE (200B)(9 KW)	140°F min
INLET TEMPERATURE (200B)(11 KW)	110°F min
INLET TEMPERATURE (200LT)	140°F min
GALLONS PER HOUR	52.2
GALLONS PER RACK	0.92
WATER LINE SIZE I.P.S. (Minimum)	3/4"
DRAIN LINE SIZE I.P.S. (Minimum)	1-1/2"
FLOW PRESSURE P.S.I. (Optimum)	20
MINIMUM CHLORINE REQUIRED (PPM)(200LT)	50

## NOMENCLATURE

This service manual covers three separate models of the 200 line of Jackson dishmachines. A brief description of these models is included here for your reference.

The 200B is a dual temperature, hot water sanitizing dishmachine. This model employs incoming water at a temperature less than 180° F (see individual machine data plate for incoming water temperature requirements). The water for rinse is heated using an integral rinse booster tank to raise the water temperature to the appropriate temperature. The wash tank temperature is maintained through the use of an internal wash tank heater and from heat transferred from the rinse cycle. The 200B, as stated previously, is a hot water sanitizing dishmachine, in that it uses heat, rather than chemicals, to clean and sanitize ware. The 200B still requires a separate detergent hookup in order to function correctly.

The 200LT is a chemical sanitizing dishmachine, designed to operate much in the same manner as the 200B. The major difference between the 200B and the 200LT is that the 200LT does not come with an integral rinse booster tank and must be connected to a third party chemical feeder system in order to ensure that ware comes clean and is sanitized properly.

The 200 is a dual temperature, hot water sanitizing dishmachine, designed to operate with an incoming water temperature of at least 180° F (see individual machine data plate for incoming water temperature requirements). The 200 does not have an integral rinse booster tank and therefore must be supplied with a higher temperature water than the 200B or 200LT. The 200 must be supplied with a separate detergent dispenser to ensure proper operation.

## DETAILS OF THE 200 SERIES DATA PLATE

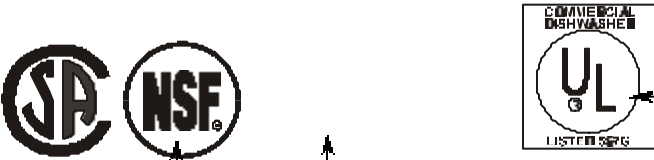
SERIAL NO.: <span style="border: 1px solid black; display: inline-block; width: 100px; height: 15px;"></span>	
<b>MODEL:</b>	<b>60Hz 1 PH 2 WIRE</b>
	<u>208 VOLT</u> <u>230 VOLT</u>
WASH MOTOR: 1 HP	8.4 AMPS                      1 HP    8.4 AMPS
WASH HEATER: 4.1 KW	<u>19.7 AMPS</u> 5 KW <u>21.8 AMPS</u>
TOTAL LOAD	28.1 AMPS                      ← 30.2 AMPS
MINIMUM WASH TEMPERATURE	150°F
MINIMUM RINSE TEMPERATURE	180°F
WASH CYCLE TIME	← 45 SEC
RINSE CYCLE TIME	11 SEC
INCOMING WATER TEMPERATURE	180°F MIN
OPTIMUM FLOW PRESSURE	20 PSI
	

MANUFACTURER'S LOGO

MODEL DESIGNATION (I.E. 200)

AMPERAGE LOAD INFORMATION

MINIMUM OPERATING PARAMETERS (SEE NOTE #1)

UL LOGO (SEE NOTE #2)

MANUFACTURER'S ADDRESS INFORMATION

NSF LOGO (SEE NOTE #4)

CSA LOGO (SEE NOTE #3)

The data plate is located (standing before the unit) on the right front corner, directly on the tub. Under no circumstance should the data plate be removed from the unit. The data plate is essential in identifying the particular characteristics of your machine and is of great benefit to installers, operators, and maintenance personnel. It is recommended that you copy down the essential information on the final page in this manual for reference before installation. Do not use the above data plate to represent your dishmachine. The data plate above is a generic representation used only to show you where to locate information.

## GENERAL NOTES SECTION

Before connecting, operating, or adjusting any of the dishmachines covered in this manual, please carefully read through the entire manual to familiarize yourself with the machine and its proper operation. This manual contains important operating, safety, and maintenance information concerning your dishmachine. You must follow the instructions and guidelines provided in this manual to ensure that your warranty remains in effect.

**FOR SERVICE PERSONNEL:** Jackson MSC Inc. provides technical support for all of the dishmachines detailed in this manual. We strongly recommend that you refer to this manual before making a call to our technical support staff. Please have this manual with you when you call so that our staff can refer you, if necessary, to the proper page. Technical support is available from 8:00 a.m. to 5:00 p.m. (EST), Monday through Friday. Technical support is not available on holidays. Contact technical support toll-free at 1-888-800-5672. Please remember that technical support is available for service personnel only. Non-service personnel should refer to the list of provided service agencies in this manual for local service support.

### NOTES CONCERNING THE 200 SERIES DATA PLATES:

**NOTE 1:** This area of the data plate denotes the minimum parameters that must be met in order for your dishmachine to operate at the designed level of efficiency. Not meeting the required parameters can result in substandard performance of the dishmachine. Do not refer to the data plate example in this manual for the parameters of your machine; instead, refer to the data plate affixed to the machine. Not every 200 machine operates the same way. If you are unsure of whether or not you are meeting the required minimum parameters, contact your nearest Jackson authorized service agency.

**NOTE 2:** The UL logo on the data plate indicates that this machine is Listed by Underwriters Laboratories Inc. Representative samples of this product have been evaluated by UL and meet applicable UL Standards and requirements. Dishmachines are evaluated under UL Standard 921. For more information concerning the UL logo and UL standards in general, you may write to: Underwriters Laboratories Inc., 333 Pfingsten Road, Northbrook, IL., 60062; or you may visit their website at [www.ul.com](http://www.ul.com).

**NOTE 3:** The CSA logo on the data plate indicates that this machine has been approved to bear this mark by CSA International Inc. CSA International evaluates and approves equipment for installation and operation in Canada. Representative samples of this product have been made available to CSA for inspection to ensure that they meet all applicable Canadian safety standards and regulations. For more information concerning the CSA mark and CSA standards in general, you may write to: CSA International Inc., 178 Rexdale Blvd, Rexdale (Toronto), Ontario, Canada, M9W 1R3; or you may visit their website at [www.csa-international.org](http://www.csa-international.org).

**NOTE 4:** The NSF logo on the data plate indicates that this machine has been approved to be listed under NSF Standard 3 by NSF International Inc. All of Jackson MSC's Standard 3 approved dishmachines are listed on the NSF website at [www.nsf.org](http://www.nsf.org). For more information concerning NSF International, their testing procedures and their standards in general, you may write to: NSF International Inc., 789 Dixboro Road, Ann Arbor, MI., 48105.

*Machines born  
of tradition*



*Built with  
innovation*

## INSTALLATION INSTRUCTIONS

**VISUAL INSPECTION:** Before installing the unit, check the container and machine for damage. A damaged container is an indicator that there may be some damage to the machine. If there is damage to both the container and machine, do not throw away the container. The dishmachine has been inspected and packed at the factory and is expected to arrive to you in new, undamaged condition. However, rough handling by carriers or others may result in there being damage to the unit while in transit. If such a situation occurs, do not return the unit to Jackson; instead, contact the carrier and ask them to send a representative to the site to inspect the damage to the unit and to complete an inspection report. You must contact the carrier within 48 hours of receiving the machine. Also, contact the dealer through which you purchased the unit.

**UNPACKING THE DISHMACHINE:** Once the machine has been removed from the container, ensure that there are no missing parts from the machine. This may not be obvious at first. If it is discovered that an item is missing, contact Jackson immediately to have the missing item shipped to you.

**LEVEL THE DISHMACHINE:** The dishmachine is designed to operate while being level. This is important to prevent any damage to the machine during operation and to ensure the best results when washing ware. The unit comes with adjustable bullet feet, which can be turned using a pair of pliers or by hand if the unit can be raised safely. Ensure that the unit is level from side to side and from front to back before making any connections.

**PLUMBING THE DISHMACHINE:** All plumbing connections must comply with all applicable local, state, and national plumbing codes. The plumber is responsible for ensuring that the incoming water line is thoroughly flushed prior to connecting it to any component of the dishmachine. It is necessary to remove all foreign debris from the water line that may potentially get trapped in the valves or cause an obstruction. Any valves that are fouled as a result of foreign matter left in the water line, and any expenses resulting from this fouling, are not the responsibility of the manufacturer.

**CONNECTING THE DRAIN LINE:** The drain for the 200 series models covered in this manual are gravity discharge drains. All piping from the 1-1/2" MNPT connection on the waste accumulator must be pitched (1/4" per foot) to the floor or sink drain. All piping from the machine to the drain must be a minimum 1-1/2" I.P.S. and shall not be reduced. There must also be an air gap between the machine drain line and the floor sink or drain. If a grease trap is required by code, it should have a flow capacity of 5 gallons per minute.

**WATER SUPPLY CONNECTION:** Ensure that you have read the section entitled "PLUMBING THE DISHMACHINE" above before proceeding. Install the water supply line (3/4" pipe size minimum) to the dishmachine line strainer using copper pipe. It is recommended that a water shut-off valve be installed in the water line between the main supply and the machine to allow access for service. The water supply line is to be capable of 20 PSI "flow" pressure at the recommended temperature indicated on the data plate.

In areas where the water pressure fluctuates or is greater than the recommended pressure, it is suggested that a water pressure regulator be installed. The 200 series models covered in this manual do not come with water pressure regulators as standard equipment. Please notify Jackson if you have any questions.

Do not confuse static pressure with flow pressure. Static pressure is the line pressure in a "no flow" condition (all valves and services are closed). Flow pressure is the pressure in the fill line when the fill valve is opened during the cycle.

It is also recommended that a shock absorber (not supplied with the 200 series models) be installed in the incoming water line. This prevents line hammer (hydraulic shock), induced by the solenoid valve as it operates, from causing damage to the equipment.

**PLUMBING CHECK:** Slowly turn on the water supply to the machine after the incoming fill line and the drain line have been installed. Check for any leaks and repair as required. All leaks must be repaired prior to placing the machine in operation.

**ELECTRICAL POWER CONNECTION:** Electrical and grounding connections must comply with the applicable portions of the National Electrical Code ANSI/NFPA 70 (latest edition) and/or other electrical codes.

Disconnect electrical power supply and place a tag at the disconnect switch to indicate that you are working on the circuit.

The dishmachine data plate is located on the right side and to the front of the machine. Refer to the data plate for machine operating requirements, machine voltage, total amperage load and serial number.

To install the incoming power lines, open the control box. This will require taking a phillipshead screwdriver and removing the four (4) screws on the sides of the control box. Install 3/4" conduit into the pre-punched holes in the back of the control box. Route power wires and connect to power block and grounding lug. Install the service wires (L1, L2, and L3 (3 phase only)) to the appropriate terminals as they are marked on the terminal block. Install the grounding wire into the lug provided. Tighten the connections and perform the "pull test". The tightened wires should remain in place after giving the wires a moderate pull to see if they will come loose.

It is recommended that "DE-OX" or another similar anti-oxidation agent be used on all power connections.

**VOLTAGE CHECK:** Ensure that the power switch is in the OFF position and apply power to the dishmachine. Check the incoming power at the terminal block and ensure it corresponds to the voltage listed on the data plate. If not, contact a qualified service agency to examine the problem. Do not run the dishmachine if the voltage is too high or too low. Shut off the service breaker and mark it as being for the dishmachine. Advise all proper personnel of any problems and of the location of the service breaker. Replace the control box cover and tighten down the screws.



## INSTALLATION CHECKLIST

CHECK OFF THE FOLLOWING ITEMS AS THEY ARE COMPLETED BEFORE PROCEEDING TO OPERATION OF DISHMA-  
CHINE.

- Has the dishmachine been checked for concealed/hidden damage?
- Has the dishmachine and the surrounding area been properly vented in accordance with all applicable codes?
- Has the dishmachine been properly leveled?
- Has the drain plumbing been installed with an air gap?
- Has the service voltage been checked to ensure that it meets the electrical requirements listed on the dishma-  
chine's data plate?
- Has the dishmachine been properly grounded?
- Has the dishmachine circuit breaker/service breaker been sized correctly, given the dishmachine's load, and has it  
been marked clearly and identified to all pertinent personnel?
- Has the incoming water supply been flushed for debris?
- Is the hot water supply at the minimum temperature as indicated on the dishmachine data plate?
- Is the incoming water supply at 20 PSI?
- Is the incoming water supply line at 3/4" minimum?
- Has the pump intake strainer been installed?
- Has the drain stopper been installed?
- Have the wash arms been installed?
- Have the rinse arms been installed?

## DETERGENT CONTROL

Detergent usage and water hardness are two factors that contribute greatly to how efficient your dishmachine will operate. Using detergent in the proper amount can become, in time, a source of substantial savings. A qualified water treatment specialist can tell you what is needed for maximum efficiency from your detergent, but you should still know some basics so you'll understand what they are talking about.

First, you must understand that hard water greatly effects the performance of the dishmachine. Water hardness is the amount of dissolved calcium and magnesium in the water supply. The more dissolved solids in the water, the greater the water hardness. Hard water works against detergent, thereby causing the amount of detergent required for washing to increase. As you use more detergent, your costs for operating the dishmachine will increase and the results will decrease. The solids in hard water also may build-up as a scale on wash and rinse heaters, decreasing their ability to heat water. Water temperature is important in removing soil and sanitizing dishes. If the water cannot get hot enough, your results may not be satisfactory. This is why Jackson recommends that if you have installed the machine in an area with hard water, that you also install some type of water treatment equipment to help remove the dissolved solids from the water before it gets to the dishmachine.

Second, hard water may have you adding drying agents to your operating cycle to prevent spotting, when the real problem is deposited solids on your ware. As the water evaporates off of the ware, the solids will be left behind to form the spotting and no amount of drying agent will prevent this. Again, using treated water will undoubtedly reduce the occurrences of this problem.

Third, treated water may not be suitable for use in other areas of your operation. For instance, coffee made with soft water may have an acid or bitter flavor. It may only be feasible to install a small treatment unit for the water going into the dishmachine itself. Discuss this option with your qualified water treatment specialist.

Even after the water hardness problems have been solved, there still must be proper training of dishmachine operators in how much detergent is to be used per cycle. Talk with your water treatment specialist and detergent vendor and come up with a complete training program for operators. Using too much detergent has as detrimental effects as using too little. The proper amount of detergent must be used for job. It is important to remember that certain menu items may require extra detergent by their nature and personnel need to be made aware of this. Experience in using the dishmachine under a variety of conditions, along with good training in the operation of the machine, can go a long way in ensuring your dishmachine operates as efficiently as possible.

Certain dishmachine models require that chemicals be provided for proper operation and sanitization. Some models even require the installation of third-party chemical feeders to introduce those chemicals to the machine. Jackson does not recommend or endorse any brand name of chemicals or chemical dispensing equipment. Contact your local chemical distributor for questions concerning these subjects.

Some dishmachines come equipped with integral solid detergent dispensers. These dispensers are designed to accommodate detergents in a certain sized container. If you have such a unit, remember to explain this to your chemical distributor upon first contacting them.

As explained before, water temperature is an important factor in ensuring that your dishmachine functions properly. The data plate located on each unit details what the minimum temperatures must be for either the incoming water supply, the wash tank and the rinse tank, depending on what model of dishmachine you have installed. These temperatures may also be followed by temperatures that Jackson recommends to ensure the highest performance from you dishmachine. However, if the minimum requirements are not met, the chances are your dishes will not be clean or sanitized. Remember, a dish can look clean, but it may not be sanitized. Instruct your dishmachine operators to observe the required temperatures and to report when they fall below the minimum allowed. A loss of temperature can indicate a much larger problem such as a failed heater or it could also indicate that the hot water heater for your operation is not up to capacity and a larger one may need to be installed.

There are several factors to consider when installing your dishmachine to ensure that you get the best possible results from it and that it operates at peak efficiency for many years. Discuss your concerns with your local chemical distributor and water treatment specialist before there is a problem.

## OPERATION INSTRUCTIONS

**PREPARATION:** Before proceeding with the start-up of the unit, verify the following:

1. The pan strainers and pump suction strainer are in place and are clean.
2. The overflow tube and o-ring are installed.
3. That the wash and rinse arm assemblies are secured into place and that their endcaps are tight. The wash and rinse arm assemblies should rotate freely.

**POWER UP:** To energize the unit, turn on the power at the service breaker. The voltage should have been previously verified as being correct. If not, the voltage will have to be verified.

**NOTE: UNLESS OTHERWISE SPECIFIED IN THESE INSTRUCTION, ENSURE THAT THE MANUAL MODE SWITCH IS IN THE "OFF" POSITION BEFORE PROCEEDING WITH ANY OF THE FOLLOWING STEPS.**

**FILLING THE WASH TUB:** Place the power switch into the ON position. Then place the cycle mode switch in the AUTO position. The machine should fill automatically and shut off when the appropriate level is reached (just below the pan strainer). Verify that the drain stopper is preventing the wash tub water from pouring out excessively. There may be some slight leakage from the drain hole. Verify that there are no other leaks on the unit before proceeding any further. The wash tub must be completely filled before operating the wash pump to prevent damage to the component. Once the wash tub is filled, the unit is ready for operation.

**WARE PREPARATION:** Proper preparation of ware will help ensure good results and less re-washes. If not done properly, ware may not come out clean and the efficiency of the dishmachine will be reduced. It is important to remember that a dishmachine is not a garbage disposal and that simply throwing unscrapped dishes into the machine simply defeats the purpose altogether of washing the ware. Scraps should be removed from ware prior to being loaded into a rack. Pre-rinsing and pre-soaking are good ideas, especially for silverware and casserole dishes. Place cups and glasses upside down in racks so that they do not hold water during the cycle. The dishmachine is meant not only to clean, but to sanitize as well, to destroy all of the bacteria that could be harmful to human beings. In order to do this, ware must be properly prepared prior to being placed in the machine.

**DAILY MACHINE PREPARATION:** Refer to the section entitled "PREPARATION" at the top of this page and follow the instructions there. Afterwards, check that all of the chemical levels are correct and/or that there is plenty of detergent available for the expected workload.

**WARM-UP CYCLES:** For a typical daily start-up, it is probably a good idea to run the machine through 3 cycles to ensure that all of the cold water is out of the system and to verify that the unit is operating correctly. To cycle the machine, ensure that the power is on, the cycle mode switch is in AUTO and that the tub has filled to the correct level. Lift the doors and the cycle light will illuminate. When the light goes out, close the doors, the unit will start, run through the cycle, and shut off automatically.

Repeat this two more times. The unit should now be ready to proceed with the washing of ware.

**WASHING A RACK OF WARE:** To wash a rack, open the doors completely (being careful for hot water that may drip from the doors) and slide the rack into the unit. Close the doors and the unit will start automatically. Once the cycle is completed, open the door (again watching for the dripping hot water) and remove the rack of clean ware. Replace with a rack of soiled ware and close the doors. The process will then repeat itself.

**OPERATIONAL INSPECTION:** Based upon usage, the pan strainer may become clogged with soil and debris as the workday progresses. Operators should regularly inspect the pan strainer to ensure it has not become clogged. If the strainer does, it will reduce the washing capability of the machine. Instruct operators to clean out the pan strainer at regular intervals or as required by work load.

**SHUTDOWN AND CLEANING:** At the end of the workday, close the doors. When the unit completes the cycle, turn the power switch to the OFF position and open the doors. Manually remove the drain stopper from the tub and allow the tub to drain (NOTE: the wash tank water will be hot so caution is advised). Once the wash tub is drained, remove the pan strainers and the pump suction strainer. Remove soil and debris from the strainer and set to the side. Remove the wash and rinse arm assemblies from their manifolds. Remove the endcaps and flush the arms with water. Use a brush to clean out the inside of the arms. If the nozzles appear to be clogged, use a toothpick to remove the obstruction. Wipe the inside of the unit out, removing all soil and scraps. Reassemble the wash and rinse arm assemblies and replace. NOTE: When replacing the arms, do not use any tools to do so, the assemblies should secure by hand. Reinstall the strainers and close the doors.

## TROUBLESHOOTING SECTION

**WARNING:** Inspection, testing and repair of electrical equipment should only be performed by a qualified service technician. Many of the tests require that the unit have power to it and live electrical components be exposed. **USE EXTREME CAUTION WHEN TESTING THE MACHINE.**

Symptom	Possible Cause	Action
Dishmachine will not run. No power to the unit.	Service breaker tripped.	Reset breaker. If breaker trips again, immediately contact an electrician.
	Incoming power lines not installed in control box.	Install power lines.
	Incoming power lines connections not tightened.	Tighten connections.
Dishmachine will not run. There is power to the unit.	Door switch shorted out or is disconnected.	Check to ensure door switch wires are connected correctly. If so, replace door switch.
	Faulty "ON/OFF" switch	Ensure switch is wired properly. If so, replace switch.
	Solid state timer, faulty.	Check wiring, replace if necessary.
Machine runs, but there is no water.	No water supply to machine.	Check to ensure that all water valves are open and that water is being supplied to the machine at 20 PSI.
	Incoming water supply solenoid not operating.	Check to ensure that valve is wired correctly. If so, replace valve.
Dishmachine fills continuously, even with no power to the machine.	Incoming water supply solenoid not operating. (Stuck open)	Check to ensure that valve is wired correctly. If so, replace valve.

## TROUBLESHOOTING SECTION (CONTINUED)

**WARNING:** Inspection, testing and repair of electrical equipment should only be performed by a qualified service technician. Many of the tests require that the unit have power to it and live electrical components be exposed. **USE EXTREME CAUTION WHEN TESTING THE MACHINE.**

<b>Symptom</b>	<b>Possible Cause</b>	<b>Action</b>
Dishmachine fills continuously, only when the power is on.	Incoming water supply solenoid not operating properly.	Check to ensure that valve is wired correctly. If so, replace valve.
	Faulty solid state timer.	Check wiring, replace if necessary.
	Shorted out ON/FILL switch.	Check the voltage across the switch. If the voltage is incorrect, replace the switch.
	Shorted/defective liquid level control board or probe.	Check voltage going to each component and ensure they are wired correctly. If satisfactory, replace the defective part.
Dishmachine runs with the door open.	Door switch shorted out/wired incorrectly.	Check the wiring of the door switch, if correct, replace the door switch.
	Faulty wash relay (wash relay welded closed).	Turn machine off, if wash relay doesn't release, replace contactor.
Low wash water pressure.	Water level is too low.	Check to ensure that the drain stopper is in and has an O-ring. Check to ensure that the LLC board and probe are functioning properly.
	Pump intake strainer is clogged.	Remove and clean strainer.
	Wash arms (nozzles) are clogged.	Remove wash arms and clean.

## TROUBLESHOOTING SECTION (CONTINUED)

**WARNING:** Inspection, testing and repair of electrical equipment should only be performed by a qualified service technician. Many of the tests require that the unit have power to it and live electrical components be exposed. **USE EXTREME CAUTION WHEN TESTING THE MACHINE.**

<b>Symptom</b>	<b>Possible Cause</b>	<b>Action</b>
Low wash water pressure.	Pump impeller worn or broken.	Replace pump.
Water temperature is less than required.	Low incoming water temperature.	Compare to data plate.
	No power to heater.	Check wiring, replace if necessary.
	Thermostat out of adjustment.	Adjust or replace thermostat as required.

# DIMENSIONS

**LEGEND:**

- A**- Drain 1 1/2" I.P.S.
- B**- Water inlet 3/4" I.P.S.
- C**- Electrical connection
- D**- Standard wall clearance, with dish table 4"
- E**- Model 200B booster tank location

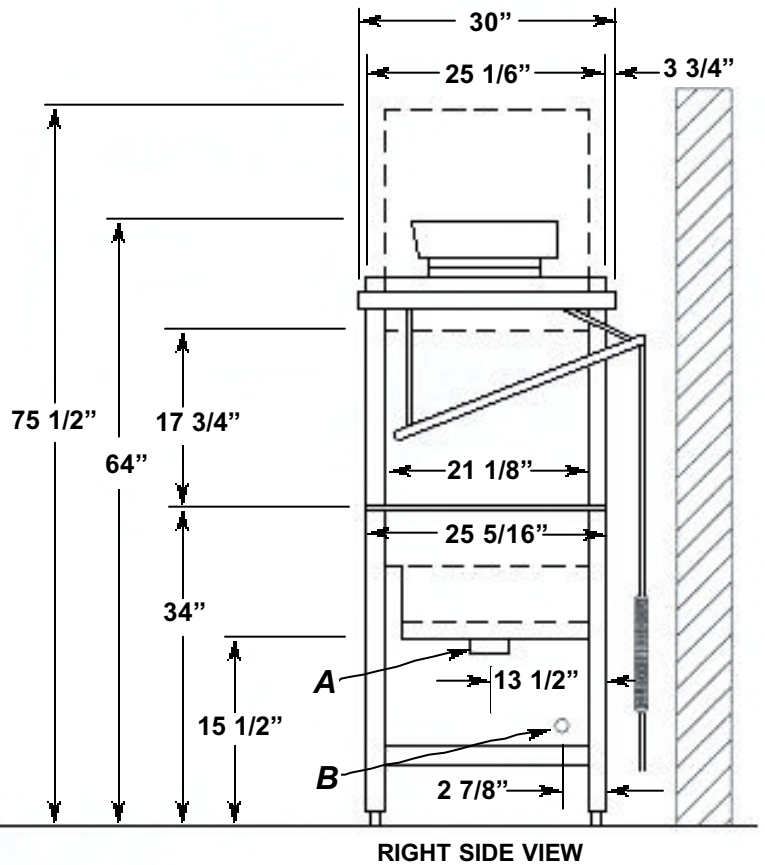
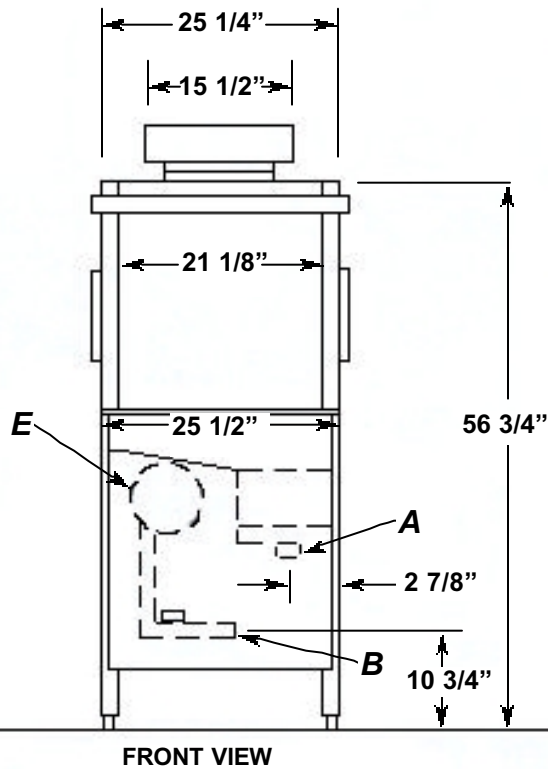
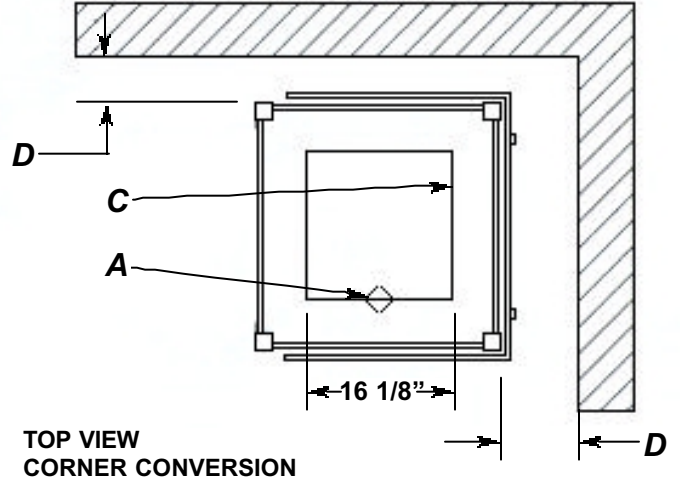
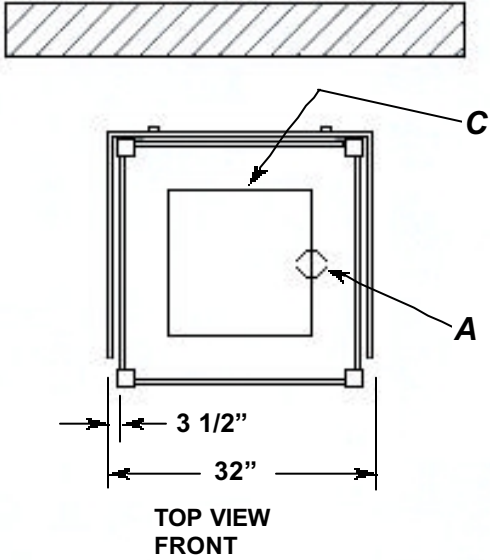

# MAIN ASSEMBLY

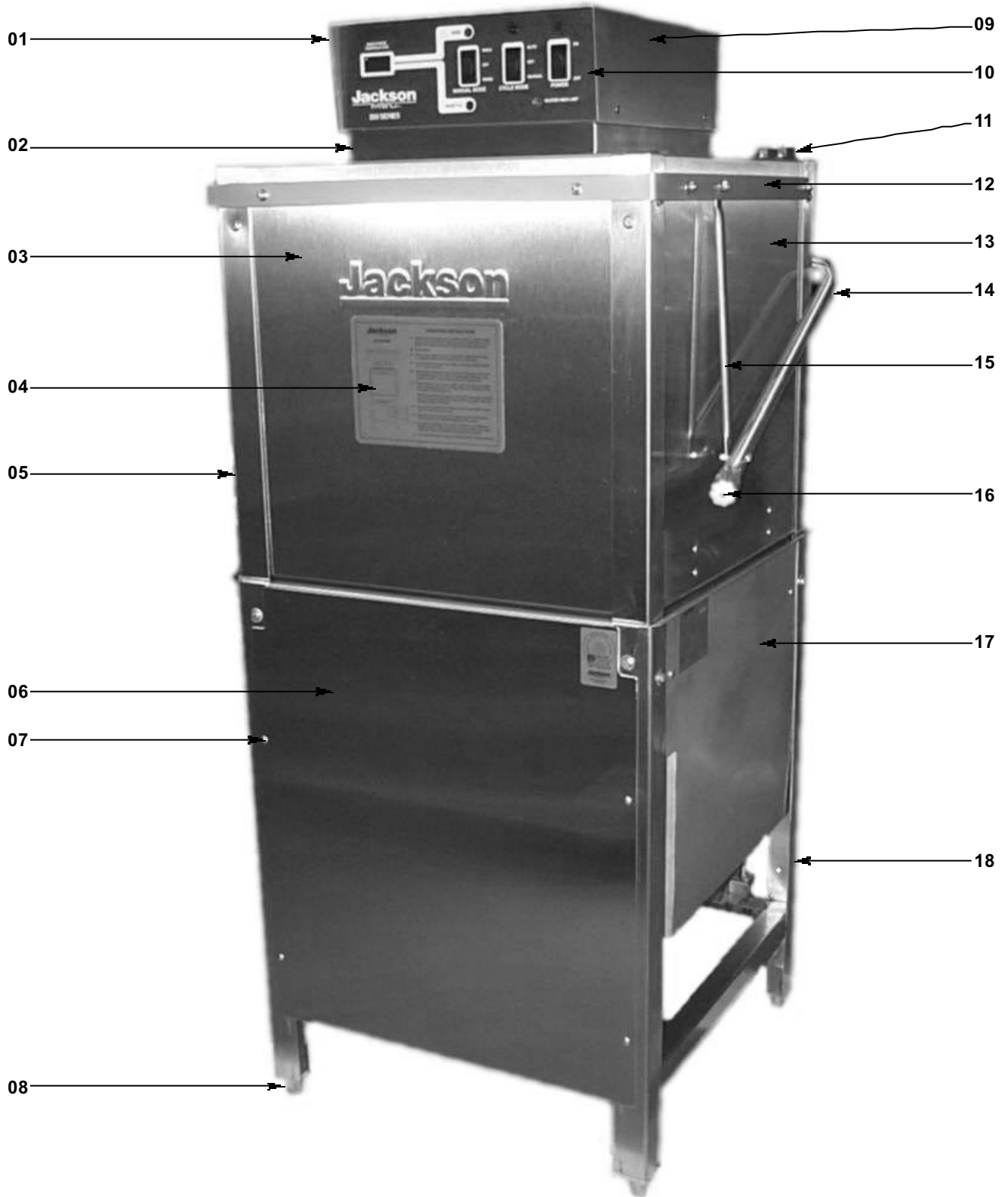



**MAIN ASSEMBLY (CONTINUED)**

<b>ITEM</b>	<b>QTY</b>	<b>DESCRIPTION</b>	<b>MFG NO.</b>
01	1	Control Box	5700-001-26-44
02	1	Control Box Platform	5700-001-26-89
03	1	Door, Front	5700-001-25-72
04	1	Decal, Operation 200	9905-101-11-12
05	1	Door, Left Side	5700-001-25-73
06	1	Panel, Front	5700-001-25-80
07	4	Screw, 10-32 X 3/8" Long Truss	5305-173-12-00
08	4	Bullet Feet	5340-108-02-06
09	1	Cover, Control Box	5700-001-22-09
10	1	Decal, Control Box	9905-101-00-00
11	1	Magnetic Door Switch Assembly	5930-111-51-22
12	1	Door Connector Wrap	5700-001-22-73
13	1	Door, Right Side	5700-001-25-74
14	1	Cantilever Arm Assembly	5700-001-25-75
15	2	Connector, Cantilever Arm	5700-001-25-42
16	2	Grips, Handle	5340-106-07-00
17	1	Tub Weldment	5700-001-25-48
18	1	Frame Weldment	5700-001-25-46

## TABLE DIMENSIONS

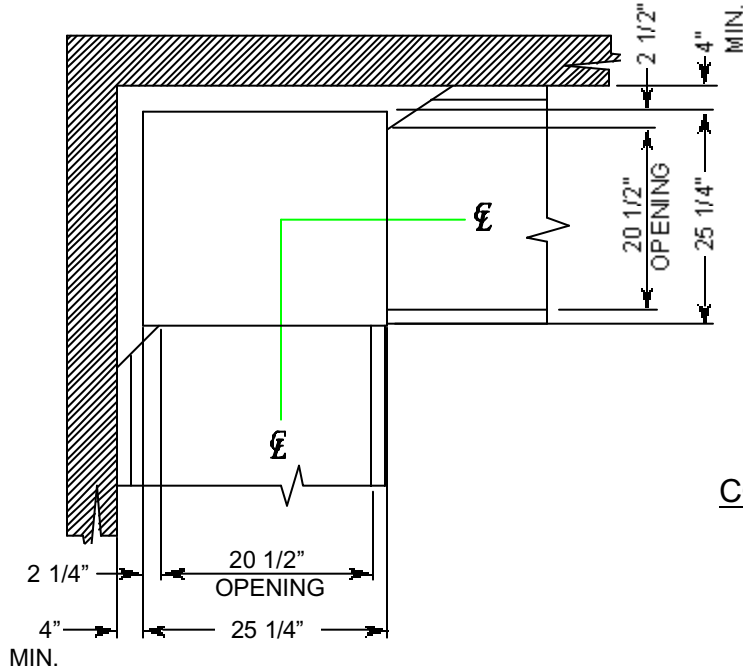

TABLE DIMENSIONS  
CORNER INSTALLATION

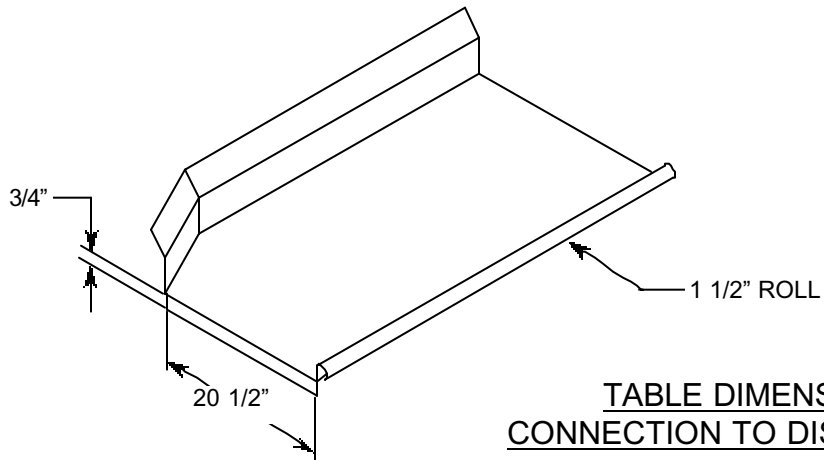

TABLE DIMENSIONS  
CONNECTION TO DISHMACHINE

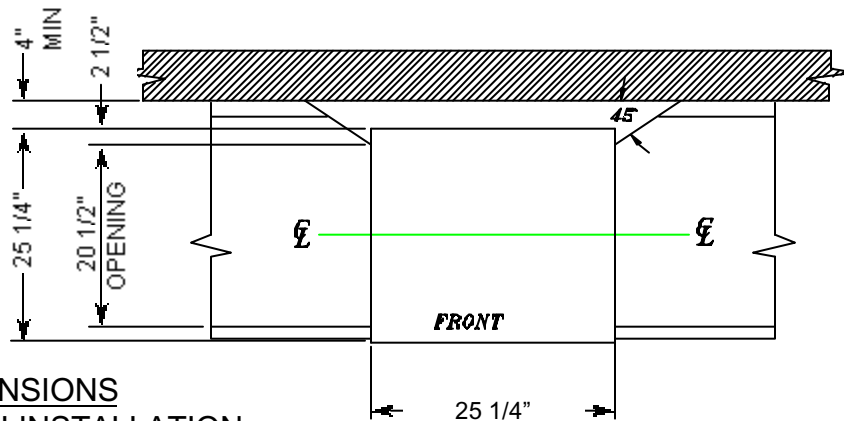
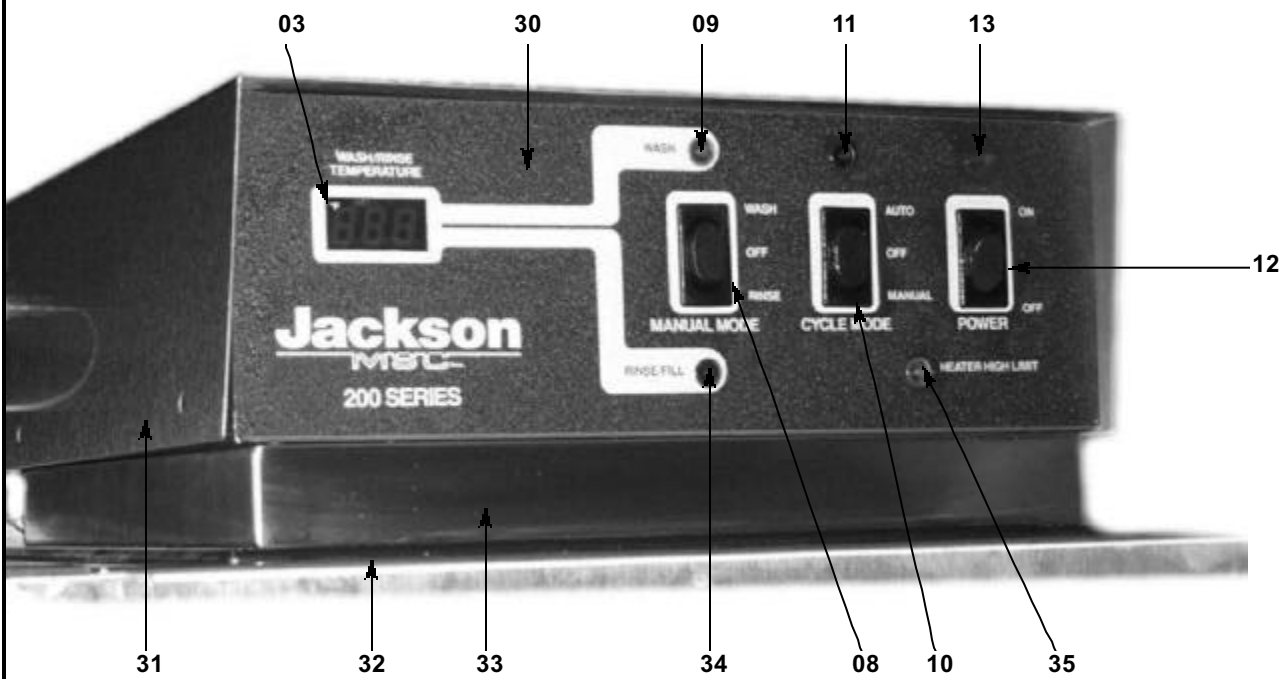
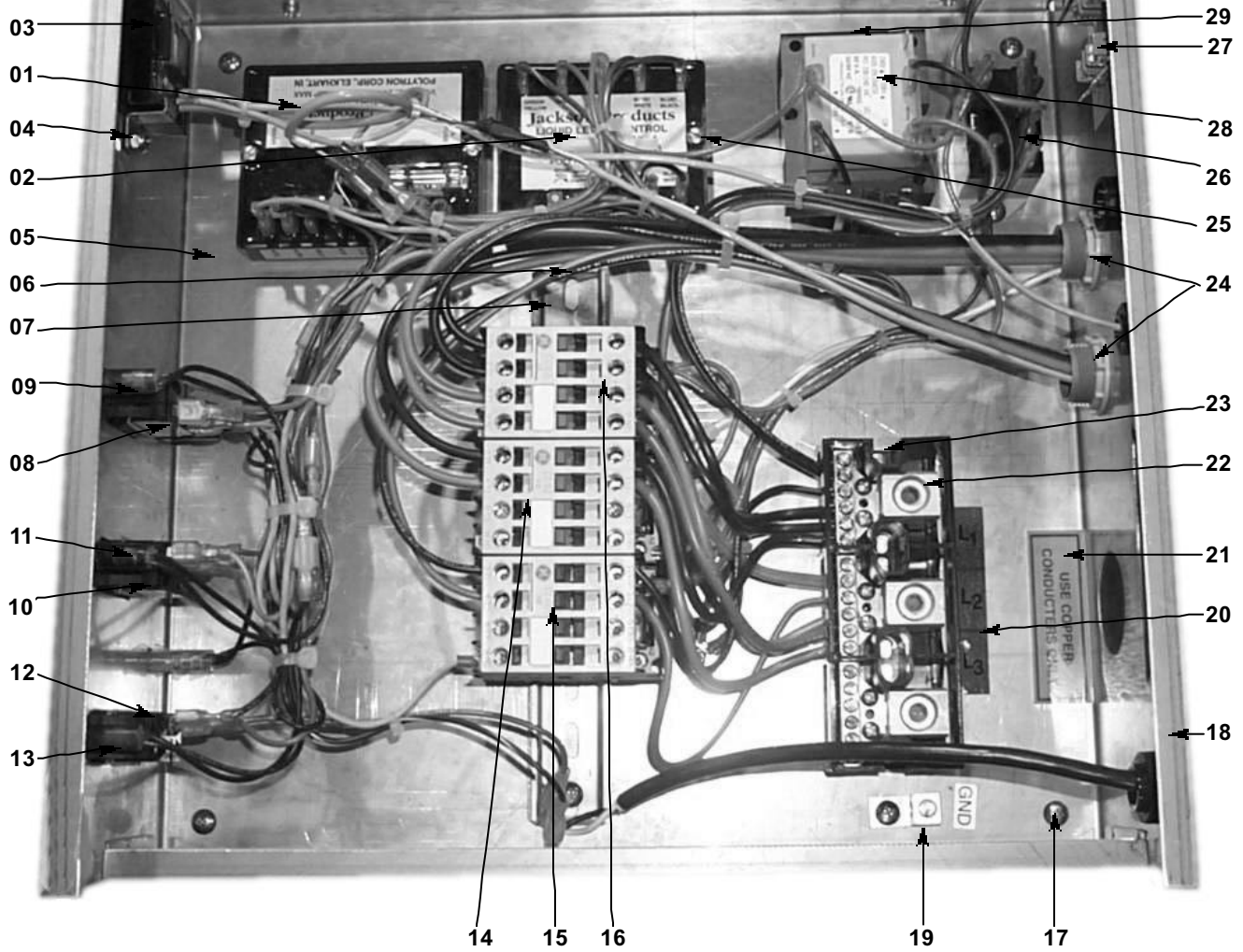

TABLE DIMENSIONS  
STRAIGHT THROUGH INSTALLATION

# 200B CONTROL BOX ASSEMBLY (208-230 VOLT 1 PHASE)



## 200B CONTROL BOX ASSEMBLY (208-230 VOLT 1 PHASE) (CONTINUED)

ITEM	QTY	DESCRIPTION	MFG NO.
01	1	Timer, Solid State	5945-307-07-93
02	1	Liq. Level Control, 2 Probe, 4 SEC	6680-200-01-93
03	1	Thermometer, Led w/ 21" & 89" Probe	6685-400-04-00
04	2	Locknut, 10-24 S/S Hex w/ Nylon Insert	5310-373-01-00
05	1	Platform, Back Control Box	5700-001-26-60
06	2	Screw, 10-32 X 3/8" Long Truss	5305-173-12-00
07	1	Din Rail, 9-11/16" Long	5700-001-26-97
08	1	Switch, SPDT 3 Position, WASH-OFF-RINSE	5930-302-03-41
09	1	Light, Amber Indicator 28 VAC	5945-504-02-90
10	1	Switch, SPDT 3 Position, AUTO-OFF-MANUAL	5930-302-01-41
11	1	Light, Green Indicator 28 VAC	5945-504-04-90
12	1	Switch, SPDT 2 Position, ON-OFF	5930-302-02-41
13	1	Light, Red Indicator 28 VAC	5945-504-01-90
14	1	Relay, Wash Motor, 208-460V, 1PH & 3 PH	5945-109-03-09
15	1	Relay, Wash Heater, 208-230V, 1 PH	5945-109-02-09
16	1	Relay, Rinse Heater, 208-230/380/460V	5945-109-01-09
17	4	Tricnut, 10-32	5340-118-05-00
18	1	Control Box Weldment w/ Tric-nuts	5700-001-26-44
19	1	WireLug	5940-200-76-00
20	1	Decal, L1, L2, L3,	9905-101-12-66
21	1	Decals, Copper Conductors	9905-011-47-35
22	1	Block, 3 Pole Power Distirbution	5945-603-01-66
23	2	Screw, 10-32 X 7/8" Fillister Head	5305-973-04-00
24	2	Fitting, 3/4" Straight Xtraflex	5975-205-46-44
25	4	Screw, 10-32 X 7/8" Fillister Head	5305-973-04-00
26	1	Relay, 24 VAC Coil	5945-301-07-40
27	1	Holder, Fuse #350 330	5920-401-03-14
28	1	Transformer, 60VA, 208/24V Class	5950-400-01-35
29	2	Screw, 10-32 X 3/8" Long Truss	5305-173-12-00
30	1	Decal, Control Box	9905-101-00-00
31	1	Cover, Control Box	5700-001-22-09
32	1	Spacer, Control Box	9515-800-94-00
33	1	Platform, w/Tricnut	5700-001-26-89
34	1	Light, Blue Indicator 28 VAC	5945-504-05-90
35	1	Light, Clear Indicator 28 VAC	5945-504-03-90

# 200B CONTROL BOX ASSEMBLY (208-230/460 VOLT 3 PHASE)

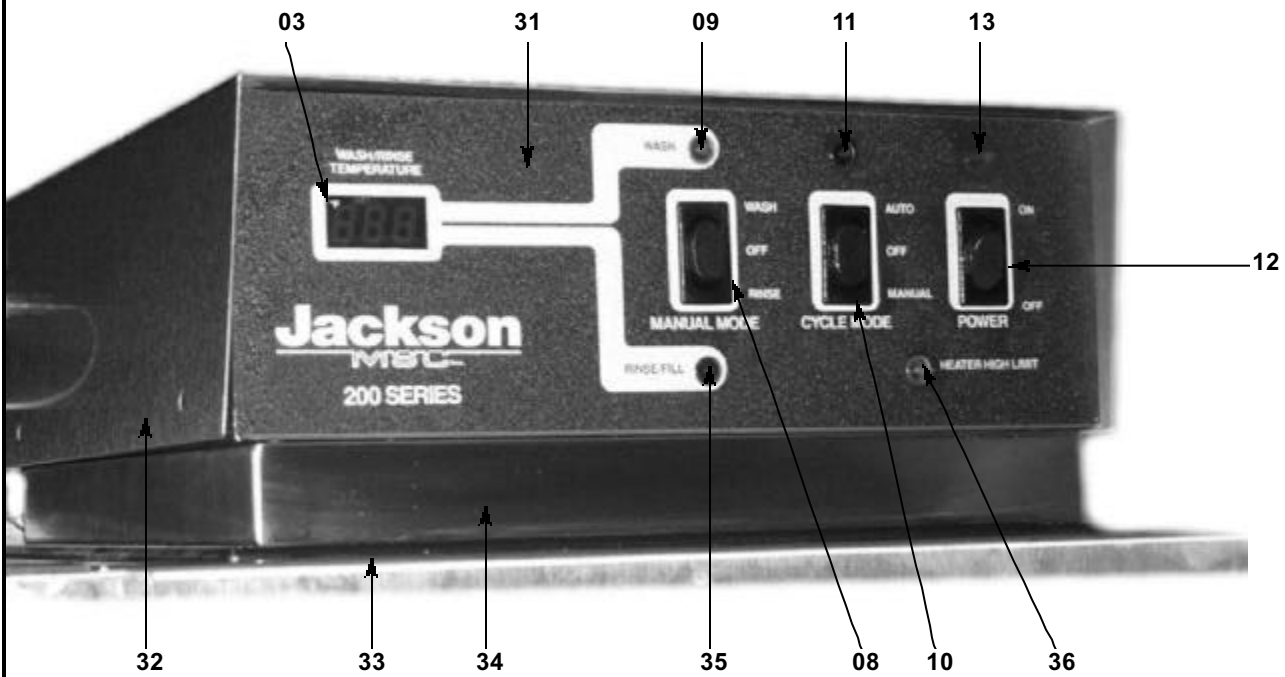
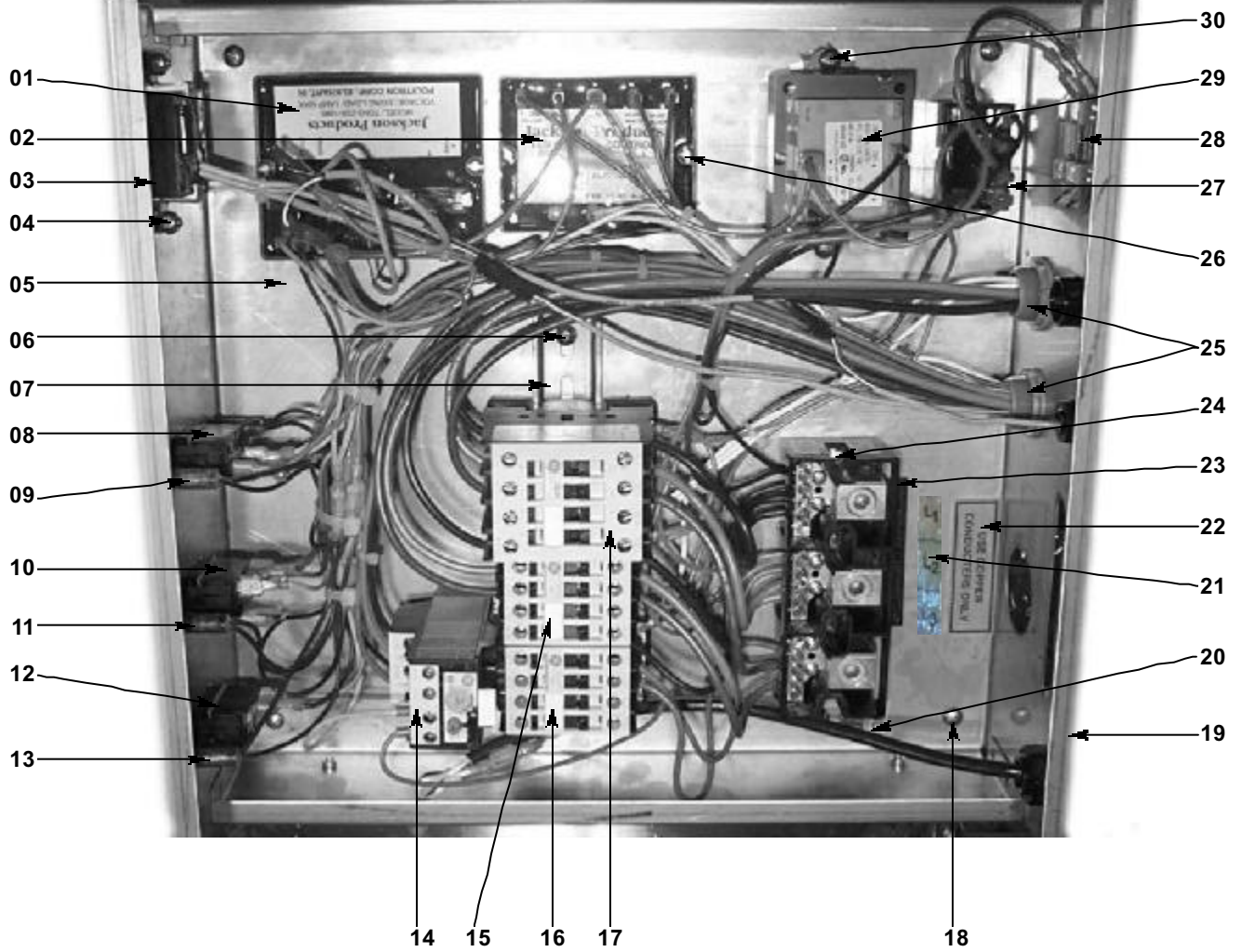

**200B CONTROL BOX ASSEMBLY (208-230/460 VOLT 3 PHASE) (CONTINUED)**

ITEM	QTY	DESCRIPTION	MFG NO.
01	1	Timer, Solid State	5945-307-07-93
02	1	Liq. Level Control, 2 Probe, 4 SEC	6680-200-01-93
03	1	Thermometer, Led w/ 21" & 89" Probe	6685-400-04-00
04	2	Locknut, 10-24 S/S Hex w/ Nylon Insert	5310-373-01-00
05	1	Platform, Back Control Box	5700-001-26-60
06	2	Screw, 10-32 X 3/8" Long Truss	5305-173-12-00
07	1	Din Rail, 9-11/16" Long	5700-001-26-97
08	1	Switch, SPDT 3 Position, WASH-OFF-RINSE	5930-302-03-41
09	1	Light, Amber Indicator 28 VAC	5945-504-02-90
10	1	Switch, SPDT 3 Position, AUTO-OFF-MANUAL	5930-302-01-41
11	1	Light, Green Indicator 28 VAC	5945-504-04-90
12	1	Switch, SPDT 2 Position, ON-OFF	5930-302-02-41
13	1	Light, Red Indicator 28 VAC	5945-504-01-90
14	1	Overload, 2.5-4 AMP Range	5945-111-68-41
14	1	Overload, 460V, 3 PH	5945-304-02-09
15	1	Relay, Wash Motor, 208-460V, 1PH & 3 PH	5945-109-03-09
16	1	Relay, Wash Heater, 208-230V, 1 PH	5945-109-02-09
17	1	Relay, Rinse Heater, 208-230/380/460V	5945-109-01-09
18	4	Tricnut, 10-32	5340-118-05-00
19	1	Control Box Weldment w/ Tric-nuts	5700-001-26-44
20	1	WireLug	5940-200-76-00
21	1	Decal, L1, L2, L3,	9905-101-12-66
22	1	Decals, Copper Conductors	9905-011-47-35
23	1	Block, 3 Pole Power Distirbution	5945-603-01-66
24	2	Screw, 10-32 X 7/8" Fillister Head	5305-973-04-00
25	2	Fitting, 3/4" Straight Xtraflex	5975-205-46-44
26	4	Screw, 10-32 X 7/8" Fillister Head	5305-973-04-00
27	1	Relay, 24 VAC Coil	5945-301-07-40
28	1	Holder, Fuse #350 330	5920-401-03-14
29	1	Transformer, 60VA, 208/240V Class	5950-400-01-35
29	1	Transformer, 60VA, 460V	5950-400-02-35
30	2	Screw, 10-32 X 3/8" Long Truss	5305-173-12-00
31	1	Decal, Control Box	9905-101-00-00
32	1	Cover, Control Box	5700-001-22-09
33	1	Spacer, Control Box	9515-800-94-00
34	1	Platform, w/Tricnut	5700-001-26-89
35	1	Light, Blue Indicator 28 VAC	5945-504-05-90
36	1	Light, Clear Indicator 28 VAC	5945-504-03-90

# 200/200LT CONTROL BOX ASSEMBLY (1 PHASE)

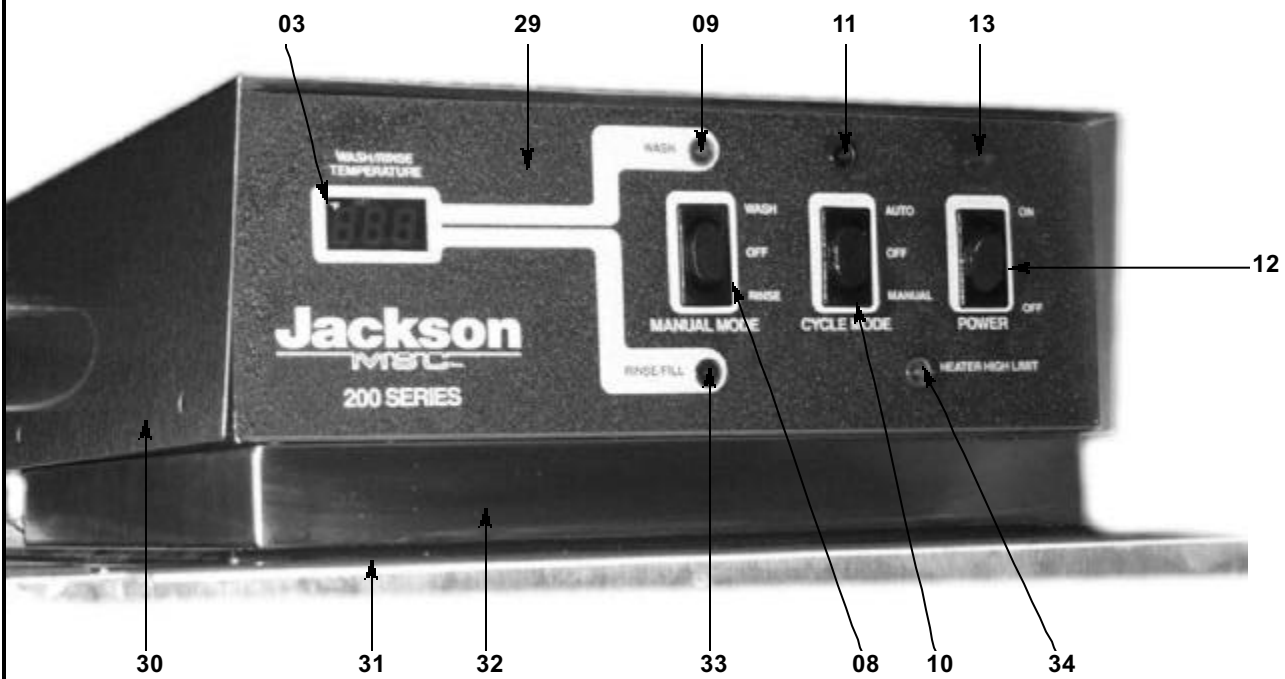
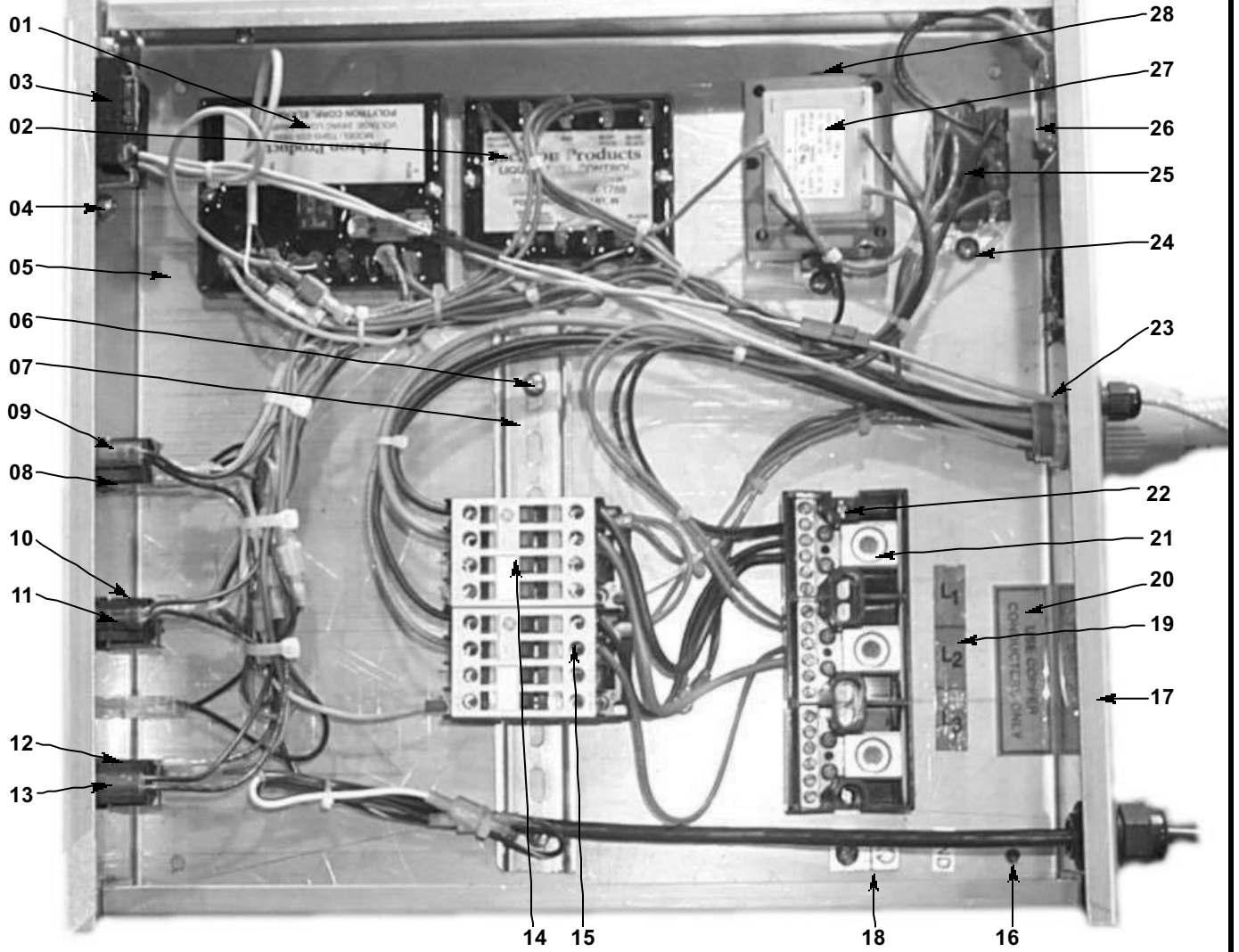

**200/200LT CONTROL BOX ASSEMBLY (1 PHASE) (CONTINUED)**

<b>ITEM</b>	<b>QTY</b>	<b>DESCRIPTION</b>	<b>MFG NO.</b>
01	1	Timer, Solid State	5945-307-07-93
02	1	Liq. Level Control, 2 Probe, 4 SEC	6680-200-01-93
03	1	Thermometer, Led w/ 21" & 89" Probe	6685-400-04-00
04	2	Locknut, 10-24 S/S Hex w/ Nylon Insert	5310-373-01-00
05	1	Platform, Back Control Box	5700-001-26-60
06	2	Screw, 10-32 X 3/8" Long Truss	5305-173-12-00
07	1	Din Rail, 9-11/16" Long	5700-001-26-97
08	1	Switch, SPDT 3 Position, WASH-OFF-RINSE	5930-302-03-41
09	1	Light, Amber Indicator 28 VAC	5945-504-02-90
10	1	Switch, SPDT 3 Position, AUTO-OFF-MANUAL	5930-302-01-41
11	1	Light, Green Indicator 28 VAC	5945-504-04-90
12	1	Switch, SPDT 2 Position, ON-OFF	5930-302-02-41
13	1	Light, Red Indicator 28 VAC	5945-504-01-90
14	1	Relay, Wash Motor, 208-460V, 1PH & 3 PH	5945-109-03-09
15	1	Relay, Wash Heater, 208-230V, 1 PH	5945-109-02-09
16	4	Tricnut, 10-32	5340-118-05-00
17	1	Control Box Weldment w/ Tric-nuts	5700-001-26-44
18	1	WireLug	5940-200-76-00
19	1	Decal, L1, L2, L3,	9905-101-12-66
20	1	Decals, Copper Conductors	9905-011-47-35
21	1	Block, 3 Pole Power Distirbution	5945-603-01-66
22	2	Screw, 10-32 X 7/8" Fillister Head	5305-973-04-00
23	2	Fitting, 3/4" Straight Xtraflex	5975-205-46-44
24	4	Screw, 10-32 X 7/8" Fillister Head	5305-973-04-00
25	1	Relay, 24 VAC Coil	5945-301-07-40
26	1	Holder, Fuse #350 330	5920-401-03-14
27	1	Transformer, 60VA, 208/24V Class	5950-400-01-35
28	2	Screw, 10-32 X 3/8" Long Truss	5305-173-12-00
29	1	Decal, Control Box	9905-101-00-00
30	1	Cover, Control Box	5700-001-22-09
31	1	Spacer, Control Box	9515-800-94-00
32	1	Platform, w/Tricnut	5700-001-26-89
33	1	Light, Blue Indicator 28 VAC	5945-504-05-90
34	1	Light, Clear Indicator 28 VAC	5945-504-03-90



200/200LT CONTROL BOX ASSEMBLY (208-230/460 VOLT 3 PHASE)

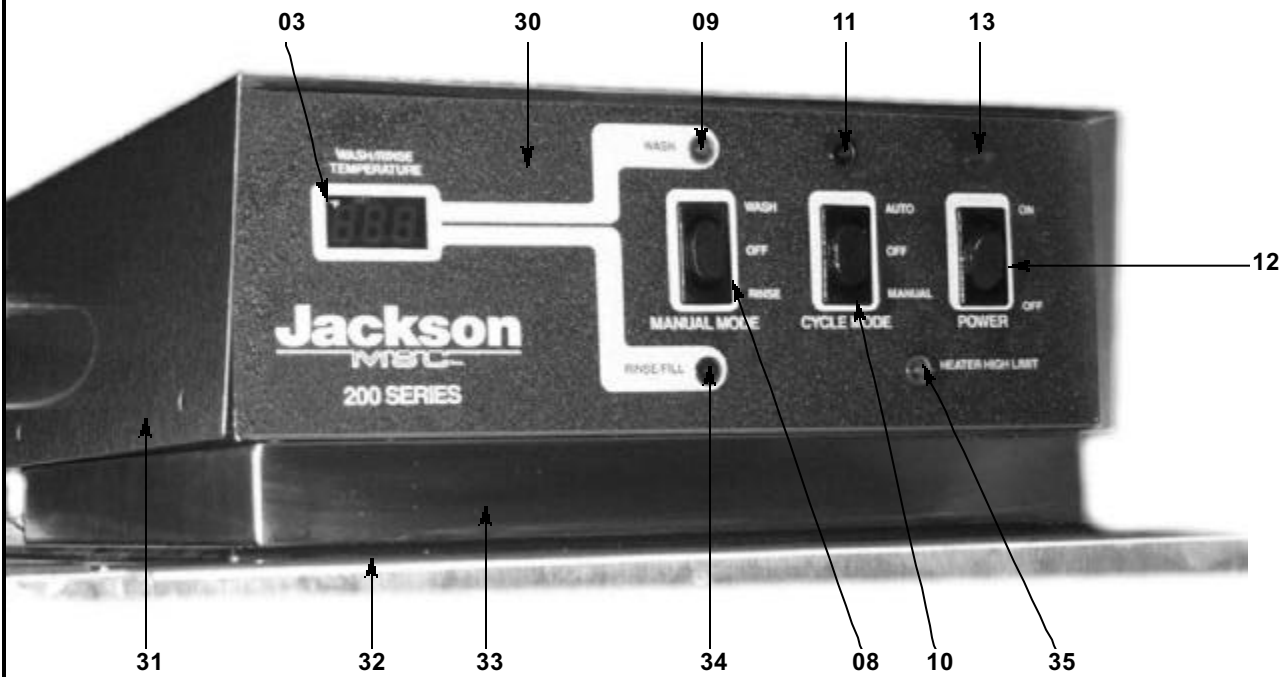
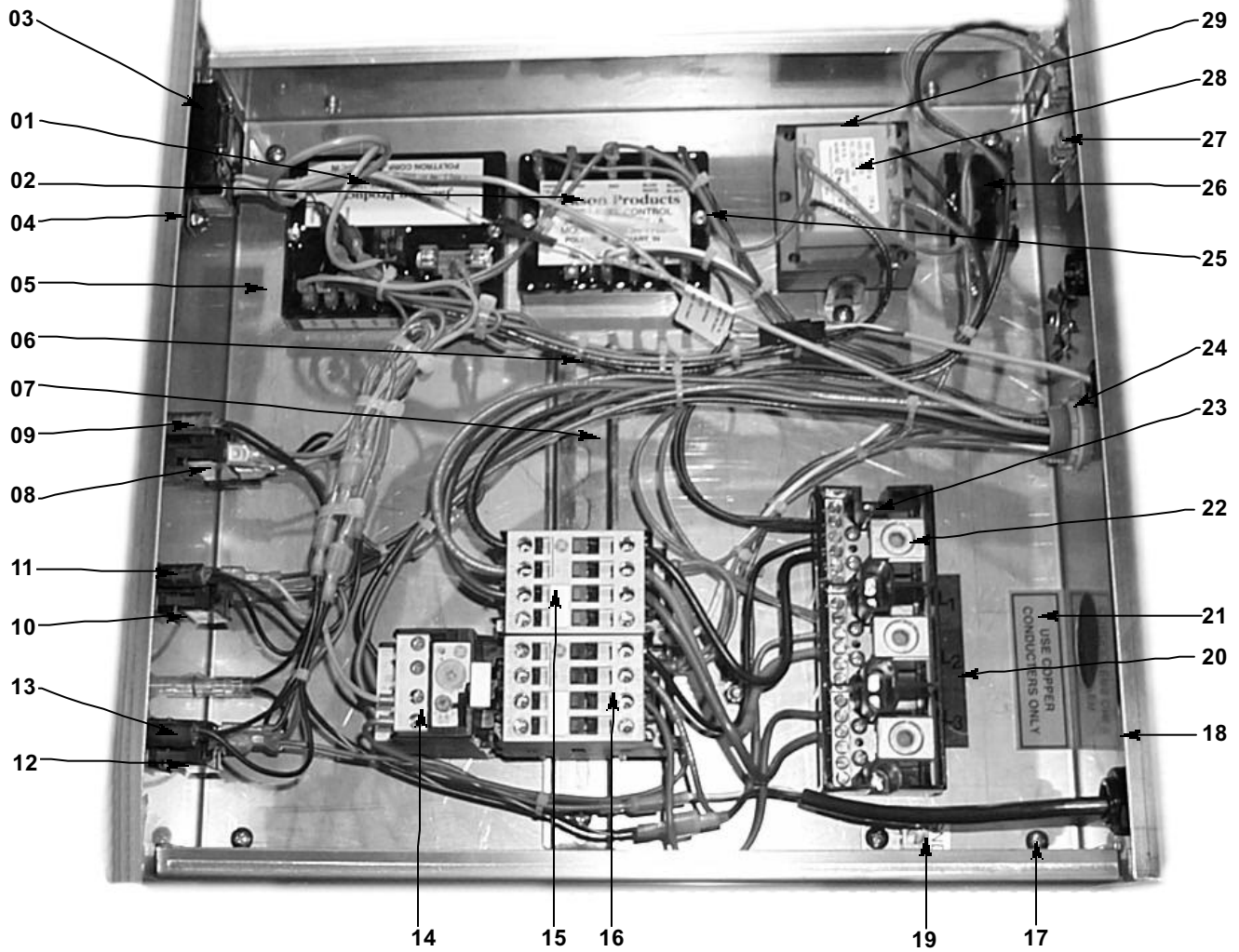

## 200/200LT CONTROL BOX ASSEMBLY (208-230/460 VOLT 3 PHASE) (CONT)

ITEM	QTY	DESCRIPTION	MFG NO.
01	1	Timer, Solid State	5945-307-07-93
02	1	Liq. Level Control, 2 Probe, 4 SEC	6680-200-01-93
03	1	Thermometer, Led w/ 21" & 89" Probe	6685-400-04-00
04	2	Locknut, 10-24 S/S Hex w/ Nylon Insert	5310-373-01-00
05	1	Platform, Back Control Box	5700-001-26-60
06	2	Screw, 10-32 X 3/8" Long Truss	5305-173-12-00
07	1	Din Rail, 9-11/16" Long	5700-001-26-97
08	1	Switch, SPDT 3 Position, WASH-OFF-RINSE	5930-302-03-41
09	1	Light, Amber Indicator 28 VAC	5945-504-02-90
10	1	Switch, SPDT 3 Position, AUTO-OFF-MANUAL	5930-302-01-41
11	1	Light, Green Indicator 28 VAC	5945-504-04-90
12	1	Switch, SPDT 2 Position, ON-OFF	5930-302-02-41
13	1	Light, Red Indicator 28 VAC	5945-504-01-90
14	1	Overload, 2.5-4 AMP Range	5945-111-68-41
14	1	Overload, 460V, 3PH	5945-304-02-09
15	1	Relay, Wash Motor, 208-460V, 1PH & 3 PH	5945-109-03-09
16	1	Relay, Wash Heater, 208-230V, 1 PH	5945-109-02-09
17	4	Tricnut, 10-32	5340-118-05-00
18	1	Control Box Weldment w/ Tric-nuts	5700-001-26-44
19	1	WireLug	5940-200-76-00
20	1	Decal, L1, L2, L3,	9905-101-12-66
21	1	Decals, Copper Conductors	9905-011-47-35
22	1	Block, 3 Pole Power Distirbution	5945-603-01-66
23	2	Screw, 10-32 X 7/8" Fillister Head	5305-973-04-00
24	2	Fitting, 3/4" Straight Xtraflex	5975-205-46-44
25	4	Screw, 10-32 X 7/8" Fillister Head	5305-973-04-00
26	1	Relay, 24 VAC Coil	5945-301-07-40
27	1	Holder, Fuse #350 330	5920-401-03-14
28	1	Transformer, 60VA, 208/24V Class	5950-400-01-35
28	1	Transformer, 60VA, 460V Class	5950-400-02-35
29	2	Screw, 10-32 X 3/8" Long Truss	5305-173-12-00
30	1	Decal, Control Box	9905-101-00-00
31	1	Cover, Control Box	5700-001-22-09
32	1	Spacer, Control Box	9515-800-94-00
33	1	Platform, w/Tricnut	5700-001-26-89
34	1	Light, Blue Indicator 28 VAC	5945-504-05-90
35	1	Light, Clear Indicator 28 VAC	5945-504-03-90

# CANTILEVER ARM ASSEMBLY

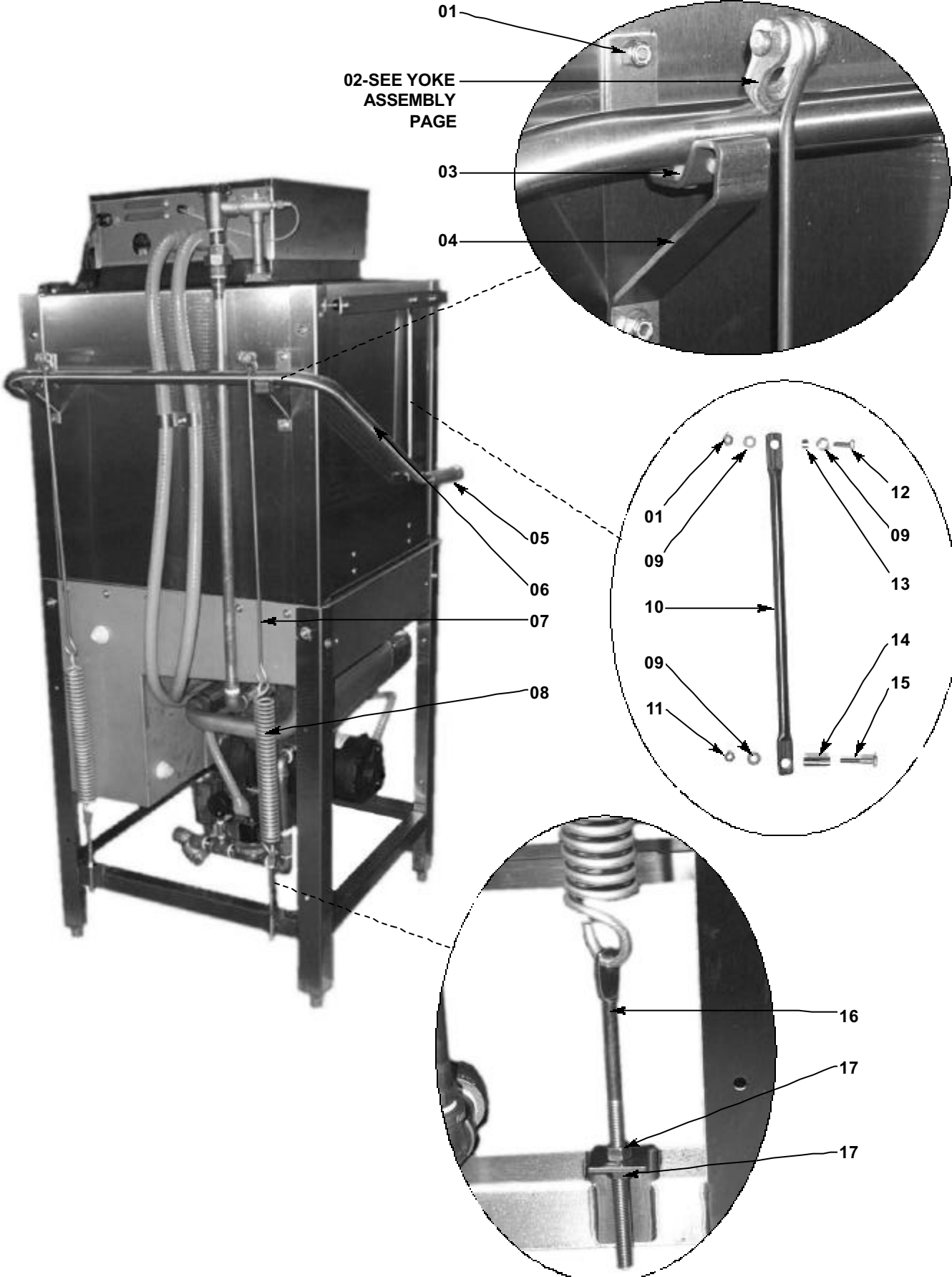

## CANTILEVER ARM ASSEMBLY (CONTINUED)

ITEM	QTY	DESCRIPTION	MFG NO.
01	4	Locknut, 1/4"- 20 S/S Hex w/ Nylon Insert	5310-374-01-00
02	2	Yoke Assembly	5700-000-75-78
03	6	Wear Button, 1/2" D. UHMW	5700-011-88-01
04	2	Cantilever Arm Support Brkt.	5700-031-88-00
05	2	Handle Grips	5340-106-07-00
06	1	Cantilever Arm	5700-001-21-00
07	2	Spring Rod	5700-001-28-18
08	2	Springs	5340-109-02-00
09	3	Washer, 1/4" ID S/S	5311-174-01-00
10	2	Cantilever Arm Connector	5700-001-25-42
11	2	Locknut, 1/4"- 20 S/S Low Profile w/ Nylon Insert	5310-374-02-00
12	2	Bolt, Hex Head 1/4"- 20 X 3/4" Long	5305-274-04-00
13	2	Sleeve, Lever & Wrap	5700-001-25-41
14	2	Sleeve, Cantilever Arm	5700-000-85-69
15	2	Screw, 1/4"- 20 X 1-1/2" Long Hex Head	5305-274-23-00
16	2	Bolt, Hanger Eye, 3/8-16	5306-956-05-00
17	4	Nut, 3/8"- 16 S/S Hex Head	5310-276-01-00

# YOKE ASSEMBLY

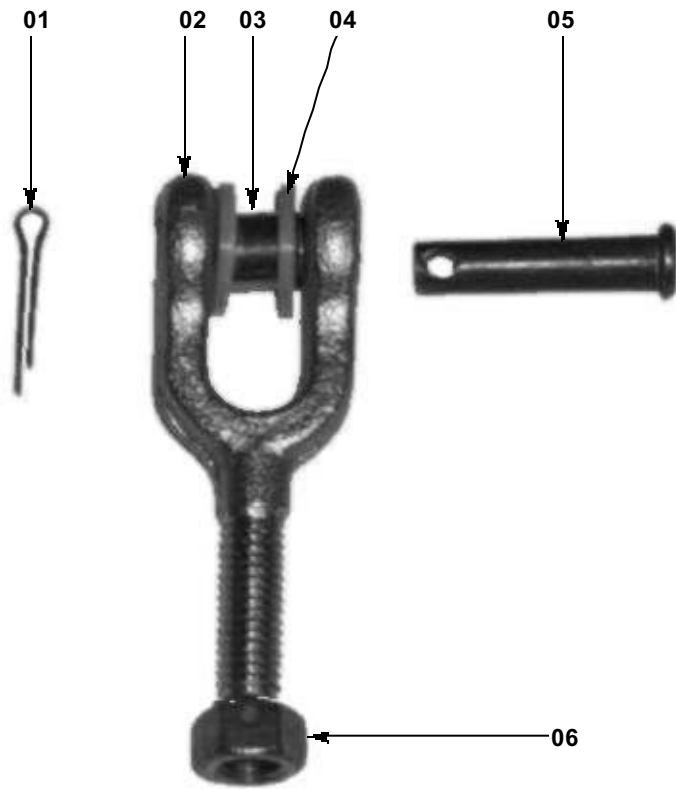

ITEM	QTY	DESCRIPTION	MFG NO.
01	1	Cotter Pin, 3/32 X 3/4"	5315-207-01-00
02	1	Yoke, Finished	5700-000-75-78
03	1	Bushing	3120-100-03-00
04	2	Washer, Nylon	5311-369-03-00
05	1	Clevis Pin	5315-700-01-00
06	1	Nut, Center Lock 3/8"- 16 S/S	5310-256-04-00

## HOOD TO TUB ASSEMBLY

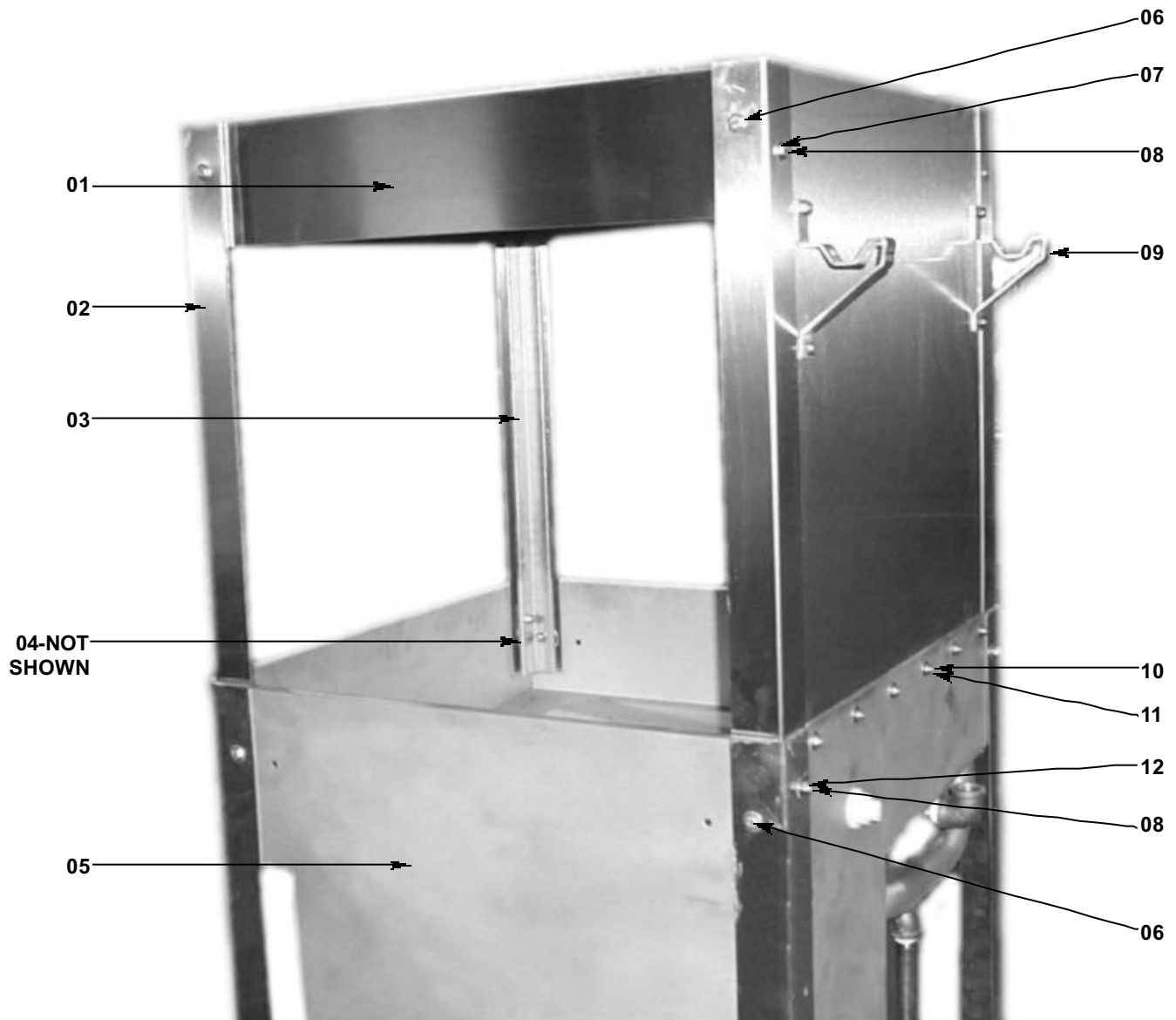

ITEM	QTY	DESCRIPTION	MFG NO.
01	1	Hood-Top, Back, & Side Rail	5700-001-23-22
02	4	Hood Support	5700-001-20-83
03	2	Front Door Rail	5700-001-20-82
04	6	Spacer, Bottom Corner	5700-001-23-05
05	1	Tub Weldment	5700-001-25-48
06	12	Bolt, 1/4-20 X 1-1/8" S/S Hex Head	5305-274-21-00
07	22	1/4" S/S Washer	5311-174-01-00
08	2	Bolt, 1/4-20 X 5/8" S/S Hex Head	5305-275-24-00
09	2	Cantilever Arm Support Bracket	5700-031-88-00
10	6	Screw, w/Rubber Washer 1/4"- 20 X 1/2" Long	5305-974-01-00
11	22	1/4-20 S/S Hex Nut w/Nylon Insert	5310-374-01-00
12	2	Bolt, 1/4"- 20 X 3/4" Hex Head	5305-274-01-00

# WASH TANK ASSEMBLY

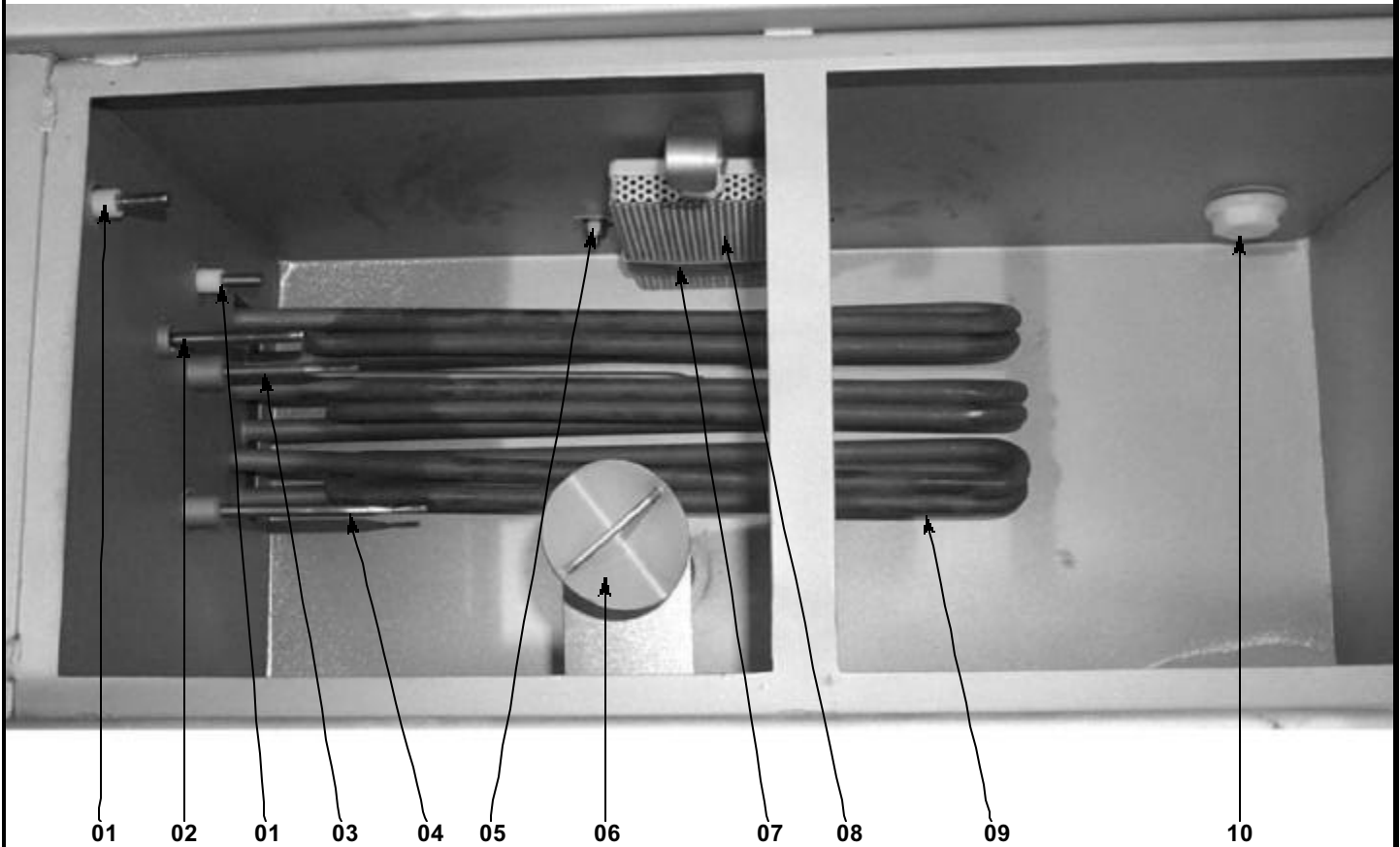

ITEM	QTY	DESCRIPTION	MFG NO.
01	2	Water Level Probe 3/8" NPT	6680-200-02-68
02	1	Thermometer, Led w/21° Probe, & 89° Probe	6685-400-04-00
03	1	Hi Limit Thermostat w/ Loxit Fitting 220°F Fixed	5930-510-01-79
04	1	Wash Thermostat w/Loxit Ffitting 150°F Adjustable	5930-510-02-79
05	2	Locknut, 1/4"- 20 S/S w/Nylon Insert	5310-374-01-00
06	1	Drain Tube Assembly	5700-001-25-69
07	1	Suction Strainer Bracket	5700-001-22-24
08	1	Suction Strainer	5700-001-22-23
09	1	Heater, Wash 240V 5300W FLG. Immersion	4540-100-02-15
10	2	Plug, Bulk Head	4730-609-05-00

## LOWER WASH & RINSE ARM ASSEMBLY



01      02      03                      04      05      06      07      08      09      10                      11

ITEM	QTY	DESCRIPTION	MFG NO.
01	1	Top Wash & Rinse Manifold Assembly	5700-001-25-52
02	1	Track Assembly	5700-001-22-16
03	2	Manifold Gasket	5330-500-18-00
04	1	Wash Arm Assembly	5700-021-42-00
05	1	Bottom Wash & Rinse Manifold Weld Assembly	5700-001-25-53
06	1	Wash Spindle, Machined	5700-021-41-81
07	1	Rinse Spindle, Machined	5700-031-41-89
08	1	Wash Head Cap	5700-021-41-92
09	2	Plug, Bulk Head	4730-609-05-00
10	1	Rinse Arm Assembly	5700-021-41-98
11	2	Strainer Weldment	5700-001-22-25



## UPPER WASH & RINSE ARM ASSEMBLY

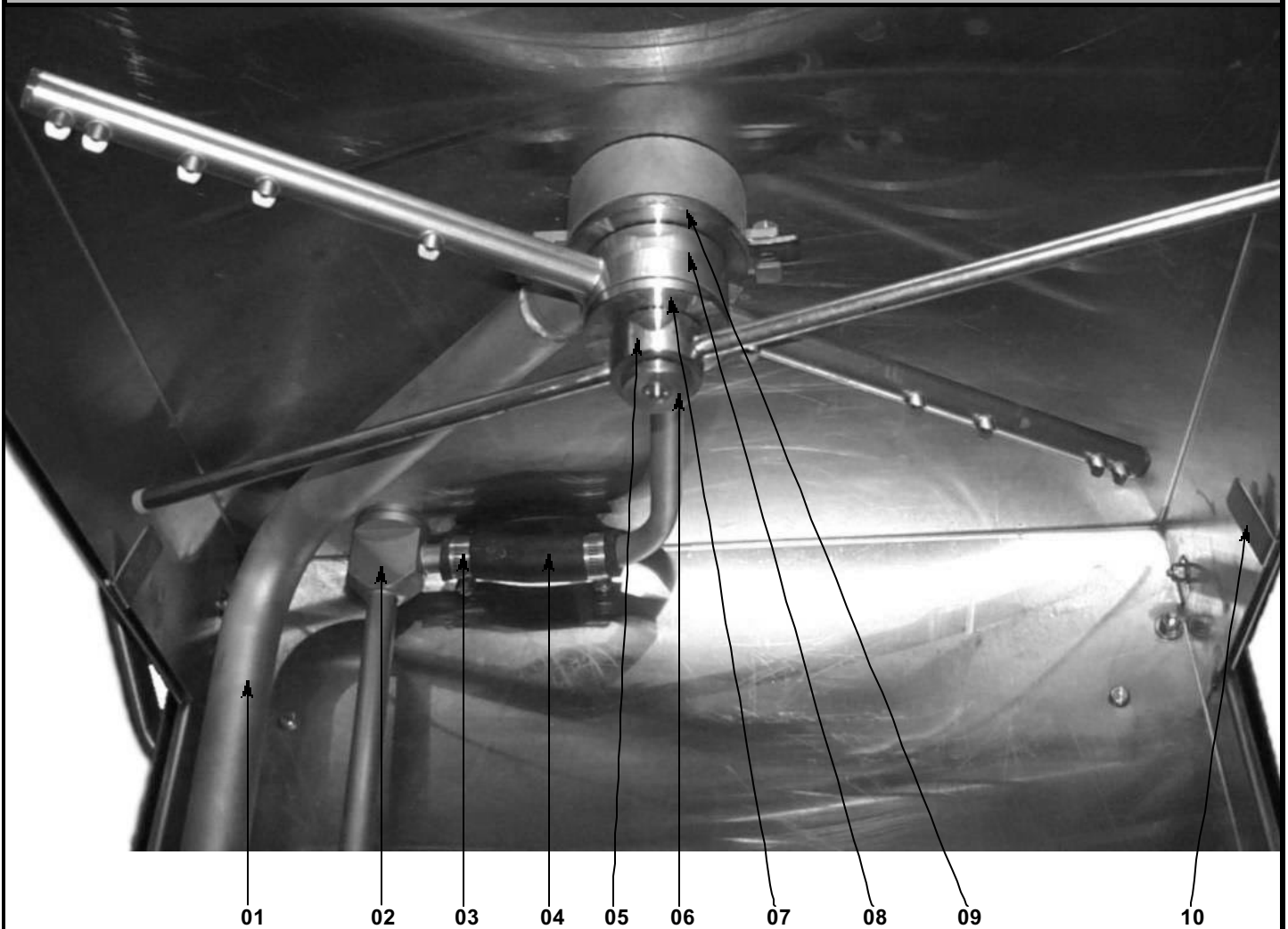

ITEM	QTY	DESCRIPTION	MFG NO.
01	1	Top Wash & Rinse Manifold Weld Assembly	5700-001-25-52
02	1	Bottom Wash & Rinse Manifold Weld Assembly	5700-001-25-53
03	2	Clamp, Hose Spring Clamp 1" Nom.	4730-719-02-37
04	1	Rinse Manifold Hose	5700-001-26-50
05	1	Rinse Arm Assembly	5700-021-41-98
06	1	Wash Head Cap	5700-021-41-92
07	1	Rinse Spindle, Machined	5700-031-41-89
08	1	Wash Arm Assembly	5700-021-42-00
09	1	Wash Spindle, Machined	5700-021-41-81
10	4	Door Stop	5700-021-38-88

# 200B INCOMING PLUMBING

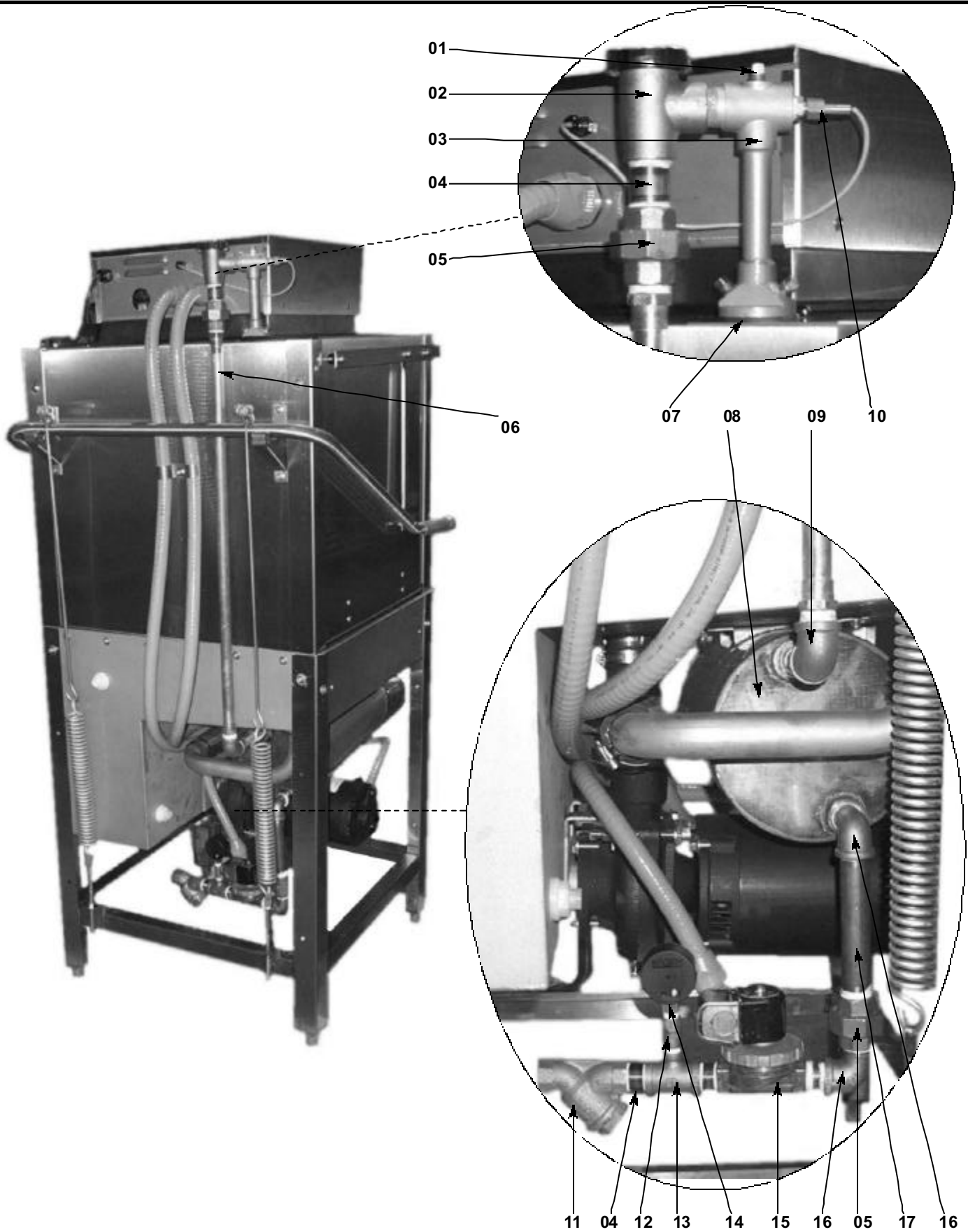

**200B INCOMING PLUMBING (CONTINUED)**

<b>ITEM</b>	<b>QTY</b>	<b>DESCRIPTION</b>	<b>MFG NO.</b>
01	3	Plug, 1/8" N.P.T. Brass	4730-209-07-37
02	1	Vacum Breaker, 3/4 (Alternate)	4820-300-08-00
03	1	Rinse Injector Assembly	5700-001-25-78
04	4	Nipple, Close Brass 3/4"	4730-207-34-00
05	2	Union, 3/4 Brass	4730-212-05-00
06	1	Tubing, Copper 3/4" X 29.375 Long	5700-011-82-29
07	2	Rinse Injector Gasket	5330-500-19-00
08	1	Booster, Rinse Tank Weldment	5700-001-22-02
09	1	Elbow, 3/4 90° Brass	4730-206-13-00
10	1	Thermometer, Led w/21 Probe, 4 SEC TD	6680-200-01-93
11	1	Strainer, Y - 3/4" Watts	4730-717-02-06
12	1	Ball Valve, Test Cock 1/4" Bronze	4810-011-72-67
13	1	Tee, Brass 3/4" X 3/4" X 1/4"	4730-211-04-00
14	1	Guage, 0-100 PSI 2 Pressure	6685-111-59-66
15	1	Solenoid Valve, 3/4" 24 Volt	4820-100-01-40
16	2	Elbow, 3/4" Street Brass	4730-206-04-34
17	1	Nipple, 3/4" Brass X 6" Long	5700-001-26-74

## 200/200LT INCOMING PLUMBING

The plumbing of the 200 NO BOOSTER has the same parts as the 200 BOOSTER plumbing except the parts indicated below, also minus the parts of the booster tank assembly.

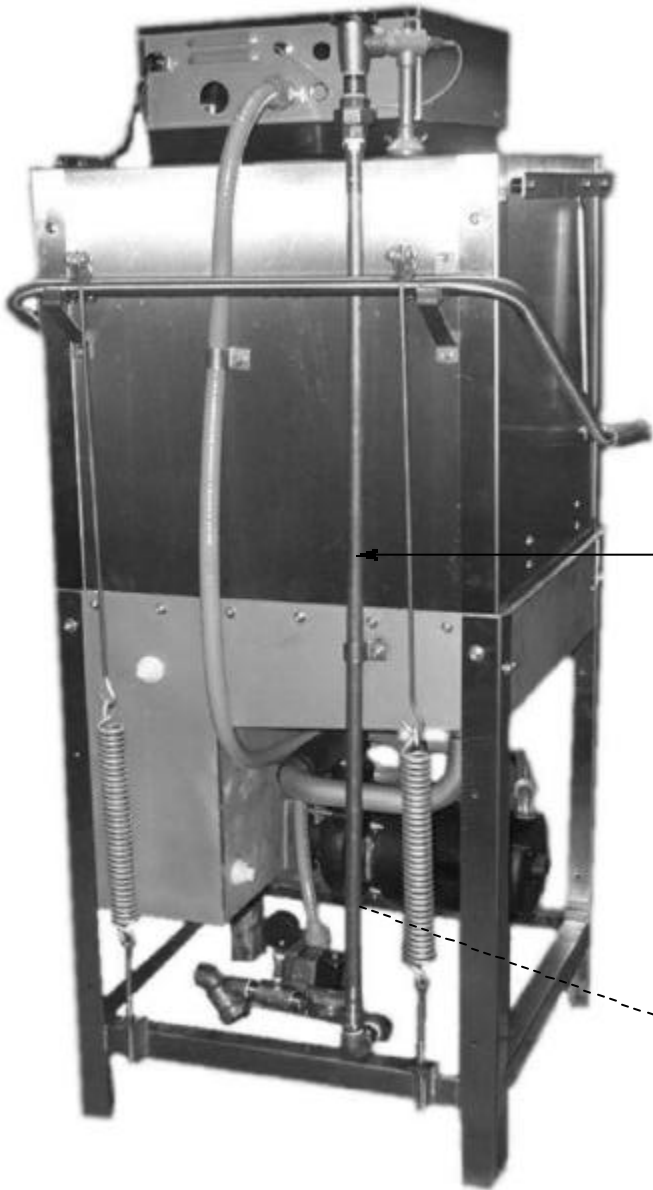

5700-011-65-25  
Copper Tube, 3/4" X 46-3/8" long

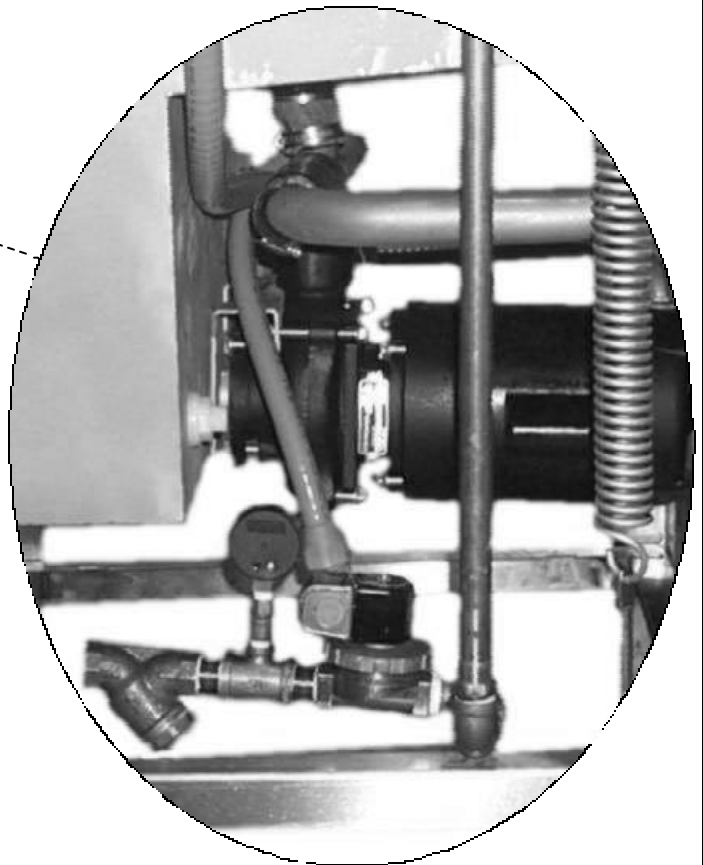

## SOLENOID VALVE REPAIR KITS (3/4", 24V)

ITEM	QTY	DESCRIPTION	MFG. NO.
01	1	Coil, 24 Volt	4810-100-06-18
02	1	Spring	4810-200-04-18
03	1	Plunger	4810-200-04-18
04	1	O-Ring	4810-100-10-18
05	1	Diaphragm Retainer	4810-100-10-18

Order the entire solenoid valve using part number 4810-100-03-18.

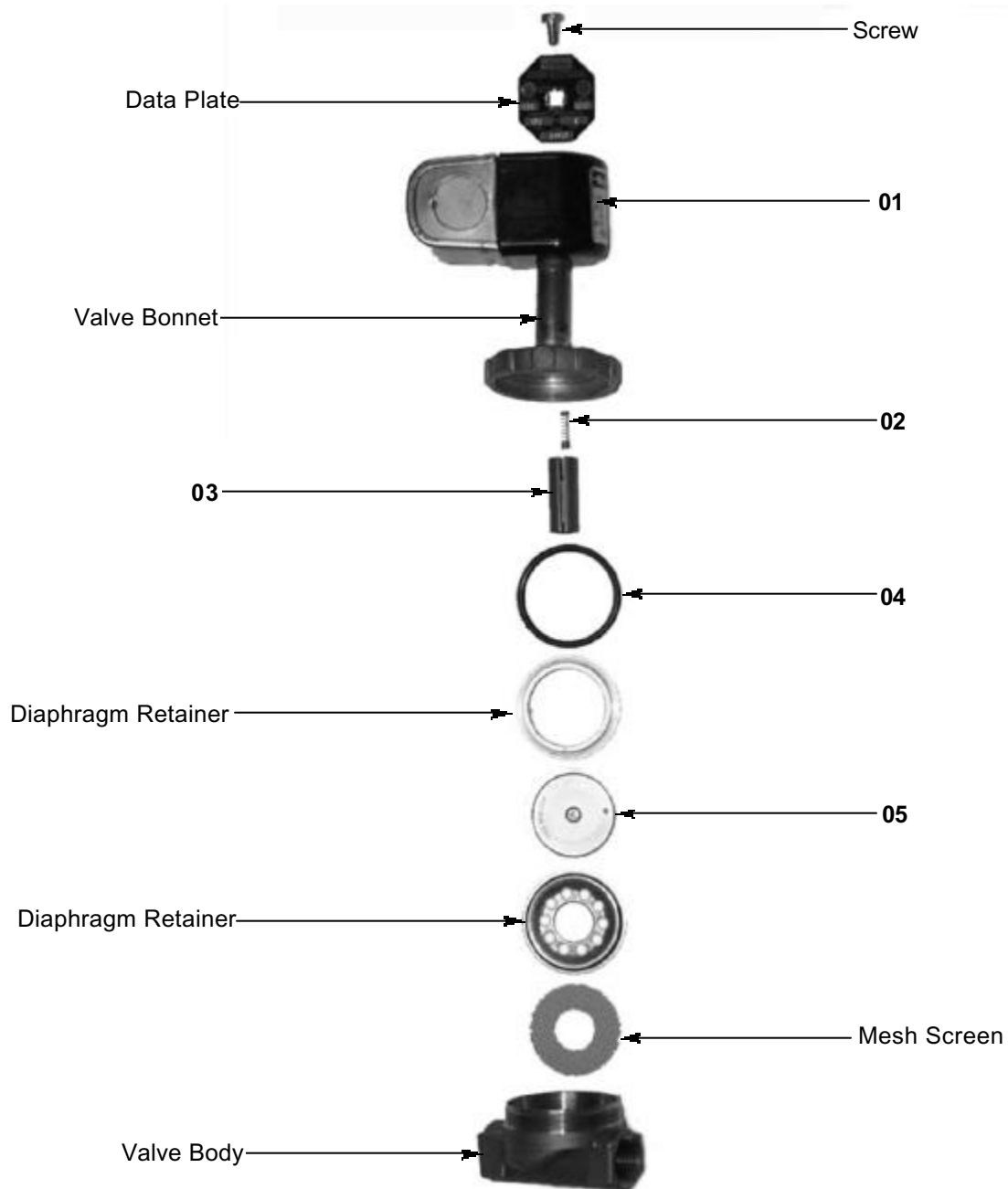

# VACUUM BREAKER REPAIR KIT (3/4" NPT)

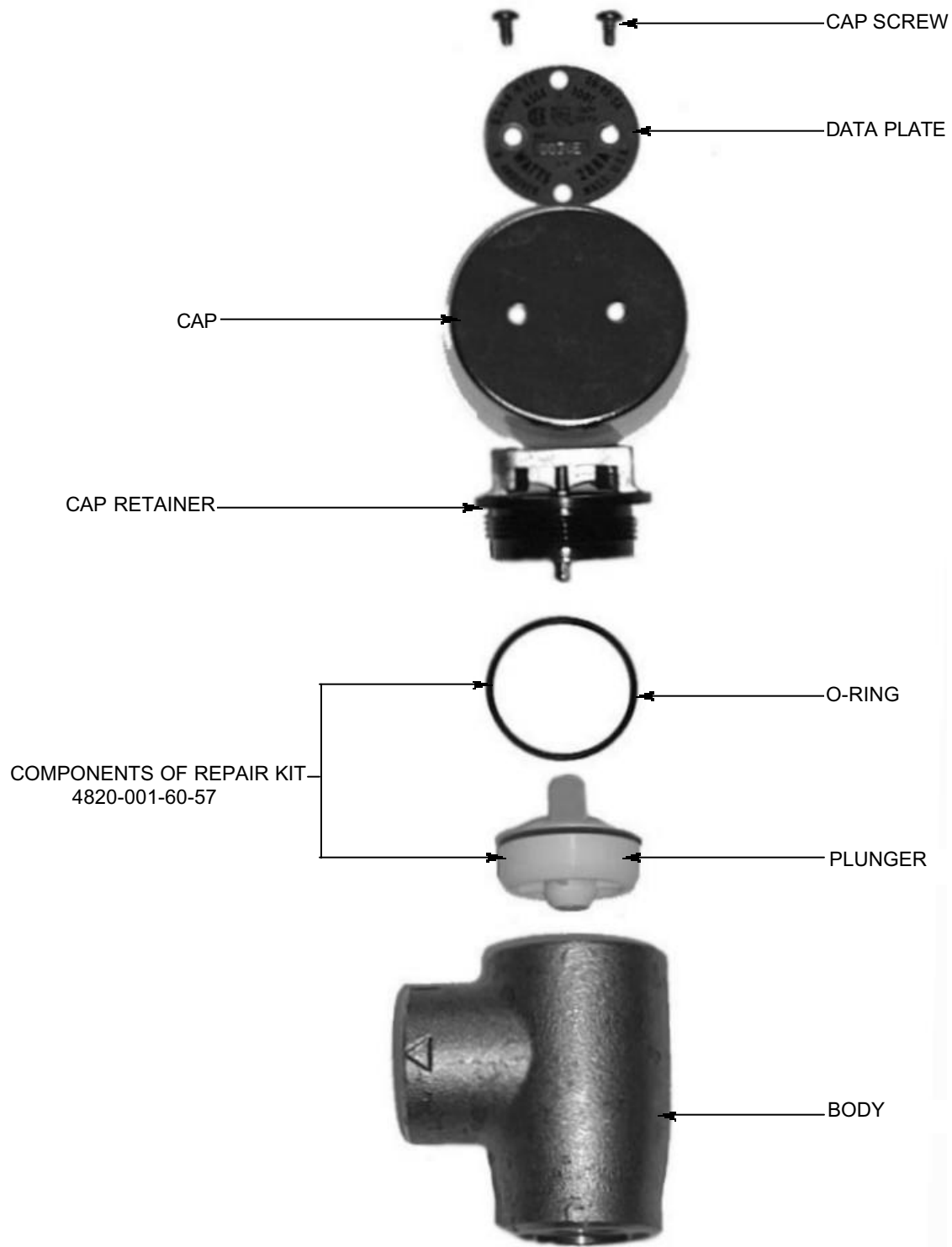

Order the entire assembly using part number 4820-300-08-00.

# BOOSTER TANK & MOTOR TO TUB

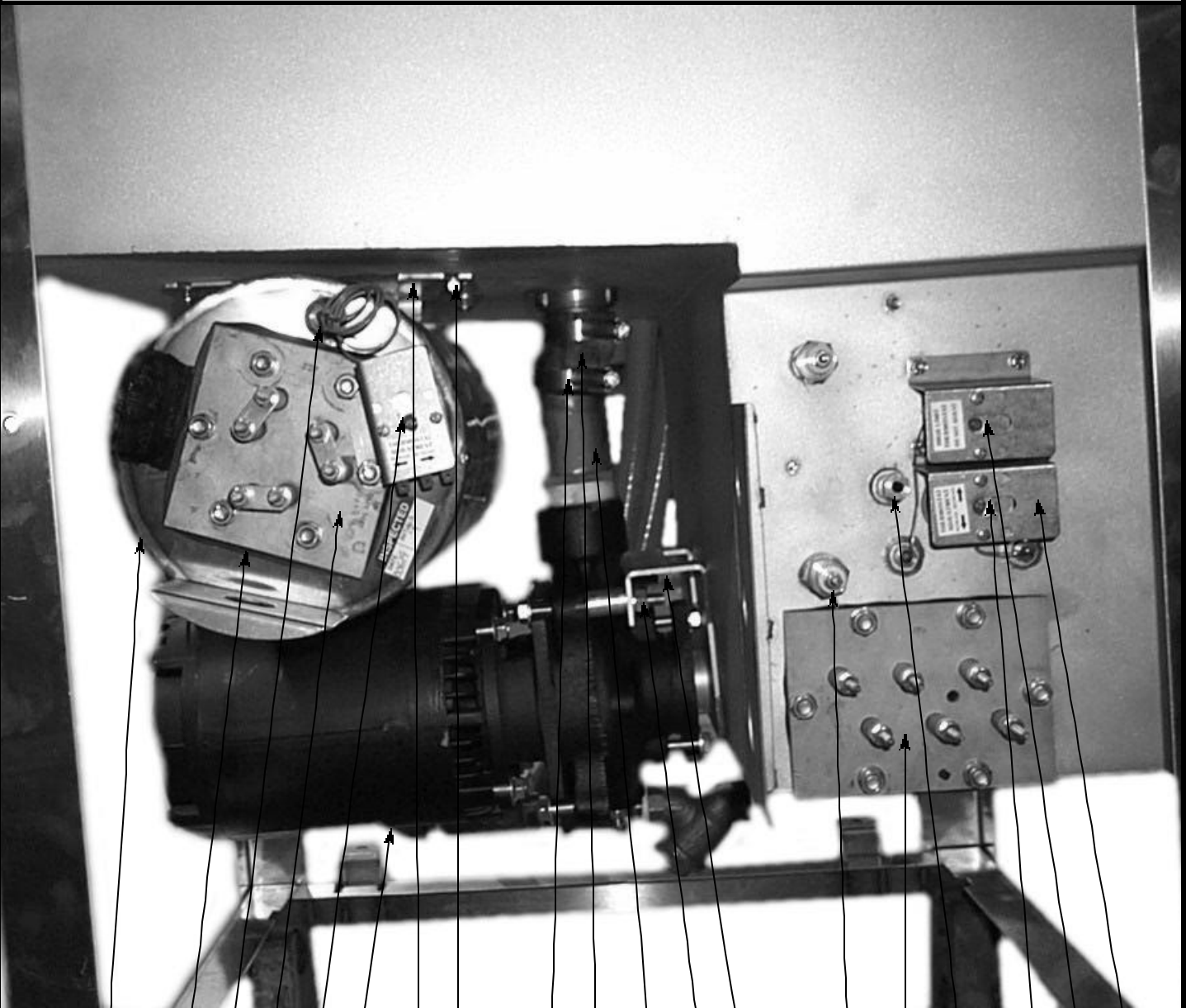

- 01
- 02
- 03
- 04
- 05
- 06
- 07
- 08
- 09
- 10
- 11
- 12
- 13
- 14
- 15
- 16
- 17
- 18
- 19

## BOOSTER TANK & MOTOR TO TUB (CONTINUED)

ITEM	QTY	DESCRIPTION	MFG NO.
01	1	Booster, Rinse Tank Weldment	5700-001-22-02
02	1	Heater Gasket	5330-200-02-70
03	3	Fitting, imperial Brass 1/4"	5310-924-02-05
04	1	Heater Bus Assembly 3 Phase	5700-001-29-10
04	1	Heater Bus Assembly 1 Phase	5700-001-29-07
05	1	Thermostat, Rinse 89 DEG (Not Shown)	5930-121-71-29
06	1	Pump Motor, Wash 208-230/460V/60HZ 3 Phase	6105-102-04-94
06	1	Pump Motor, Wash 208-230/115V/60HZ 1 Phase	6105-102-05-94
07	1	Booster Tank Mounting Bracket (Part of Tank Weldment)	5700-001-21-99
08	4	Locknut, 1/4"- 20 S/S Hex w/Nylon Insert	5310-374-01-00
08	4	Washer, 1/4" S/S	5311-174-01-00
09	4	Worm Hose Clamp, 2"	4730-719-01-37
10	1	Hose, Bottom Manifold Pump	5700-001-22-92
11	1	Tee, Discharge (Machined)	5700-001-21-46
12	2	Nut, Hex 3/8"- 16 S/S	5310-276-01-00
12	2	Washer, Lock 3/8" S/S	5311-276-01-00
13	1	Motor Mounting Bracket (Part of Tub Weldment)	5700-001-21-69
14	2	Probe, Water Level 3/8" NPT	6680-200-02-68
15	1	Heater, Wash 240V, 5300W FLG. Immersion	4540-100-02-15
15	1	Heater, Wash 480V, 5300W FLG. Immersion	4540-100-03-15
16	1	Union, Modified 1/4" (For Thermometer Led Probe)	5700-001-16-52
17	1	Thermostat, Wash Regulating 78 DEG	5930-121-67-72
18	1	Thermostat, High Limit 104 DEG	5930-121-71-30
19	3	Bracket, Thermostat	5700-011-73-72



# ORDERING WIRE REPLACEMENT

## ORDERING REPLACEMENT WIRE FOR YOUR DISHMACHINE

Jackson dishmachines have several color and gauges of wire used in them and it may become necessary to replace these wires. Wire may be ordered from Jackson MSC Inc., but please note that it is only available in feet. Ensure that you order the correct color and gauge.

### BLACK WIRE:

6 Gauge	6145-002-15-91
8 Gauge	6145-104-43-00
10 Gauge	6145-104-16-00
12 Gauge	6145-112-01-00
14 Gauge	6145-104-09-00
18 Gauge	6145-104-01-97
18 Gauge with Orange Stripes	6145-011-35-66
18 Gauge with White Stripes	6145-011-35-65
18 Gauge with Yellow Stripes	6145-011-35-64

### BLUE WIRE:

6 Gauge	6145-002-15-93
8 Gauge	6145-104-44-00
10 Gauge	6145-104-42-00
14 Gauge	6145-104-04-00
18 Gauge	6145-104-35-00
18 Gauge with Black Stripes	6145-011-46-35
18 Gauge with Red Stripes	6145-011-46-37
18 Gauge with White Stripes	6145-011-46-36
18 Gauge with Yellow Stripes	6145-011-46-38
20 Gauge	6145-104-06-97
20 Gauge with Black Stripes	6145-104-17-97
20 Gauge with White Stripes	6145-104-13-97

### GREEN WIRE:

8 Gauge	6145-002-15-94
14 Gauge	6145-104-03-00
18 Gauge	6145-104-32-00
18 Gauge with Yellow Stripes	6145-001-44-96
20 Gauge	6145-104-05-97
20 Gauge with Black Stripes	6145-011-59-57
20 Gauge with Yellow Stripes	6145-104-11-97

### GREY WIRE:

18 Gauge	6145-104-36-00
18 Gauge with Black Stripes	6145-011-81-71
18 Gauge with Blue Stripes	6145-011-81-72
18 Gauge with Red Stripes	6145-011-46-41
18 Gauge with White Stripes	6145-011-35-60
18 Gauge with Yellow Stripes	6145-011-46-42
20 Gauge	6145-104-03-97

### RED WIRE:

6 Gauge	6145-002-15-92
8 Gauge	6145-104-45-00
10 Gauge	6145-104-08-00
14 Gauge	6145-104-05-00
18 Gauge	6145-104-37-00
18 Gauge with Black Stripes	6145-011-59-56
18 Gauge with Blue Stripes	6145-011-81-74
18 Gauge with White Stripes	6145-011-81-73
18 Gauge with Yellow Stripes	6145-011-81-75
20 Gauge	6145-104-02-97

### WHITE WIRE:

10 Gauge	6145-104-19-00
14 Gauge	6145-104-10-00
18 Gauge	6145-104-39-00
18 Gauge with Black Stripes	6145-011-35-70
18 Gauge with Blue Stripes	6145-011-46-40
18 Gauge with Green Stripes	6145-011-35-69
18 Gauge with Grey Stripes	6145-002-20-18
18 Gauge with Red Stripes	6145-011-35-67
18 Gauge with Yellow Stripes	6145-011-35-68
20 Gauge	6145-104-04-97
20 Gauge with Orange & Yellow Stripes	6145-104-16-97
20 Gauge with Yellow Stripes	6145-104-15-97

### YELLOW WIRE:

18 Gauge	6145-104-33-00
18 Gauge with Black Stripes	6145-011-81-68
18 Gauge with Blue Stripes	6145-011-81-70
18 Gauge with Red Stripes	6145-011-81-69
20 Gauge	6145-104-07-97

## ORDERING REPLACEMENT WIRE (CONTINUED)/CONDUIT & FITTINGS

### MISCELLANEOUS WIRE:

Brown (18 Gauge)	6145-104-20-00
Brown (20 Gauge)	6145-104-08-97
Orange (18 Gauge)	6145-104-34-00
Orange with Black Stripes (18 Gauge)	6145-011-35-62
Orange with Blue Stripes (18 Gauge)	6145-011-46-39
Orange with White Stripes (18 Gauge)	6145-011-35-63
Orange with Yellow Stripes (18 Gauge)	6145-011-35-61
Orange (20 Gauge)	6145-104-10-97
Pink (18 Gauge)	6145-011-82-69
Purple (18 Gauge)	6145-104-31-00
Violet (20 Gauge)	6145-104-09-97
Plug, GFI	6145-001-97-90
Cable, 16 Gauge, 3 Wire Romex	6145-001-98-29
Cord, Hubble Plug MC	6145-011-47-23
Cord, S-J	6145-011-49-02
Cord, Power	6145-011-70-28
Cord, 115V Power	6145-309-02-00
Cord, 125V Power, 96 " Long	6145-309-04-00

### CONDUIT AND RELATED FITTINGS

Jackson dishmachines come with a wide variety of conduit and fittings for use in routing the wires of the machine. The list below provides for most of stock of such items. When ordering, remember that Jackson does not offer pre-cut sections of conduit for your machine, instead it is sold by the foot. Please take into account the slack that will be necessary once installing the new conduit to ensure that it fits correctly. It is recommended that you order at least 6" more conduit than you require to ensure that you have enough for trimming.

### CONDUIT:

Conduit, 1/2", Liquidtite	5975-101-25-00	Fitting, 1", 90 Degree	5975-011-68-43
Conduit, 1/2", Non-Metallic	5975-111-46-57	Fitting, Cole-Flex, 1/2" Straight	5975-205-03-00
Conduit, 1/2", PVC	5975-105-04-00	Fitting, Cole-Flex, 3/4" Straight	5975-205-41-00
Conduit, 1/2", Sealitite	5975-105-01-00	Fitting, Cole-Flex, 3/4", 90 Degree	5975-204-42-00
Conduit, 1/2", Xtraflex	5975-105-06-44	Fitting, Liquidtite, .231 ID/.394 OD	5975-011-49-03
Conduit, 3/8", Liquidtite	5975-105-02-00	Fitting, Liquidtite, .25 ID/.546 OD	5975-011-65-51
Conduit, 3/4", Cole-Flex	5975-105-05-00	Fitting, Liquidtite, .27 ID/.48 OD	5975-011-59-50
Conduit, 3/4", Liquidtite	5975-105-03-00	Fitting, Liquidtite, 1/2", 90 Degree	5975-111-01-00
Conduit, 3/4", Non-Metallic	5975-011-47-71	Fitting, Liquidtite, 3/8", Straight	5975-205-03-82
Conduit, 3/4" Xtraflex	5975-105-07-44	Fitting, Liquidtite, 3/8", 90 Degree	5975-205-02-82
Conduit, 1", Carlon	5975-011-68-42	Fitting, Liquidtite, 3/4", Straight	5975-205-15-02
		Fitting, Liquidtite, 3/4", 45 Degree	5975-205-01-82
		Fitting, Liquidtite, 3/4", 90 Degree	5975-205-07-82
		Fitting, Xtraflex, 1/2", Straight	5975-205-47-44
		Fitting, Xtraflex, 3/4", Straight	5975-205-46-44
		Nut, 1-1/4"	5975-011-42-54

### CONDUIT FITTINGS:

Elbow, Cole-Flex, 1/2", 90 Degree	5975-205-40-00
Elbow, Xtraflex, 1/2", 90 Degree	5975-205-44-44
Elbow, Xtraflex, 3/4", 90 Degree	5975-205-45-44
Fitting, 1/2" Straight	5975-011-45-13
Fitting, 1/2", Straight, Zinc Plated	5975-111-89-89
Fitting, 1/2", 45 Degree	5975-011-45-23
Fitting, 1/2", 45 Degree, Zinc Plated	5975-111-89-86
Fitting, 1/2", 90 Degree	5975-011-45-14
Fitting, 1/2", 90 Degree, Zinc Plated	5975-111-89-88
Fitting, 3/4", Straight	5975-011-47-72
Fitting, 3/4", 45 Degree	5975-011-47-74
Fitting, 3/4", 90 Degree	5975-011-47-73
Fitting, 1", Straight	5975-011-70-75

## ORDERING REPLACEMENT FASTENERS

Dishmachines come with a variety of fasteners used to hold them together. On the following pages will be comprehensive list of all of the fasteners you may order. Jackson reserves the right to require minimum quantities to be ordered.

### **SCREWS:**

Screw, 1/4"-20 x 1/4", Set	5305-002-10-14
Screw, 1/4"-20 x 1/2", Phillips Truss Head	5305-174-03-00
Screw, 1/4"-20 x 1/2", Set Screw	5305-011-71-51
Screw, 1/4"-20 x 1/2", Slotted Truss Head	5305-002-22-81
Screw, 1/4"-20 x 1/2", Thumb	5305-011-38-62
Screw, 1/4"-20 x 1/2", with Rubber Washer	5305-974-01-00
Screw, 1/4"-20 x 5/8", 80 Deg. CSink	5305-002-20-30
Screw, 1/4"-20 x 5/8", Hex Head	5305-274-24-00
Screw, 1/4"-20 x 5/8", Phillips Truss Head	5305-174-04-00
Screw, 1/4"-20 x 1-1/8", Hex Head	5305-274-21-00
Screw, 1/4"-20 x 1-1/4", Flat Head	5305-174-19-00
Screw, 1/4"-20 x 1-3/8", Hex Head	5305-274-19-00
Screw, 1/4"-20 x 1-1/2", Flat Head	5305-174-11-00
Screw, 1/4"-20 x 1-1/2", Hex Head	5305-274-23-00
Screw, 1/4"-20 x 1-1/2", Phillips Head	5305-011-44-50
Screw, 1/4"-20 x 1-1/2", Slotted Truss Hd	5305-002-22-82
Screw, 1/4"-20 x 1-3/4", Hex Head	5305-274-10-00
Screw, 1/4"-20 x 3-3/4", Hex Head	5305-011-93-68
Screw, 5/16"-18 x 1/2", Hex Head	5306-011-88-67
Screw, 5/16"-18 x 1-1/4", Flat Head	5305-011-83-49
Screw, 3/8"-16 x 1", Socket Head	5305-356-04-00
Screw, 3/8"-16 x 1-1/4", Hex Head Plated	5305-256-04-00
Screw, 3/8"-16 x 2", Cap	5305-011-74-98
Screw, 4-40 x 1/4", Phillips Pan Head	5305-011-36-92
Screw, 4-40 x 3/8", Phillips Truss Head	5305-011-59-70
Screw, 4-40 x 1/2" Phillips Pan Head	5305-011-38-19
Screw, 4-40 x 5/8" Phillips Truss Head	5305-011-49-70
Screw, 4-40 x 3/4", Phillips Pan Head	5305-011-59-64
Screw, 4-40 x 1", Slotted Pan Head	5305-179-01-00
Screw, 6-32 x 1/4", Flat Head	5305-171-01-00
Screw, 6-32 x 1/4", Round Head	5305-151-02-00
Screw, 6-32 x 1/2", Phillips Head	5305-171-15-00
Screw, 6-32 x 1/2", Phillips Truss Head	5305-011-39-34
Screw, 6-32 x 3/8", Phillips Head	5305-171-02-00
Screw, 6-32 x 3/8", Phillips Round Head	5305-171-07-00
Screw, 6-32 x 5/8", Phillips Round Head	5305-011-39-85
Screw, 6-32 x 3/4", Round Head	5305-171-03-00
Screw, 6-32 x 3/4", Phillips Pan Head	5305-011-37-05
Screw, 6-32 x 7/8", Phillips Round Head	5305-171-10-00
Screw, 8-32 x 1/4", Phillips Pan Head	5305-172-09-00
Screw, 8-32 x 1/4", Slotted Round Head	5305-172-01-00
Screw, 8-32 x 3/8", Phillips Flat Head	5305-776-03-00
Screw, 8-32 x 3/8", Phillips Flat Head	5305-011-37-07
Screw, 8-32 x 3/8", Round Head	5305-172-02-00
Screw, 8-32 x 1/2", Hex Head	5305-002-02-87
Screw, 8-32 x 1/2", Phillips Flat Head	5305-011-37-06
Screw, 8-32 x 3/4", Phillips Round Head	5305-172-06-00
Screw, 10-24 x 3/8", Flat Head Undercut	5305-773-02-00
Screw, 10-24 x 3/8", Phillips Truss Head	5305-173-03-00
Screw, 10-24 x 1/2", Phillips Truss Head	5305-173-18-00
Screw, 10-24 x 1/2", Set	5305-473-02-00
Screw, 10-24 x 5/8", Hex Head	5305-011-40-89
Screw, 10-24 x 3/4", Hex Head	5305-273-05-00
Screw, 10-24 x 2-1/4", Hex Head	5305-011-38-10
Screw, 10-32 x 1/4", Round Head	5305-173-01-00
Screw, 10-32 x 3/8", Phillips Pan Head	5305-173-26-00
Screw, 10-32 x 3/8", Phillips Truss Head	5305-173-12-00
Screw, 10-32 x 3/8", Round Head, Slotted	5305-173-02-00

Screw, 10-32 x 1/2", Phillips Flat Head	5305-011-44-51
Screw, 10-32 x 1/2", Phillips Pan Head	5305-011-44-52
Screw, 10-32 x 1/2", Phillips Truss Head	5305-011-39-36
Screw, 10-32 x 1/2", Self Tapping	5305-011-62-69
Screw, 10-32 x 1/2", Slotted Truss	5305-173-04-00
Screw, 10-32 x 5/8", Fillister Head	5305-973-02-00
Screw, 10-32 x 3/4", Shoulder, .25 Shoulder	5305-011-86-65
Screw, 10-32 x 3/4", Phillips Truss Head	5305-011-62-17
Screw, 10-32 x 3/4", Phillips Truss Head	5305-011-49-33
Screw, 10-32 x 7/8", Fillister Head	5305-973-04-00
Screw, 10-32 x 7/8", Hex Head	5305-279-01-00
Screw, 10-32 x 1", Phillips Pan Head	5305-002-19-42
Screw, 10-32 x 1-1/8" Fillister Head	5305-973-03-00
Screw, 10-32 x 1-1/4", Phillips Truss Head	5305-011-66-03
Screw, 10-32 x 1-1/4", Socket Head	5305-356-16-00
Screw, 10-32 x 1-1/2", Fillister Head	5305-973-01-00
Screw, 10-32 x 1-3/4", Phillips Pan Head	5305-011-62-67
Screw, 10-32 x 1-3/4", Self Tapping	5305-011-59-92

### **BOLTS:**

Bolt, 1/4"-20 x 3/8", Hex Head	5305-274-20-00
Bolt, 1/4"-20 x 1/2", Hex Head	5305-274-02-00
Bolt, 1/4"-20 x 3/4", Hex Head	5305-274-04-00
Bolt, 1/4"-20 x 7/8", Hex Head	5305-274-05-00
Bolt, 1/4"-20 x 1", Hex Head	5305-254-06-00
Bolt, 1/4"-20 x 1-1/4", Hex Head	5305-274-22-00
Bolt, 1/4"-20 x 2", Hex Head	5306-011-84-72
Bolt, 1/4"-20 x 2-1/4", Hex Head	5305-011-30-50
Bolt, 1/4"-20 x 2-1/2", Hex Head	5306-011-83-52
Bolt, 1/4"-20 x 2-3/4", Hex Head	5306-011-46-62
Bolt, 1/4"-20 x 3-1/4", Hex Head	5306-002-05-55
Bolt, 5/16"-18 x 5/8", Hex Head	5305-275-09-00
Bolt, 5/16"-18 x 3/4", Hex Head	5305-275-04-00
Bolt, 5/16"-18 x 1", Hex Head	5305-275-06-00
Bolt, 5/16"-18 x 1-1/4", Hex Head	5305-275-10-00
Bolt, 3/8"-16 x 3/4", Hex Head	5306-011-71-60
Bolt, 3/8"-16 x 7/8", Hex Head	5306-011-36-95
Bolt, 3/8"-16 x 1", Hex Head	5305-276-03-00
Bolt, 3/8"-16 x 1", Hex Head, Plated	5305-256-03-00
Bolt, 3/8"-16 x 1-1/4", Hex Head	5305-276-10-00
Bolt, 3/8"-16 x 1-3/4", Hex Head	5306-011-36-94
Bolt, 3/8"-16 x 2-1/4", Hex Head	5306-011-95-12
Bolt, 3/8"-16 x 2-3/4", U-Bolt	5306-011-51-34
Bolt, 3/8"-16 x 4", Hex Head	5306-956-02-00
Bolt, 1/2"-13 x 1-3/4"	5305-011-71-94
Bolt, 10-24 x 3/8", Hex Head	5306-011-63-29
Bolt, 10-32 x 3/8"	5306-011-62-45

## ORDERING REPLACEMENT FASTENERS (CONTINUED)

### LOCKWASHERS:

Lockwasher, 1/4", Split	5311-274-01-00
Lockwasher, 3/8", Split	5311-276-01-00
Lockwasher, 3/8", Split	5311-256-01-00
Lockwasher, 5/8"	5311-278-02-00
Lockwasher, 5/16", Split	5311-275-01-00
Lockwasher, 5/16", Split, Cad Plated	5311-255-01-00
Lockwasher, #4, External Tooth	5311-011-59-70
Lockwasher, #6 External Tooth	5311-271-02-00
Lockwasher, #8	5311-272-02-00
Lockwasher, #8, External Tooth	5311-272-01-00
Lockwasher, #8, Internal Tooth	5311-272-03-00
Lockwasher, #10, External Tooth	5311-273-02-00
Lockwasher, #10, Internal Tooth	5311-273-03-00
Lockwasher, #10, Split	5311-273-01-00

### FLAT WASHERS:

Washer, Flat, Brass, 3/32" ID	5311-129-08-00
Washer, Flat, Brass, 1/4" ID	5311-129-09-00
Washer, 1/4" ID x 3/4" OD	5311-011-76-30
Washer, Flat, 5/16" ID	5311-175-01-00
Washer, Flat, Brass, 5/16", Cadplated	5311-156-01-00
Washer, Flat, S/S, 3/8" ID	5311-176-01-00
Washer, 3/8" ID x 9/16" OD	5311-011-71-49
Washer, 1/2" ID x 1" OD x 1/8" Thick	5311-011-71-48
Washer, 1/2" ID x 1-5/16" OD, Cadplated	5311-157-01-00
Washer, Nylon, .51" ID x .76" OD	5311-011-62-65
Washer, Flat, S/S, 11/16 " ID x 1/2" OD	5311-178-01-00
Washer, 7/8" ID x 1-1/2" OD	5311-011-35-37
Washer, Flat, 1/4" ID	5311-174-01-00
Washer, Flat, #10	5311-173-02-00

### LOCKNUTS:

Locknut, 1/4"-20 with Nylon, High Profile	5310-374-01-00
Locknut, 1/4"-20 with Nylon, Low Profile	5310-374-02-00
Locknut, 5/16"-24 with Nylon, High Profile	5310-375-01-00
Locknut, 5/16"-24 with Nylon, Low Profile	5310-374-03-00
Locknut, 3/8"-16, with Nylon, High Profile	5310-011-72-55
Locknut, 3/8"-16, with Nylon, Low Profile	5310-376-02-00
Locknut, 4-40, with Nylon	5310-279-06-00
Locknut, 6-32, with Nylon	5310-373-03-00
Locknut, 10-24, with Nylon	5310-373-01-00
Locknut, 10-32, with Nylon	5310-373-02-00

### HEX NUTS:

Nut, Hex, 1/4"-20	5310-274-01-00
Nut, Hex, 1/4"-20, Cad Plated	5310-254-01-00
Nut, Hex, 5/16"-18	5310-275-01-00
Nut, Hex, 5/16"-18, Cad Plated	5310-255-01-00
Nut, Hex, 3/8"-16	5310-276-02-00
Nut, Hex, 3/8"-16, Cad Plated	5310-256-02-00
Nut, Hex, 1/2"-13	5310-011-72-58
Nut, Hex, 6-32	5310-271-01-00
Nut, Hex, 8-32	5310-272-01-00
Nut, Hex, 10-24	5310-273-02-00
Nut, Hex, 10-32	5310-273-01-00

### MISCELLANEOUS NUTS:

Nut, 1/4"-20, Acorn	5310-174-01-00
Nut, 1/4"-20, Hex, Serrated	5310-011-66-49
Nut, 1/4"-20, Wing, Nylon	5310-994-01-00
Nut, 5/16"-18, Keps	5310-955-01-00
Nut, 5/8"-18, Brass	5310-228-01-11
Nut, 6-32, Keps	5310-002-24-29
Nut, 10-24, Hex Cap	5310-173-01-00
Nut, 10-24, Wing, Nylon	5310-993-01-00

# JACKSON MAINTENANCE & REPAIR CENTERS (USA)

## ALABAMA

### **Jones-McLeod Appliance**

1616 7th Avenue North  
Birmingham, AL 35203  
(205) 251-0159  
(800) 821-1150  
(205) 322-1440 fax

### **Jones-McLeod Appliance**

854 Lakeside Drive  
Mobile, AL 36693  
(334) 666-7278  
(800) 237-9859  
(334) 661-0223 fax

## ALASKA

### **Restaurant Appliance Service**

7219 Roosevelt Way NE  
Seattle, WA 98115  
(206) 524-8200  
(800) 433-9390  
(206) 525-2890 fax

## ARIZONA

### **GCS Service, Inc. #78**

5052 South 40th Street  
Phoenix, AZ 85040  
(602) 474-4510  
(800) 510-3497  
(602) 470-4511 fax

### **Authorized Commercial Food Equipment Service**

4832 South 35th St.  
Phoenix, AZ 85040  
(602) 234-2443  
(800) 824-8875  
(602) 232-5862 fax

## ARKANSAS

### **Bromely Parts & Service**

10th & Ringo  
P.O. Box 1688  
Little Rock, AR 72202  
(501) 374-0281  
(800) 482-9269  
(501) 374-8352 fax

### **Commercial Parts & Service**

3717 Cherry Road  
Memphis, TN 38118  
(901) 366-4587  
(800) 262-9155  
(901) 366-4588 fax

## CALIFORNIA

### **P & D Appliance**

4220-C Roseville Road  
North Highlands, CA 95660  
(916) 974-2772  
(800) 824-7219  
(916) 974-2774

## CALIFORNIA (cont)

### **P & D Appliance**

100 South Linden Avenue  
S. San Francisco, CA 94080  
(650) 635-1900  
(800) 424-1414  
(650) 635-1919 fax

### **Barkers Food Machinery Equipment**

5367 Second Street  
Irwindale, CA 91706  
(626) 960-9390  
(800) 258-6999  
(626) 337-4541 fax

### **GCS Service, Inc. #24**

1100 East Pico Blvd  
Los Angeles, CA 90021  
(213) 683-2090  
(800) 327-1433  
(213) 683-2099 fax

### **GCS Service, Inc. #24**

650 S. Grand Avenue  
Suite 111  
Santa Ana, CA 92705  
(714) 542-1798  
(800) 540-0719  
(714) 542-4787 fax

### **GCS Service, Inc. #52**

360 Littlefield  
S. San Francisco, CA 94080  
(650) 635-0720  
(800) 969-4427  
(650) 871-4019 fax

### **GCS Service, Inc. # 84**

9030 Kenamar Drive  
Suite 313  
San Diego, CA 92121  
(858) 549-8411  
(800) 422-7278  
(858) 549-2323 fax

## COLORADO

### **GCS Service, Inc. #60**

4251 S. Natches Ct.  
Unit C  
Sheridan, Co 80110  
(303) 371-9054  
(800) 972-5314

### **Metro Appliance Service**

1640 South Broadway  
Denver, CO 80210  
(303) 778-1126  
(800) 525-3532  
(303) 778-0268 fax

## CONNECTICUT

### **GCS Service, Inc. #06**

302 Murphy Road  
Hartford, CT 06114  
(860) 549-5575  
(800) 423-1562  
(860) 527-6355 fax

## DELAWARE

### **Food Service Equipment**

2101 Parkway South  
Broomall, PA 19008  
(610) 356-6900  
(610) 356-2038 fax

### **GCS Service, Inc. #44**

817 N. Third Street  
P.O. Box 3564  
Philadelphia, PA 19123  
(215) 925-6217  
(800) 441-9115  
(215) 925-6208 fax

### **Elmer Schultz Service**

36 Belmont Ave.  
Wilmington, DE 19804  
(302) 655-8900  
(800) 225-0599  
(302) 656-3673 fax

### **EMR Service Division**

106 Willamsport Circle  
Salisbury, MD 21804  
(410) 543-8197  
(410) 543-4038 fax

## FLORIDA

### **GCS Service, Inc. #15**

3373 N. W. 168th Street  
Miami, FL 33056  
(305) 621-6666  
(800) 766-8966  
(305) 621-6656 fax

### **Commercial Appliance Service**

8416 Laurel Fair Circle  
Building 6, Suite 114  
Tampa, FL 33610  
(813) 663-0313  
(800) 282-4718  
(813) 663-0212 fax

### **GCS Service, Inc. #14**

3902 Corporex Park Drive  
Suite 350  
Tampa, FL 33619  
(813) 626-6044  
(800) 282-3008  
(813) 621-1174

# JACKSON MAINTENANCE & REPAIR CENTERS (USA)

## FLORIDA (cont)

### **GCS Service, Inc. # 13**

4305 Vineland Road  
Suite G-12  
Orlando, FL 32811  
(407) 841-2551  
(800) 338-7322  
(407) 423-8425 fax

### **Jones-McLeod Appliance**

854 Lakeside Drive  
Mobile, AL 36693  
(334) 666-7278  
(800) 237-9859  
(334) 661-0223 fax

## GEORGIA

### **GCS Service, Inc. #16**

3127 Presidential Dr.  
Atlanta, GA 30340  
(770) 452-7322  
(300) 334-3599  
(770) 452-7473 fax

### **Southeastern**

#### **Restaurant Service**

2200 Norcross Pkwy,  
Suite 210  
Norcross, GA 30071  
(770) 446-6177  
(800) 235-6516  
(770) 446-3157 fax

### **Whaley Foodservice Repairs**

109-A Owens Industrial Drive  
Savannah, GA 31405  
(912) 447-0827  
(888) 765-0036  
(912) 447-0826 fax

## HAWAII

### **Food Equipment Parts & Service Co.**

300 Puuhale Road  
Honolulu, HI 96819  
(808) 847-4871  
(808) 842-1560 fax

## IDAHO

### **Ron's Service**

703 E. 44th Street, Suite 10  
Garden City, ID 83714  
(208) 375-4073  
(208) 375-4402 fax

### **Restaurant Appliance Service**

7219 Roosevelt Way Ne  
Seattle, WA 98115  
(206) 524-8200  
(800) 433-9390  
(206) 525-2890 fax

## ILLINOIS

### **GCS Service Inc. #12**

696 Larch Avenue  
Elmhurst, IL 60126  
(630) 941-7800  
(800) 942-9689  
(630) 941-6048 fax

### **Cone's Repair Service**

2408 40th Avenue  
Moline, IL 61265  
(309) 797-5323  
(800) 716-7070  
(309) 797-3631 fax

### **Eichenauer Services, Inc.**

130 S. Oakland Street  
Decatur, IL 62522  
(217) 429-4229  
(800) 252-5892  
(217) 429-0226 fax

### **GCS Service, Inc. #80**

9722 Reavis Park Drive  
St. Louis, MO 63123  
(314) 638-7444  
(800) 284-4427  
(314) 638-0135 fax

## INDIANA

### **Commercial Parts and Service**

5310 E. 25th Street  
Indianapolis, IN 46218  
(317) 545-9655  
(800) 727-8710  
(317) 549-6286 fax

## IOWA

### **Goodwin-Tucker Group**

3509 Delaware Avenue  
Des Moines, IA 50313  
(515) 262-9308  
(800) 372-6066  
(515) 262-2936 fax

### **Cone's Repair Service**

1056 27th Ave. SW  
Cedar Rapids, IA 52404  
(319) 365-3325  
(800) 747-3326  
(319) 365-0885 fax

## KANSAS

### **GCS Service Inc. #82**

6107 Connecticut  
Kansas City, MO 64120  
(816) 920-5999  
(800) 229-6477  
(816) 920-7387 fax

## KENTUCKY

### **Certified Service Center**

Ramco Business Park  
4283 Produce Road  
Louisville, Ky 40218  
(502) 964-7007  
(800) 637-6350  
(502) 964-7202 fax

### **Commercial Parts & Service**

4204 South Brook Street  
Louisville, KY 40214  
(502) 367-1788  
(800) 752-6160  
(502) 367-0400 fax

### **Certified Service Center**

1051 Goodwin Drive  
Lexington, KY 40505  
(606) 254-8854  
(800) 432-9269  
(606) 231-7781 fax

### **Commercial Parts & Service**

1002 Nandino Blvd.  
Lexington, KY 40511  
(606) 255-0746  
(800) 432-9260  
(606) 255-0748 fax

## LOUISIANA

### **Bana Parts, Inc.**

1501 Kueble Street  
Harahan, LA 70123  
(504) 734-0076  
(800) 325-7543  
(504) 734-8456 fax

### **Bana Parts, Inc.**

4028 Greenwood Road  
Shreveport, LA 71109  
(318) 631-6550  
(800) 832-6550  
(318) 636-5675 fax

## MAINE

### **GCS Service, Inc. #09**

180 Second Street  
Chelsea, MA 02150  
(617) 889-9393  
(800) 225-1155  
(617) 889-1222 fax

### **Massachusetts Restaurant Supply**

34 South Street  
Somerville, MA 02143  
(617) 868-1930  
(800) 338-6737  
(617) 868-5331 fax

# JACKSON MAINTENANCE & REPAIR CENTERS (USA)

## MARYLAND

**GCS Service, Inc. #07**  
2660 Pittman Drive  
Silver Spring, MD 20910  
(301) 585-7550 (DC)  
(410) 792-0388 (Balt)  
(800) 638-7278  
(301) 495-4410 fax

**EMR Service Division**  
700 East 25th Street  
Baltimore, MD 21218  
(410) 467-8080  
(800) 879-4994  
(410) 467-4191 fax

**EMR Service Division**  
106 Willamsport Circle  
Salisbury, MD 21804  
(410) 543-8197  
(888) 687-8080  
(410) 548-4038 fax

**EMR Service Division**  
2626 Pittman Drive  
Silver Spring, MD 20910  
(301) 588-8080  
(800) 348-2365  
(301) 588-6985 fax

## MASSACHUSETTS

**GCS Service, Inc. #09**  
180 Second Street  
Chelsea, MA 02150  
(617) 889-9393  
(800) 225-1155  
(617) 889-1222 fax

**Massachusetts Restaurant Supply**  
34 South Street  
Somerville, MA 02143  
(617) 868-1930  
(800) 338-6737  
(617) 868-5331 fax

**Ace Service Co.**  
95 Hampton Avenue  
Needham, MA 02494  
(781) 449-4220  
(800) 225-4510 MA & NH  
(781) 444-4789 fax

**GCS Service, Inc. #06**  
302 Murphy Road  
Hartford, CT 06114  
(860) 549-5575  
(800) 723-1562  
(860) 527-6355 fax

## MICHIGAN

**GCS Service, Inc. #20**  
31829 West Eight Mile Road  
Livonia, MI 48152  
(248) 426-9500  
(800) 772-2936  
(248) 426-7555 fax

**GCS Service, Inc. #21**  
3516 Roger B Chaffe SE  
Grand Rapids, MI 49548  
(248) 426-9500  
(800) 772-2936  
(248) 426-7555 fax

**Jackson Service**  
3980 Benstein Road  
Commerce Township, MI 48382  
(248) 363-4159  
(800) 332-4053  
(248) 363-5448 fax

## MINNESOTA

**GCS/Metro Service, Inc.**  
2857 Louisiana Avenue N.  
Minneapolis, MN 55427  
(612) 546-4221  
(800) 345-4221  
(612) 546-4286 fax

## MISSISSIPPI

**Commercial Parts & Service**  
5755 Gallant Drive  
Jackson, MS 39206  
(601) 956-7800  
(800) 274-5954  
(601) 956-1200 fax

**Commercial Parts & Service**  
3717 Cherry Road  
Memphis, TN 38118  
(901) 366-4587  
(800) 262-9155  
(901) 366-4588 fax

## MISSOURI

**GCS Service, Inc. #82**  
6107 Connecticut  
Kansas City, MO 64120  
(816) 920-5999  
(800) 229-6477  
(816) 920-7387 fax

**GCS Service, Inc. # 80**  
9722 Reavis Park Drive  
St. Louis, MO 63123  
(314) 638-7444  
(800) 284-4427  
(314) 638-0135 fax

## MISSOURI (cont)

**Kammerlin Parts & Service**  
2728 Locust Street  
St. Louis, MO 63103  
(314) 535-2222  
(314) 535-6205 fax

## MONTANA

**Restaurant Appliance Service**  
7219 Roosevelt Way NE  
Seattle, WA 98115  
(206) 524-8200  
(800) 433-9390  
(206) 525-2890 fax

## NEBRASKA

**Goodwin-Tucker Group**  
815 N. 19th Street  
Omaha, NE 68102  
(402) 345-7400  
(800) 228-0342  
(402) 346-6145 fax

## NEVADA

**GCS Service, Inc. #77**  
3585 East Patrick Lane  
Suite 1000  
Las Vegas, NV 89102  
(702) 450-3495  
(800) 500-9060  
(702) 450-3491 fax

**Burney's Commercial Service**  
4480 Aldevaran Avenue  
Las Vegas, NV 89103  
(702) 736-0006  
(702) 798-7531 fax

## NEW HAMPSHIRE

**GCS Service, Inc. #09**  
180 Second Street  
Chelsea, MA 02150  
(617) 889-9393  
(800) 225-1155  
(617) 889-1222 fax

**Massachusetts Restaurant Supply**  
34 South Street  
Somerville, MA 02143  
(617) 868-1930  
(800) 338-6737  
(617) 868-5331 fax

**Ace Service Co.**  
95 Hampton Avenue  
Needham, MA 02494  
(781) 449-4220  
(800) 225-4510 MA & NH  
(781) 444-4789 fax

# JACKSON MAINTENANCE & REPAIR CENTERS (USA)

## NEW JERSEY

### **Jackson Faspray Service**

155 Sargeant Avenue  
Clifton, NJ 07013  
(973) 471-8000  
(800) 356-6740  
(973) 471-1289 fax

### **GCS Service, Inc. #44**

817 N. Third Street  
Philadelphia, PA 19123  
(215) 925-6217  
(800) 441-9115  
(215) 925-6208 fax

### **GCS Service, Inc. #02**

1 Madison ST., Bldg. F  
E. Rutherford, NJ 07073  
(973) 614-0003  
(800) 399-8294  
(973) 614-0320 fax

### **Food Service Equipment**

2101 Parkway South  
Broomall, PA 19123  
(610) 356-6900  
(610) 356-2038 fax

## NEW MEXICO

### **Stove Parts Supply Co.**

2120 Solana Street  
Ft. Worth, TX 76117  
(817) 831-0381  
(800) 433-1804  
(817) 834-7754 fax

## NEW YORK

### **GCS Service, Inc. #01**

932 Grand Street  
Brooklyn, NY 11211  
(718) 486-5220  
(800) 969-4271  
(718) 486-6772 fax

### **Duffy's Equipment Service**

3138 Oneida Street  
Sauquoit, NY 13456  
(315) 737-9401  
(800) 443-8339  
(315) 737-7132 fax

### **B.E.S.T., Inc.**

3003 Genesee Street  
Buffalo, NY 14225  
(716) 893-6464  
(800) 338-5011  
(716) 893-6466 fax

## NEW YORK (cont)

### **Appliance Installation & Service Corp.**

1336 Main Street  
Buffalo, NY 14209  
(716) 884-7425  
(800) 722-1252  
(716) 884-0410 fax

### **Northern Parts & Service**

21 Northern Avenue  
Plattsburgh, NY 12903  
(518) 563-3200  
(800) 634-5005  
(800) 782-5424 fax

### **Jackson Faspray Service**

155 Sargeant Avenue  
Clifton, NJ 07013  
(973) 471-8000  
(800) 356-6740  
(973) 471-1289 fax

## NORTH CAROLINA

### **Whaley Foodservice Repairs**

8334-K Arrowridge Blvd.  
Charlotte, NC 28273  
(704) 529-6242  
(704) 529-1558 fax

### **Whaley Foodservice Repairs**

203-D Creek Ridge Road  
Greensboro, NC 27406  
(336) 333-2333  
(336) 333-2533 fax

### **Whaley Foodservice Repairs**

335-105 Sherwee Drive  
Raleigh, NC 27603  
(919) 779-2266  
(919) 779-2224 fax

### **Whaley Foodservice Repairs**

6418-101 Amsterdam Way  
Wilmington, NC 28405  
(910) 791-0000  
(910) 791-6662 fax

## NORTH DAKOTA

### **GCS/Metro Service Inc.**

2857 Louisiana Avenue N.  
Minneapolis, MN 55427  
(612) 546-4221  
(800) 345-4221  
(612) 546-4286 fax

## OHIO

### **Certified Service Center**

890 Redna Terrace  
Cincinnati, OH 45215  
(513) 772-6600  
(800) 543-2060  
(513) 612-6600 fax

## OHIO (cont)

### **Commercial Parts & Service of Columbus**

1150 West Mound Street  
Columbus, OH 43223  
(614) 221-0057  
(800) 837-8327  
(614) 221-3622 fax

### **GCS Service, Inc.**

2830 Johnstown Rd.  
Columbus, OH 43219  
(614) 476-3225  
(800) 282-5406  
(614) 476-1196 fax

### **Electrical Appliance Repair Service**

5805 Valley Belt Road  
Cleveland, OH 44131  
(216) 459-8700  
(800) 621-8259  
(216) 459-8707 fax

## OKLAHOMA

### **Krueger Inc.**

100 NE 24th Street  
Oklahoma City, OK 73105  
(405) 528-8883  
(800) 522-8069  
(405) 528-5405 fax

### **Hagar Restaurant Equipment**

1229 W. Main Street  
Oklahoma City, OK 73106  
(405) 235-2184  
(800) 445-1791  
(405) 236-5592 fax

## OREGON

### **Ron's Service**

16364 SW 72nd Ave.  
Portland, OR 97224  
(503) 624-0890  
(800) 851-4118  
(503) 684-6107 fax

## PENNSYLVANIA

### **GCS Service, Inc. #44**

817 N. Third Street  
P.O. Box 3564  
Philadelphia, PA 19123  
(215) 925-6217  
(800) 441-9115  
(215) 925-6208 fax

### **Elmer Schultz Service**

540 North 3rd Street  
Philadelphia, PA 19123  
(215) 627-5400  
(215) 627-5408 fax



# JACKSON MAINTENANCE & REPAIR CENTERS (USA)

## PENNSYLVANIA (cont)

### **Food Service Equipment**

2101 Parkway South  
Broomall, PA 19008  
(610) 356-6900  
(610) 356-2038

### **A.I.S. Commercial Parts & Service**

1816 West 26th Street  
Erie, PA 16508  
(814) 456-3732  
(800) 332-3732  
(814) 452-4843 fax

### **GCS Service, Inc. #44**

4400 Lewis Road, Suite E  
Harrisburg, PA 17111  
(717) 564-3282  
(800) 367-3225  
(717) 564-9286 fax

### **K & D Parts & Service**

1833-41 N. Cameron Street  
Harrisburg, PA 17103  
(717) 236-9039  
(800) 932-0503  
(717) 238-4367 fax

### **AFS-Authorized Factory Service, Co.**

940 First Avenue  
Coraopolis, PA 15108  
(412) 262-2330  
(800) 222-8767  
(412) 262-2245 fax

### **GCS Service, Inc. #48**

210 Vista park Drive  
Pittsburgh, PA 15205  
(412) 787-1970  
(800) 738-1221  
(412) 787-5005 fax

## RHODE ISLAND

### **GCS Service, Inc. #90**

1002 Waterman Ave.  
E. Providence, RI 02914  
(401) 434-6803  
(800) 462-6012  
(401) 438-9400 fax

## SOUTH CAROLINA

### **Whaley Foodservice Repairs**

I-26 & US1  
P.O. Box 4023  
West Columbia, SC 29170  
(803) 791-4420  
(800) 877-2662  
(803) 794-4630 fax

## SOUTH CAROLINA (cont)

### **Whaley Foodservice Repairs**

748 Congaree Road  
Greenville, SC 29607  
(864) 234-7011  
(800) 494-2539  
(864) 234-6662 fax

### **Whaley Foodservice Repairs**

1406-C Commerce Pl.  
Myrtle Beach, SC 29577  
(843) 626-1866  
(843) 626-2632 fax

### **Whaley Foodservice Repairs**

4740-A Franchise St.  
N. Charleston, SC 29418  
(843) 760-2110  
(843) 760-2255 fax

## SOUTH DAKOTA

### **Metro Commercial Service, Inc.**

2857 Louisiana Avenue N.  
Minneapolis, MN 55427  
(612) 546-4221  
(800) 345-4221  
(612) 546-4286 fax

## TENNESSEE

### **Commercial Parts & Service**

3717 Cherry Road  
Memphis, TN 38118  
(901) 366-4587  
(800) 262-9155  
(901) 366-4588 fax

### **Commercial Parts & Service**

748 Fesslers Lane  
Nashville, TN 37210  
(615) 244-8050  
(800) 831-7174  
(615) 244-8885 fax

### **Commercial Appliance Service**

919 8th Ave. South  
Nashville, TN 37203  
(615) 254-0906  
(800) 476-0906  
(615) 254-0919 fax

## TEXAS

### **GCS Service, Inc. #90**

10850 Sanden Drive  
Dallas, TX 75238-5325  
(972) 484-2954  
(800) 422-5026  
(972) 484-2531 fax

## TEXAS (cont)

### **Stove Parts Supply Co.**

2120 Solana Street  
Ft. Worth, TX 76117  
(817) 831-0381  
(800) 433-1804  
(817) 834-7754 fax

### **GCS Service, Inc. #88**

8150 Westpark  
Houston, TX 77081  
(713) 785-9187  
(800) 868-6957  
(713) 785-3979 fax

### **Armstrong Repair Center**

5110 Glenmont Dr.  
Houston, TX 77081  
(713) 666-7100  
(800) 392-5325  
(713) 661-0520 fax

### **Commercial Kitchen Repair**

1377 N. Brasos  
P.O. Box 831128  
San Antonio, TX 78207  
(210) 735-2811  
(800) 292-2120  
(210) 735-7421 fax

## UTAH

### **Lamonica's Restaurant Equipment Service**

6182 S. Stratler Avenue  
Murray, UT 84107  
(801) 263-3221  
(800) 527-2561  
(801) 263-3229 fax

## VERMONT

### **Authorized Appliance Servicer of Vermont**

74 River Street  
Rutland, VT 05701  
(802) 775-5588  
(800) 874-1080  
(802) 775-9593 fax

### **Northern Parts & Service**

4874 S. Catherine Street  
Plattsburg, NY 12901  
(518) 563-3200  
(800) 634-5005  
(800) 782-5424 fax

### **GCS Service, Inc. #09**

180 Second Street  
Chelsea, MA 02150  
(617) 889-9393  
(800) 225-1155  
(617) 889-1222 fax

## JACKSON MAINTENANCE & REPAIR CENTERS (USA)

### VIRGINIA

**GCS Service, Inc. #18**  
5760 Northampton Blvd.  
Suite 106  
Virginia Beach, VA 23455  
(757) 464-3500  
(800) 476-4278  
(757) 464-4106 fax

**GCS Service, Inc. #07**  
2660 Pittman Drive  
Silver Spring, MD 20910  
(301) 585-7550 (DC)  
(410) 792-0388 (Balt)  
(800) 638-7278  
(301) 495-4410 fax

**GCS Service, inc. #18**  
2421 Grenoble Road  
Richmond, VA 23294  
(804) 672-1700  
(800) 899-5949  
(804) 672-2888 fax

**Daubers, Inc.**  
7645 Dynatech Court  
Springfield, VA 22153  
(703) 866-3600  
(800) 554-7788  
(703) 866-4071 fax

### WASHINGTON

**Restaurant Appliance Service**  
7219 Roosevelt Way NE  
Seattle, WA 98115  
(206) 524-8200  
(800) 433-9390  
(206) 525-2890

### WEST VIRGINIA

**AFS-Authorized Factory Service, Inc.**  
Rt.-1 Box 288  
S. Charleston, WV 25312  
(304) 344-8225  
(800) 654-4606  
(304) 344-8248 fax

### WISCONSIN

**Appliance Service Center, Inc.**  
2439 Atwood Avenue  
Madison, WI 53704  
(608) 246-3160  
(800) 236-7440  
(608) 246-2721 fax

**Appliance Service Center, Inc.**  
6843 W. Belloit Road  
West Allis, WI 53219  
(414) 543-6460  
(800) 236-6460  
(414) 543-6480 fax

### WISCONSIN (cont)

**Appliance Service Center, Inc.**  
786 Morris Ave.  
Green Bay, WI 54304  
(920) 496-9993  
(800) 236-0871  
(920) 496-9927 fax

### WYOMING

**Metro Appliance Service**  
1640 South Broadway  
Denver, CO 80210  
(303) 778-1126  
(800) 525-3532  
(303) 778-0268 fax

## JACKSON MAINTENANCE & REPAIR CENTERS (CANADA)

### **Kontac Industries**

6504 South Broadway  
Edmonton, AB T6B0E7  
(780) 469-4869  
(800) 661-2500  
(780) 465-6937 fax

### **Key Food Equipment Services**

#105-3728 North Fraser Way  
Burnaby, BC V5J5G1  
(604) 433-4484  
(800) 665-2655  
(604) 433-4684 fax

### **Choquette - CKS**

2710 Lancaster Road  
Unit 119  
Ottawa, OT K1B4T7  
(613) 739-8458  
(800) 267-2515  
(613) 739-3851 fax

### **Kontac Industries**

6271-15 Dorman Road  
Mississauga, OT L4V1H1  
(905) 677-1580  
(800) 661-2500  
(905) 677-2863 fax

### **Choquette - CKS**

8487 19th Avenue  
Montreal, QU H1Z4J2  
(514) 722-2000  
(800) 361-7681(Quebec)  
(514) 722-5050 fax

### **Service D'Equipment de Cuisine Entretien**

893 King O  
Sherbrooke, QU J1H1R9  
(819) 821-2153  
(819) 821-4015 fax

### **A.A. Dot (Service d'Entretien)**

15 St. Alphonse  
Ste. Therese, QU J731G3  
(450) 435-7736  
(450) 435-5249 fax

### **Choquette - CKS**

900 Pierre Bertrand  
Suite 220  
Vanier, QU G1M3k2  
(418) 681-3944  
(800) 463-5506  
(418) 681-3385 fax

# ELECTRICAL DIAGRAM

## SINGLE PHASE HIGH VOLTAGE CIRCUIT

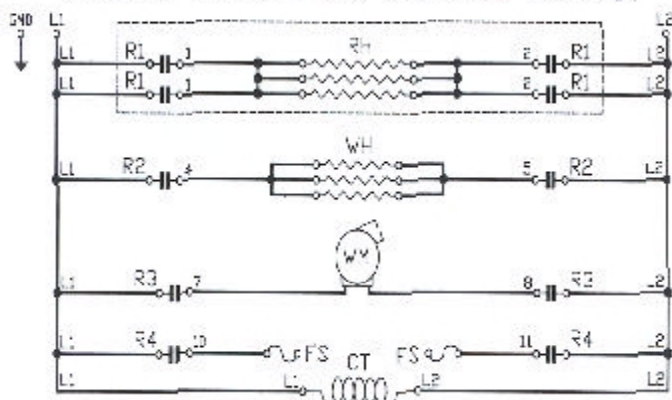

## THREE PHASE HIGH VOLTAGE CIRCUIT

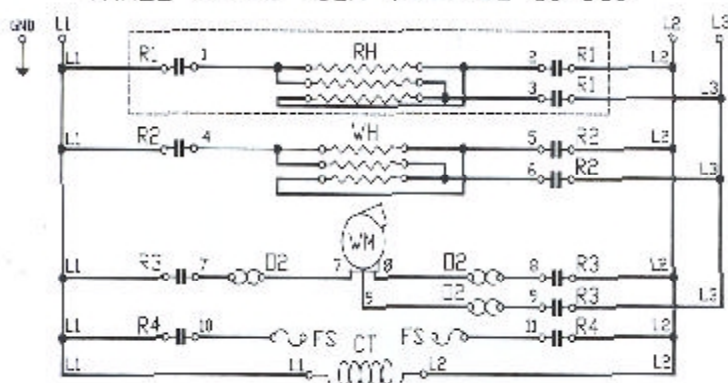

## LOW VOLTAGE CONTROL CIRCUIT

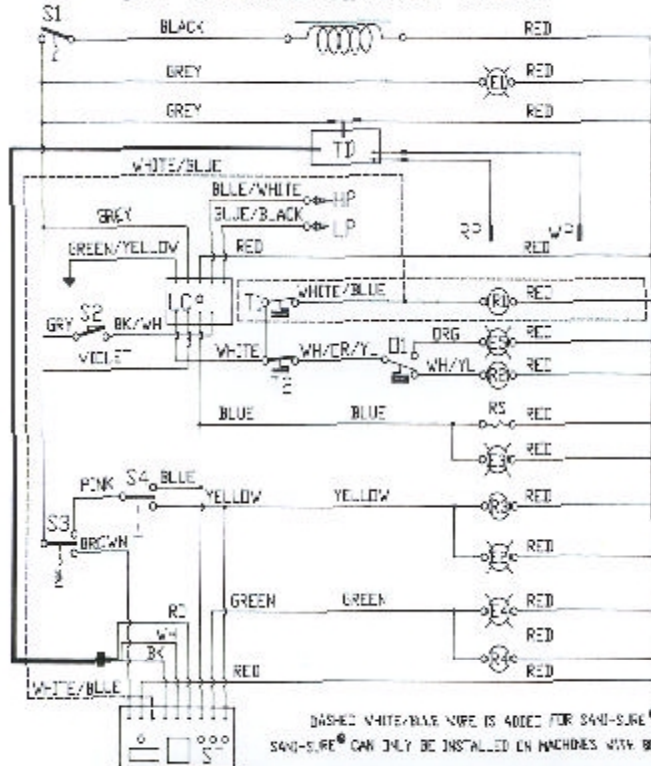

DASHED WHITE/BLUE WIRE IS ADDED FOR S40-SURE® OPTION  
S40-SURE® CAN ONLY BE INSTALLED ON MACHINES WITH BOOSTER OPTION

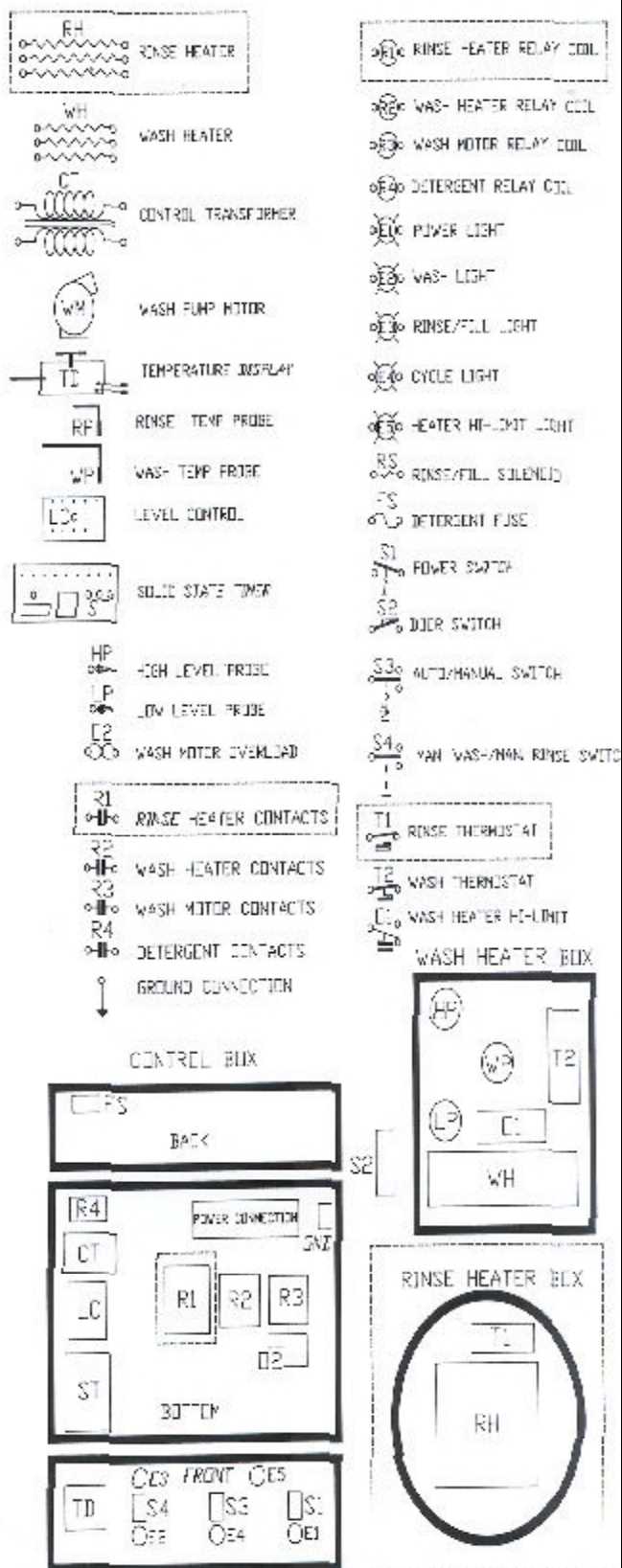

All the dashed lines are options that are installed on a unit containing a booster tank.