



40024A Series Display Merchandisers

PROJECT _____

ITEM # _____ QTY. _____

DATE _____

Self-Contained Countertop Display Case



Model 40024A

24" long x 24" deep self-contained single service, or pass-thru display case on adjustable legs with insulated glass door, stainless steel interior and exterior. Adjustable shelving and fluorescent illumination. Top-mounted R-134a forced air refrigeration system with high capacity evaporator coil and thermostatic control. Foamed in place, "CFC free" insulation and cordset for 120V operation.



Models ■ 40024A ■ 40024SSA

STANDARD FEATURES:

- Self-contained, top-mounted refrigeration system with thermostatic control, system utilizes "CFC free", R-134a refrigerant.
- Insulated glass doors, stainless steel front louver panel - lighted sign panel on back louver.
- Foamed in place "CFC free" urethane insulation.
- Stainless steel exterior and interior.
- Adjustable shelving set up and condensate evaporator mounted at factory.
- Fluorescent interior illumination.
- Totally self-contained for plug-in installation.

OPTIONAL ACCESSORIES:

- ☐ Door Lock

SPECIFICATIONS:

CABINET EXTERIOR: Cabinet body to be stainless steel with glass display door and solid glass back. (**MODEL 40024A** with pass-thru door setup). Front louver panel to be die-formed stainless steel, allowing ventilation of condensing unit, with solar digital thermometer read out mounted in front panel. Back louver panel to be a lighted sign panel (signage by others). Door opening frames to be stainless steel with ABS breaker strips and heater elements to prevent condensation on fronts. Unit to be supplied on 4" high adjustable leg set.

CABINET INTERIOR: Interior bottom to be all stainless steel with ABS plastic formed sided with molded shelf supports to hold two powder coat finished shelves provided. Interior light with external switch provided. Interior top with fluorescent lighting fixture. Unit insulated with CFC free, foamed in place urethane insulation. ABS interior sides provided with recessed mirror to accentuate lighting and products.

DOORS: Door to be insulated glass, mounted on concealed hinges with stainless steel frames, magnetic gaskets and aluminum handles.

REFRIGERATION: CFC free, HFC-134a refrigeration system with condensing unit, evaporator blower coil, condensate evaporator, and thermostatic control for operator adjustability. Unit totally prewired and to be supplied with 9' cordset (NEMA 5-15P) for 120V plug-in operation.

Randell Manufacturing, Inc.

520 S. Coldwater Rd. Weidman, MI 48893
Phone 1-800-621-8560 Fax 1-800-634-5369

For the most current specifications, visit our WebSite. www.randell.com

www.randell.com

Revised January 2002 R. Sec. 7, Page 4
Replaces R. Sec. 7, Page 4 from the revised January 2000 catalog

Dimensional Data

40024A Series

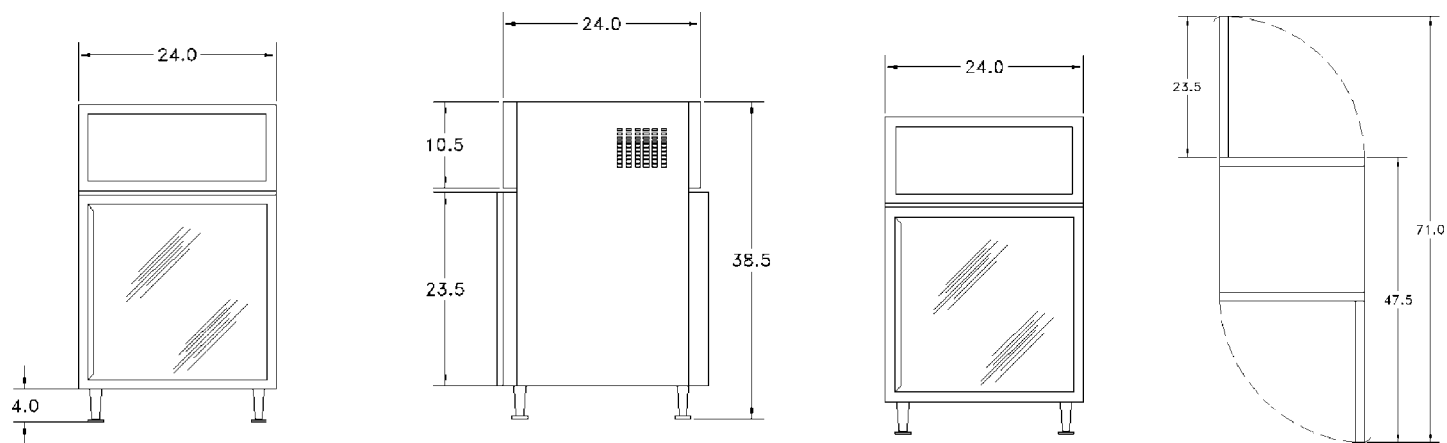

40024A

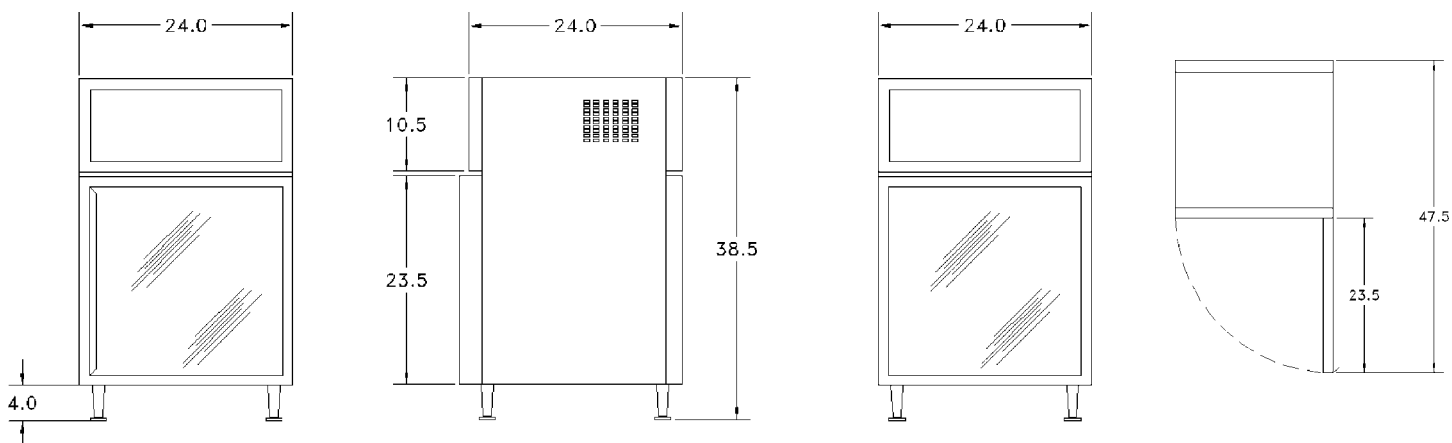

40024SSA

Model	L	D	H	Style	Storage Cu. Ft.	Shelves Sq. Ft.	H.P.	Volt	Amp.	NEMA	Ship Wt.
40024A	24"	24 1/2"	38 1/2"	Pass-Thru	4.75	11*	1/3	115/60/1	5	5-15P	240
40024SSA	24"	24 1/2"	38 1/2"	Single Service	4.75	11*	1/3	115/60/1	5	5-15P	240

* Includes interior bottom.

Door Opening Sizes - Interior Depths

Unit Length	Clearances Through Door		Interior Depth Behind Hinged Glass Door
	Lt. to Rt.	Top to Bottom	
24"	19 1/4"	18 1/2"	19"

Lighted Sign Panel Size:

Exposed Area: 21.5" x 8"

Overall Panel Size: 23.5" x 11.25"

Our Product Line Is On



AutoCAD™ R12-2000
AutoCAD™ Lt

Randell Manufacturing, Inc.

Due to a continuous program of product improvement, Randell reserves the right to make changes in design and specifications without prior notice