



# 12" SECTIONAL RANGE

## Two 33,000 BTU Open-Top Burners

### Platinum Series

#### Standard Features

- 12"-wide sectional range with two open-top burners available with a cabinet base or as a modular unit (for mounting on countertop, refrigerated or freezer base).
- Two 33,000 BTU NAT (30,000 BTU LP) patented clog-free burners (life time warranty)
- 9-1/4" deep front rail
- Removable drip tray
- Stainless steel front, sides, rear and exterior bottom
- Fully insulated lining and burner box
- 1-1/4" front gas manifold and 1" rear gas connection
- 5" high stainless steel flue riser
- Free battery-design assistance
- Warranty: two years on specified operational parts and one year on labor from date of purchase

#### Standard Features of Cabinet-Base Models

- Stainless steel cabinet with a removable door that can hinge on the right or the left.

- ☐ P12N-B (Modular Mount)
- ☐ P12C-B (Cabinet Base)

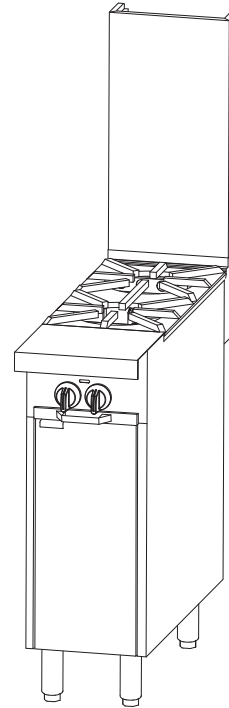

Model P12C-B with optional 24" flue riser

#### STANDARD CONSTRUCTION SPECIFICATIONS

**Exterior Finish:** Front, sides, rear and exterior bottom constructed of #3 polished 430 and 304 stainless steel.

**Range:** 12"-wide front-manifold sectional range with two 33,000 BTU NAT (30,000 BTU LP) clog-free, open-top burners with removable cast-grate top.

**Front Rail:** 9-1/4" deep front rail.

**Flue Riser:** 5" high stainless steel flue riser

**Battery:** Unit can be in any position in a battery. If the unit is at the end of the battery, the end side will be solid (rather than have a cover plate over the end of the front manifold).

**Legs:** 6" stainless steel adjustable legs standard.

**Model 12C:** Stainless steel cabinet base with a removable door that can hinge on the right or the left.



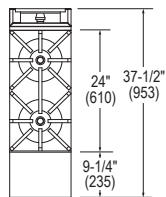

TOP VIEW

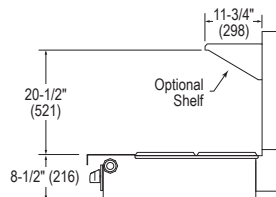

SIDE VIEW of MODULAR MODEL

SHIPPING CRATE DIMENSIONS & WEIGHT					
MODEL	WIDTH	HEIGHT	DEPTH	VOLUME	WEIGHT
P12N-B	20" (508)	21" (533)	42.5" (1080)	10.3 cu ft (0.29 cu m)	130 lbs (59 kg)
P12C-B	20" (508)	45" (1143)	42.5" (1080)	22.1 cu ft (0.63 cu m)	200 lbs (91 kg)

Dimensions shown in inches and (millimeters)

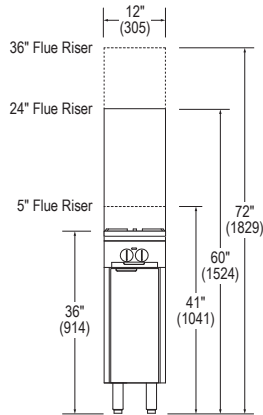

FRONT VIEW

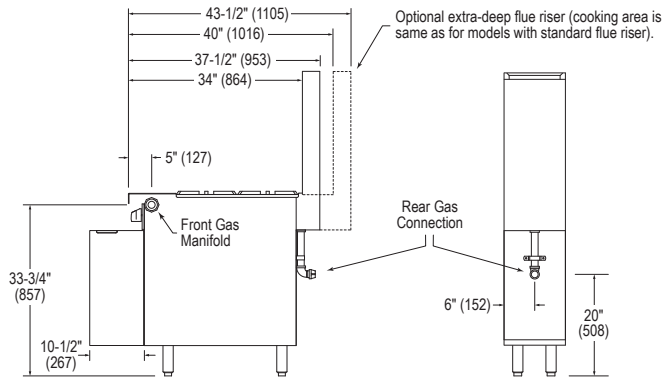

SIDE VIEW

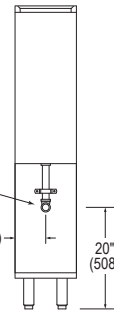

REAR VIEW

**UTILITY INFORMATION**

MODEL	GAS (BTU/HOUR)	
	NATURAL	PROPANE
P12N-B	66,000	60,000
P12C-B	66,000	60,000

**GAS:** Each unit has a 1-1/4" front manifold that couples to the adjacent sectional unit(s), and a 1" rear gas connection with a male NPT connector. Minimum gas supply pressure is 7" W.C. for natural gas and 11" W.C. for propane. All sectional units require a regulated gas supply (a pressure regulator must be ordered separately). If using a flexible-hose gas connection, the inside diameter of the hose must not be smaller than the connector on the unit and must comply with ANSI Z21.69, providing an adequate means of restraint to prevent undue strain on the gas connection.

**MISCELLANEOUS**

- If casters are used with a flexible-hose gas connection, a restraining device should be used to prevent undue strain on the hose.
- Minimum clearance from noncombustible construction is zero. Minimum clearance from combustible construction is 10" (254 mm) on sides and 6" (152 mm) on rear.
- Installation under a vented hood is recommended.
- Check local codes for fire and sanitary regulations.

**NOTICE:**

Southbend has a policy of continuous product research and improvement. We reserve the right to change specifications and product design without notice. Such revisions do not entitle the buyer to corresponding changes, improvements, additions or replacements for previously purchased equipment.

**OPTIONS and ACCESSORIES**

- |                                                                                |                                                                                                      |                                                                          |
|--------------------------------------------------------------------------------|------------------------------------------------------------------------------------------------------|--------------------------------------------------------------------------|
| <input type="checkbox"/> External pressure regulator                           | <input type="checkbox"/> Casters (front two casters lock)                                            | <input type="checkbox"/> Tray or tubular shelves                         |
| <input type="checkbox"/> Front rail options:                                   | <input type="checkbox"/> Cable restraint kit (to restrict movement when on casters)                  | <input type="checkbox"/> Open-frame base with casters for future battery |
| <input type="checkbox"/> Cutouts in front rail for sauce pans                  | <input type="checkbox"/> 24" or 36" high flue riser                                                  | <input type="checkbox"/> Extra-deep rear-extending flue riser            |
| <input type="checkbox"/> 7-1/4" deep front rail (to match old style sectional) | <input type="checkbox"/> Shelves on flue riser (one on 24" flue riser, one or two on 36" flue riser) | <input type="checkbox"/> Removable shelf inside cabinet                  |
| <input type="checkbox"/> Square belly bar mounted on 7-1/4" deep front rail    |                                                                                                      |                                                                          |

**INTENDED FOR COMMERCIAL USE ONLY.  
NOT FOR HOUSEHOLD USE.**



1100 Old Honeycutt Road, Fuquay-Varina, NC 27526  
(919) 762-1000 www.southbendnc.com