

# **STAR<sup>®</sup>**

## **DRAWER ROLL/ BUN WARMER**

MODEL

SST-20

SST-30

SST-50

SST-75

### **Installation and Operation Instructions**

2M-Z3235 Rev. G 8/2/2010

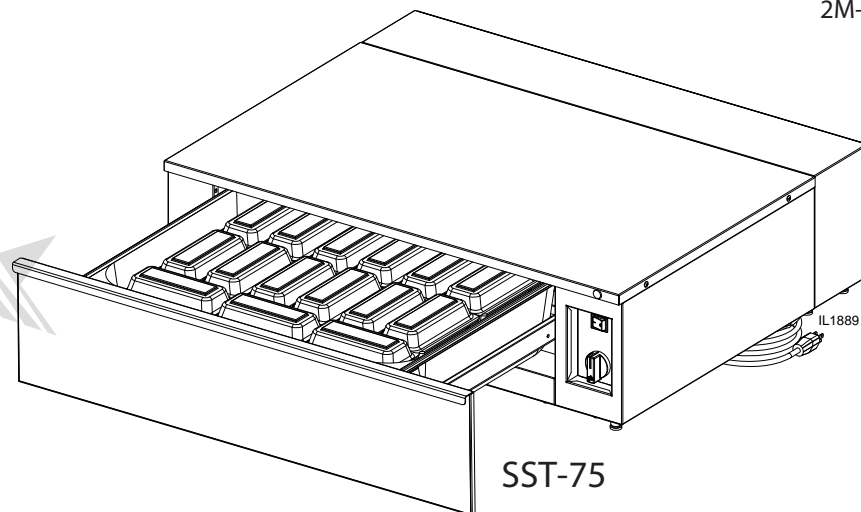

## SAFETY SYMBOL



These symbols are intended to alert the user to the presence of important operating and maintenance instructions in the manual accompanying the appliance.

---

## RETAIN THIS MANUAL FOR FUTURE REFERENCE

### NOTICE

Using any part other than genuine Star factory supplied parts relieves the manufacturer of all liability.

Star reserves the right to change specifications and product design without notice. Such revisions do not entitle the buyer to corresponding changes, improvements, additions or replacements for previously purchased equipment.

Due to periodic changes in designs, methods, procedures, policies and regulations, the specifications contained in this sheet are subject to change without notice. While Star Manufacturing exercises good faith efforts to provide information that is accurate, we are not responsible for errors or omissions in information provided or conclusions reached as a result of using the specifications. By using the information provided, the user assumes all risks in connection with such use.

## MAINTENANCE AND REPAIRS

Contact your local authorized service agent for service or required maintenance. Please record the model number, serial number, voltage and purchase date in the area below and have it ready when you call to ensure a faster service.

Model No. \_\_\_\_\_  
Serial No. \_\_\_\_\_  
Voltage \_\_\_\_\_  
Purchase Date \_\_\_\_\_

### Authorized Service Agent Listing

Reference the listing provided with the unit

or

for an updated listing go to:

**Website:** [www.star-mfg.com](http://www.star-mfg.com)  
**E-mail** [Service@star-mfg.com](mailto:Service@star-mfg.com)  
**Telephone:** (800) 807-9054 Local (314) 781-2777

### Service Help Desk

**Business Hours:** 8:00 am to 4:30 p.m. Central Standard Time

**Telephone:** (800) 264-7827 Local (314) 781-2777

**Fax:** (800) 396-2677 Local (314) 781-2714

**E-mail** [Parts@star-mfg.com](mailto:Parts@star-mfg.com)  
[Service@star-mfg.com](mailto:Service@star-mfg.com)  
[Warranty@star-mfg.com](mailto:Warranty@star-mfg.com)

**Website:** [www.star-mfg.com](http://www.star-mfg.com)

**Mailing Address:** Star International Holdings Inc., Company  
10 Sunnen Drive  
St. Louis, MO 63143  
U.S.A



## GENERAL INSTALLATION DATA

This equipment is designed and sold for commercial use only by personnel trained and experienced in its operation and is not sold for consumer use in and around the home nor for use directly by the general public in food service locations.

Before using your new equipment, read and understand all the instructions & labels associated with the unit prior to putting it into operation. Make sure all people associated with its use understand the units operation & safety before they use the unit.

All shipping containers should be checked for freight damage both visible and concealed. This unit has been tested and carefully packaged to insure delivery of your unit in perfect condition. If equipment is received in damaged condition, either apparent or concealed, a claim must be made with the delivering carrier.

Concealed damage or loss - if damage or loss is not apparent until after equipment is unpacked, a request for inspection of concealed damage must be made with carrier within 15 days. Be certain to retain all contents plus external and internal packaging materials for inspection. The carrier will make an inspection and will supply necessary claim forms.

## INSTALLATION

This bun warmer is equipped for the voltage shown on the nameplate. It will operate on alternating current only; however, the correct voltage must be applied. The unit should be installed by a qualified installer.

**DO NOT CONNECT TO DIRECT CURRENT (DC).**



## GENERAL OPERATING PROCEDURES

Using the power switch, turn the unit on. The pilot light on the front of the unit will indicate when the power is on. Select a setting on the thermostat for warming or holding rolls.

To keep the rolls soft and fresh, turn the control knob to a low position. Higher settings should be used only for short periods or preheating the warmer. Keep the drawers as full as possible. When adding new rolls to the drawer, pull the rolls and buns that are left in the drawer toward the front and use them first, giving time for the new rolls to become heated. Do not heat the rolls more than once, as they will not be palatable if reheated. If the rolls dry out, reduce temperature.

**NOTE:** This unit may smoke and have a slight odor when first used. We suggest you turn the thermostat to a high heat position and let unit heat for approximately two (2) hours before using.

## ELECTRICAL CONNECTIONS

For your protection, this appliance is equipped with a 3-conductor cord with a grounding type plug. Connect only to a grounding receptacle.

Before making any electrical connection to this unit, check that the power supply is adequate for the voltage, amperage and requirements stated on the rating plate.

A wiring diagram is included herewith.

Disconnect the unit from the power source before installing or removing any parts.

Be absolutely sure that the ground connection for the receptacle is properly wired. Do not connect equipment to power without proper ground connections. Improper grounding may result in personal injury or fatality.

**DO NOT CUT OR REMOVE THIS PLUG OR GROUNDING PRONG FROM THE PLUG.**

**CONNECT/PLUG UNIT INTO DEDICATED A.C. LINE ONLY SPECIFIED ON THE DATA PLATE OF THE UNIT.**



## **CLEANING**

To remove the drawer for cleaning:

1. Pull the drawer out until it stops.
2. Remove the interior pan.
3. Grasp the drawer assembly with both hands.
4. Lift the drawer in an upward direction while slowly pulling out.

This will disengage the drawer from the drawer stops. To re-install the drawer, reverse the procedure. The unit should be cleaned with a damp cloth using a mild detergent or non abrasive cleaner. Clean the entire unit daily to ensure long life and satisfactory performance as well as to maintain an attractive appearance. Do not clean with water jet equipment.

## **MAINTENANCE AND REPAIRS**

Contact the factory, a service representative, or a local service company for service or required maintenance.

|   |     |             |                                     |  |                          |                        |     |      |
|---|-----|-------------|-------------------------------------|--|--------------------------|------------------------|-----|------|
| MATERIAL<br>-----   |     |             | FINISH<br>-----                     |  | MODEL NO.<br>SST20,30,50 | PART NO.<br>SK1635     |     |      |
| DR. MH  | CK. | DATE 2-2-99 | STAR MFG. INTERNATIONAL, INC.       |  |                          | TITLE WIRE DIAGRAM SST |     |      |
| LIMITS UNLESS OTHERWISE NOTED<br>FRACTIONS $\pm 1/64$ DECIMALS $\pm .005$ |     |             | 10 SUNNEN DRIVE ST. LOUIS, MO 63143 |  |                          | CHANGES                | LTR | DATE |

| CHANGE | LTR      | DATE | CHANGE  | DR |
|--------|----------|------|---|----|
| A      | 7-7-99   |      | CORRECTED WIRE NOTATIONS                                  | MH |
| B      | 9-20-99  |      | DELETED WIRE NOTATIONS                                    | TH |
| C      | 10/27/03 |      | REMOVED NUMBERS FROM SWITCH AND SHOWED AS BACK OF SWITCH. | PR |

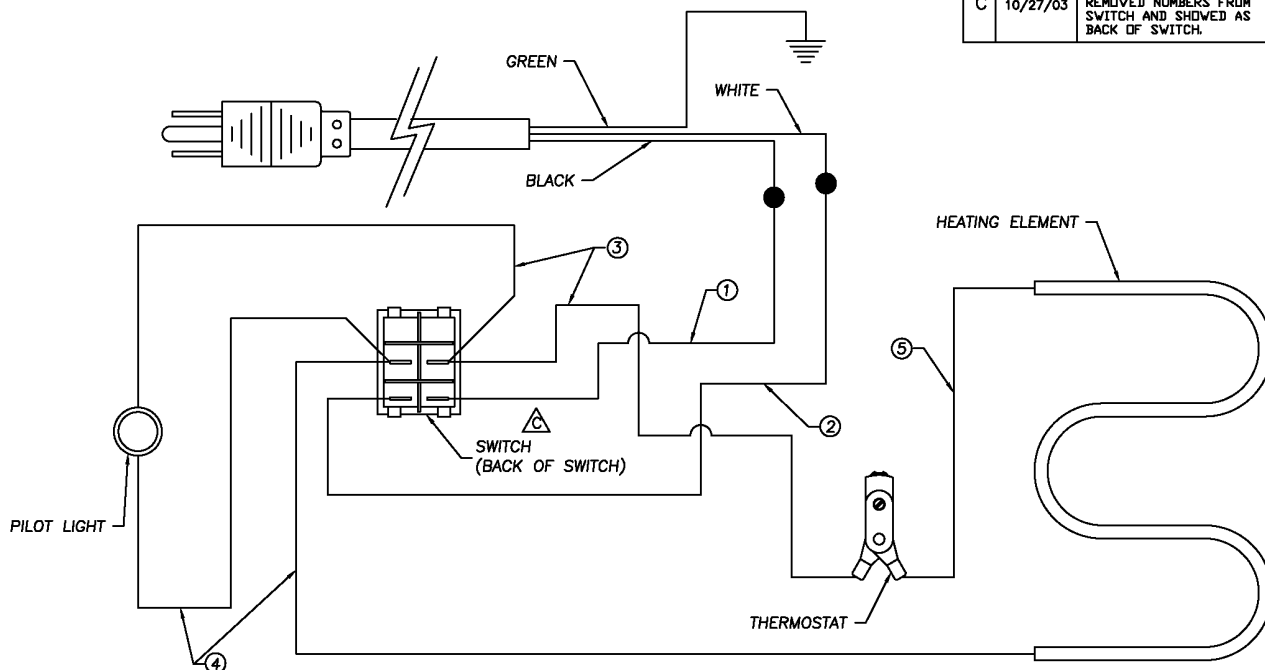

|   |     |             |                                     |  |                        |                           |     |      |
|---|-----|-------------|-------------------------------------|--|------------------------|---------------------------|-----|------|
| MATERIAL<br>-----   |     |             | FINISH<br>-----                     |  | MODEL NO.<br>SST 230CE | PART NO.<br>SK1636        |     |      |
| DR. MH  | CK. | DATE 2-2-99 | STAR MFG. INTERNATIONAL, INC.       |  |                        | TITLE WIRE DIAGRAM SST CE |     |      |
| LIMITS UNLESS OTHERWISE NOTED<br>FRACTIONS $\pm 1/64$ DECIMALS $\pm .005$ |     |             | 10 SUNNEN DRIVE ST. LOUIS, MO 63143 |  |                        | CHANGES                   | LTR | DATE |

| CHANGE | LTR      | DATE | CHANGE  | DR |
|--------|----------|------|---|----|
| A      | 7-7-99   |      | CORRECTED WIRE NOTATIONS                                  | MH |
| B      | 9-20-99  |      | DELETED WIRE NOTATIONS                                    | TH |
| C      | 10/27/03 |      | REMOVED NUMBERS FROM SWITCH AND SHOWED AS BACK OF SWITCH. | PR |

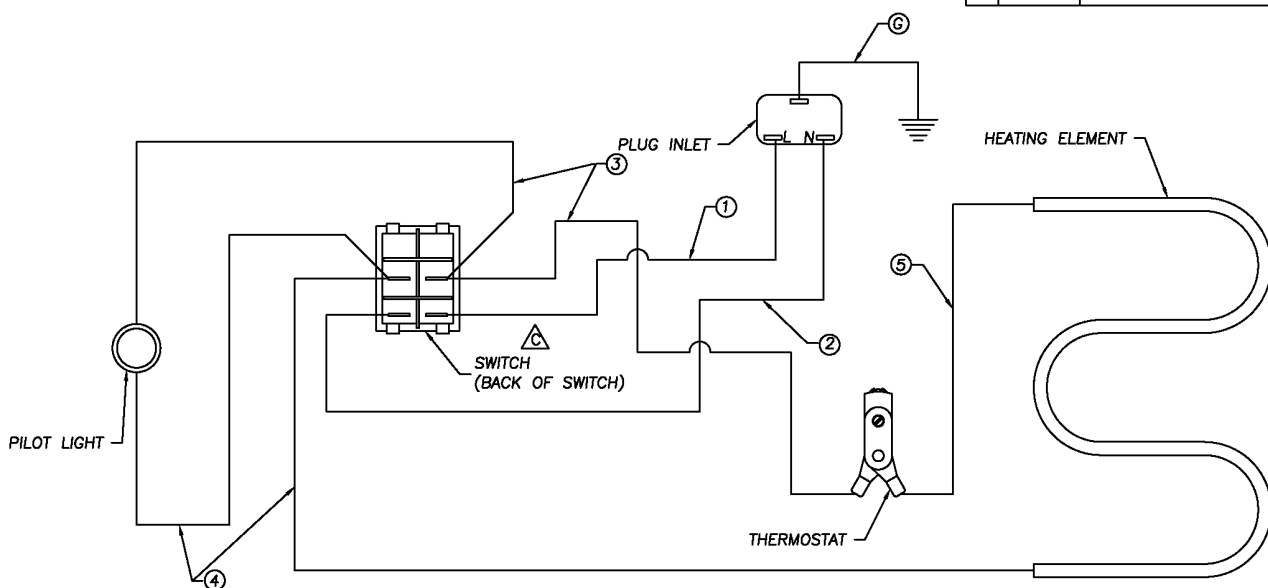

Visit our Website at: [www.star-mfg.com](http://www.star-mfg.com)

Email: [service@star-mfg.com](mailto:service@star-mfg.com)

### THOROUGHLY INSPECT YOUR UNIT ON ARRIVAL

This unit has been tested for proper operation before leaving our plant to insure delivery of your unit in perfect condition. However, there are instances in which the unit may be damaged in transit. In the event you discover any type of damage to your product upon receipt, you must immediately contact the transportation company who delivered the item to you and initiate your claim with same. If this procedure is not followed, it may affect the warranty status of the unit.

### LIMITED EQUIPMENT WARRANTY

All workmanship and material in Star products have a one (1) year limited warranty on parts & labor in the United States and Canada. Such warranty is limited to the original purchaser only and shall be effective from the date the equipment is placed in service. Star's obligation under this warranty is limited to the repair of defects without charge, by the factory authorized service agency or one of its sub-agencies. Models that are considered portable (*see below*) should be taken to the closest Star service agency, transportation prepaid.

- > Star will not assume any responsibility for loss of revenue.
- > On all shipments outside the United States and Canada, see International Warranty.
- \* The warranty period for the JetStar six (6) ounce & Super JetStar eight (8) ounce series popcorn machines is two (2) years.
- \* The warranty period for the Chrome-Max Griddles is five (5) years on the griddle surface. See detailed warranty provided with unit.
- \* The warranty period for Teflon/Dura-Tec coatings is one year under normal use and reasonable care. This warranty does not apply if damage occurs to Teflon/Dura-Tec coatings from improper cleaning, maintenance, use of metallic utensils, or abrasive cleaners, abrasive pads, product identifiers and point-of-sale attachments, or any other non-food object that comes in continuous contact with the roller coating. This warranty does not apply to the "non-stick" properties of such materials.
- > This warranty does not apply to "Special Products" but to regular catalog items only. Star's warranty on "Special Products" is six (6) months on parts and ninety (90) days on labor.
- > This warranty does not apply to any item that is disassembled or tampered with for any purpose other than repair by a Star Authorized Service Center or the Service Center's sub-agency.
- > This warranty does not apply if damage occurs from improper installation, misuse, wrong voltage, wrong gas or operated contrary to the Installation and Operating instructions.
- > This warranty is not valid on Conveyor Ovens *unless* a "start-up/check-out" has been performed by a Factory Authorized Technician.

### PARTS WARRANTY

Parts that are sold to repair out of warranty equipment are warranted for ninety (90) days. The part only is warranted. Labor to replace the part is chargeable to the customer.

### SERVICES NOT COVERED BY WARRANTY

- |  |   |
|--|---|
| 1. Travel time and mileage rendered beyond the 50 mile radius limit  | 10. Voltage conversions   |
| 2. Mileage and travel time on portable equipment ( <i>see below</i> )  | 11. Gas conversions   |
| 3. Labor to replace such items that can be replaced easily during a daily cleaning routine, ie; removable kettles on fryers, knobs, grease drawers on griddles, etc. | 12. Pilot light adjustment  |
| 4. Installation of equipment   | 13. Miscellaneous adjustments   |
| 5. Damages due to improper installation  | 14. Thermostat calibration and by-pass adjustment   |
| 6. Damages from abuse or misuse  | 15. Resetting of circuit breakers or safety controls or reset buttons                           |
| 7. Operated contrary to the Operating and Installation Instructions  | 16. Replacement of bulbs  |
| 8. Cleaning of equipment   | 17. Replacement of fuses  |
| 9. Seasoning of griddle plates   | 18. Repair of damage created during transit, delivery, & installation OR created by acts of God |

### PORTABLE EQUIPMENT

Star will not honor service bills that include travel time and mileage charges for servicing any products considered "Portable" including items listed below. These products should be taken to the Service Agency for repair:

- \* The Model 510FD Fryer.
- \* The Model 526TOA Toaster Oven.
- \* The Model J4R, 4 oz. Popcorn Machine.
- \* The Model 518CMA & 526CMA Cheese Melter.
- \* The Model 12MC & 15MC & 18MCP Hot Food Merchandisers.
- \* The Model 12NCPW & 15NCPW Nacho Chip/Popcorn Warmer.
- \* All Hot Dog Equipment **except Roller Grills & Drawer Bun Warmers.**
- \* All Nacho Cheese Warmers **except Model 11WLA Series Nacho Cheese Warmer.**
- \* All Condiment Dispensers **except the Model HPD & SPD Series Dispenser.**
- \* All Specialty Food Warmers **except Model 130R, 11RW Series, and 11WSA Series.**
- \* All QCS/RCS Series Toasters **except Model QCS3 & RCS3 Series.**

#### ALL:

- \* Pop-Up Toasters
- \* Butter Dispensers
- \* Pretzel Merchandisers
- (Model 16PD-A Only)
- \* Pastry Display Cabinets
- \* Nacho Chip Merchandisers
- \* Accessories of any kind
- \* Sneeze Guards
- \* Pizza Ovens
- (Model PO12 Only)
- \* Heat Lamps
- \* Pumps-Manual

The foregoing warranty is in lieu of any and all other warranties expressed or implied and constitutes the entire warranty.

### FOR ASSISTANCE

Should you need any assistance regarding the Operation or Maintenance of any Star equipment; write, phone, fax or email our Service Department. In all correspondence mention the Model number and the Serial number of your unit, and the voltage or type of gas you are using.

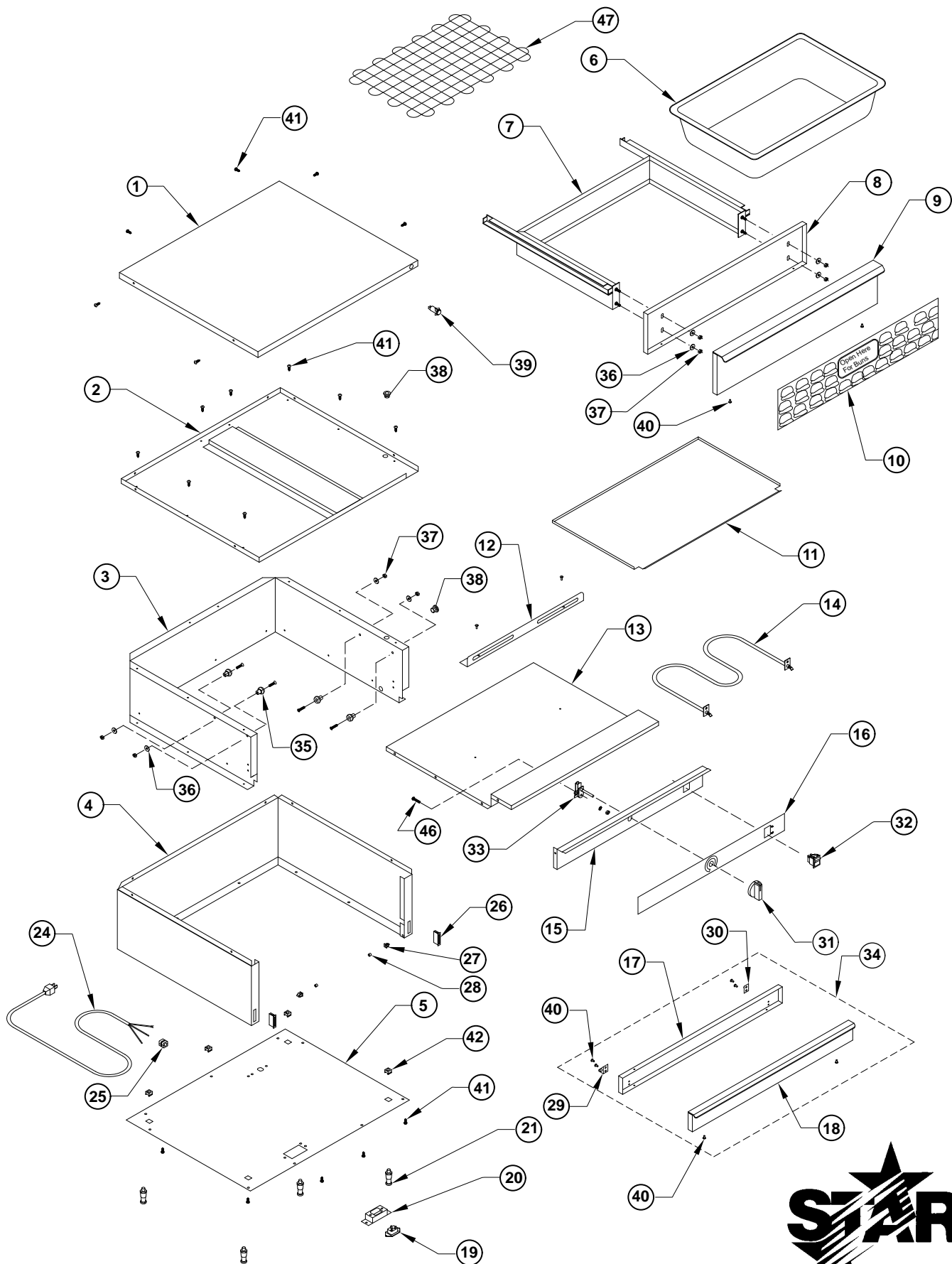

MODELS SST-20, SST-30, SST-50

STAR MANUFACTURING INTERNATIONAL, INC.

SK1632

REV B

12/9/99



# PARTS LIST

October 2, 2009, Rev. G

| SST-20 120V/230CE Drawer Roll / Bun Warmer |           |     |                         |              | SST-20 120V/230CE Drawer Roll / Bun Warmer |          |     |                           |             |
|--|-----------|-----|-------------------------|--------------|--|----------|-----|---------------------------|-------------|
| Fig No                                     | Part No   | Qty | Description             | Application  | Fig No                                     | Part No  | Qty | Description               | Application |
| 1  | A4-Z2212  | 1   | TOP                     |              | 39   | 2J-Z2329 | 1   | PILOT LIGHT               |             |
| 2  | A4-BW2003 | 1   | LINER-TOP               |              | 39   | 2J-Z3157 | 1   | PILOT LIGHT               | 230 CE      |
| 3  | A4-BW2014 | 1   | LINER-BODY              |              | 40   | 2C-Y1451 | 12  | RIVET .125 X .25          |             |
| 4  | A4-Z2210  | 1   | BODY                    |              | 41   | 2C-6349  | 34  | SCREW #8 X .375 TH NP     |             |
| 5  | A4-Z3221  | 1   | BOTTOM                  |              | 42   | 2C-Z2642 | 4   | THREADED INSERT           | SST-20-120V |
| 6  | 2D-Z5898  | 1   | BUN PAN                 |              | 43   | 2C-1494  | 1   | SCREW 8-32 X 1/2 STL RH   |             |
| 7  | A4-BW2013 | 1   | DRAWER FRAME ASSEMBLY   |              | 44   | 2C-1825  | 2   | WASHER #8 EXT. SHAKEPROOF |             |
| 8  | A4-Z3328  | 1   | DRAWER LINER            |              | 45   | 2C-2556  | 2   | NUT #8-32                 |             |
| 9  | A4-BW2001 | 1   | DRAWER FRONT            |              | 46   | 2C-H1578 | 1   | SCREW 8-32 X 1"           |             |
| 10   | 2M-Z2231  | 1   | GRAPHIC-DRAWER          |              | 47   | 2B-Z5847 | 1   | BUN RACK                  |             |
| 11   | A4-Z5892  | 1   | PAN COVER               |              |  |          |     |                           |             |
| 12   | A4-Z2214  | 1   | ELEMENT SUPPORT         |              |  |          |     |                           |             |
| 13   | A4-Z2216  | 1   | BOTTOM LINER            |              |  |          |     |                           |             |
| 14   | 2N-Z2235  | 1   | ELEMENT 300 WATTS       | SST-20 120V  |  |          |     |                           |             |
|  | 2N-Z2530  |     | ELEMENT 300 WATTS       | SST-20 230CE |  |          |     |                           |             |
| 15   | A4-Z2222  | 1   | CONTROL PANEL           |              |  |          |     |                           |             |
| 16   | 2M-Z2232  | 1   | GRAPHIC-CNTRL PANEL     |              |  |          |     |                           |             |
| 17   | A4-Z2218  | 1   | DOOR LINER              |              |  |          |     |                           |             |
| 18   | A4-BW2012 | 1   | DOOR ASSY               |              |  |          |     |                           |             |
| 19   | 2E-Z3034  | 1   | PLUG INLET              | SST-20 230CE |  |          |     |                           |             |
| 20   | A4-Z2287  | 1   | PLUG INLET HOUSING      | SST-20 230CE |  |          |     |                           |             |
| 21   | 2R-Z5846  | 4   | FOOT 3/8" STUD, 1" HIGH |              |  |          |     |                           |             |
| 24   | E4-403009 | 1   | CORDSET                 | SST-20 120V  |  |          |     |                           |             |
|  | 2E-Z0512  |     |                         | SST-20 230CE |  |          |     |                           |             |
| 25   | 2K-7889   | 1   | CORDSET BUSHING         | SST-20 120V  |  |          |     |                           |             |
| 26   | 2R-Y7330  | 2   | MAGNETIC CATCH          |              |  |          |     |                           |             |
| 27   | 21-Z1894  | 2   | HINGE INSERT            |              |  |          |     |                           |             |
| 28   | 2A-Z2233  | 2   | HINGE SLEEVE            |              |  |          |     |                           |             |
| 29   | A4-Z2228  | 1   | HINGE BRACKET LEFT      |              |  |          |     |                           |             |
| 30   | A4-Z2229  | 1   | HINGE BRACKET RIGHT     |              |  |          |     |                           |             |
| 31   | 2R-Z1854  | 1   | CONTROL KNOB            |              |  |          |     |                           |             |
| 32   | 2E-Z1858  | 1   | SWITCH ON/OFF           |              |  |          |     |                           |             |
| 32   | 2E-Z3156  | 1   | SWITCH ON/OFF           | 230 CE       |  |          |     |                           |             |
| 33   | 2T-Z2236  | 1   | THERMOSTAT              |              |  |          |     |                           |             |
| 34   | A4-BW2005 | 1   | DOOR ASSEMBLY COMPLETE  |              |  |          |     |                           |             |
| 35   | 2P-Z0315  | 4   | ROLLER                  |              |  |          |     |                           |             |
| 36   | 2C-1810   | 12  | BURR RIVETING           |              |  |          |     |                           |             |
| 37   | 2C-Z0498  | 8   | NUT 10/24 NYLOK         |              |  |          |     |                           |             |
| 38   | 2K-z2895  | 2   | BUSHING SPLIT           |              |  |          |     |                           |             |

**IMPORTANT: WHEN ORDERING, SPECIFY VOLTAGE OR TYPE GAS DESIRED  
INCLUDE MODEL AND SERIAL NUMBER**

PAGE 1  
OF 1

Some items are included for illustrative purposes only and in certain instances may not be available.



**Star Manufacturing International, Inc.**



# PARTS LIST

October 2, 2009, Rev. G

MODEL SST-30 120V/230CE Drawer Roll / Bun Warmer

| SST-30 120V/230CE Drawer Roll / Bun Warmer |           |     |                         |              |
|--|-----------|-----|-------------------------|--------------|
| Fig No                                     | Part No   | Qty | Description             | Application  |
| 1  | A4-Z2270  | 1   | TOP                     |              |
| 2  | A4-BW3003 | 1   | LINER-TOP               |              |
| 3  | A4-BW3013 | 1   | LINER-BODY              |              |
| 4  | A4-Z2268  | 1   | BODY                    |              |
| 5  | A4-Z3222  | 1   | BOTTOM                  |              |
| 6  | 2D-Z5899  | 1   | BUN PAN                 |              |
| 7  | A4-BW3012 | 1   | DRAWER FRAME ASSEMBLY   |              |
| 8  | Z4-Z3322  | 1   | DRAWER LINER            |              |
| 9  | A4-BW3001 | 1   | DRAWER FRONT            |              |
| 10   | 2M-Z2286  | 1   | GRAPHIC-DRAWER          |              |
| 11   | A4-Z5893  | 1   | PAN COVER               |              |
| 12   | A4-Z2272  | 1   | ELEMENT SUPPORT         |              |
| 13   | A4-Z2274  | 1   | BOTTOM LINER            |              |
| 14   | 2N-Z2283  | 1   | ELEMENT 400 WATTS       | SST-30 120V  |
|  | 2N-Z2389  |     | ELEMENT 400 WATTS       | SST-30 230CE |
| 15   | A4-Z2280  | 1   | CONTROL PANEL           |              |
| 16   | 2M-Z2284  | 1   | GRAPHIC-CONTROL PANEL   |              |
| 17   | A4-Z2276  | 1   | DOOR LINER              |              |
| 18   | A4-BW3011 | 1   | DOOR ASSY               |              |
| 19   | 2E-Z3034  | 1   | PLUG INLET              | SST-30 230CE |
| 20   | A4-Z2287  | 1   | PLUG INLET HOUSING      | SST-30 230CE |
| 21   | 2R-Z5846  | 4   | FOOT 3/8" STUD, 1" HIGH |              |
| 24   | E4-403009 | 1   | CORDSET                 | SST-30 120V  |
|  | 2E-Z0512  |     | CORDSET                 | SST-30 230CE |
| 25   | 2K-7889   | 1   | CORDSET BUSHING         | SST-30 120V  |
| 26   | 2R-Y7330  | 2   | MAGNETIC CATCH          |              |
| 27   | 21-Z1894  | 2   | HINGE INSERT            |              |
| 28   | 2A-Z2233  | 2   | HINGE SLEEVE            |              |
| 29   | A4-Z2228  | 1   | HINGE BRACKET LEFT      |              |
| 30   | A4-Z2229  | 1   | HINGE BRACKET RIGHT     |              |
| 31   | 2R-Z1854  | 1   | CONTROL KNOB            |              |

| SST-30 120V/230CE Drawer Roll / Bun Warmer |           |     |                           |             |
|--|-----------|-----|---------------------------|-------------|
| Fig No                                     | Part No   | Qty | Description               | Application |
| 32   | 2E-Z1858  | 1   | SWITCH ON/OFF             |             |
| 33   | 2T-Z2236  | 1   | THERMOSTAT                |             |
| 34   | A4-BW3005 | 1   | DOOR ASSEMBLY COMPLETE    |             |
| 35   | 2P-Z0315  | 4   | ROLLER                    |             |
| 36   | 2C-1810   | 12  | BURR RIVETING             |             |
| 37   | 2C-Z0498  | 8   | NUT 10-24 NYLOK           |             |
| 38   | 2K-Z2895  | 2   | BUSHING SPLIT             |             |
| 39   | 2J-Z2329  | 1   | PILOT LIGHT               |             |
| 40   | 2C-Y1451  | 12  | RIVET .125 X .25          |             |
| 41   | 2C-6349   | 34  | SCREW #8 X .375 TH NP     |             |
| 42   | 2C-Z2642  | 4   | THREADED INSERT           | SST-30-120V |
| 43   | 2C-1494   | 1   | SCREW 8-32 X 1/2 STL RH   |             |
| 44   | 2C-1825   | 2   | WASHER #8 EXT. SHAKEPROOF |             |
| 45   | 2C-2556   | 2   | NUT #8-32                 |             |
| 46   | 2C-H1578  | 1   | SCREW 8-32 X 1"           |             |
| 47   | 2B-Z5847  | 1   | BUN RACK                  |             |

**IMPORTANT: WHEN ORDERING, SPECIFY VOLTAGE OR TYPE GAS DESIRED  
INCLUDE MODEL AND SERIAL NUMBER**

PAGE 1  
OF 1

Some items are included for illustrative purposes only and in certain instances may not be available.



**Star Manufacturing International, Inc.**

# PARTS LIST

August 2, 2010, Rev. G

MODEL: SST-50 120V/230CE Drawer Roll / Bun Warmer

| SST-50 120V/230CE Drawer Roll / Bun Warmer |           |     |                         |              |
|--|-----------|-----|-------------------------|--------------|
| Fig No                                     | Part No   | Qty | Description             | Application  |
| 1  | A4-Z2310  | 1   | TOP                     |              |
| 2  | A4-BW5003 | 1   | LINER-TOP               |              |
| 3  | A4-BW5011 | 1   | LINER-BODY              |              |
| 4  | A4-Z2308  | 1   | BODY                    |              |
| 5  | A4-Z3223  | 1   | BOTTOM                  |              |
| 6  | 2D-Z5898  | 2   | BUN PAN                 |              |
| 7  | A4-BW5010 | 1   | DRAWER FRAME ASSEMBLY   |              |
| 8  | A4-Z3316  | 1   | DRAWER LINER            |              |
| 9  | A4-BW5032 | 1   | DRAWER FRONT ASY        |              |
| 10   | 2M-Z2326  | 1   | GRAPHIC-DRAWER          |              |
| 11   | A4-Z5894  | 1   | PAN COVER               |              |
| 12   | A4-Z2272  | 1   | ELEMENT SUPPORT         |              |
| 13   | A4-Z2314  | 1   | BOTTOM LINER            |              |
| 14   | 2N-Z2324  | 1   | ELEMENT 600 WATTS       | SST-50 120V  |
|  | 2N-Z2312  |     | ELEMENT 600 WATTS       | SST-50 230CE |
| 15   | A4-Z2320  | 1   | CONTROL PANEL           |              |
| 16   | 2M-Z2327  | 1   | GRAPHIC-CONTROL PANEL   |              |
| 17   | A4-Z2316  | 1   | DOOR LINER              |              |
| 18   | A5-BW5009 | 1   | DOOR ASSY               |              |
| 19   | 2E-Z3034  | 1   | PLUG INLET              | SST-50 230CE |
| 20   | A4-Z2287  | 1   | PLUG INLET HOUSING      | SST-50 230CE |
| 21   | 2R-Z5846  | 4   | FOOT 3/8" STUD, 1" HIGH |              |
| 24   | E4-403009 | 1   | CORDSET                 | SST-50 120V  |
|  | 2E-Z0512  |     | CORDSET                 | SST-50 230CE |
| 25   | 2K-7889   | 1   | CORDSET BUSHING         | SST-50 120V  |
| 26   | 2R-Y7330  | 2   | MAGNETIC CATCH          |              |
| 27   | 21-Z1894  | 2   | HINGE INSERT            |              |
| 28   | 2A-Z2233  | 2   | HINGE SLEEVE            |              |
| 29   | A4-Z2228  | 1   | HINGE BRACKET LEFT      |              |
| 30   | A4-Z2229  | 1   | HINGE BRACKET RIGHT     |              |
| 31   | 2R-Z1854  | 1   | CONTROL KNOB            |              |
| 32   | 2E-Z1858  | 1   | SWITCH ON/OFF           |              |
| 33   | 2T-Z2236  | 1   | THERMOSTAT              |              |

| SST-50 120V/230CE Drawer Roll / Bun Warmer |           |     |                           |             |
|--|-----------|-----|---------------------------|-------------|
| Fig No                                     | Part No   | Qty | Description               | Application |
| 34   | A4-BW5005 | 1   | DOOR ASSEMBLY COMPLETE    |             |
| 35   | 2P-Z0315  | 4   | ROLLER                    |             |
| 36   | 2C-1810   | 12  | BURR RIVETING             |             |
| 37   | 2C-Z0498  | 8   | NUT 10-24 NYLOK           |             |
| 38   | 2K-Z2895  | 2   | BUSHING SPLIT             |             |
| 39   | 2J-Z2329  | 1   | PILOT LIGHT               |             |
| 40   | 2C-Y1451  | 12  | RIVET .125 X .25          |             |
| 41   | 2C-6349   | 34  | SCREW #8 X .375 TH NP     |             |
| 42   | 2C-Z2642  | 4   | THREADED INSERT           | SST-50-120V |
| 43   | 2C-1494   | 1   | SCREW 8-32 X 1/2 STL RH   |             |
| 44   | 2C-1825   | 2   | WASHER #8 EXT. SHAKEPROOF |             |
| 45   | 2C-2556   | 2   | NUT #8-32                 |             |
| 46   | 2C-H1578  | 1   | SCREW 8-32 X 1"           |             |
| 47   | 2B-Z5847  | 1   | BUN RACK                  |             |

**IMPORTANT: WHEN ORDERING, SPECIFY VOLTAGE OR TYPE GAS DESIRED  
INCLUDE MODEL AND SERIAL NUMBER**

PAGE 1  
OF 1

Some items are included for illustrative purposes only and in certain instances may not be available.



Star Manufacturing International, Inc.

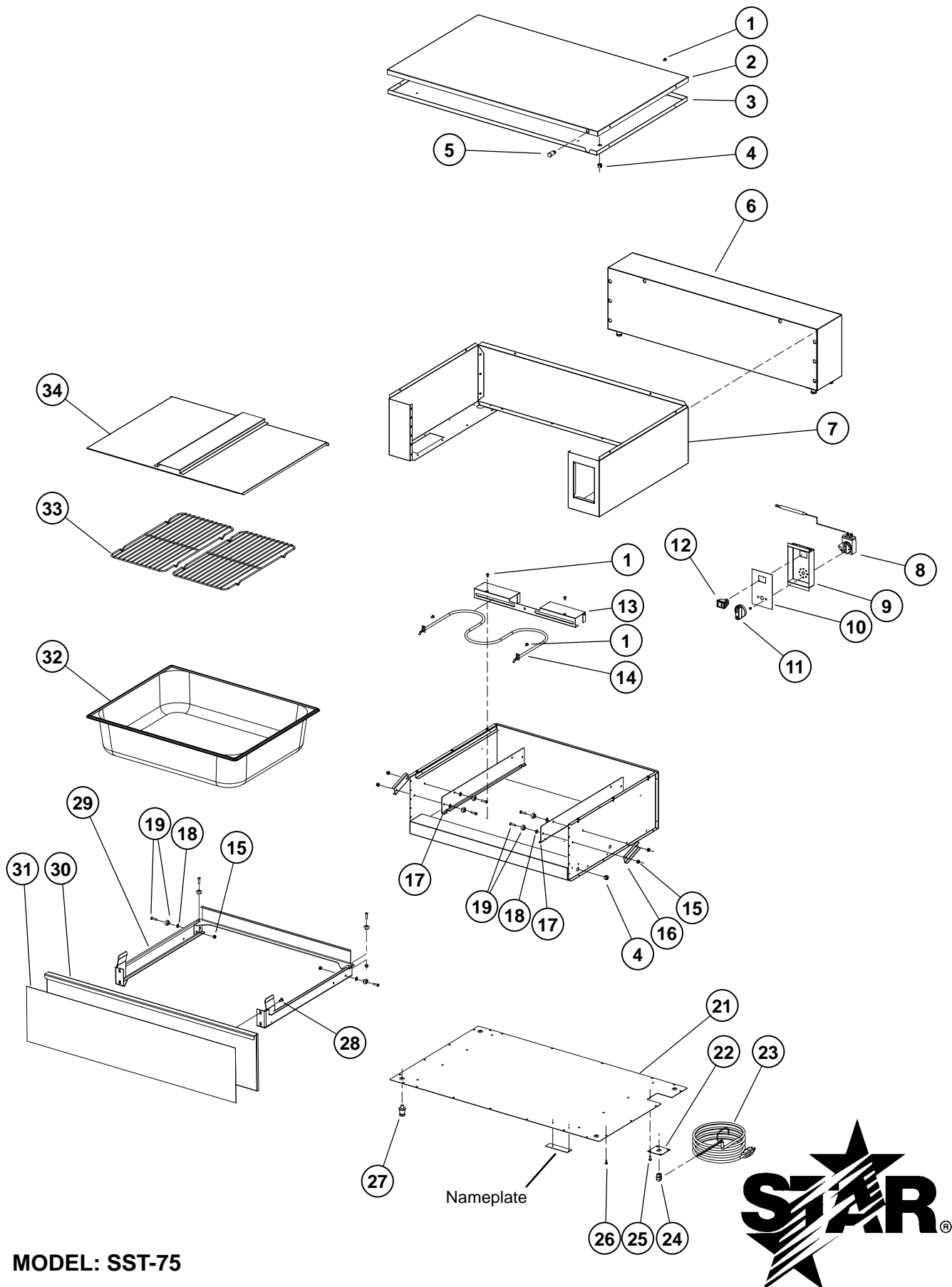

MODEL: SST-75

STAR MANUFACTURING INTERNATIONAL, INC.

SK2441

Rev. -

10/02/09

# PARTS LIST

October 2, 2009, Rev. G

MODEL SST-75 120V/230CE Drawer Roll / Bun Warmer

| SST-75 120V/230CE Drawer Roll / Bun Warmer |             |   |     |             |
|--|-------------|---|-----|-------------|
| Fig No                                     | Part No.    | Description                             | Qty | Application |
| 1  | 2C-6349     | SCREW #8X3/8 B THP STL NP               | 10  |             |
| 2  | A4-Z11900   | TOP                                     | 1   |             |
| 3  | A4-BW5020   | TOP LINER ASSEMBLY                      | 1   |             |
| 4  | 2K-Z2895    | BUSHING HEYCO OCB-500                   | 2   |             |
| 5  | 2J-Z2329    | PILOT LIGHT                             | 1   | 230CE       |
|  | 2J-Z3157    | PILOT LIGHT 250V AMBER                  |     |             |
| 6  | 8A-75BWST   | BUN WARMER SHELF TALL, <b>ACCESSORY</b> |     |             |
| 7  | A4-BW5018   | BODY WRAP ASSEMBLY                      | 1   |             |
| 8  | 2T-Y9113    | THERMOSTAT                              | 1   |             |
| 9  | A4-Z11909   | CONTROL HOUSING                         | 1   |             |
| 10   | 2M-Z11956   | OVERLAY - SST                           | 1   |             |
| 11   | 2R-Z4621    | KNOB, 1-3/4" .250"D HOLE                | 1   |             |
| 12   | 2E-Z1858    | SWITCH-LIGHTED                          | 1   |             |
| 13   | A4-Z11947   | ELEMENT BRACKET                         | 1   |             |
| 14   | 2N-Z2312    | ELEMENT 230V/600W                       | 1   | 230CE       |
|  | 2N-Z2324    | ELEMENT                                 |     |             |
| 16   | 2C-Z4248    | NUT 10-24 NYLK SS                       | 11  |             |
| 16   | E9-Z3987    | ROLLER SUPPORT DW/N                     | 2   |             |
| 17   | A4-Z11895   | SLIDE RAIL                              | 2   |             |
| 18   | 2C-1810     | WASHER 3/16 BURR STL NP                 | 4   |             |
| 19   | 2P-Z0315    | BEARING-TRACK                           | 4   |             |
| 21   | A4-Z11897   | BOTTOM                                  | 1   |             |
| 22   | A4-Z11970-1 | POWER INLET POCKET                      | 1   | 230CE       |
|  | A4-Z11970-2 | POWER INLET PLATE                       |     |             |
| 23   | 2E-Z0512    | CORD SET, CONT. EUR 10A                 | 1   | 230CE       |
|  | 2E-Z11975   | CORDSET 18-3 5-15 PO                    |     |             |
| 24   | 2K-7889     | BUSHING HEYCO SR-11-2                   | 1   |             |
| 25   | 2C-1513     | SCREW 10-24X1/2 RHP SS                  | 4   |             |
| 26   | 2C-Z6925    | SCREW #8X1/2 HEXW B SS                  | 37  |             |
| 27   | 2R-Z5846    | FOOT-ROLLER GRILLS                      | 4   |             |
| 28   | 2C-Z4063    | SCREW 10-24X1/2 SS THP                  | 4   |             |
| 29   | A4-BW5017   | DRAWER FRAME ASSEMBLY                   | 1   |             |
| 30   | A4-BW5021   | DRAWER FACE ASSEMBLY                    | 1   |             |
| 31   | 2M-Z12029   | GRAPHIC, DRAWER FRONT                   | 1   |             |
| 32   | 2D-Z11949   | STEAM PAN - DOUBLE 6"                   | 1   |             |
| 33   | 2B-Z5848    | BUN RACK (LARGE)                        | 2   |             |
| 34   | A4-Z11899   | PAN COVER                               | 1   |             |
| NI   | 2E-Z3034    | IEC CORD INLET HOT                      | 1   | 230CE       |

IMPORTANT: WHEN ORDERING, SPECIFY VOLTAGE OR TYPE GAS DESIRED  
INCLUDE MODEL AND SERIAL NUMBER

PAGE 1  
OF 1

Some items are included for illustrative purposes only and in certain instances may not be available.



Star Manufacturing International, Inc.