

STAR[®] **BROIL-O-DOG**

MODEL
174CBA, 174SBA
175CBA, 175SBA

Installation and Operation Instructions

2M-Z3755 Rev. J 10/4/06



175CBA

cUL[®]us
LISTED
(120V Only)



SAFETY SYMBOL



These symbols are intended to alert the user to the presence of important operating and maintenance instructions in the manual accompanying the appliance.

RETAIN THIS MANUAL FOR FUTURE REFERENCE NOTICE

Using any part other than genuine Star factory supplied parts relieves the manufacturer of all liability.

Star reserves the right to change specifications and product design without notice. Such revisions do not entitle the buyer to corresponding changes, improvements, additions or replacements for previously purchased equipment.

Due to periodic changes in designs, methods, procedures, policies and regulations, the specifications contained in this sheet are subject to change without notice. While Star Manufacturing exercises good faith efforts to provide information that is accurate, we are not responsible for errors or omissions in information provided or conclusions reached as a result of using the specifications. By using the information provided, the user assumes all risks in connection with such use.

MAINTENANCE AND REPAIRS

Contact your local authorized service agent for service or required maintenance. Please record the model number, serial number, voltage and purchase date in the area below and have it ready when you call to ensure faster service.

Model No. _____
Serial No. _____
Voltage _____
Purchase Date _____

Authorized Service Agent

Reference the listing provided with the unit

or

for an updated listing go to:

Website: www.star-mfg.com
E-mail Service@star-mfg.com
Telephone: (800) 807-9054 Local (314) 781-2777

The Star Service Help Desk

Business Hours: 8:00 am to 4:30 p.m. Central Standard Time

Telephone: (800) 807-9054 Local (314) 781-2777

Fax: (800) 396-2677 Local (314) 781-2714

E-mail Parts@star-mfg.com
Service@star-mfg.com
Warranty@star-mfg.com

Website: www.star-mfg.com

Mailing Address: Star Manufacturing International Inc.
10 Sunnen Drive
St. Louis, MO 63143
U.S.A

SPECIFICATIONS

174SBA

Type: Spike Wheel
Capacity: 24 Hot Dogs, 12 Buns
Electrical: 120 volt, 60 hertz, single phase, 1150 watts, 9.58 amps
230 volt, 60 hertz, single phase, 1060 watts, 4.61 amps
Cord Length - 4 ft.
Plug: 120V NEMA Spec - NEMA 5-15P
230V CEE-7/VII rated 16A 250V
Dimensions: 13 1/2"W x 14 1/2"D x 24"H
(34.29 cm W x 36.83 cm D x 60.96 cm H)

174CBA

Type: Cradle Wheel
Capacity: 18 Hot Dogs, 12 Buns
Electrical: 120 volt, 60 hertz, single phase, 1150 watts, 9.58 amps
230 volt, 60 hertz, single phase, 1060 watts, 4.61 amps
Cord Length - 4 ft.
Plug: 120V NEMA Spec - NEMA 5-15P
230V CEE-7/VII rated 16A 250V
Dimensions: 13 1/2"W x 14 1/2"D x 24"H
(34.29 cm W x 36.83 cm D x 60.96 cm H)

175SBA

Type: Spike Wheel
Capacity: 48 Hot Dogs, 32 Buns
Electrical: 120 volt, 60 hertz, single phase, 1350 watts, 11.25 amps
230V volt, 60 hertz, single phase, 1240 watts, 5.39 amps
Cord Length - 4 ft.
Plug: 120V NEMA Spec - NEMA 5-15P
230V CEE-7/VII rated 16A 250V
Dimensions: 19 1/2"W x 14 1/2"D x 24"H
(49.53 cm W x 36.83 cm D x 60.96 cm H)

175CBA

Type: Cradle Wheel
Capacity: 36 Hot Dogs, 32 Buns
Electrical: 120 volt, 60 hertz, single phase, 1350 watts, 11.25 amps
230V volt, 60 hertz, single phase, 1240 watts, 5.39 amps
Cord Length - 4 ft.
Plug: 120VNEMA Spec - NEMA 5-15P
230V CEE-7/VII rated 16A 250V
Dimensions: 19 1/2"W x 14 1/2"D x 24"H
(49.53 cm W x 36.83 cm D x 60.96 cm H)



CAUTION

This equipment is designed and sold for commercial use only by personnel trained and experienced in its operation and is not sold for consumer use in and around the home nor for use directly by the general public in food service locations.

Before using your new equipment, read and understand all the instructions & labels associated with the unit prior to putting it into operation. Make sure all people associated with its use understand the units operation & safety before they use the unit.

All shipping containers should be checked for freight damage both visible and concealed. This unit has been tested and carefully packaged to insure delivery of your unit in perfect condition. If equipment is received in damaged condition, either apparent or concealed, a claim must be made with the delivering carrier.

Concealed damage or loss - if damage or loss is not apparent until after equipment is unpacked, a request for inspection of concealed damage must be made with carrier within 15 days. Be certain to retain all contents plus external and internal packaging materials for inspection. The carrier will make an inspection and will supply necessary claim forms. This equipment is designed and sold for commercial use only by personnel trained and experienced in its operation and is not sold for consumer use in and around the home nor for use directly by the general public in food service locations.

INSTALLATION

1. Clean unit inside and outside before placing in service. (See Cleaning)
2. Install the low E Tempered, oxide coated glass (**reflective side facing inward**) as shown below. The 1/4" thick glass goes in the side location, resting in the track formed into the shelf. The 1/8" thick glass goes on the front of the unit.

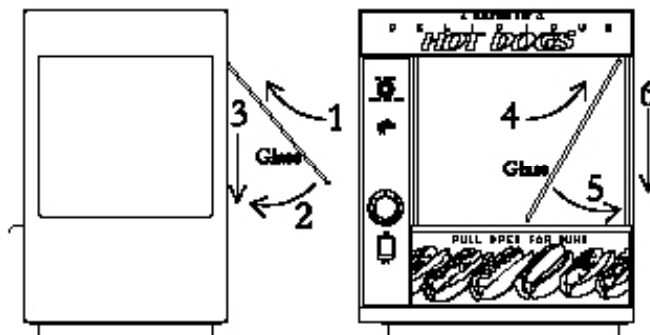

3. Install the wire shaft support as shown in steps 7 and 8. Mounting holes have been punched in the ceiling of the unit.

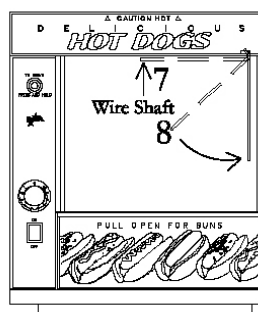

4. Install the hot dog wheel as shown in steps 9 and 10. While holding the wire shaft support against the side glass, install the hot dog wheel in the broiler by placing the slotted end of the shaft into the motor coupling at the left of the broiler (step 9). Turn the shaft until the slot engages with the coupling pin. Raise the grooved end of the shaft up and into the wire shaft support on the right side of the broiler (step 10).

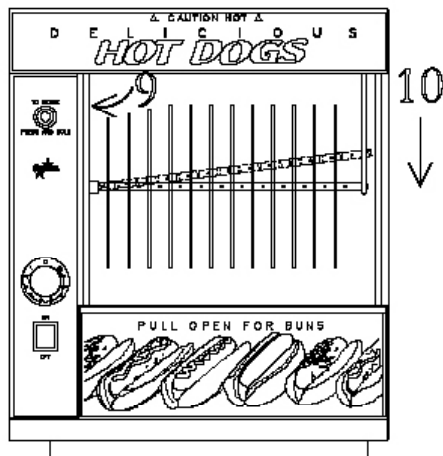

5. Place the unit in a prominent location on a level counter, where the revolving hot dogs will attract attention.
6. Precaution should be taken so customers do not come in contact with the hot unit.
7. Plug the power cord into a suitable 120 volt outlet that can provide the required wattage. Having other appliances on a circuit, may prevent your unit from receiving the necessary voltage.

GENERAL OPERATING PROCEDURES

1. Pre-heat unit for 15 minutes while set at 10.
2. Place the desired quantity of hot dogs on the holders. **NOTE:** A lower temp control setting may be used for slower broiling. The time required to broil the hot dogs will vary, depending upon the size and the temperature of the hot dogs when placed in the Broil-O-Dog.
3. Place the desired quantity of buns in the bun drawer. For best results leave buns in the bag. A 50 watt warming element is installed to keep buns warm.
4. Turn control to 6 or 7 to keep the hot dogs in a ready-to-serve condition. Hot dogs can be held for several hours on this unit without loss of flavor or shriveling.
5. Load or unload the hot dog wheel by pressing in and holding the serve switch to stop the hot dog wheel.

NOTE: When you turn the switch to the "OFF" position, you turn off the heating element.

COOKING

The heat control provides an infinite range of settings for a wide variety of hot dogs and installation conditions. The size, content and shape of the product and the installation of any sanitary food shields or sneeze guards will determine the proper heat setting. The National Sanitation Foundation requires that perishable foods be kept at 140°F or above during serving periods. The product should be kept refrigerated until ready for use. Cooking time will vary depending on the starting temperature and the qualities of the product.

COOKING

The heat control provides an infinite range of settings for a wide variety of hot dogs and installation conditions. The size, content and shape of the product and the installation of any sanitary food shields or sneeze guards will determine the proper heat setting. The National Sanitation Foundation requires that perishable foods be kept at 140°F or above during serving periods. The product should be kept refrigerated until ready for use. Cooking time will vary depending on the starting temperature and the qualities of the product.

CLEANING

1. Place ON/OFF switch in "OFF" position.
2. Remove the hot dog wheel and drip tray.
3. Remove the wheel hanger at right side of broiler.
4. The glass is removable for cleaning but care must be taken when doing so.
5. Clean all of the above parts and inside and outside of the unit with mild soap and water; rinse and install parts.
6. These models require the removal of the bun drawer to remove the bun pan. To remove the bun drawer, grab the drawer by both sides and pull it out all the way. Lift the front to unhook the drawer slide from rear drawer roller. Pull the drawer the remainder of the way out. Use caution not to drop the drawer when reaching the end of the drawer slide travel. To reinsert the drawer, first hook the drawer slide over the front roller then the back roller (See Figure1-Figure 3).

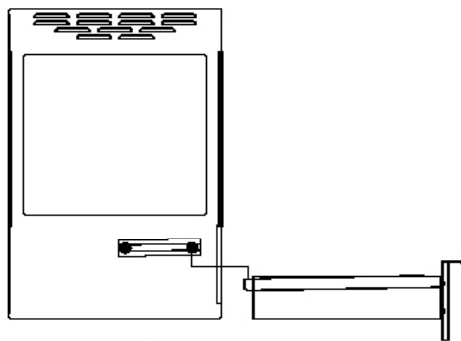

FIGURE 1

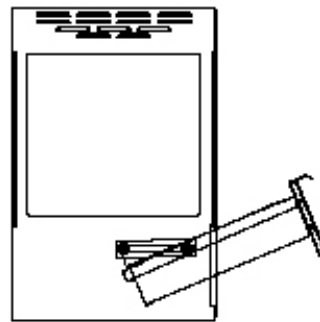

FIGURE 2

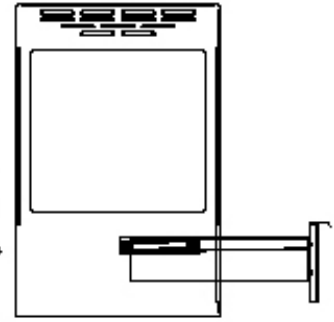

FIGURE 3



CAUTION

TO AVOID COMBUSTION, REPLACEMENT GLASS MUST BE LOW TEMPERED, TIN OXIDE COATED. CALL STAR SERVICE HELP DESK.

MAINTENANCE PROCEDURES

LIGHT BULB

Use a 15 watt, 120 volt (or 240V if applicable) appliance size oven-type lamp.

GLASS REPLACEMENT

Refer to the installation procedures located on page 4. To prevent surrounding areas from getting too hot, use only a low E Tempered, oxide coated glass (**reflective side facing inward**) when replacing glass. This glass can be purchased by contacting Star (contact information located on the inside front cover).

Visit our Website at: www.star-mfg.com

Email: service@star-mfg.com

THOROUGHLY INSPECT YOUR UNIT ON ARRIVAL

This unit has been tested for proper operation before leaving our plant to insure delivery of your unit in perfect condition. However, there are instances in which the unit may be damaged in transit. In the event you discover any type of damage to your product upon receipt, you must immediately contact the transportation company who delivered the item to you and initiate your claim with same. If this procedure is not followed, it may affect the warranty status of the unit.

LIMITED EQUIPMENT WARRANTY

All workmanship and material in Star products have a one (1) year limited warranty on parts & labor in the United States and Canada. Such warranty is limited to the original purchaser only and shall be effective from the date the equipment is placed in service. Star's obligation under this warranty is limited to the repair of defects without charge, by the factory authorized service agency or one of its sub-agencies. Models that are considered portable (*see below*) should be taken to the closest Star service agency, transportation prepaid.

- > Star will not assume any responsibility for loss of revenue.
- > On all shipments outside the United States and Canada, see International Warranty.
- * The warranty period for the JetStar six (6) ounce & Super JetStar eight (8) ounce series popcorn machines is two (2) years.
- * The warranty period for the Chrome-Max Griddles is five (5) years on the griddle surface. See detailed warranty provided with unit.
- * The warranty period for Teflon/Dura-Tec coatings is one year under normal use and reasonable care. This warranty does not apply if damage occurs to Teflon/Dura-Tec coatings from improper cleaning, maintenance, use of metallic utensils, or abrasive cleaners. This warranty does not apply to the "non-stick" properties of such materials.
- > This warranty does not apply to "Special Products" but to regular catalog items only. Star's warranty on "Special Products" is six (6) months on parts and ninety (90) days on labor.
- > This warranty does not apply to any item that is disassembled or tampered with for any purpose other than repair by a Star Authorized Service Center or the Service Center's sub-agency.
- > This warranty does not apply if damage occurs from improper installation, misuse, wrong voltage, wrong gas or operated contrary to the Installation and Operating instructions.
- > This warranty is not valid on Conveyor Ovens *unless* a "start-up/check-out" has been performed by a Factory Authorized Technician.

PARTS WARRANTY

Parts that are sold to repair out of warranty equipment are warranted for ninety (90) days. The part only is warranted. Labor to replace the part is chargeable to the customer.

SERVICES NOT COVERED BY WARRANTY

- | | |
|--|---|
| 1. Travel time and mileage rendered beyond the 50 mile radius limit | 10. Voltage conversions |
| 2. Mileage and travel time on portable equipment (<i>see below</i>) | 11. Gas conversions |
| 3. Labor to replace such items that can be replaced easily during a daily cleaning routine, ie; removable kettles on fryers, knobs, grease drawers on griddles, etc. | 12. Pilot light adjustment |
| 4. Installation of equipment | 13. Miscellaneous adjustments |
| 5. Damages due to improper installation | 14. Thermostat calibration and by-pass adjustment |
| 6. Damages from abuse or misuse | 15. Resetting of circuit breakers or safety controls or reset buttons |
| 7. Operated contrary to the Operating and Installation Instructions | 16. Replacement of bulbs |
| 8. Cleaning of equipment | 17. Replacement of fuses |
| 9. Seasoning of griddle plates | 18. Repair of damage created during transit, delivery, & installation OR created by acts of God |

PORTABLE EQUIPMENT

Star will not honor service bills that include travel time and mileage charges for servicing any products considered "Portable" including items listed below. These products should be taken to the Service Agency for repair:

- * The Model 510FD Fryer.
- * The Model J4R, 4 oz. Popcorn Machine.
- * The Model 518CMA & 526CMA Cheese Melter.
- * The Model 12MC & 15MC & 18MCP Hot Food Merchandisers.
- * The Model 12NCPW & 15NCPW Nacho Chip/Popcorn Warmer.
- * All Hot Dog Equipment **except Roller Grills & Drawer Bun Warmers.**
- * All Nacho Cheese Warmers **except Model 11WLA Series Nacho Cheese Warmer.**
- * All Condiment Dispensers **except the Model HPDE, & SPDE Series Dispenser.**
- * All Specialty Food Warmers **except Model 130R, 11RW Series, and 11WSA Series.**
- * All QCS/RCS Series Toasters **except Model QCS3 & RCS3 Series.**

ALL:

- * Pop-Up Toasters
- * Butter Dispensers
- * Pretzel Merchandisers
- * Pastry Display Cabinets
- * Nacho Chip Merchandisers
- * Accessories of any kind
- * Sneeze Guards
- * Pizza Ovens
- * Heat Lamps
- * Pumps

The foregoing warranty is in lieu of any and all other warranties expressed or implied and constitutes the entire warranty.

FOR ASSISTANCE

Should you need any assistance regarding the Operation or Maintenance of any Star equipment; write, phone, fax or email our Service Department. In all correspondence mention the Model number and the Serial number of your unit, and the voltage or type of gas you are using.

Part# 2M-4497-2 05/06 RB

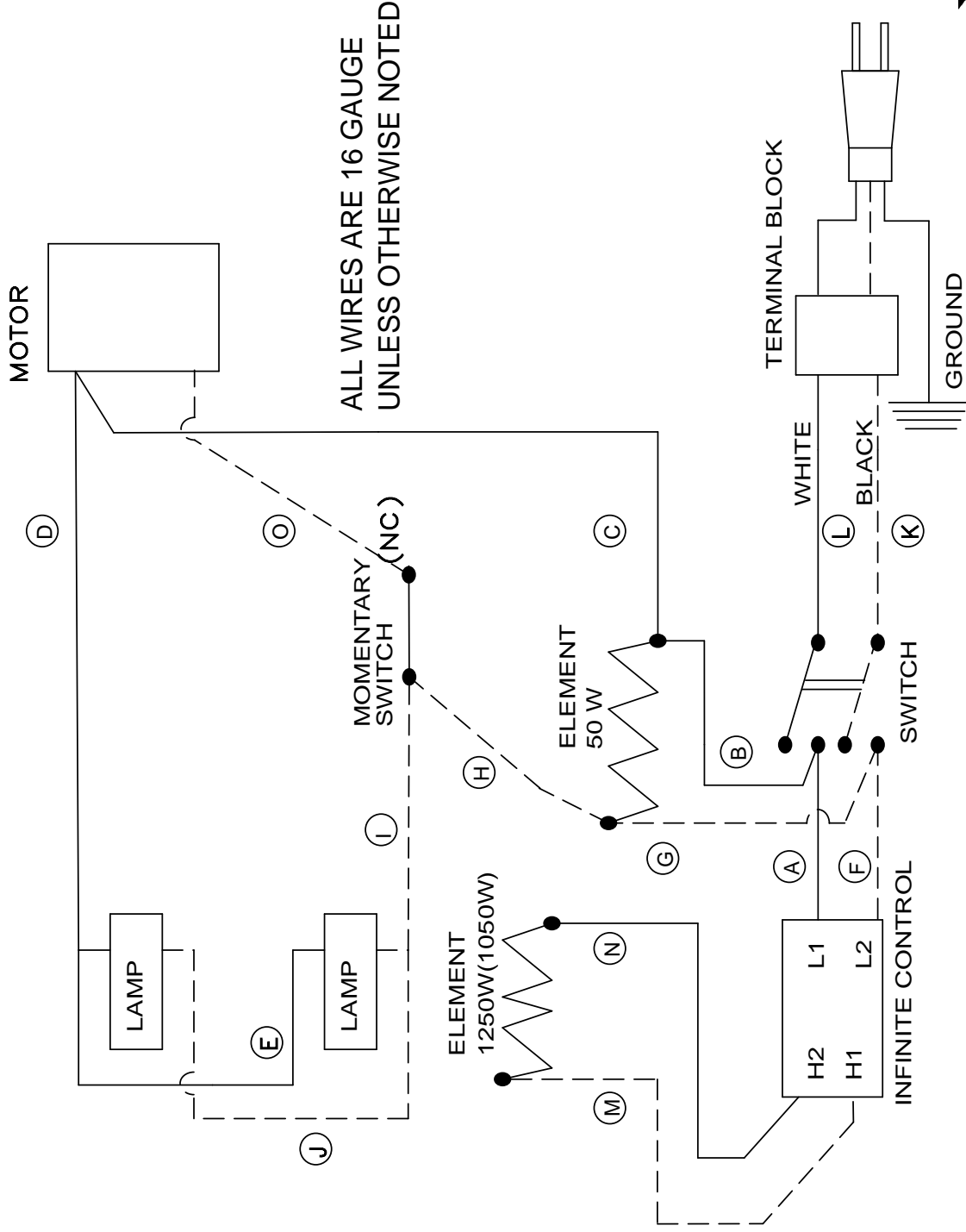

MODEL: 174CBA, 174SBA, 175CBA, 175SBA

THIS DRAWING CONTAINS INFORMATION CONFIDENTIAL TO STAR MFG. INT'L. INC.
NO REPRODUCTION OR DISCLOSURE OF ITS CONTENTS IS PERMITTED.



STAR MANUFACTURING INTERNATIONAL INC.

SK1790

Rev -

7/18/2000

MODEL 175SBA SHOWN
WELDED ASSEMBLY EXPLODED FOR CLARITY

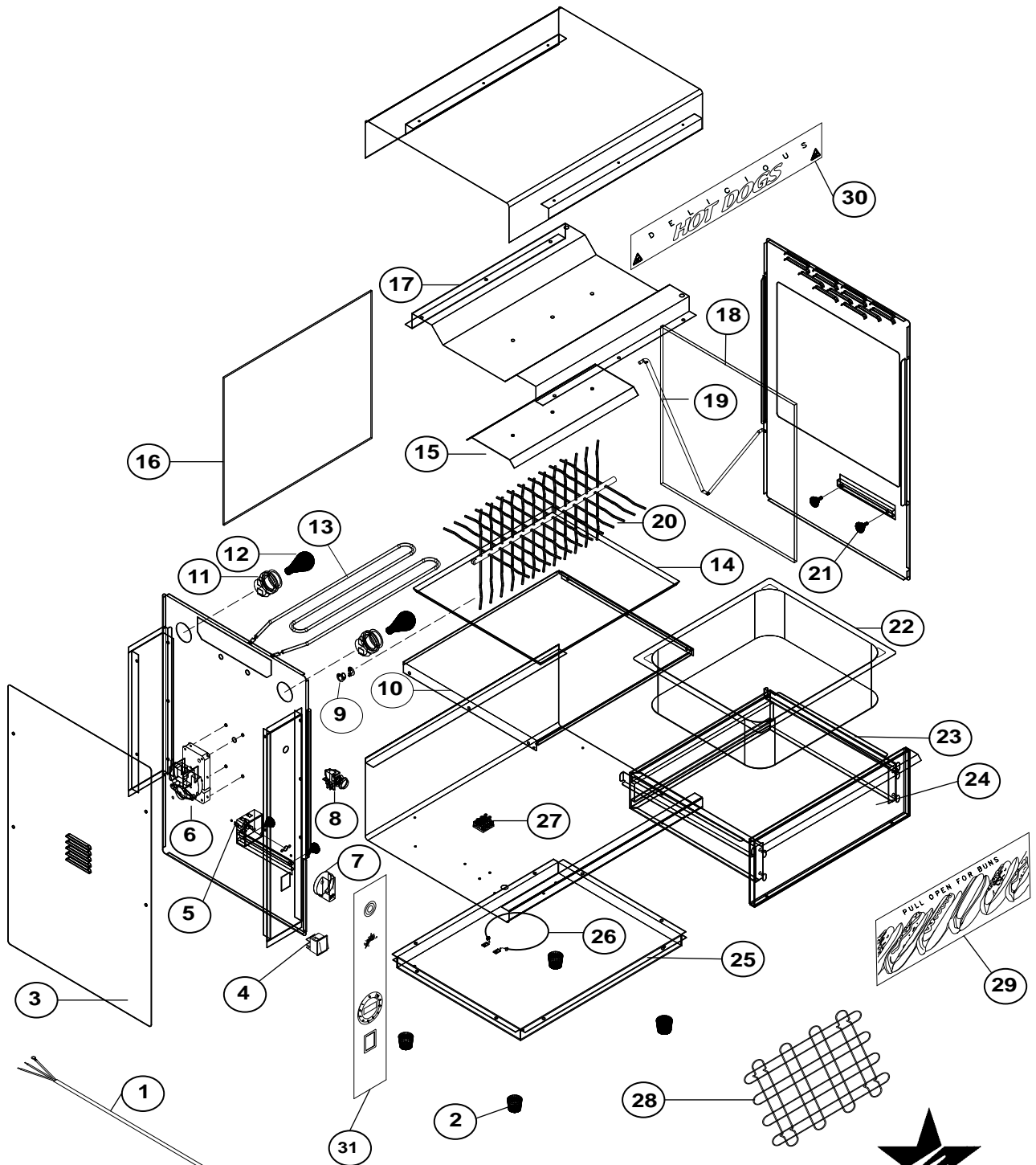

SOME ITEMS ARE INCLUDED FOR
ILLUSTRATIVE PURPOSES ONLY AND IN
CERTAIN INSTANCES MAY NOT BE AVAILABLE

This drawing contains information confidential
to Star Manufacturing International, Inc.
No reproduction or disclosure of its
contents is permitted.



MODEL 174CBA,174SBA,175CBA,175SBA

STAR MANUFACTURING INTERNATIONAL, INC.

SK1793

REV. A

11/28/00

PARTS LIST

October 4, 2006, Rev. J

MODEL 174CBA/SBA, 175CBA/SBA Broil-O-Dog

Key Number	Part Number	Number Per Unit	Description and Model Designation
1	2E-Z3385	1	CORD SET 14/3 120V 15A
	B9-73029	1	LEAD IN CORD 230CE
2	2I-Z0057	4	FOOT-RUBBER
3	A1-Z3669	1	ACCESS PANEL
4	2E-Z1858	1	SWITCH
5	2J-Z2195	1	TEMP CONTROL (120V)
	2J-Z2192	1	TEMP CONTROL (240V)
6	2U-Z3641	1	MOTOR - 2.4 RPM (120V) Fan Not Included
	2U-Z3642	1	MOTOR - 2.4 RPM (230V) Fan Not Included
NI	2U-Z9811	1	FAN, MOTOR
7	2R-Z1854	1	KNOB TEMP CONTROL
8	2E-Z3682	1	SWITCH-MOMENTARY
9	2K-7523	1	COUPLING-MOTOR-SHAFT
10	A1-Z3660	1	SHELF 175CBA/SBA
	A1-Z3684	1	SHELF 174CBA/SBA
11	2E-Y9184	2	SOCKET
12	2S-1279	2	LAMP 15W 120V #15A15
	2S-Y8321	2	LAMP 15W 220V
13	2N-Z3799	1	ELEMENT - HEATING 120V 1250W 175CBA/SBA
	2N-Y5313	1	ELEMENT - HEATING 120V 1050W 174CBA/SBA
	2N-Z3800	1	ELEMENT - HEATING 240V 1250W 175CBA/SBA
	2N-Z2754	1	ELEMENT - HEATING 240V 1050W 174CBA/SBA
14	A1-Y1290	1	TRAY 175CBA/SBA
	A1-Y5348	1	TRAY 174CBA/SBA
15	A1-Z3676	1	ELEMENT PLATE 175CBA/SBA
	A1-Z3693	1	ELEMENT PLATE 174CBA/SBA
16	2Q-Z3644	1	GLASS FRONT, LOW E TEMP. OXIDE COATING 175CBA/SBA (14 15/16" x 12 5/8")
	2Q-Z3645	1	GLASS FRONT, LOW E TEMP. OXIDE COATING 174CBA/SBA (8 15/16" x 12 5/8")
17	A1-BD1006	1	ASSY-ELEMENT BARRIER 175CBA/SBA
	A1-BD1010	1	ASSY-ELEMENT BARRIER 174CBA/SBA
18	2Q-Z3646	1	GLASS SIDE, LOW E TEMP. OXIDE COATING (13 1/2" x 13 1/2")
19	2B-Z3647	1	SHAFT SUPPORT
20	2B-Z7962	1	CRADLE WHEEL ASSEMBLY KIT (not shown) 175CBA
	2B-Z7963	1	CRADLE WHEEL ASSEMBLY KIT (not shown) 174CBA
	2B-Z3656	1	SPIKE WHEEL (shown) 175SBA
	2B-Z3657	1	SPIKE WHEEL (shown) 174SBA
21	2P-Z3812	4	ROLLERS
22	2D-Z5898	1	PAN 2/3 x 4" DEEP 175CBA/SBA
	2D-Z3643	1	PAN 1/3 x 4" DEEP 174CBA/SBA
23	A1-BD1004	1	DRAWER FRAME ASSEMBLY 175CBA/SBA
	A1-BD1008	1	DRAWER FRAME ASSEMBLY 174CBA/SBA
24	A1-BD1003	1	DRAWER PULL ASSEMBLY 175CBA/SBA
	A1-BD1007	1	DRAWER PULL ASSEMBLY 174CBA/SBA
25	A1-Z3672	1	BASE 175CBA/SBA
	A1-Z3692	1	BASE 174CBA/SBA
26	2N-Y4306	1	ELEMENT 50W (120V)
	2N-Z3781	1	ELEMENT 50W (240V)
27	2E-Y9050	1	TERMINAL BLOCK
28	2B-Z3807	2/1	BUN RACK 175CBA/SBA / 174CBA/SBA
29	2M-Z3770	1	GRAPHIC DRAWER FRONT 175 175CBA/SBA
	2M-Z3771	1	GRAPHIC DRAWER FRONT 174 174CBA/SBA
30	2M-Z3772	2	GRAPHIC TOP 175 175CBA/SBA
	2M-Z3773	2	GRAPHIC TOP 174 174CBA/SBA
31	2M-Z3708	1	OVERLAY

**IMPORTANT: WHEN ORDERING, SPECIFY VOLTAGE OR TYPE GAS DESIRED
INCLUDE MODEL AND SERIAL NUMBER**

PAGE 1
OF 1

Some items are included for illustrative purposes only and in certain instances may not be available.



Star Manufacturing International, Inc.

STAR MANUFACTURING

10 Sunnen Drive, St. Louis, MO 63143 U.S.A.

(800) 807-9054 (314) 781-2777

Parts & Service (800) 807-9054

www.star-mfg.com